

6/16/2008 8:07:01 AM C:\projects\South Arsenal Development\Authority\South Arsenal Road East\ADD\1850 MOT_03_01.dwg

MATCH LINE STA. 250+00

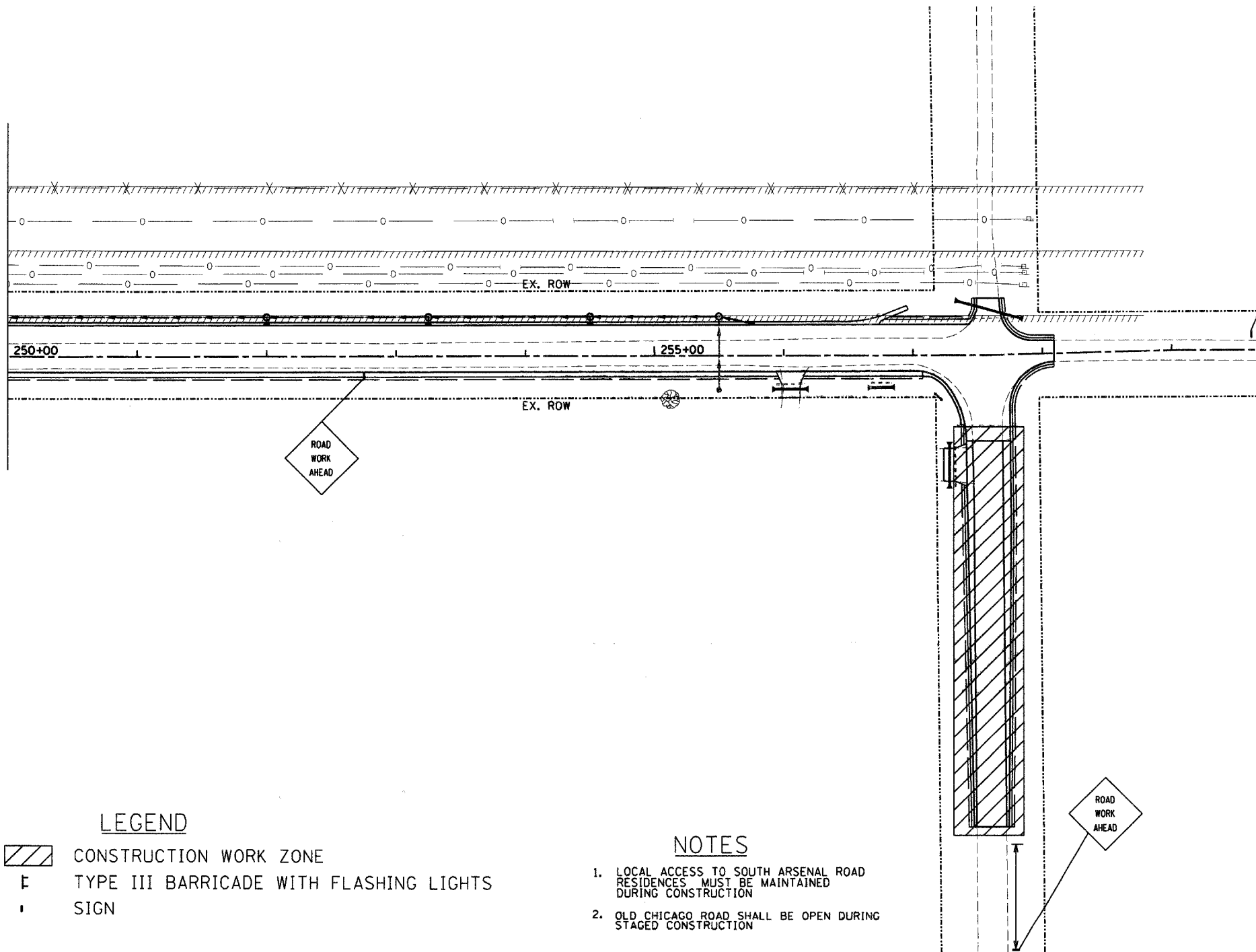

LEGEND

- CONSTRUCTION WORK ZONE
- TYPE III BARRICADE WITH FLASHING LIGHTS
- SIGN

NOTES

1. LOCAL ACCESS TO SOUTH ARSENAL ROAD RESIDENCES MUST BE MAINTAINED DURING CONSTRUCTION
2. OLD CHICAGO ROAD SHALL BE OPEN DURING STAGED CONSTRUCTION

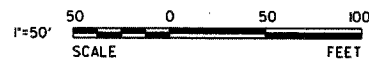

ESI CONSULTANTS, LTD
1979 N. MILL STREET, SUITE 100
 NAPERVILLE, IL 60563
 (630) 420-1700
 WWW.ESI-CONSULTANTS.COM

DESIGNED - JRS	REVISED -
DRAWN - DJN	REVISED -
CHECKED - MAR	REVISED -
DATE - 6/16/2008	REVISED -

**STATE OF ILLINOIS
 DEPARTMENT OF TRANSPORTATION**

MAINTENANCE OF TRAFFIC PLAN
 STAGE 2A

SCALE: 1"=50' SHEET NO. OF SHEETS STA. 250+00 TO STA. 258+09

F.A. RTE.	SECTION	COUNTY	TOTAL SHEETS	SHEET NO.
	08-00039-00-FP	WILL	89	50
CONTRACT NO. 63066				
FED. ROAD DIST. NO.		ILLINOIS FED. AID PROJECT		