

F.A.S. RTE.	SECTION	COUNTY	TOTAL SHEETS	SHEET NO.
1177	(110,111)T	LEE	59	14
STA.		TO STA.		
FED. ROAD DIST. NO.		ILLINOIS	FED. AID PROJECT	

STA. 28+64 TWO CELL 6' x 4' BOX CULVERT

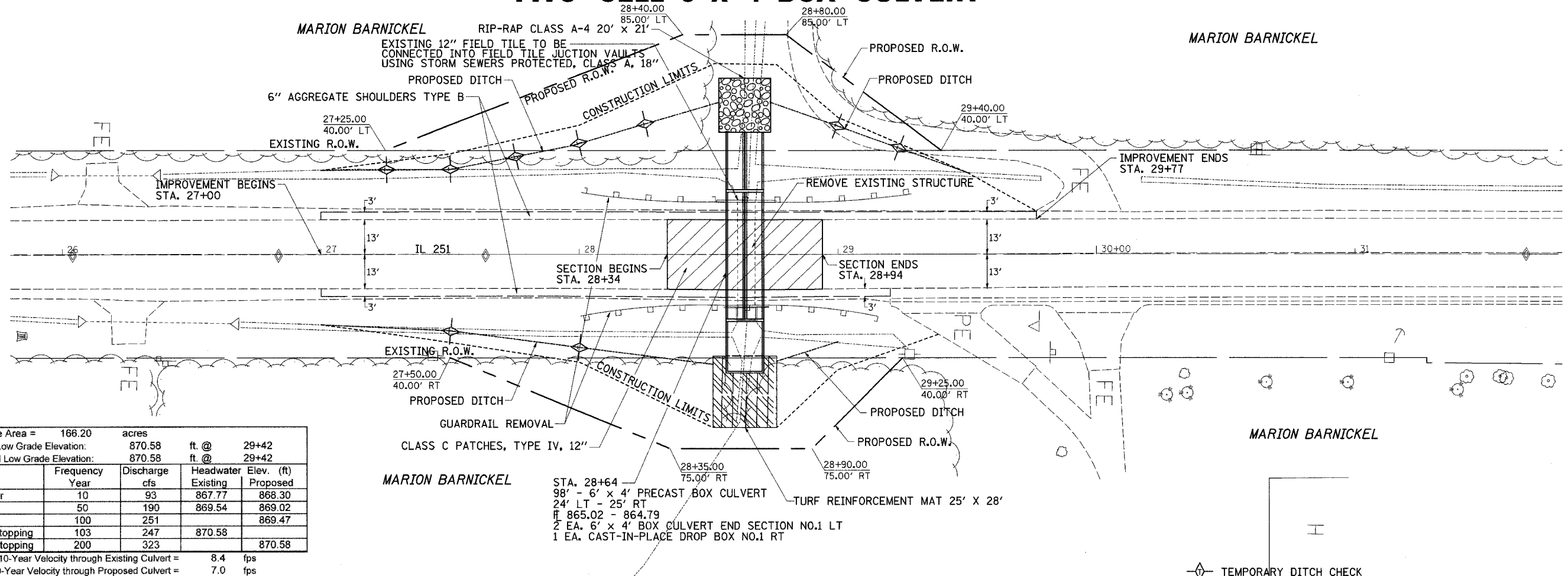

Drainage Area =	166.20	acres		
Existing Low Grade Elevation:	870.58	ft. @	29+42	
Proposed Low Grade Elevation:	870.58	ft. @	29+42	
Flood	Frequency	Discharge	Headwater	Elev. (ft)
	Year	cfs	Existing	Proposed
Ten-Year	10	93	867.77	868.30
Design	50	190	869.54	869.02
Base	100	251	869.02	869.47
EX Overtopping	103	247	870.58	
PR Overtopping	200	323		870.58

10-Year Velocity through Existing Culvert = 8.4 fps
 10-Year Velocity through Proposed Culvert = 7.0 fps

STA. 28+64
 98' - 6' x 4' PRECAST BOX CULVERT
 24' LT - 25' RT
 F 865.02 - 864.79
 2 EA. 6' x 4' BOX CULVERT END SECTION NO.1 LT
 1 EA. CAST-IN-PLACE DROP BOX NO.1 RT

PLAN

DATE	
BY	
DESIGNED	
PLOTTED	
ALIGNED	
CHECKED	
NO. 1	
NO. 2	
NO. 3	
NO. 4	
NO. 5	
NO. 6	
NO. 7	
NO. 8	
NO. 9	
NO. 10	

PROFILE

DATE	
BY	
DESIGNED	
PLOTTED	
GRADES	
CHECKED	
NO. 1	
NO. 2	
NO. 3	
NO. 4	
NO. 5	
NO. 6	
NO. 7	
NO. 8	
NO. 9	
NO. 10	

PLOT DATE = Tue Feb 26 10:28:54 2008
 PLOT SCALE = 20.0000' / IN.
 USER NAME = cushman

