

| F.A.S. RTE. | SECTION | COUNTY | TOTAL SHEETS | SHEET NO. |
|---------------------|------------|------------------|--------------|-----------|
| 1177 | (110,111)T | LEE | 59 | 15 |
| STA. | | TO STA. | | |
| FED. ROAD DIST. NO. | ILLINOIS | FED. AID PROJECT | | |

STA. 261+52 10' x 5' BOX CULVERT

PARAMOUNT GROUP, LLC

PARAMOUNT GROUP, LLC

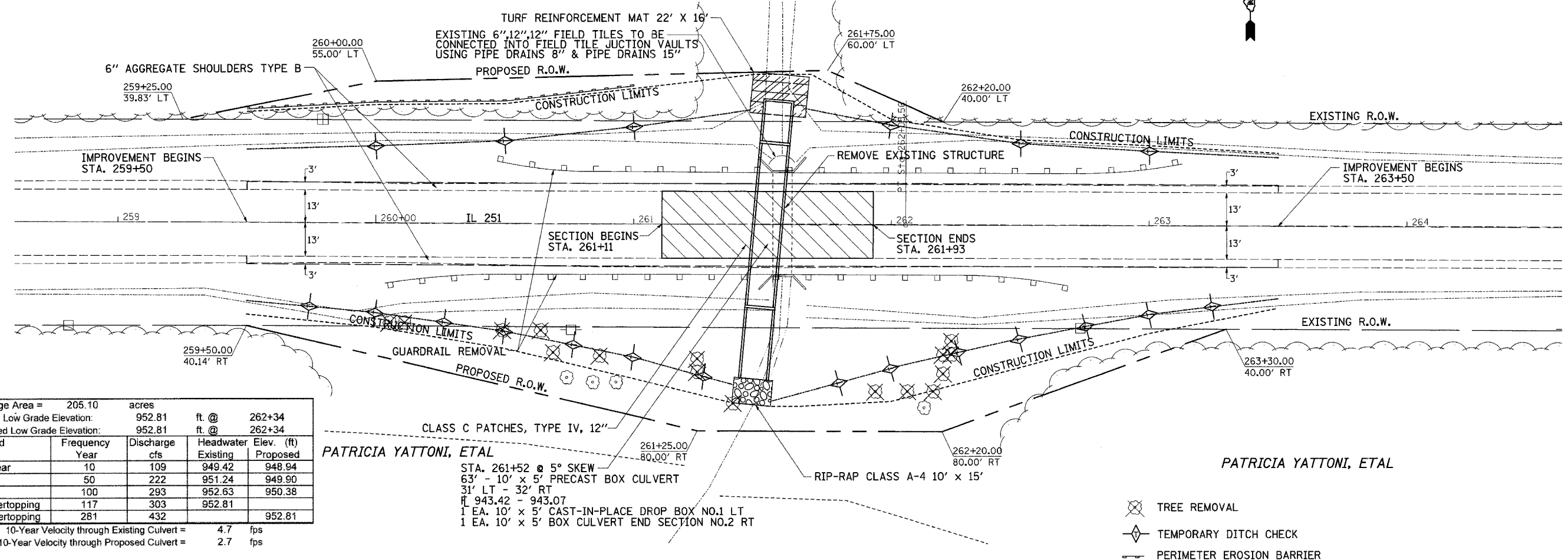

| | | | | |
|-------------------------------|--------|---------------|--------------------|---------------------|
| Drainage Area = | 205.10 | acres | | |
| Existing Low Grade Elevation: | 952.81 | ft. @ | 262+34 | |
| Proposed Low Grade Elevation: | 952.81 | ft. @ | 262+34 | |
| Flood Frequency | Year | Discharge cfs | Headwater Existing | Elev. (ft) Proposed |
| Ten-Year | 10 | 109 | 949.42 | 948.94 |
| Design | 50 | 222 | 951.24 | 949.90 |
| Base | 100 | 293 | 952.63 | 950.38 |
| EX Overtopping | 117 | 303 | 952.81 | |
| PR Overtopping | 281 | 432 | | 952.81 |

10-Year Velocity through Existing Culvert = 4.7 fps
 10-Year Velocity through Proposed Culvert = 2.7 fps

PATRICIA YATTONI, ETAL

CLASS C PATCHES, TYPE IV, 12"
 STA. 261+52 @ 5° SKEW
 63' - 10' x 5' PRECAST BOX CULVERT
 31' LT - 32' RT
 R 943.42 - 943.07
 1 EA. 10' x 5' CAST-IN-PLACE DROP BOX NO.1 LT
 1 EA. 10' x 5' BOX CULVERT END SECTION NO.2 RT

PATRICIA YATTONI, ETAL

- TREE REMOVAL
- TEMPORARY DITCH CHECK
- PERIMETER EROSION BARRIER

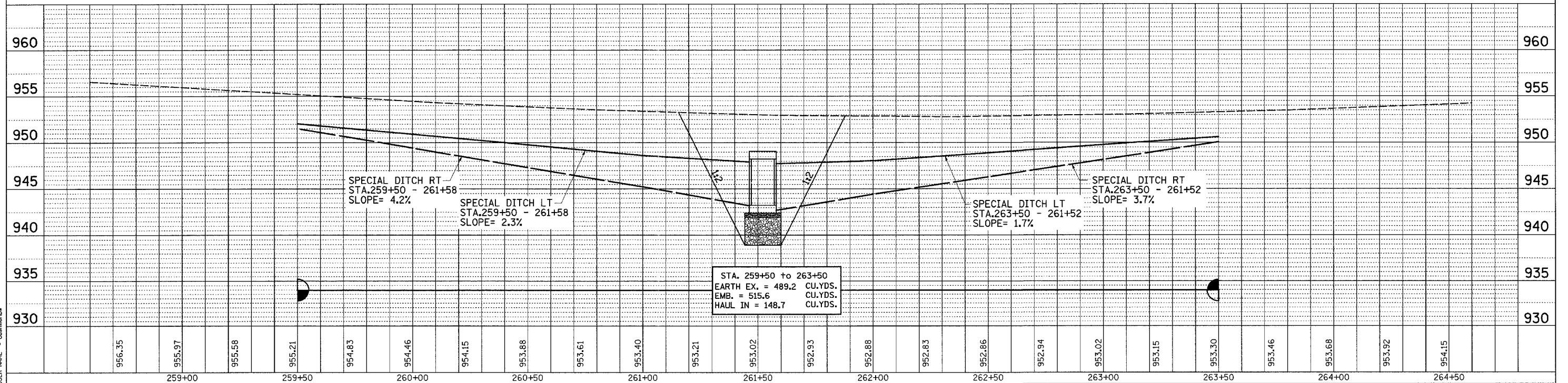

DATE: _____ BY: _____
 CHECKED: _____
 DATE: _____ BY: _____
 PLOTTED: _____
 DATE: _____ BY: _____
 PLAN NO. _____

DATE: _____ BY: _____
 CHECKED: _____
 DATE: _____ BY: _____
 PLOTTED: _____
 DATE: _____ BY: _____
 PROFILE NO. _____

PLOT DATE = Tue Feb 26 10:28:54 2008
 PLOT SCALE = 20.00000 / IN.
 USER NAME = cshambay