

KEY

CE - COMMERCIAL ENTRANCE	FE - FIELD ENTRANCE
PE - PRIVATE ENTRANCE	BC - BOX CULVERT
MT - MAILBOX TURNOUT	RR - RAILROAD
PC - PIPE CULVERT	

NOTES

- SEE DETAILS FOR TREATMENT AND EXTENT OF IMPROVEMENT AT FE, CE, & PE.
- SEE DETAILS FOR TREATMENT AND EXTENT OF IMPROVEMENT AT SIDE ROADS.

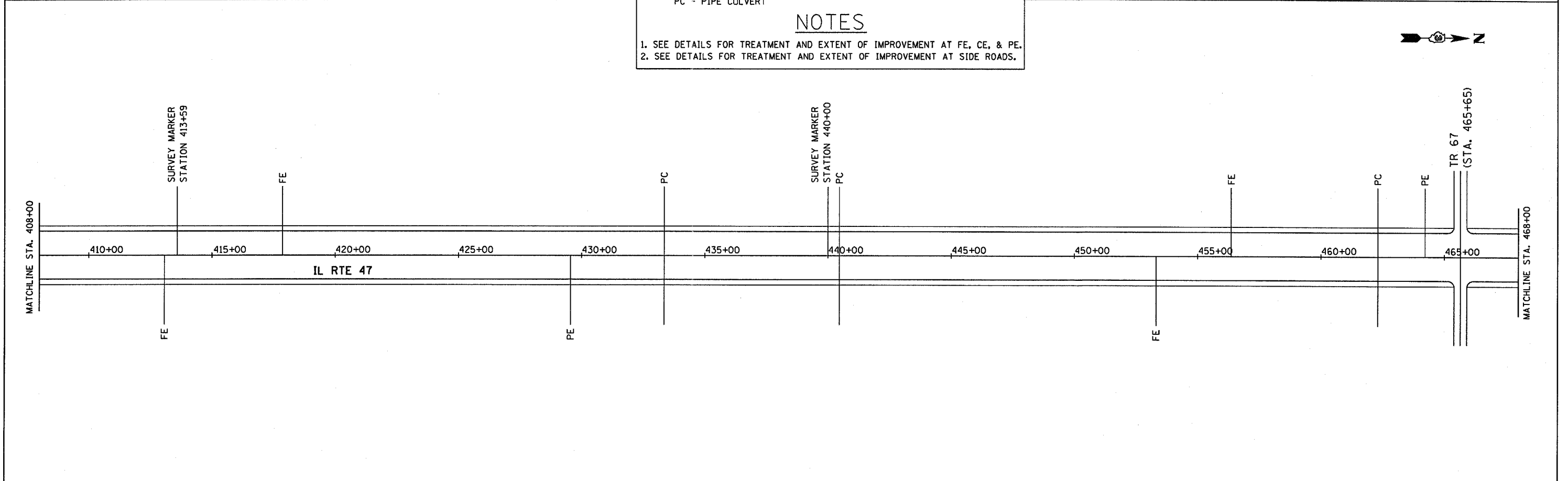

FILE NAME =	USER NAME = duncanbd	DESIGNED -	REVISED -DIST. 3 COMMENT	STATE OF ILLINOIS DEPARTMENT OF TRANSPORTATION	PROJECT LAYOUT	F.A.P. RTE.	SECTION	COUNTY	TOTAL SHEETS	SHEET NO.	
ca:\projects\ed02404\consult\oadd drawings\shtr\dj01.dgn	DRAWN - MAP	REVISED - 5/27/04				326		FORD	22	11	
PLOT SCALE = 200.0004' / IN.	CHECKED - RRM	REVISED - BDD 01/28/08				CONTRACT NO. 66423					
PLOT DATE = Mar 11, 2008 - 09:28:05 AM	DATE - 02/26/04	REVISED -				FED. ROAD DIST. NO. ILLINOIS FED. AID PROJECT					
				SCALE: N.T.S.		SHEET NO. 3 OF 5 SHEETS		STA. 348+00 TO STA. 468+00			

*(125)RS-5, (126)RS-3 & (127)RS-2