

**STATE OF ILLINOIS**  
**DEPARTMENT OF TRANSPORTATION**  
**DIVISION OF HIGHWAYS**  
**PROPOSED**  
**HIGHWAY PLANS**

FOR INDEX OF SHEETS, SEE SHEET NO. 2

**FAI ROUTE 255**  
**SECTION (60-8, 9)I, (60-9)RS**

**MADISON COUNTY**  
**PATCHING & RESURFACING**  
**C-98-095-08**

F.A.I. RTE.	SECTION	COUNTY	TOTAL SHEETS	SHEET NO.
255	(60-8, 9)I, (60-9)RS	MADISON	20	1
FED. ROAD DIST. NO.	ILLINOIS	CONTRACT NO. 76C22		

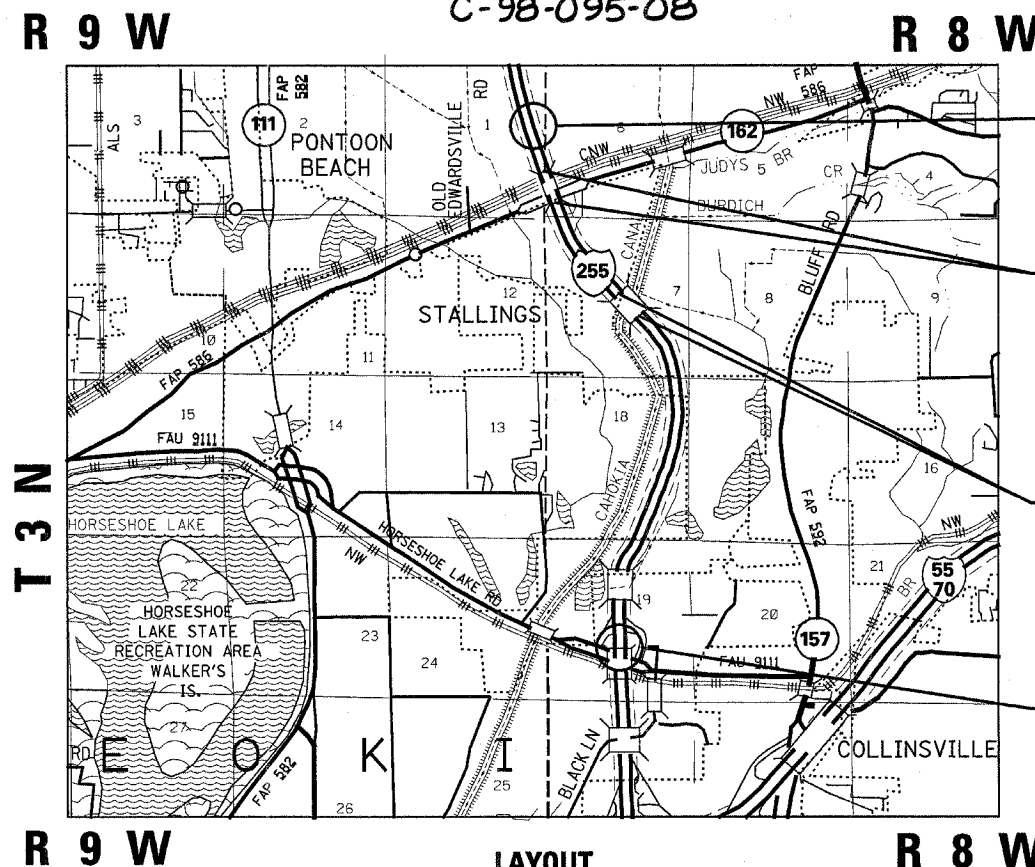
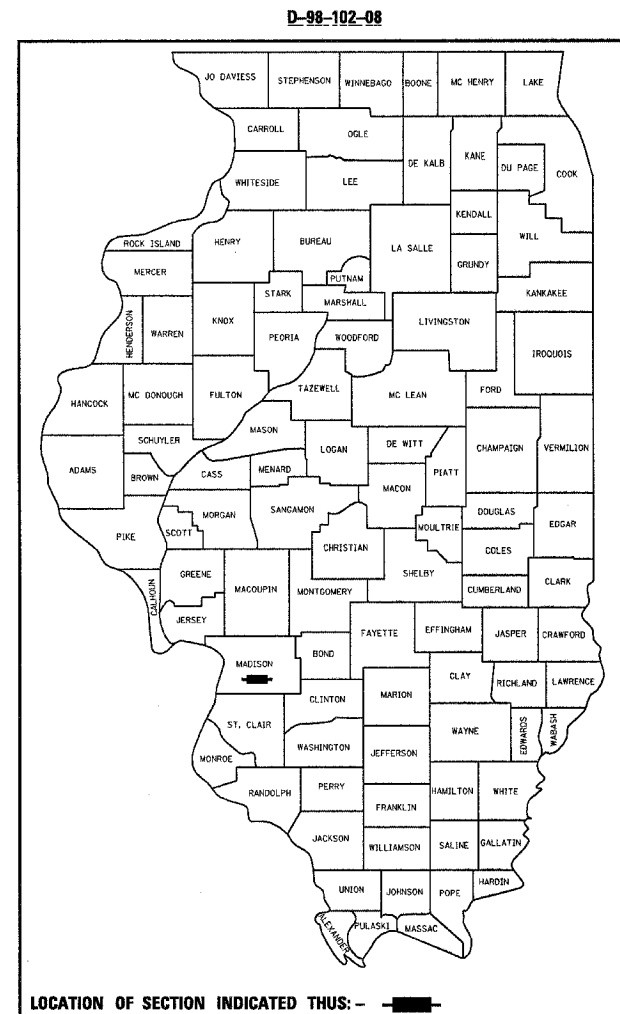

END PROJECT  
 STA 1556 + 40.00  
 LAT. = 38.73293  
 LONG. = -90.03818

BRIDGE OMISSION  
 S.N. 060-0221 NB  
 S.N. 060-0220 SB  
 STA 1525 + 64.00 TO  
 STA 1531 + 28.00  
 564 FT

BRIDGE OMISSION  
 S.N. 060-0218 NB  
 S.N. 060-0219 SB  
 STA 1477 + 05.00 TO  
 STA 1481 + 03.00  
 398 FT

BEGIN PROJECT  
 STA 1360 + 25.00  
 LAT. = 38.69077  
 LONG. = -90.03052

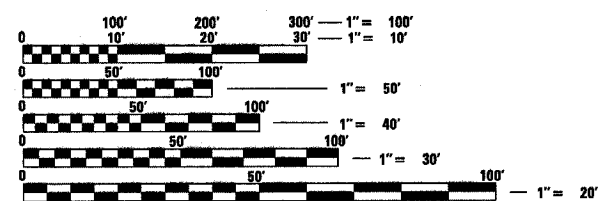

FULL SIZE PLANS HAVE BEEN PREPARED USING STANDARD ENGINEERING SCALES. REDUCED SIZED PLANS WILL NOT CONFORM TO STANDARD SCALES. IN MAKING MEASUREMENTS ON REDUCED PLANS, THE ABOVE SCALES MAY BE USED.

J.U.L.I.E.  
 JOINT UTILITY LOCATION INFORMATION FOR EXCAVATION  
 1-800-892-0123  
 OR 811

PROJECT ENGINEER: PATTI LEBEAU (618)346-3179  
 PROJECT MANAGER: CHERYL KEPLAR (618)346-3186

CONTRACT NO. 76C22

DESIGN DESIGNATION  
 I 255 - INTERSTATE  
 ADT 2007 (53,800)  
 ADT 2029 (67,000)  
 SU = 3.3%  
 MU = 17.7%

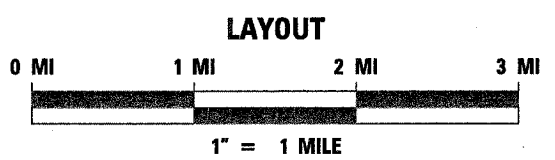

GROSS LENGTH - 19,615' = 3.71 MILES  
 NET LENGTH - 18,653' = 3.53 MILES

STATE OF ILLINOIS  
 DEPARTMENT OF TRANSPORTATION  
 DIVISION OF HIGHWAYS

SUBMITTED May 15 20 08  
May C. Romie  
 DEPUTY DIRECTOR OF HIGHWAYS, REGION ENGINEER

June 27 20 08  
Eric E. Hansen  
 ENGINEER OF DESIGN AND ENVIRONMENT

June 27 20 08  
Christine M. Reed  
 DIRECTOR OF HIGHWAYS, CHIEF ENGINEER

**PRINTED BY THE AUTHORITY  
 OF THE STATE OF ILLINOIS**

GENERAL NOTES

1 THE STANDARDS AND REVISION NUMBERS SHALL APPLY TO THIS PROJECT.

2 IF ANY SECTION OR SUB-SECTION MONUMENTS ARE ENCOUNTERED, THE ENGINEER SHALL BE NOTIFIED BEFORE SUCH MONUMENTS ARE REMOVED OR RESURFACED OVER. THE CONTRACTOR SHALL PROTECT AND CAREFULLY PRESERVE ALL PROPERTY MARKERS AND MONUMENTS UNTIL THE OWNER, AN AUTHORIZED SURVEYOR, OR AGENT HAS WITNESSED OR OTHERWISE REFERENCED THEIR LOCATION.

3 ILLINOIS STATE LAW REQUIRES A 48 HOUR NOTICE TO BE GIVEN TO UTILITIES BEFORE DIGGING. FIELD MARKING OF FACILITIES MAY BE OBTAINED BY CONTACTING J.U.L.I.E. OR FOR NON MEMBERS, THE UTILITY COMPANY DIRECTLY. AGENCIES KNOWN TO HAVE FACILITIES WITHIN THE PROJECT AREA ARE AS FOLLOWS:

UTILITY

- AMEREN IP
- AT&T ILLINOIS
- AT&T CORPORATION
- CENTERPOINT ENGERY
- CHARTER COMMUNICATIONS, INC
- CITY OF COLLINSVILLE
- CONSOLIDATED COMMUNICATIONS
- ILLINOIS AMERICAN WATER CO.
- MCLEOD USA/PAETEC TELECOMMUNICATIONS, INC.
- MADISON COUNTY SPECIAL SERVICE AREA #1
- SOUTHWESTERN ELECTRIC COOPERATIVE, INC.

MEMBERS OF J.U.L.I.E. (800)892-0123 ARE INDICATED BY \*. NON MEMBERS MUST BE NOTIFIED INDIVIDUALLY.

4 EXCESS BITUMEN REMOVAL SHALL BE PAID FOR ACCORDING TO ARTICLE 109.04 OF STANDARD SPECIFICATIONS.

5 THE THICKNESS OF THE HMA MIXTURE SHOWN ON THE PLANS IS THE NOMINAL THICKNESS. DEVIATIONS FROM THE NOMINAL THICKNESS WILL BE PERMITTED WHEN SUCH DEVIATIONS OCCUR DUE TO IRREGULARITIES IN THE IN THE EXISTING SURFACE OR BASE ON WHICH THE HMA MIXTURE IS PLACED.

6 THE MIXTURE REQUIREMENTS SHOWN ON THIS SHEET IN THE MIXTURE REQUIREMENTS CHART ARE APPLICABLE FOR THIS PROJECT.

7 EARTHWORK FOR THIS PROJECT CONSISTS OF 1 CUBIC YARDS OF EARTH EXCAVATION.

8 IF ANY UNSUITABLE MATERIAL IS ENCOUNTERED DURING CONSTRUCTION IT WILL BE NECESSARY TO REMOVE THE UNSUITABLE MATERIAL AND REPLACE IT WITH A SUITABLE MATERIAL AS APPROVED BY THE ENGINEER.

9 THE TOPO, PLAN DETAILS AND NOTES ON THE PLAN SHEETS APPLY ONLY TO THE ROADWAYS INDICATED IN THE TITLE BLOCK.

10 ANY REFERENCE TO BITUMINOUS CONCRETE SHALL BE CONSTRUED TO MEAN HMA.

11 ALL AREAS DISTURBED FOR ANY REASON SHALL BE SEEDED AND MULCHED AS DIRECTED BY THE ENGINEER. NUTRIENTS SHALL CONFORM TO ARTICLE 250.04 OF THE STANDARD SPECIFICATIONS.

12 SAW CUTTING ON ALL EDGES FOR REMOVAL ITEMS SHALL BE INCLUDED IN THE COST OF THE REMOVAL ITEM AS INDICATED AND IN ACCORDANCE WITH SECTION 440 OF THE STANDARD SPECIFICATIONS.

13 THE CONTRACTOR AND THE ENGINEER SHALL BE AWARE THAT NO SURVEY WAS PERFORMED FOR THIS PROJECT. THE STATIONING AND TOPO SHOWN IN THE PLANS WAS CREATED USING MICROFILM AND FIELD MEASUREMENTS MADE BY DESIGN PERSONNEL. BOTH SHALL BE CONSIDERED APPROXIMATE.

14 THE CONTRACTOR SHALL VERIFY ALL DIMENSIONS AND CONDITIONS IN THE FIELD PRIOR TO CONSTRUCTION AND ORDERING OF MATERIALS.

15 "ROAD CONSTRUCTION AHEAD" SIGNS SHALL BE PLACED AT THE BEGINNING OF THE PROJECT PLUS ALL INTERSECTING SIDE ROADS AND RAMPS AND WILL BE INCLUDED IN THE TRAFFIC CONTROL PAY ITEMS. ALL CONSTRUCTION SIGNS SHALL BE 48" FLOURESCENT ORANGE.

16 FLAGMEN SHALL BE PRESENT DURING ALL CLOSURE HOURS INCLUDING LUNCH HOUR AND NO ADDITIONAL COMPENSATION SHALL BE ALLOWED.

17 SHORT-TERM PAVEMENT MARKING SHALL BE APPLIED TO THE MILLED, PRIMED, AND FINAL HMA SURFACE. A QUANTITY FOR TEMPORARY PAVEMENT MARKING EQUAL TO THE AMOUNT OF PERMANENT PAVEMENT MARKING HAD BEEN INCLUDED IN THE PLANS. "WORK ZONE PAVEMENT MARKING REMOVAL" SHALL BE PAID FOR THE FINAL SURFAVE ONLY.

18 ALL TEMPORARY PAVEMENT MARKINGS SHALL BE PLACED IN SUCH A WAY AS NOT TO INTERFERE WITH THE PLACEMENT OF PERMANENT PAVEMENT MARKINGS.

INDEX OF SHEETS

1	COVER SHEET
2	INDEX OF SHEETS, GENERAL NOTES, HIGHWAY STANDARDS AND COMMITMENTS
3	SUMMARY OF QUANTITIES
4-9	TYPICAL SECTIONS
10-12	SCHEDULES
13-19	PLAN SHEETS
20	DETAILS

COMMITMENTS

NONE

MIXTURE REQUIREMENTS - SUPERPAVE PROJECT

ROUTE	FAI 255
SECTION	(60-8.9), (60-9)RS
COUNTY	MADISON
CONTRACT	76C22

DESCRIPTION:	RESURFACING AND PATCHING ON I-255 FROM HORSESHOE LAKE ROAD TO 0.5 MILES NORTH OF IL 162.
--------------	--

ADT (Construction Yr)	41200
MJ%:	10.4
SU%:	2.7
20 YR. ESA%:	26.84

MIXTURE USE	POLY SURFACE	BINDER / PATCHING	Partial Depth Patch	SHOULDERS	TOP LIFT SHOULDERS
AC/PG	SBS PG 76-22	PG 64-22	PG 64-22	PG 58-22	PG 58-22
RAP % (MAX)	10%	10%	10%	30%	30%
DESIGN AIR VOIDS	4.0% @ Ndes=80	4.0% @ Ndes=105	4.0% @ Ndes=105	2.0% @ Ndes=30	**2.0% @ Ndes=30
MIX COMPOSITION					
(GRADATION MIXTURE)					
FRICITION AGG	SMA	MIXTURE "B"	MIXTURE "C"	BAM	BAM

MIXTURE USE					
AC/PG					
RAP % (MAX)					
DESIGN AIR VOIDS					
MIX COMPOSITION					
(GRADATION MIXTURE)					
FRICITION AGG					

\*\* Top Lift Shoulders - Design this mix at 2.0% voids and add asphalt to reduce voids to 1.5%.

Plan quantities for Bituminous Concrete Surface Course Items are calculated using a unit weight of 112 lb/sq yd / m (59.8 kg/sq m/25 mm thickness).

HIGHWAY STANDARDS

- BLR 25
- 000001-05
- 001006
- 442001-03
- 442101-07
- 630001-07
- 630301-04
- 631011-04
- 631033-02
- 635006-02
- 635011-01
- 701101-01
- 701106-01
- 701400-02
- 701401-04
- 701406-04
- 701411-04
- 701426-02
- 701446
- 701901

FILE NAME =	USER NAME =	DESIGNED -	REVISED -	<b>STATE OF ILLINOIS DEPARTMENT OF TRANSPORTATION</b>	<b>GENERAL NOTES, INDEX OF SHEETS, HIGHWAY STANDARDS AND COMMITMENTS</b>	F.A.I. RTE.	SECTION	COUNTY	TOTAL SHEETS	SHEET NO.	
c:\projects\d876c22\design\d876c22-sh-	ernote.dgn	DRAWN -	REVISED -			255	(60-8.9), (60-9)RS	MADISON	20	2	
	PLT SCALE = 5/8"=1'-0" IN.	CHECKED -	REVISED -			CONTRACT NO. 76C22					
	PLT DATE = 7/2/2008	DATE -	REVISED -			FED. ROAD DIST. NO. ILLINOIS FED. AID PROJECT					
					SCALE: _____	SHEET NO. ___ OF ___ SHEETS		STA. _____ TO STA. _____			

# SUMMARY OF QUANTITIES

SUMMARY OF QUANTITIES			URBAN TOTAL QUANTITIES	CONSTRUCTION TYPE CODE			SUMMARY OF QUANTITIES			URBAN TOTAL QUANTITIES	CONSTRUCTION TYPE CODE		
CODE NO	ITEM	UNIT		I000 100% STATE	-----	-----	CODE NO	ITEM	UNIT		I000 100% STATE	-----	-----
20200100	EARTH EXCAVATION	CU YD	1	1		* 63100089	TRAFFIC BARRIER TERMINAL, TYPE 6B	EACH	1				
28100705	STONE DUMPED RIPRAP, CLASS A3	SQ YD	17	17		* 63100167	TRAFFIC BARRIER TERMINAL, TYPE 1 (SPECIAL) TANGENT	EACH	1				
31101200	SUB-BASE GRANULAR MATERIAL, TYPE B 4"	SQ YD	6	6		63200305	STEEL PLATE BEAM GUARD RAIL REMOVAL	FOOT	3942	3942			
40600982	HOT-MIX ASPHALT SURFACE REMOVAL - BUTT JOINT	SQ YD	858	858		66101150	HOT-MIX ASPHALT SHOULDER CURB	FOOT	3886	3886			
40600985	PORTLAND CEMENT CONCRETE SURFACE REMOVAL - BUTT JOINT	SQ YD	324	324		67100100	MOBILIZATION	L SUM	1	1			
40603095	<del>POLYMERIZED</del> HOT-MIX ASPHALT BINDER COURSE, IL-19.0, N105	TON	2720	2720		70100420	TRAFFIC CONTROL AND PROTECTION, STANDARD 701411	EACH	1	1			
44000300	CURB REMOVAL	FOOT	3886	3886		70100700	TRAFFIC CONTROL AND PROTECTION, STANDARD 701406	L SUM	1	1			
44200553	CLASS A PATCHES, TYPE II, 10 INCH	SQ YD	463	463		70100800	TRAFFIC CONTROL AND PROTECTION, STANDARD 701401	L SUM	1	1			
44200557	CLASS A PATCHES, TYPE III, 10 INCH	SQ YD	87	87		70100815	TRAFFIC CONTROL AND PROTECTION, STANDARD 701446	L SUM	1	1			
44200559	CLASS A PATCHES, TYPE IV, 10 INCH	SQ YD	175	175		* 78000200	THERMOPLASTIC PAVEMENT MARKING - LINE 4"	FOOT	12568	12568			
44200970	CLASS B PATCHES, TYPE II, 10 INCH	SQ YD	297	297		* 78100100	RAISED REFLECTIVE PAVEMENT MARKER	EACH	256	256			
44213000	PATCHING REINFORCEMENT	SQ YD	725	725		78300200	RAISED REFLECTIVE PAVEMENT MARKER REMOVAL	EACH	256	256			
44213200	SAW CUTS	FOOT	5129	5129		X4066580	POLYMERIZED HOT-MIX ASPHALT SURFACE COURSE, STONE MATRIX ASPHALT, N80	TON	2251	2251			
44300200	STRIP REFLECTIVE CRACK CONTROL TREATMENT	FOOT	312	312		X4421000	PARTIAL DEPTH PATCHING	TON	332	332			
48102100	AGGREGATE WEDGE SHOULDER, TYPE B	TON	1675	1675		X4422025	PARTIAL DEPTH REMOVAL 2"	SQ YD	2372	2372			
48203100	HOT-MIX ASPHALT SHOULDERS	TON	1329	1329		Z0017202	DOWEL BARS 1 1/2"	EACH	785	785			
* 63000000	STEEL PLATE BEAM GUARD RAIL, TYPE A	FOOT	3837.5	3837.5									
* 63100045	TRAFFIC BARRIER TERMINAL, TYPE 2	EACH	1	1									
* 63100070	TRAFFIC BARRIER TERMINAL, TYPE 5	EACH	1	1									
40600200	BITUMINOUS MATERIALS (PRIME COAT)	TON	14.3	14.3									
40600300	AGGREGATE (PRIME COAT)	TON	68.7	68.7									
44004250	PAVED SHOULDER REMOVAL	SQ YD	6	6									
48203037	HOT-MIX ASPHALT SHOULDERS, 10"	SQ YD	6	6									
70300100	SHORT-TERM PAVEMENT MARKING	FOOT	2624	2624									
70300220	TEMPORARY PAVEMENT MARKING - LINE 4"	FOOT	12,568	12,568									
70301000	WORK ZONE PAVEMENT MARKING REMOVAL	SQ FT	438	438									
78201000	TERMINAL MARKER - DIRECT APPLIED	EACH	1	1									
X0326163	PORTLAND CEMENT CONCRETE SURFACE REMOVAL-1"	SQ YD	3350	3350									

\* Specialty Items



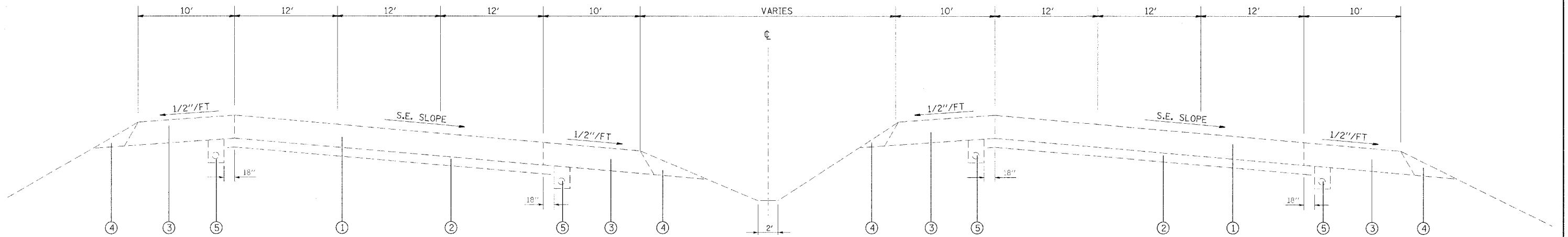

**F.A.I. 255  
TYPICAL SECTION**

SB. & NB. STA. 1387+05.67 TO STA. 1401+50.93  
 SB. & NB. STA. 1440+89.60 TO STA. 1457+45  
 SB. & NB. STA. 1457+45 TO STA. 1473+35.70  
 SB. STA. 1509+78 TO STA. 1512+99.39  
 NB. STA. 1511+00 TO STA. 1512+99.39

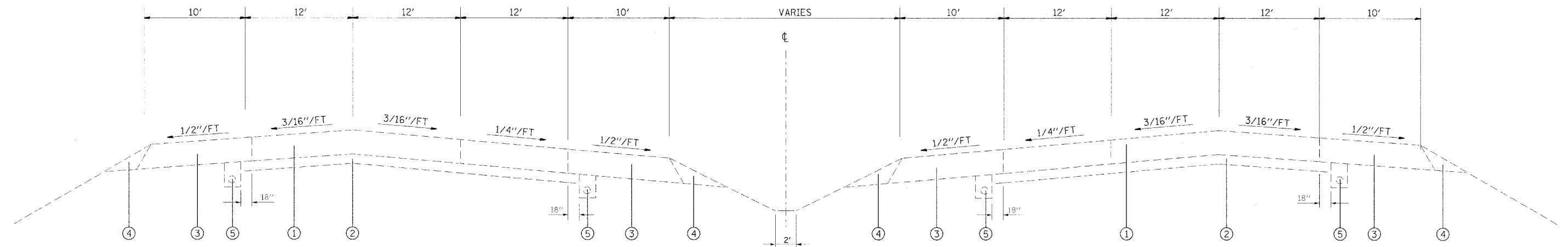

**F.A.I. 255  
TYPICAL SECTION**

NB. STA. 1371+40.00 TO STA. 1375+33.76  
 SB. STA. 1383+76.90 TO STA. 1387+05.67  
 SB. & NB. STA. 1401+50.93 TO STA. 1440+89.60  
 SB. STA. 1473+35.70 TO STA. 1476+80.50  
 NB. STA. 1473+35.70 TO STA. 1477+24.20  
 SB. STA. 1480+84.66 TO STA. 1498+39.30  
 NB. STA. 1481+28.36 TO STA. 1499+19.29  
 SB. STA. 1512+99.39 TO STA. 1523+70.00  
 NB. STA. 1512+99.39 TO STA. 1522+79.80

- ① EXISTING 10" C.R.P.C.C. PAVEMENT
- ② EXISTING 4" STABILIZED SUB-BASE
- ③ EXISTING HMA SHOULDERS 10"
- ④ EXISTING AGGREGATE SHOULDER, TYPE B
- ⑤ EXISTING PIPE UNDERDRAIN 4"
- ⑥ PROPOSED PCC SURFACE REMOVAL 1"
- ⑦ PROPOSED POLYMERIZED HMA SURFACE COURSE, 2"
- ⑧ PROPOSED HMA BINDER COURSE 2.25"
- ⑨ PROPOSED HMA BINDER COURSE 1"
- ⑩ PROPOSED AGGREGATE SHOULDER WEDGE, TYPE B
- ⑪ PROPOSED STRIP REFLECTIVE CRACK CONTROL
- ⑫ PROPOSED HMA SHOULDERS, 4.25"

FILE NAME =	USER NAME = bergmd	DESIGNED -	REVISED -	<b>STATE OF ILLINOIS DEPARTMENT OF TRANSPORTATION</b>	<b>EXISTING TYPICAL SECTIONS</b>			F.A.I. RTE.	SECTION	COUNTY	TOTAL SHEETS	SHEET NO.
ct\projects\14976c22\design\14976c22-shs	project\egn	DRAWN -	REVISED -		SCALE: _____	SHEET NO. _____ OF _____ SHEETS	STA. _____ TO STA. _____	255	160-8,911, 160-918S	MADISON	20	5
		CHECKED -	REVISED -					<b>CONTRACT NO. 76C22</b>				
		DATE -	REVISED -					FED. ROAD DIST. NO. ILLINOIS FED. AID PROJECT				

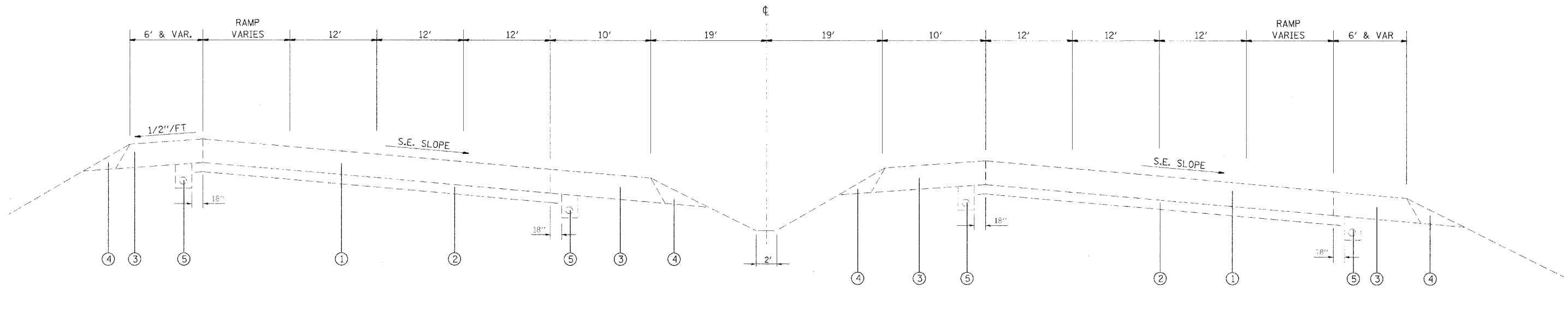

F.A.I. 255  
 TYPICAL SECTION  
 SB. STA. 1498+39.30 TO STA. 1509+78.00  
 NB. STA. 1499+19.29 TO STA. 1511+00.00

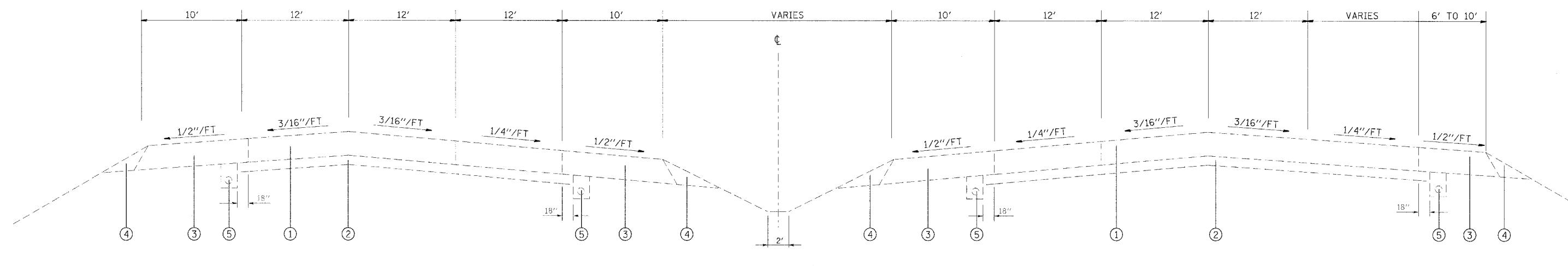

F.A.I. 255  
 TYPICAL SECTION  
 SB. STA. 1523+70.00 TO STA. 1526+00.38  
 NB. STA. 1522+79.80 TO STA. 1526+03.12

- ① EXISTING 10" C.R.P.C.C. PAVEMENT
- ② EXISTING 4" STABILIZED SUB-BASE
- ③ EXISTING HMA SHOULDERS 10"
- ④ EXISTING AGGREGATE SHOULDER, TYPE B
- ⑤ EXISTING PIPE UNDERDRAIN 4"
- ⑥ PROPOSED PCC SURFACE REMOVAL 1"
- ⑦ PROPOSED POLYMERIZED HMA SURFACE COURSE, 2"
- ⑧ PROPOSED HMA BINDER COURSE 2.25"
- ⑨ PROPOSED HMA BINDER COURSE 1"
- ⑩ PROPOSED AGGREGATE SHOULDER WEDGE, TYPE B
- ⑪ PROPOSED STRIP REFLECTIVE CRACK CONTROL
- ⑫ PROPOSED HMA SHOULDERS, 4.25"

FILE NAME =	USER NAME = bengmc	DESIGNED -	REVISED -	<b>STATE OF ILLINOIS DEPARTMENT OF TRANSPORTATION</b>	<b>EXISTING TYPICAL SECTIONS</b>	F.A.I. RTE.	SECTION	COUNTY	TOTAL SHEETS	SHEET NO.
PROJECT PATH =	DESIGNER =	DRAWN -	REVISED -			255	160-8,9,11, 160-9/BS	MADISON	20	6
PLOT SCALE = 50.0000' / IN.	CHECKED -	REVISED -	REVISED -			CONTRACT NO. 16C22				
PLOT DATE = 7/2/2008	DATE -	REVISED -	REVISED -			FED. ROAD DIST. NO. ILLINOIS FED. AID PROJECT				

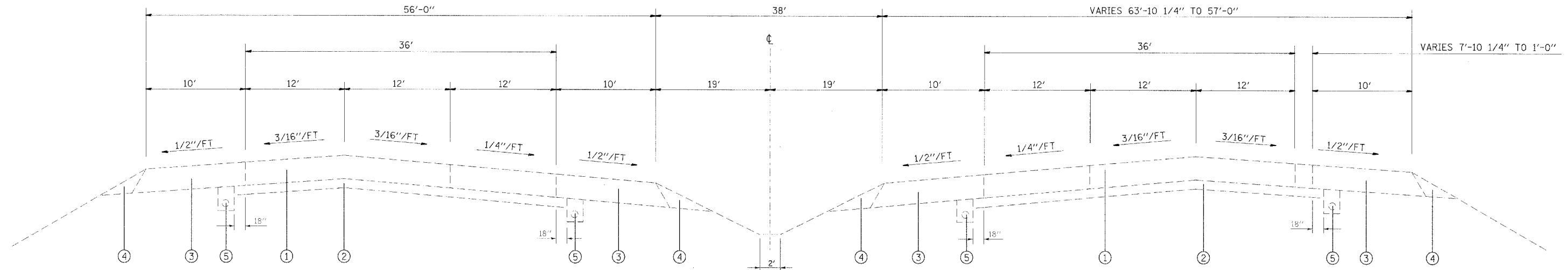

F.A.I. 255  
 TYPICAL SECTION  
 SB. & NB. STA. 1530+95.88 TO STA. 1534+40.00

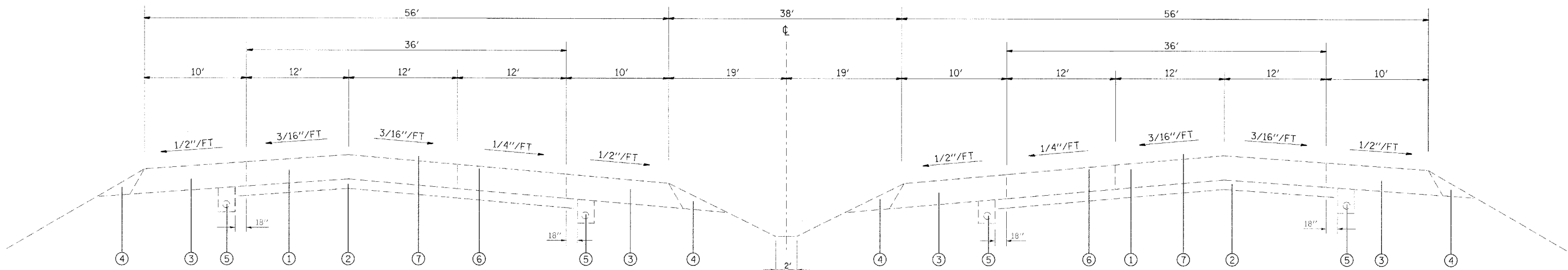

F.A.I. 255  
 TYPICAL SECTION  
 NB. STA. 1534+40.00 TO STA. 1556+40.00  
 SB. STA. 1534+40.00 TO STA. 1556+40.00

- ① EXISTING 10" C.R.P.C.C. PAVEMENT
- ② EXISTING 4" STABILIZED SUB-BASE
- ③ EXISTING HMA SHOULDERS 10"
- ④ EXISTING AGGREGATE SHOULDER, TYPE B
- ⑤ EXISTING PIPE UNDERDRAIN 4"
- ⑥ PROPOSED PCC SURFACE REMOVAL 1"
- ⑦ PROPOSED POLYMERIZED HMA SURFACE COURSE, 2"
- ⑧ PROPOSED HMA BINDER COURSE 2.25"
- ⑨ PROPOSED HMA BINDER COURSE 1"
- ⑩ PROPOSED AGGREGATE SHOULDER WEDGE, TYPE B
- ⑪ PROPOSED STRIP REFLECTIVE CRACK CONTROL
- ⑫ PROPOSED HMA SHOULDERS, 4.25"

FILE NAME =	USER NAME = bergmd	DESIGNED -	REVISED -	<b>STATE OF ILLINOIS DEPARTMENT OF TRANSPORTATION</b>	<b>EXISTING TYPICAL SECTIONS</b>		F.A.I. RTE.	SECTION	COUNTY	TOTAL SHEETS	SHEET NO.	
cd:\projects\vd976c22\design\ds76c22-sht	sjpica.dgn	DRAWN -	REVISED -		SCALE: _____	SHEET NO. _____ OF _____ SHEETS	STA. _____ TO STA. _____	255	(60-8,9)I..(60-9)BS	MADISON	20	7
		CHECKED -	REVISED -					CONTRACT NO. 76C22				
		DATE -	REVISED -					FED. ROAD DIST. NO. ILLINOIS FED. AID PROJECT				

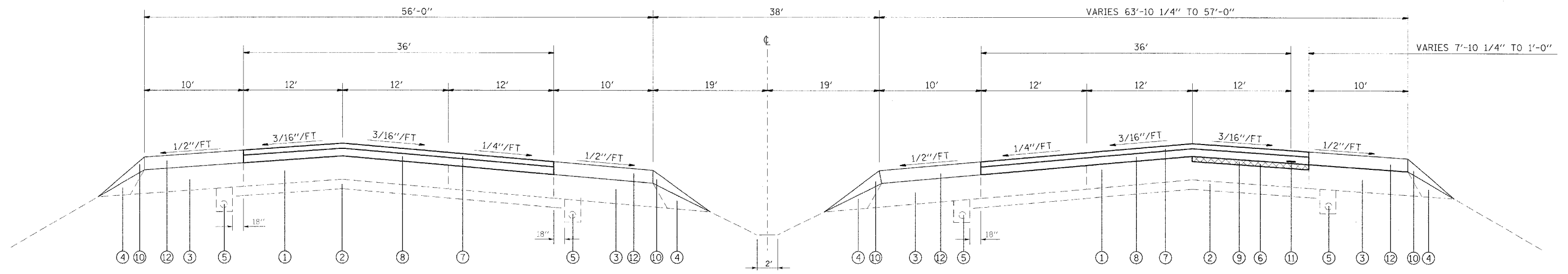

F.A.I. 255  
 TYPICAL SECTION  
 SB. & NB. STA. 1531+28.00 TO STA. 1534+40.00

- ① EXISTING 10" C.R.P.C.C. PAVEMENT
- ② EXISTING 4" STABILIZED SUB-BASE
- ③ EXISTING HMA SHOULDERS 10"
- ④ EXISTING AGGREGATE SHOULDER, TYPE B
- ⑤ EXISTING PIPE UNDERDRAIN 4"
- ⑥ PROPOSED PCC SURFACE REMOVAL 1"
- ⑦ PROPOSED POLYMERIZED HMA SURFACE COURSE, 2"
- ⑧ PROPOSED HMA BINDER COURSE 2.25"
- ⑨ PROPOSED HMA BINDER COURSE 1"
- ⑩ PROPOSED AGGREGATE SHOULDER WEDGE, TYPE B
- ⑪ PROPOSED STRIP REFLECTIVE CRACK CONTROL
- ⑫ PROPOSED HMA SHOULDERS, 4.25"

FILE NAME =	USER NAME = bergnd	DESIGNED -	REVISED -	<b>STATE OF ILLINOIS DEPARTMENT OF TRANSPORTATION</b>	<b>PROPOSED TYPICAL SECTIONS</b>			F.A.I. RTE.	SECTION	COUNTY	TOTAL SHEETS	SHEET NO.
ct:\p\projects\d876c22\design\d876c22-sht-typical.dgn	PLOT SCALE = 50.0000' / IN.	DRAWN -	REVISED -					255	(60-8,9)1, (60-9)BS	MADISON	20	8
	PLOT DATE = 7/2/2038	CHECKED -	REVISED -		CONTRACT NO. 76C22			FED. ROAD DIST. NO. ILLINOIS FED. AID PROJECT				
		DATE -	REVISED -		SCALE: _____	SHEET NO. _____ OF _____ SHEETS	STA. _____ TO STA. _____					



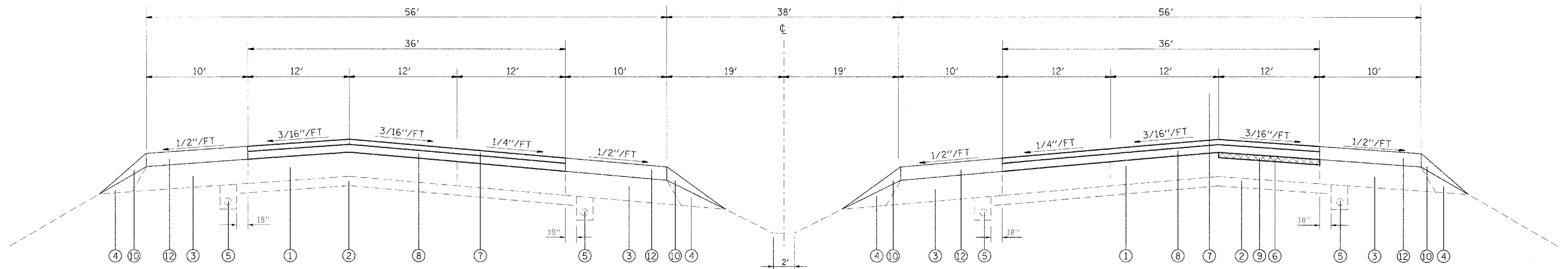

F.A.I. 255  
 TYPICAL SECTION  
 NB. STA. 1534+40.00 TO STA. 1556+40.00  
 SB. STA. 1534+40.00 TO STA. 1556+40.00

- ① EXISTING 10" C.R.P.C.C. PAVEMENT
- ② EXISTING 4" STABILIZED SUB-BASE
- ③ EXISTING HMA SHOULDERS 10"
- ④ EXISTING AGGREGATE SHOULDER, TYPE B
- ⑤ EXISTING PIPE UNDERDRAIN 4"
- ⑥ PROPOSED PCC SURFACE REMOVAL 1"
- ⑦ PROPOSED POLYMERIZED HMA SURFACE COURSE, 2"
- ⑧ PROPOSED HMA BINDER COURSE 2.25"
- ⑨ PROPOSED HMA BINDER COURSE 1"
- ⑩ PROPOSED AGGREGATE SHOULDER WEDGE, TYPE B
- ⑪ PROPOSED STRIP REFLECTIVE CRACK CONTROL
- ⑫ PROPOSED HMA SHOULDERS, 4.25"

USER NAME = bergmd PLT SCALE = 50.0000' / IN. PLOT DATE = 7/2/2009	DESIGNED - DRAWN - CHECKED - DATE -	REVISED - REVISED - REVISED - REVISED -	STATE OF ILLINOIS DEPARTMENT OF TRANSPORTATION	PROPOSED TYPICAL SECTIONS	<table border="1" style="width: 100%; border-collapse: collapse;"> <tr> <th>F.A.I. RTE.</th> <th>SECTION</th> <th>COUNTY</th> <th>TOTAL SHEETS</th> <th>SHEET NO.</th> </tr> <tr> <td>255</td> <td>160-8,911, 160-918S</td> <td>MADISON</td> <td>20</td> <td>9</td> </tr> <tr> <td colspan="5" style="text-align: center; font-weight: bold;">CONTRACT NO. 76C22</td> </tr> </table>	F.A.I. RTE.	SECTION	COUNTY	TOTAL SHEETS	SHEET NO.	255	160-8,911, 160-918S	MADISON	20	9	CONTRACT NO. 76C22				
F.A.I. RTE.	SECTION	COUNTY	TOTAL SHEETS	SHEET NO.																
255	160-8,911, 160-918S	MADISON	20	9																
CONTRACT NO. 76C22																				
			SCALE: _____ SHEET NO. ___ OF ___ SHEETS STA. _____ TO STA. _____		FED. ROAD DIST. NO. _____ ILLINOIS FED. AID PROJECT															

PARTIAL DEPTH PATCHING SCHEDULE (MAINLINE)							
LOCATION	NB/SB	LANE	LENGTH	WIDTH	PARTIAL DEPTH REMOVAL 2"	PARTIAL DEPTH PATCHING	
			(FT)	(FT)	SQ YD	TONS	
MAINLINE I-255 NB							
MP	25.80	NB	2	60	2	13.3	1.5
MP	26.35	NB	4	100	4	44.4	4.98
MP	26.35	NB	4	240	4	106.7	11.95
MP	26.45	NB	4	200	9	200.0	22.40
MP	28.75	NB	4	80	2	17.8	1.99
MAINLINE I-255 SB							
MP	26.90	SB	2	40	12	53.3	5.97
MP	26.90	SB	3	40	12	53.3	5.97
MP	28.40	SB	1	160	6	106.7	11.95
MP	28.70	SB	4	280	4	124.4	13.94
MP	29.25	SB	3	340	6	226.7	25.39
MP	29.60	SB	3	240	6	160.0	17.92
MAINLINE SUB TOTAL:						1106.7	123.9

PARTIAL DEPTH PATCHING SCHEDULE (HORSESHOE LAKE RD.)							
LOCATION	NB/SB	LANE	LENGTH	WIDTH	PARTIAL DEPTH REMOVAL 2"	PARTIAL DEPTH PATCHING	
			(FT)	(FT)	SQ YD	TONS	
RAMPS I-255							
I-255 NB TO HORSESHOE LAKE RD. (MILE STA. 0.00 AT RAMP GORE ON I-255)							
MP	0.00	NB		40	2	8.9	1.00
MP	0.10	NB		20	2	4.4	0.50
MP	0.15	NB		200	2	44.4	4.98
MP	0.20	NB		200	2	44.4	4.98
MP	0.22	NB		400	2	88.9	9.96
MP	0.26	NB		40	2	8.9	1.00
MP	0.30	NB		30	2	6.7	0.75
MP	0.32	NB		320	4	142.2	15.93
MP	0.35	NB					
END OF RAMP PAVEMENT							
HORSESHOE LAKE RD. TO NB I-255 (MILE STA. 0.00 AT START OF RAMP PAVEMENT)							
MP	0.00	NB		200	3	66.7	7.47
MP	0.10	NB		150	2	33.3	3.73
MP	0.15	NB		130	2	28.9	3.24
MP	0.17	NB		90	2	20.0	2.24
MP	0.20	NB		250	2	55.6	6.22
MP	0.35	NB		200	2	44.4	4.98
MP	0.45	NB					
RAMP GORE ON I-255 NB							
I-255 SB TO HORSESHOE LAKE RD. (MILE STA. 0.00 AT RAMP GORE ON I-255)							
MP	0.20	SB		2	16	3.6	0.40
MP	0.21	SB		40	2	8.9	1.00
MP	0.22	SB		100	2	22.2	2.49
MP	0.35	SB					
END OF RAMP PAVEMENT							
HORSESHOE LAKE RD. TO I-255 SB (MILE STA. 0.00 AT START OF RAMP PAVEMENT)							
MP	0.00	SB		50	3	16.7	1.87
MP	0.02	SB		4	16	7.1	0.80
MP	0.03	SB		20	3	6.7	0.75
MP	0.03	SB		4	16	7.1	0.80
MP	0.05	SB		150	3	50.0	5.60
MP	0.13	SB		70	2	15.6	1.74
MP	0.14	SB		200	3	66.7	7.47
MP	0.25	SB					
RAMP GORE ON I-255 SB							
SUB TOTAL:						802.2	89.8

PARTIAL DEPTH PATCHING SCHEDULE (IL 162)							
LOCATION	NB/SB	LANE	LENGTH	WIDTH	PARTIAL DEPTH REMOVAL 2"	PARTIAL DEPTH PATCHING	
			(FT)	(FT)	SQ YD	TONS	
I-255 NB TO IL 162 (MILE STA. 0.00 AT RAMP GORE ON I-255)							
MP	0.00	NB		4	16	7.1	0.80
MP	0.05	NB		130	3	43.3	4.85
MP	0.05	NB		100	3	33.3	3.73
MP	0.06	NB		4	16	7.1	0.80
MP	0.10	NB		520	2	115.6	12.94
MP	0.21	NB		2	16	3.6	0.40
MP	0.21	NB		120	2	26.7	2.99
MP	0.25	NB		40	3	13.3	1.49
MP	0.28	NB		160	3	53.3	5.97
MP	0.35	NB					
END OF RAMP PAVEMENT							
IL 162 TO I-255 NB (MILE STA. 0.00 AT START OF RAMP PAVEMENT)							
MP	0.02	NB		2	16	3.6	0.40
MP	0.10	NB		2	16	3.6	0.40
MP	0.11	NB		20	2	4.4	0.50
MP	0.15	NB		40	2	8.9	1.00
MP	0.25	NB					
RAMP GORE ON I-255 SB							
I-255 SB TO IL 162 (MILE STA. 0.00 AT RAMP GORE ON I-255)							
MP	0.00	SB		100	2	22.2	2.49
MP	0.15	SB		60	2	13.3	1.49
MP	0.18	SB		80	2	17.8	1.99
MP	0.22	SB		40	2	8.9	1.00
MP	0.25	SB		40	2	8.9	1.00
MP	0.30	SB		20	3	6.7	0.75
MP	0.31	SB					
END OF RAMP PAVEMENT							
IL 162 TO I-255 SB (MILE STA. 0.00 AT START OF RAMP PAVEMENT)							
MP	0.10			2	16	3.6	0.40
MP	0.12			30	2	6.7	0.75
MP	0.15			80	2	17.8	1.99
MP	0.16			50	2	11.1	1.24
MP	0.20			3	16	5.3	0.60
MP	0.22			30	3	10.0	1.12
MP	0.26			30	2	6.7	0.75
MP	0.35						
RAMP GORE ON I-255 SB							
IL 162 SUB TOTAL:						462.7	51.8
HORSESHOE LAKE RD. SUB TOTAL:						802.2	89.8
MAINLINE SUB TOTAL:						1106.7	123.9
ANTICIPATED FAILURES:						0	66
TOTALS:						2371.6	332

CLASS B PATCHING SCHEDULE							
LOCATION	NB/SB	LANE	CLASS B PATCHES 10"			DOWEL BARS 1 1/2"	
			LENGTH (FT)	WIDTH (FT)	TYPE II (SQ YDS)		
I 255 NB RAMP TO HORSESHOE LAKE RD.							
MP	0.15	NB	6	16	10.7	28	
MP	0.18	NB	6	16	10.7	28	
MP	0.20	NB	6	16	10.7	28	
MP	0.20	NB	6	8	5.3	12	
MP	0.20	NB	6	16	10.7	28	
MP	0.22	NB	6	16	10.7	28	
MP	0.25	NB	6	16	10.7	28	
MP	0.27	NB	6	16	10.7	28	
MP	0.35	NB	END OF RAMP PAVEMENT				
HORSESHOE LAKE RD. RAMP TO I 255 NB							
MP	0.22	NB	6	16	10.7	28	
MP	0.24	NB	6	16	10.7	28	
MP	0.25	NB	6	16	10.7	28	
MP	0.45	NB	RAMP GORE ON I 255 NB				
HORSESHOE LAKE RD. RAMP TO I 255 SB							
MP	0.01	SB	6	16	10.7	28	
MP	0.03	SB	6	16	10.7	28	
MP	0.06	SB	6	16	10.7	28	
MP	0.14	SB	6	16	10.7	28	
MP	0.22	SB	6	16	10.7	28	
MP	0.25	SB	RAMP GORE ON I 255 SB				
I 255 NB TO IL 162							
MP	0.00	NB	6	16	10.7	28	
MP	0.20	NB	6	16	10.7	28	
MP	0.35	NB	END OF RAMP PAVEMENT				
I 255 SB TO IL 162							
MP	0.17	SB	6	16	10.7	28	
MP	0.18	SB	6	16	10.7	28	
MP	0.22	SB	6	16	10.7	28	
MP	0.31	SB	END OF RAMP PAVEMENT				
IL 162 TO I 255 SB							
MP	0.00	SB	6	16	10.7	28	
MP	0.25	SB	6	16	10.7	28	
MP	0.35	SB	RAMP ON I 255 NB				
SUB TOTALS:						240	628
ANTICIPATED FAILURES						57	157
TOTALS:						297	785

CLASS A PATCHING SCHEDULE NB									
LOCATION	NB/SB	LANE	CLASS A PATCHES 10"					PATCHING REINFORCEMENT (SQ YDS)	
			LENGTH (FT)	WIDTH (FT)	TYPE II (SQ YDS)	TYPE III (SQ YDS)	TYPE IV (SQ YDS)		
MAINLINE I 255 NB									
MP	25.75	NB	2	6	12	8.0			8.0
MP	25.85	NB	4	6	12	8.0			8.0
MP	26.00	NB	2	6	12	8.0			8.0
MP	26.00	NB	3	6	12	8.0			8.0
MP	26.00	NB	4	6	20	13.3			13.3
MP	26.05	NB	3	6	12	8.0			8.0
MP	26.45	NB	3	8	12	10.7			10.7
MP	28.10	NB	2	6	12	8.0			8.0
MP	28.20	NB	2	6	12	8.0			8.0
MP	28.20	NB	3	6	12	8.0			8.0
MP	28.20	NB	1	6	12	8.0			8.0
MP	28.20	NB	2	6	12	8.0			8.0
MP	28.35	NB	1	6	12	8.0			8.0
MP	28.35	NB	2	6	12	8.0			8.0
MP	29.10	NB	1	6	12	8.0			8.0
MP	29.10	NB	3	6	12	8.0			8.0
CENTER OF 162 STRUCTURE									
MP	29.15	NB							
MP	29.23	NB	1	6	12	8.0			8.0
MP	29.23	NB	2	6	12	8.0			8.0
MP	29.23	NB	3	6	12	8.0			8.0
MP	29.25	NB	1	6	12	8.0			8.0
MP	29.25	NB	3	40	12			53.3	53.3
MP	29.60	NB	3	6	12	8.0			8.0
MP	29.65	NB	3	6	12	8.0			8.0
SUB TOTALS NB:						184.3	0	53.3	237.3

CLASS A PATCHING SCHEDULE SB									
LOCATION	NB/SB	LANE	CLASS A PATCHES 10"					PATCHING REINFORCEMENT (SQ YDS)	
			LENGTH (FT)	WIDTH (FT)	TYPE II (SQ YDS)	TYPE III (SQ YDS)	TYPE IV (SQ YDS)		
MAINLINE I 255 SB									
MP	25.90	SB	3	6	12	8.0			8.0
MP	26.00	SB	3	8	12	10.7			10.7
MP	26.05	SB	3	12	12		16.0		16.0
MP	26.30	SB	3	8	12	10.7			10.7
MP	26.35	SB	3	20	12			26.7	26.7
MP	26.40	SB	3	25	12			33.3	33.3
MP	26.45	SB	3	8	12	10.7			10.7
MP	26.50	SB	3	6	12	8.0			8.0
MP	26.70	SB	3	6	12	8.0			8.0
MP	26.90	SB	3	6	12	8.0			8.0
MP	27.20	SB	3	10	12	13.3			13.3
MP	27.50	SB	3	20	12			26.7	26.7
MP	27.65	SB	3	6	12	8.0			8.0
MP	28.20	SB	2	12	12		16.0		16.0
MP	28.20	SB	3	6	12	8.0			8.0
CENTER OF CAHOKIA CANAL STRUCTURE									
MP	28.25	SB							
MP	28.30	SB	3	6	12	8.0			8.0
MP	28.35	SB	3	6	12	8.0			8.0
MP	28.35	SB	3	10	12	13.3			13.3
MP	28.40	SB	1	6	12	8.0			8.0
MP	28.40	SB	3	16	12		21.3		21.3
MP	29.10	SB	1	6	12	8.0			8.0
MP	29.10	SB	2	6	12	8.0			8.0
MP	29.10	SB	3	6	12	8.0			8.0
MP	29.20	SB	2	12	12		16.0		16.0
MP	29.25	SB	3	6	12	8.0			8.0
MP	29.30	SB	1	6	12	8.0			8.0
MP	29.35	SB	1	6	12	8.0			8.0
MP	29.65	SB	1	6	12	8.0			8.0
SUB TOTAL FOR SB:						186.7	70	86.7	342.7
SUB TOTAL FOR NB:						184.3	0	53.3	237.3
ANTICIPATED FAILURES						93	17	35	145
TOTALS:						463	87	175	725

STRIP REFLECTIVE CRACK CONTROL SCHEDULE						
LOCATION				NB/SB	STRIP REFLECTIVE CRACK CONTROL	
					FOOT	
STA.	1531+28	TO	STA. 1534+40	NB	312	
TOTAL:					312	

GUARDRAIL SCHEDULE											
LOCATION				NB/SB	STEEL PLATE BEAM GUARDRAIL REMOVAL	TRAFFIC BARRIER TERMINAL, TYPE 1 (SPECIAL) TANGENT	TRAFFIC BARRIER TERMINAL, TYPE 6B	TRAFFIC BARRIER TERMINAL, TYPE 5	TRAFFIC BARRIER TERMINAL, TYPE 2	STEEL PLATE BEAM GUARDRAIL TYPE A	TERMINAL MARKER - DIRECT APPLIED
					FOOT	EACH	EACH	EACH	EACH	FOOT	EACH
STA.	1530+04	TO	STA. 1549+75	NB SB	3942	1	1	1	1	3837.5	1
TOTAL:					3942	1	1	1	1	3837.5	1

BUTT JOINT SCHEDULE						
STATION				NB/SB	HMA SURFACE REMOVAL-BUTT JOINT	PCC SURFACE REMOVAL-BUTT JOINT
LENGTH WIDTH LOCATION					SQYD	SQYD
1531+28	40	24	LT & CTR LNS	NB		106.7
1531+28	20	12	RT LN	NB		26.7
1531+28	6.8	40	RMP TPR	NB		30.2
1531+28	10	40	RT SHLDR	NB	44.4	
1531+28	6	40	LT SHLDR	NB	26.7	
1556+40	20	40	LT & RT SHLDR	NB	88.9	
1556+40	36	65	LT, CTR & RT LNS	NB	260.0	
1531+28	36	40	LT, CTR & RT LNS	SB		160.0
1531+28	20	40	LT & RT SHLDR	SB	88.9	
1556+40	36	65	LT, CTR & RT LNS	SB	260.0	
1556+40	20	40	LT & RT SHLDR	SB	88.9	
TOTAL:					857.8	323.6

SHOULDER REPAIR SCHEDULE							
LOCATION		NB/SB	EARTH EXCAVATION	SUB-BASE GRANULAR MATERIAL, TYPE B, 4"	STONE DUMPED RIP RAP, CLASS A3	HMA SHOULDERS, 10"	PAVED SHOULDER REMOVAL
			FOOT	SQ YD	SQ YD	SQ YD	SQ YD
STA.	1539+50	NB	0.6	6	17	6	6
TOTALS:			0.6	6	17	6	6

PAVEMENT MARKING SCHEDULE								
LOCATION				NB/SB	RAISED REFLECTIVE PAVEMENT MARKER REMOVAL	RAISED REFLECTIVE PAVEMENT MARKER	THERMOPLASTIC PAVEMENT MARKINGS LINE 4"	
					EACH	EACH	WHITE EDGE LINE	WHITE SKIP DASH
							FOOT	FOOT
STA.	1531+28	TO	STA. 1556+40	NB/SB	256	256	10048	2520
TOTAL:					256	256	12568	

MILLING SCHEDULE						
LOCATION				LANE	NB/SB	PCC SURFACE REMOVAL 1"
						SQYD
STA.	1531+28	TO	STA. 1556+40	RT	NB	3349.3
TOTAL:						3349.3

PAVING SCHEDULE										
LOCATION				NB/SB	BITUMINOUS MATERIAL (PRIME COAT)	AGGREGATE (PRIME COAT)	HMA BINDER COURSE, IL-19.0, N105	AGGREGATE WEDGE SHOULDER, TYPE B	HMA SHOULDERS	POLY, HMA SURFACE CRSE, STONE MATRIX ASPHALT, N80
					TON	TON	TON	TON	TON	TON
STA.	1531+28	TO	STA. 1556+40	NB SB	12.58	60.29	2110.08	1674.67	1328.57	2250.75
STA.	1531+28	TO	STA. 1556+40	NB SB	1.75	8.37	609.58			
TOTAL:					14.32	68.7	2720	1675	1329	2251

CURB SCHEDULE						
LOCATION				NB/SB	CURB REMOVAL	HMA SHOULDER CURB
					FOOT	FOOT
STA.	1530+12	TO	STA. 1549+55	NB/SB	3886	3886
TOTAL:					3886	3886

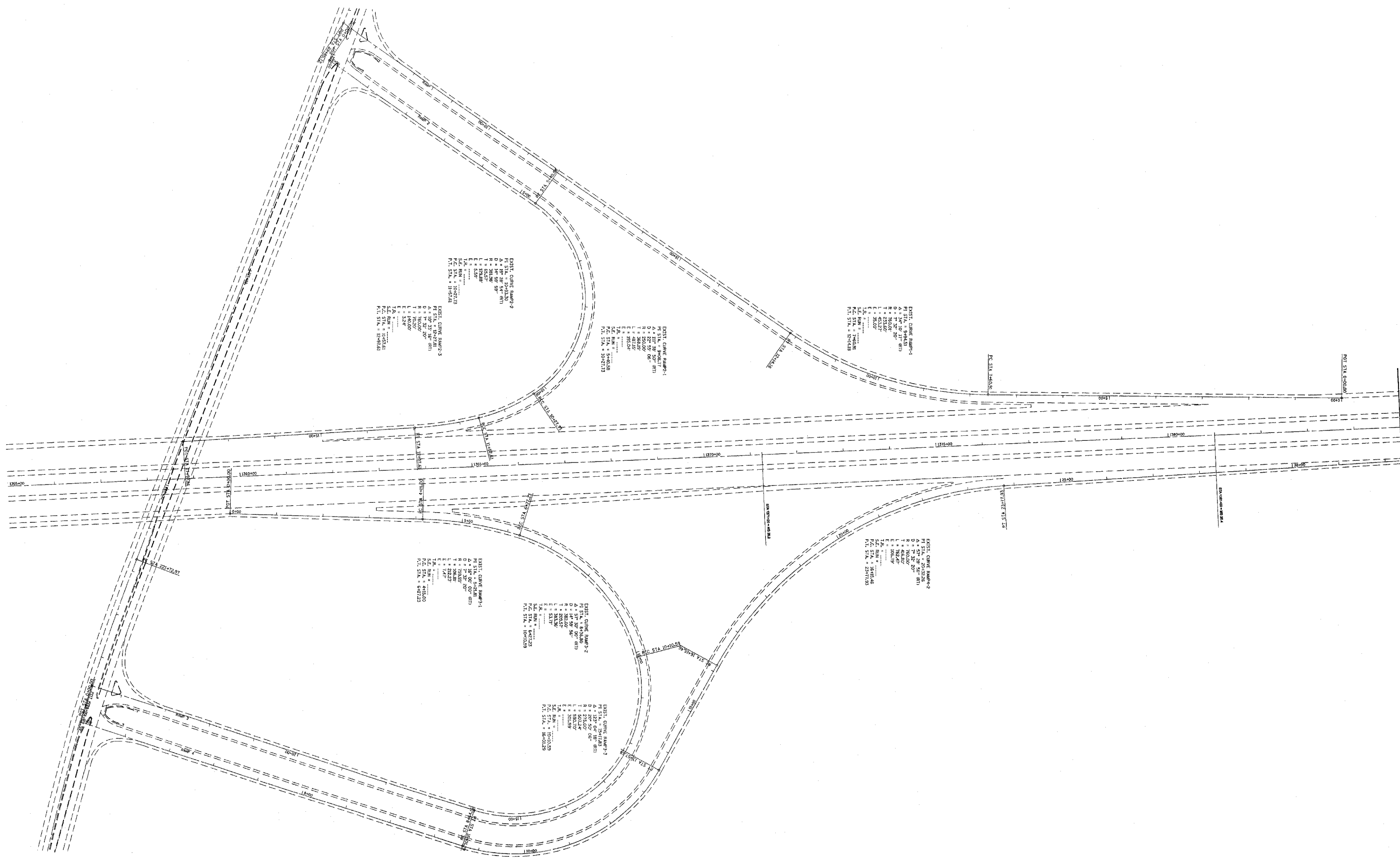

EXIST. CURVE RAMP-2  
 PI STA = 12427.11  
 PC STA = 12427.11  
 PT STA = 12427.11  
 CURVE LENGTH = 0.00'

EXIST. CURVE RAMP-1  
 PI STA = 12427.11  
 PC STA = 12427.11  
 PT STA = 12427.11  
 CURVE LENGTH = 0.00'

EXIST. CURVE RAMP-1  
 PI STA = 12427.11  
 PC STA = 12427.11  
 PT STA = 12427.11  
 CURVE LENGTH = 0.00'

EXIST. CURVE RAMP-3  
 PI STA = 12427.11  
 PC STA = 12427.11  
 PT STA = 12427.11  
 CURVE LENGTH = 0.00'

EXIST. CURVE RAMP-2  
 PI STA = 12427.11  
 PC STA = 12427.11  
 PT STA = 12427.11  
 CURVE LENGTH = 0.00'

EXIST. CURVE RAMP-2  
 PI STA = 12427.11  
 PC STA = 12427.11  
 PT STA = 12427.11  
 CURVE LENGTH = 0.00'

EXIST. CURVE RAMP-3  
 PI STA = 12427.11  
 PC STA = 12427.11  
 PT STA = 12427.11  
 CURVE LENGTH = 0.00'

EXIST. CURVE RAMP-3  
 PI STA = 12427.11  
 PC STA = 12427.11  
 PT STA = 12427.11  
 CURVE LENGTH = 0.00'

FILE NAME =	USER NAME = milleraj	DESIGNED -	REVISED -
c:\projects\0876c22\design\0876c22-sht	jan,dgn	DRAWN -	REVISED -
	PLOT SCALE = 100.0000' / IN.	CHECKED -	REVISED -
	PLOT DATE = 5/16/2008	DATE -	REVISED -

STATE OF ILLINOIS  
 DEPARTMENT OF TRANSPORTATION

<b>PLAN SHEETS</b>	
SCALE: _____	SHEET NO. ___ OF ___ SHEETS
STA. 1355+00 TO STA. 1385+00	

F.A.I. RTE.	SECTION	COUNTY	TOTAL SHEETS	SHEET NO.
255	160-8.911, 160-918S	MADISON	20	13
CONTRACT NO. 16C22				
FED. ROAD DIST. NO. - [ILLINOIS] FED. AID PROJECT				

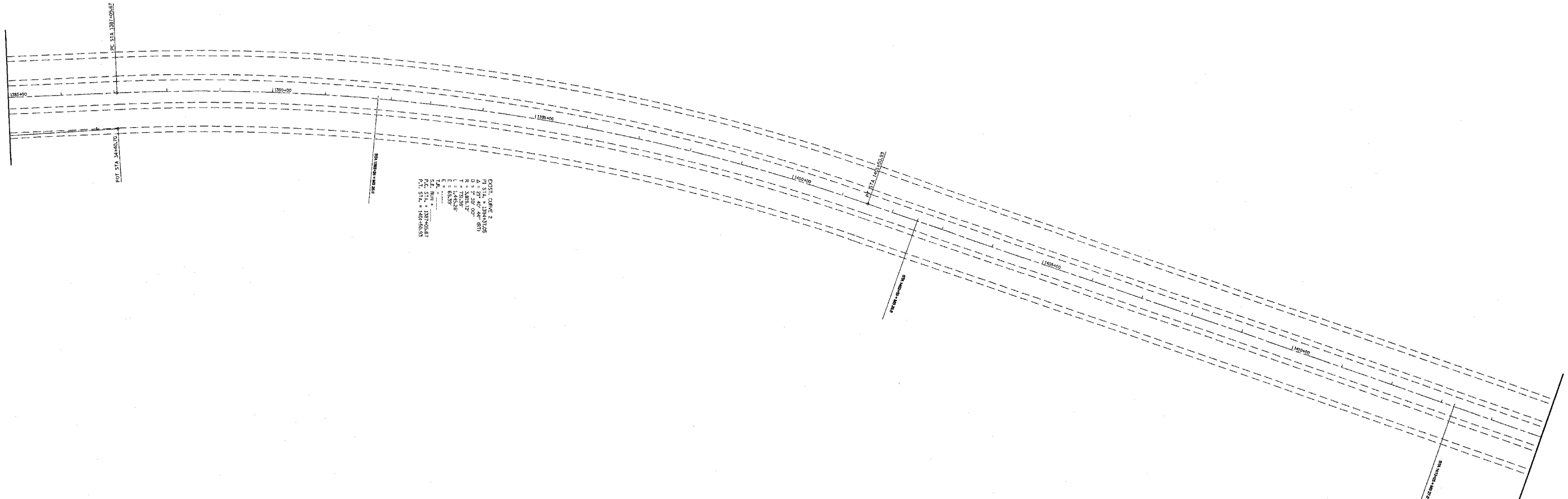

DIST. CURVE 2  
 P.C. STA. = 1381+00.67  
 P.T. STA. = 1384+00.00  
 L = 229.33  
 E = 68.39  
 A = 16.25  
 M = 138.51  
 N = 138.51  
 S = 138.51  
 TANGENT = 138.51  
 CHORD = 277.02  
 DELTA = 32.50  
 P.C. STA. = 1381+00.67  
 P.T. STA. = 1384+00.00

FILE NAME =	USER NAME = milleraj	DESIGNED -	REVISD -	<b>STATE OF ILLINOIS DEPARTMENT OF TRANSPORTATION</b>	<b>PLAN SHEETS</b>		F.A.I. RTE.	SECTION	COUNTY	TOTAL SHEETS	SHEET NO.
c:\projects\d876c22\design\d876c22-sht-landgn	PLOT SCALE = 100.0000' / IN.	DRAWN -	REVISD -				255	160-8.91L-160-91RS	MADISON	20	14
PLOT DATE = 5/16/2008	DATE -	CHECKED -	REVISD -		CONTRACT NO. 76C22			FED. ROAD DIST. NO. ILLINOIS FED. AID PROJECT			
		DATE -	REVISD -		SCALE: _____	SHEET NO. ___ OF ___ SHEETS	STA. 1385+00 TO STA. 1415+00				

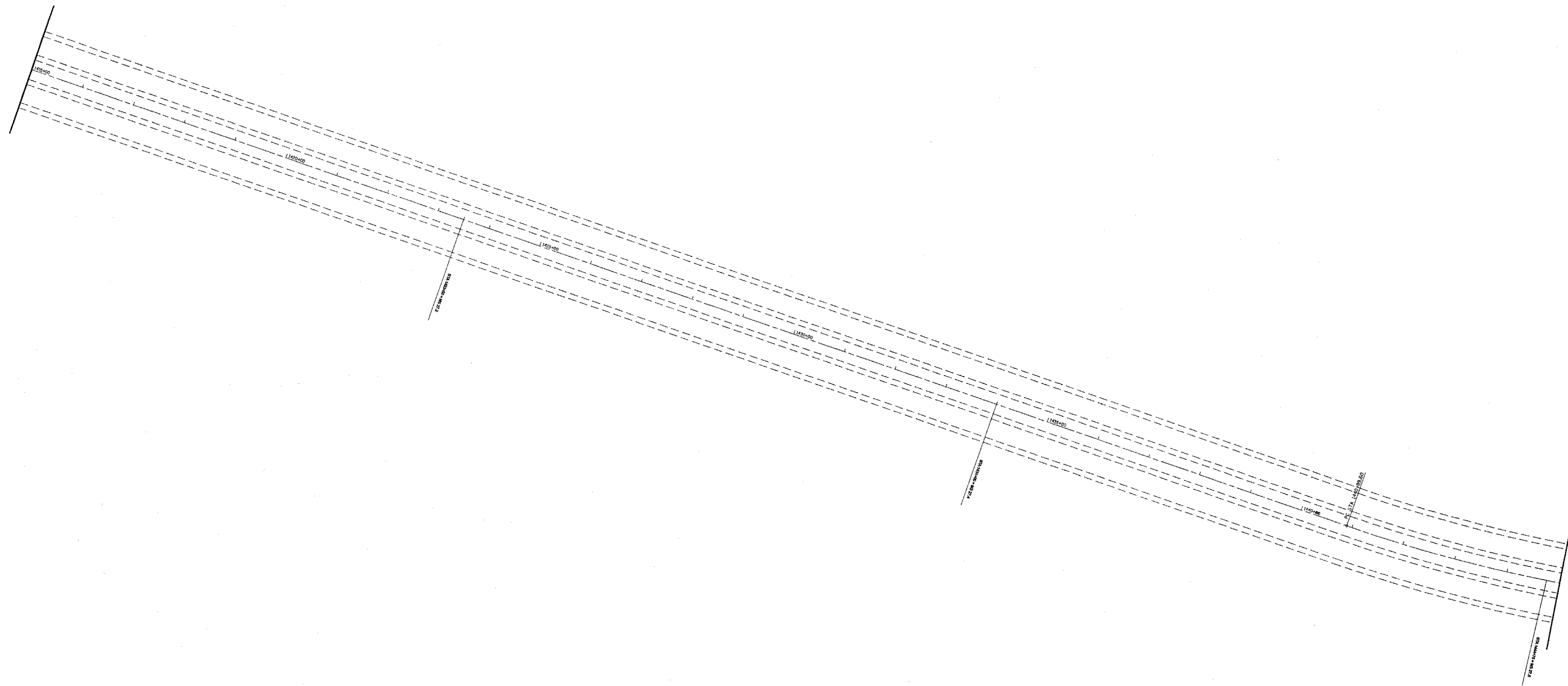

FILE NAME = c:\projects\4876c22\design\4876c22-eh-	USER NAME = millerj lan.dgn	DESIGNED - DRAWN -	REVISED - REVISED -
PLOT SCALE = 100.0000' / IN.	CHECKED -	REVISED -	REVISED -
PLOT DATE = 5/16/2008	DATE -	REVISED -	REVISED -

**STATE OF ILLINOIS  
DEPARTMENT OF TRANSPORTATION**

**PLAN SHEETS**

SCALE: \_\_\_\_\_ SHEET NO. \_\_ OF \_\_\_ SHEETS STA. 1415±00 TO STA. 1445±00

F.A.I. RTE. 255	SECTION 160-9.911-160-918S	COUNTY MADISON	TOTAL SHEETS 20	SHEET NO. 15
FED. ROAD DIST. NO. _ ILLINOIS FED. AID PROJECT			CONTRACT NO. 76C22	

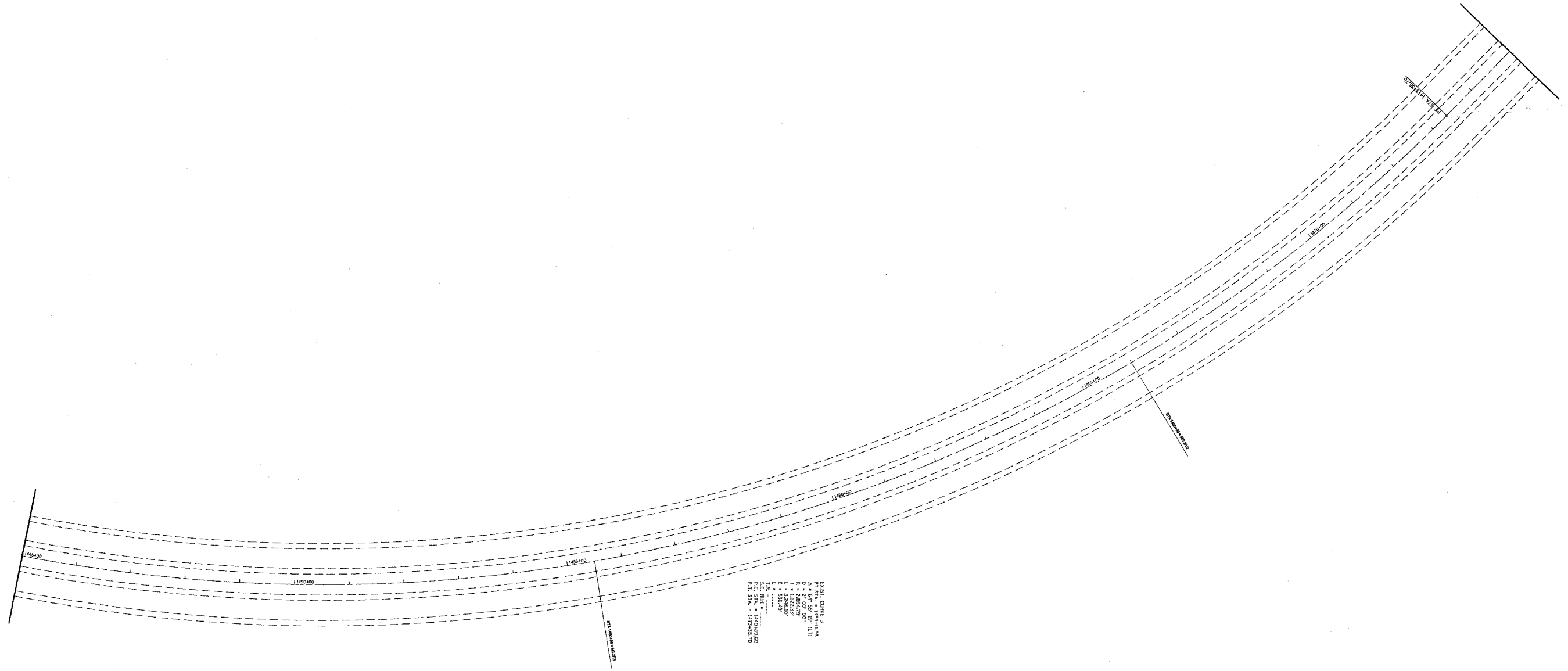

PLOT SCALE = 100.0000' / IN.  
 PLOT DATE = 5/16/2008  
 USER NAME = millerj  
 FILE NAME = c:\projects\4876e22\design\4876e22.sht

FILE NAME =	USER NAME = millerj	DESIGNED -	REVISD -
c:\projects\4876e22\design\4876e22.sht	lan.dgn	DRAWN -	REVISD -
PLOT SCALE = 100.0000' / IN.	CHECKED -	REVISD -	REVISD -
PLOT DATE = 5/16/2008	DATE -	REVISD -	REVISD -

**STATE OF ILLINOIS**  
**DEPARTMENT OF TRANSPORTATION**

**PLAN SHEETS**  
 SCALE: \_\_\_\_\_ SHEET NO. \_\_\_ OF \_\_\_ SHEETS STA. 1445+00 TO STA. 1475+00

F.A.I. RTE.	SECTION	COUNTY	TOTAL SHEETS	SHEET NO.
255	160-8.911-160-918	MADISON	20	16
FED. ROAD DIST. NO. - ILLINOIS FED. AID PROJECT			CONTRACT NO. 76C22	



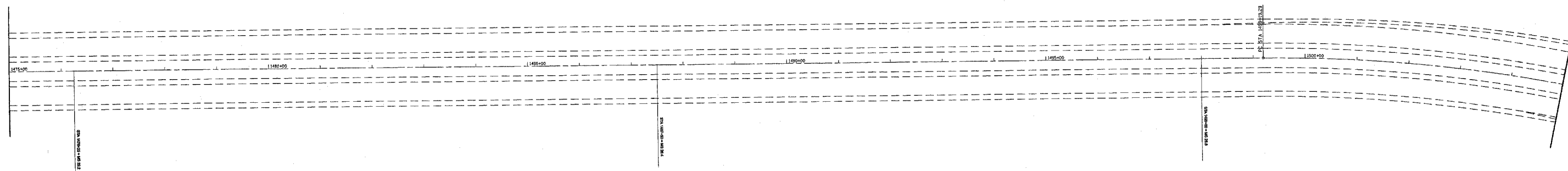

FILE NAME = c:\projects\4876e22\design\4876e22-sh1- plan.dgn	USER NAME = millerj	DESIGNED - ---	REVISED - ---	<b>STATE OF ILLINOIS DEPARTMENT OF TRANSPORTATION</b>	<b>PLAN SHEETS</b>		F.A.I. RTE. 255	SECTION 160-8.911_160-918S	COUNTY MADISON	TOTAL SHEETS 20	SHEET NO. 17	
	PLOT SCALE = 100.0000 / IN.	DRAWN - ---	REVISED - ---		SCALE: _____	SHEET NO. ___ OF ___ SHEETS	STA. 1475+00 TO STA. 1505+00	FED. ROAD DIST. NO. _ ILLINOIS FED. AID PROJECT				
	PLOT DATE = 5/16/2008	CHECKED - ---	REVISED - ---		CONTRACT NO. 76C22							
		DATE - -----	REVISED - ---									

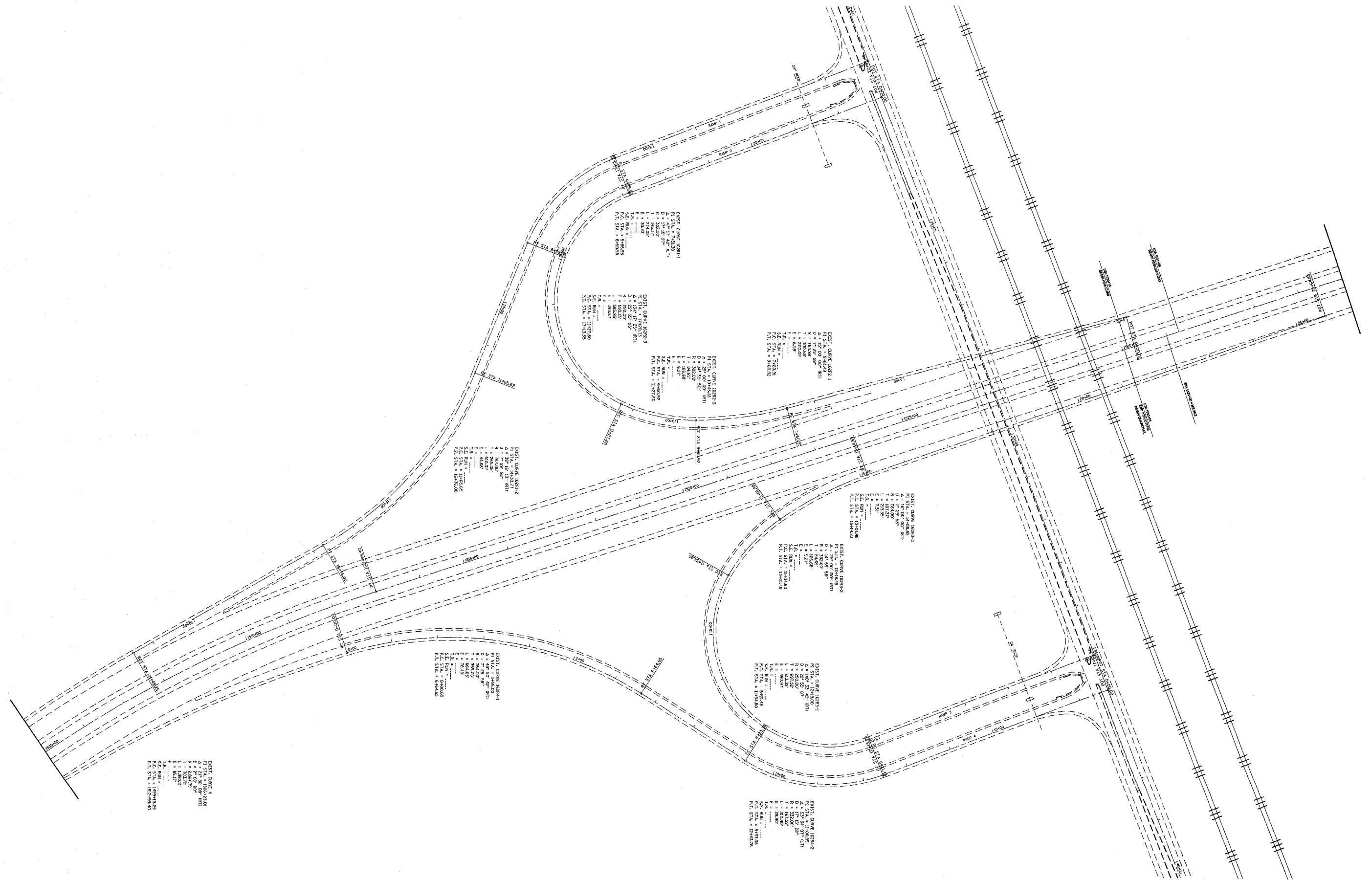

FILE NAME = c:\projects\10876c22\design\10876c22-sht-  
 USER NAME = millorroj  
 DRAWN -  
 CHECKED -  
 DATE -  
 PLOT SCALE = 100.0000' / IN.  
 PLOT DATE = 5/16/2008

DESIGNED -  
 DRAWN -  
 CHECKED -  
 DATE -  
 REVISED -  
 REVISED -  
 REVISED -  
 REVISED -

**STATE OF ILLINOIS  
 DEPARTMENT OF TRANSPORTATION**

**PLAN SHEETS**

SCALE: \_\_\_\_\_ SHEET NO. \_\_\_ OF \_\_\_ SHEETS STA. 1505+00 TO STA. 1535+00

F.A.J. RTE.	SECTION	COUNTY	TOTAL SHEETS	SHEET NO.
255	160-8.91L (60-9)RS	MADISON	20	18
CONTRACT NO. 76C22				
FED. ROAD DIST. NO. - [ILLINOIS] FED. AID PROJECT				

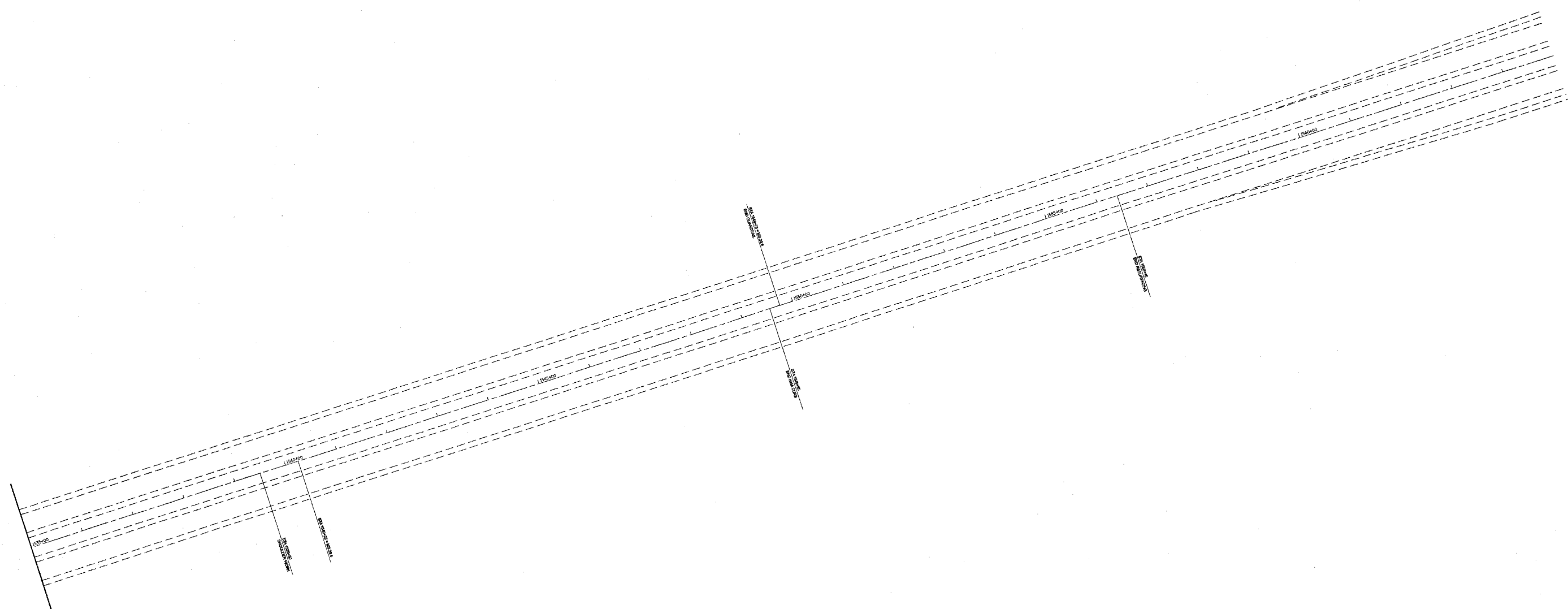

FILE NAME = c:\projects\d876c22\design\d876c22-sht-1.dgn	USER NAME = millerra.j	DESIGNED - ---	REVISED - ---
	PLOT SCALE = 100.0000' / IN.	DRAWN - ---	REVISED - ---
	PLOT DATE = 5/16/2008	CHECKED - ---	REVISED - ---
		DATE - ---	REVISED - ---

**STATE OF ILLINOIS  
DEPARTMENT OF TRANSPORTATION**

<b>PLAN SHEETS</b>		
SCALE: _____	SHEET NO. ___ OF ___ SHEETS	STA. 1535±00 TO STA. 1565±00

F.A.I. RTE. 255	SECTION 160-8.911-160-918S	COUNTY MADISON	TOTAL SHEETS 20	SHEET NO. 19
FED. ROAD DIST. NO. - ILLINOIS FED. AID PROJECT			CONTRACT NO. 76C22	

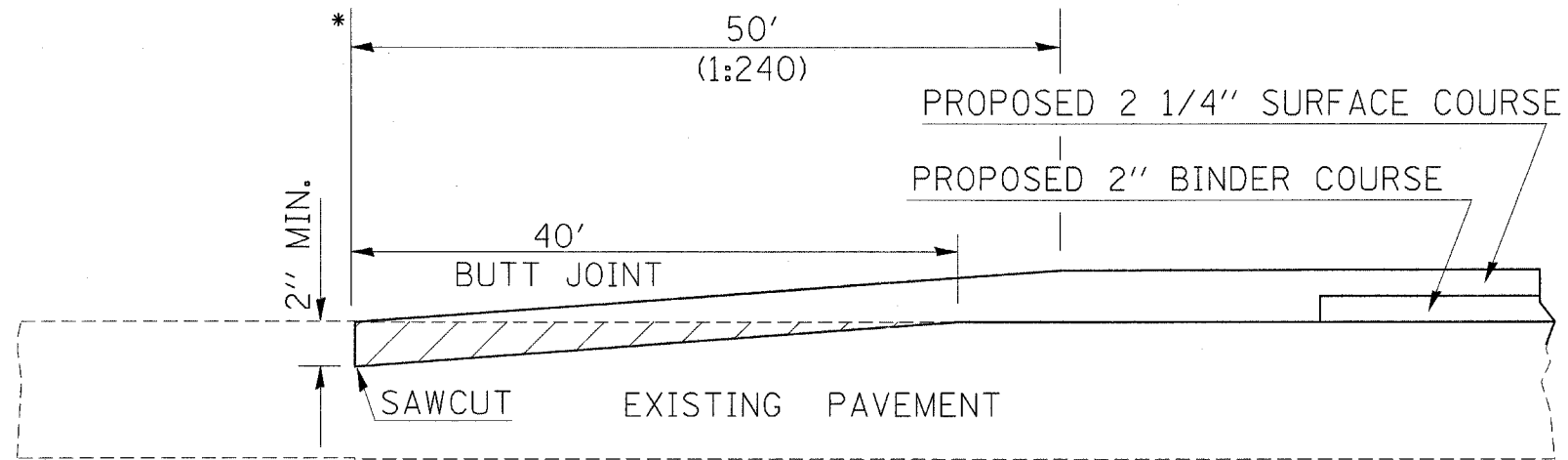

BUTT JOINT TO BE CONSTRUCTED AT BEGINNING OF PROJECT

\*STA. 1360+25

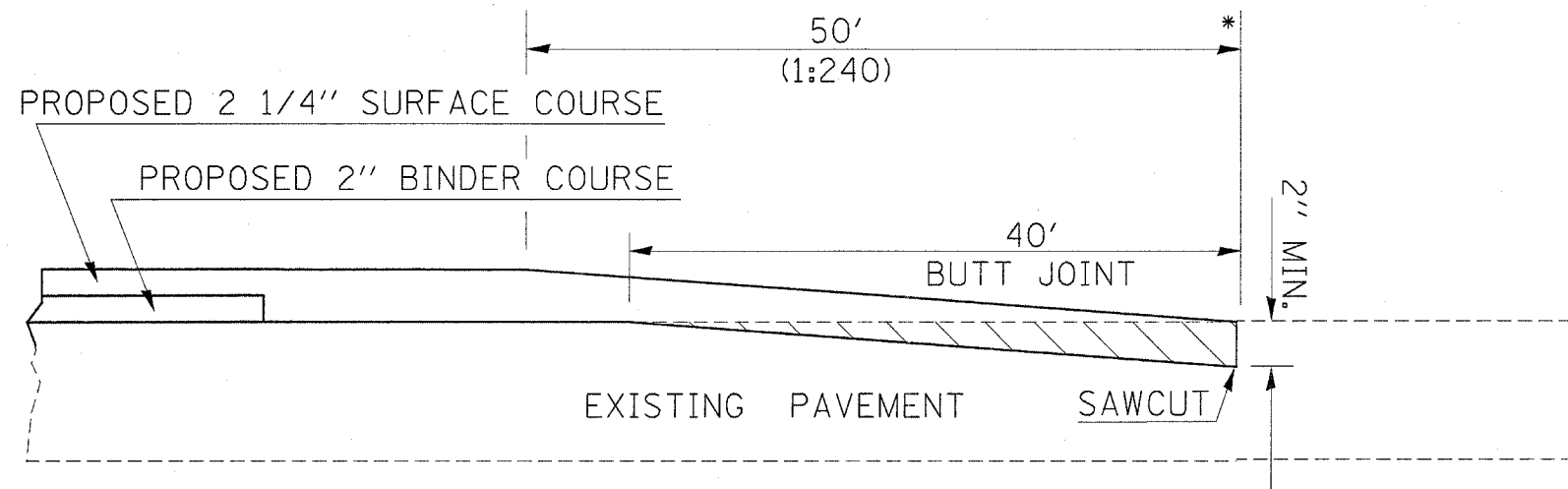

BUTT JOINT TO BE CONSTRUCTED AT END OF PROJECT

\*STA. 1556+40

FILE NAME =	USER NAME = mj11erra	DESIGNED -	REVISD -
ct:\proj\ec04\4876c22\design\4876c22-sht-1en.dgn		DRAWN -	REVISD -
PLOT SCALE = 100.0000 / IN.		CHECKED -	REVISD -
PLOT DATE = 5/16/2008		DATE -	REVISD -

STATE OF ILLINOIS  
DEPARTMENT OF TRANSPORTATION

DETAIL SHEET

SCALE: SHEET NO. OF SHEETS STA. 1355+00 TO STA. 1385+00

F.A.I. RTE.	SECTION	COUNTY	TOTAL SHEETS	SHEET NO.
255	160-8.911.160-9185	MADISON	20	20
FED. ROAD DIST. NO. - ILLINOIS FED. AID PROJECT			CONTRACT NO. 76022	