

PT. 44-001403
STA. 719+51.92 RT.
HORIZONTAL CONTROL
N. 277,835.1476
E. 791,751.3719

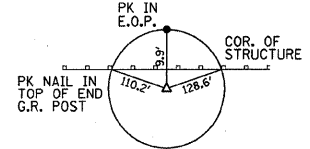

PT. 44-001404
STA. 724+34.13 RT.
HORIZONTAL CONTROL
N. 277,817.0000
E. 792,293.2931

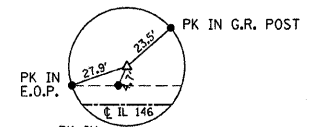

PT. 44-001402
STA. 725+73.26 LT.
HORIZONTAL CONTROL
N. 277,853.5967
E. 792,373.3663

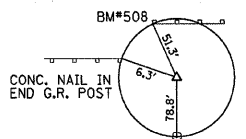

PT. 44-001405
STA. 730+63.42 RT.
GPS CONTROL
N. 277,801.8749
E. 792,850.4854

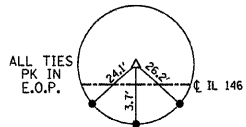

PT. 44-001401
STA. 735+11.42 LT.
TRANSVERSE STATION
N. 277,829.4720
E. 793,299.2108

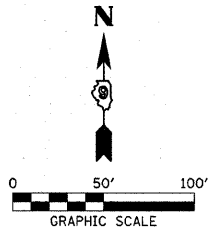

PLAN	SURVEYED	DATE
	ALIGNED	
	CHECKED	
	BY	
	NO.	

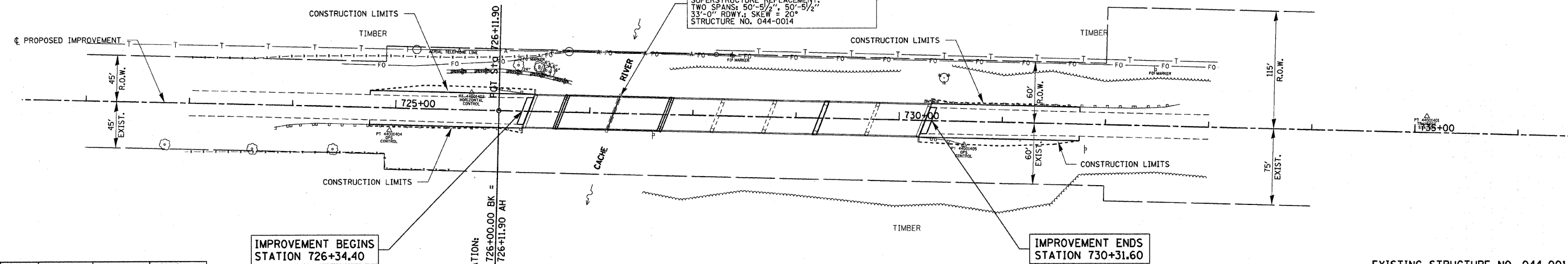

POINT	STATION	NORTHING	EASTING
POT713	C.L. 713+00.00	277,868.6797	791,100.0869
SEB726	C.L. 726+00.00	277,836.0736	792,399.6780
SEA726	C.L. 726+11.90	277,836.0736	792,399.6780
POT741	C.L. 741+00.00	277,798.7495	793,887.3098

IMPROVEMENT BEGINS
STATION 726+34.40

IMPROVEMENT ENDS
STATION 730+31.60

EXISTING STRUCTURE NO. 044-0014
STATION 728+33 - SPANS 1 & 4-8 CONCRETE
DECK ON STEEL I-BEAM; SPANS 2 & 3 PRECAST
PRESTRESSED CONCRETE DECK BEAM
BRIDGE WITH CONCRETE PARAPETS ON CLOSED
CONCRETE ABUTMENTS AND WINGWALLS.
385.2 BK.-BK. ABUTS; 33.00' o.-o. DECK

PROFILE	SURVEYED	DATE
	PLOTTED	
	CHECKED	
	BY	
	NO.	

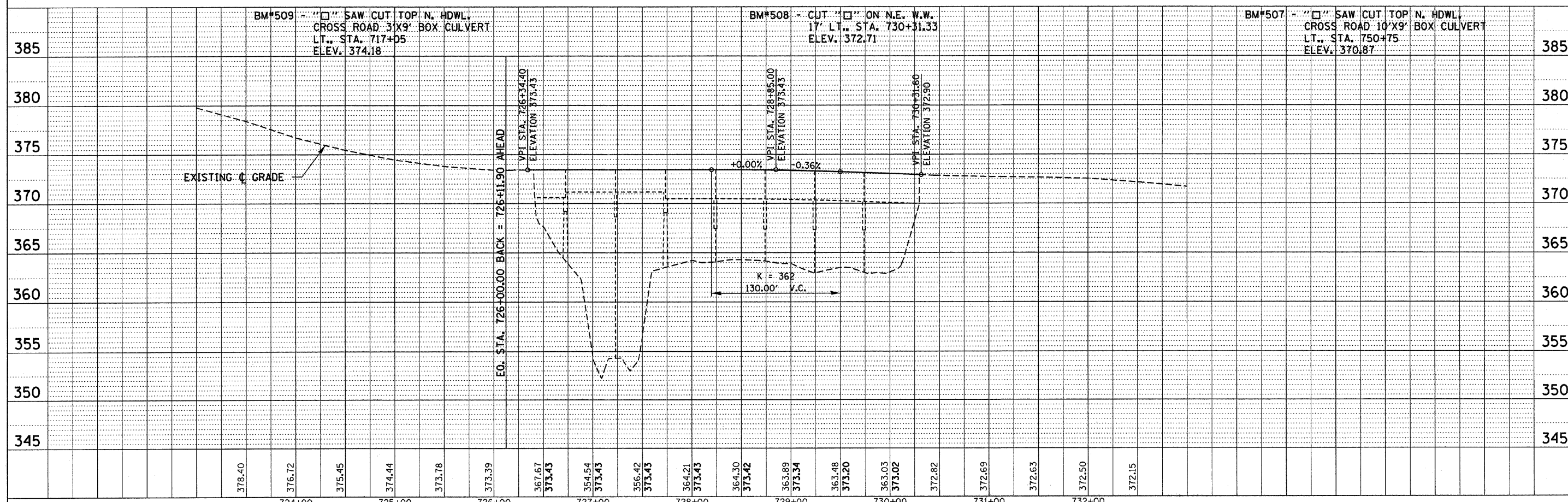

FILE NAME = 0440014-sh1-pl.dgn	USER NAME =	DESIGNED - L.F.S.	REVISED -	STATE OF ILLINOIS DEPARTMENT OF TRANSPORTATION	HAMPTON, LENZINI & RENWICK, INC. CIVIL & STRUCTURAL ENGINEERS LAND SURVEYORS	IL. ROUTE 146 PLAN & PROFILE	F.A.P. RTE. 885	SECTION 107BR-1	COUNTY JOHNSON	TOTAL SHEETS 94	SHEET NO. 11
PLOT SCALE =	CHECKED - S.W.M.	REVISED -	SHEET NO. 1 OF 1 SHEETS				CONTRACT NO. 78030				
PLOT DATE = 4/22/2008	DATE - 04/21/08	REVISED -	STA. 722+00.00 TO STA. 736+00.00				FED. ROAD DIST. NO. ILLINOIS FED. AID PROJECT				