

STATE OF ILLINOIS
DEPARTMENT OF TRANSPORTATION

ROUTE NO.	SECTION	COUNTY	TOTAL SHEETS	SHEET NO.	SHEET NO. 10
F.A.P. 885	107BR-1	Johnson	94	31	19 SHEETS
FED. ROAD DIST. NO. 7	ILLINOIS	FED. AID PROJECT-			

Contract #78030

NOTES

See Sheet 5 of 19 for Quantities and Bill of Material.

The quantity of Deck Slab Repair (Partial) has been estimated based on 10% of the concrete deck. The Engineer shall determine the repair locations and quantities after removal of the wearing surface. The actual repair locations shall be included in the as built plans. The Contractor will be paid for the actual amount of Deck Slab Repair (Partial) based on the unit price of the quantity.

See Sheets 8 & 9 of 19 for additional details.

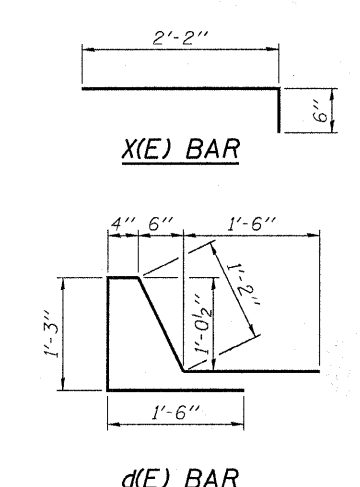
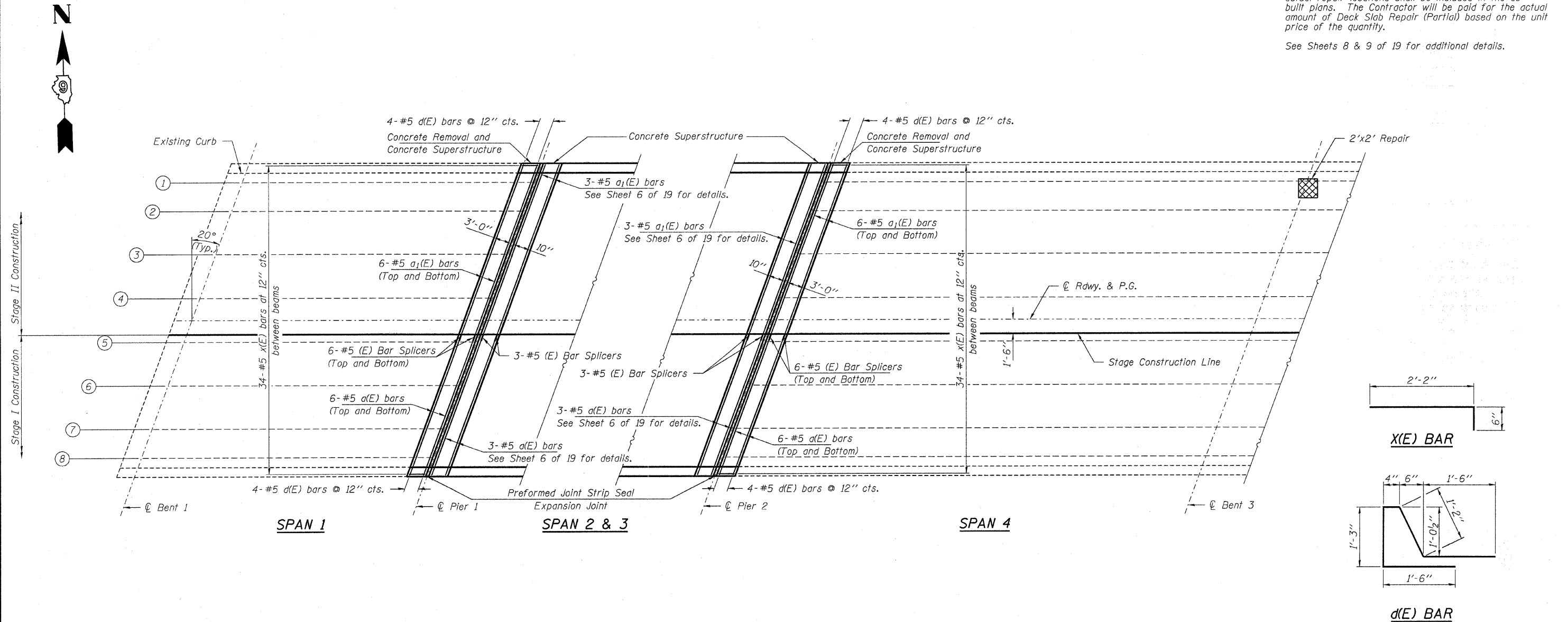

Indicates Deck Slab Repair (Full Depth)

<p>HAMPTON, LENZINI & RENWICK, INC. CIVIL & STRUCTURAL ENGINEERS LAND SURVEYORS</p> <p>HLR</p> <p>3085 STEVENSON DRIVE, SUITE 201 SPRINGFIELD, ILLINOIS 62703 (217) 546-3400</p> <p>ELGIN • SPRINGFIELD</p>	<p>DECK SLAB REPAIR</p> <p>IL. ROUTE 146 OVER CACHE RIVER</p> <p>F.A.P. ROUTE 885 / SECTION 107BR-1</p> <p>JOHNSON COUNTY</p> <p>STATION 727+23.00</p> <p>STRUCTURE NO. 044-0014</p>
	<p>PROJECT NUMBER: 12-52-0007-1 DATE: 04/02/08</p> <p>DESIGNED: S.M.S. CHECKED: M.D.C. DRAWN: D.T.M.</p>