

STATE OF ILLINOIS
DEPARTMENT OF TRANSPORTATION

ROUTE NO.	SECTION	COUNTY	TOTAL SHEETS	SHEET NO.	SHEET NO. 12 19 SHEETS
F.A.P. 885	107BR-1	Johnson	94	33	
FED. ROAD DIST. NO. 7		ILLINOIS	FED. AID PROJECT		

Contract #78030

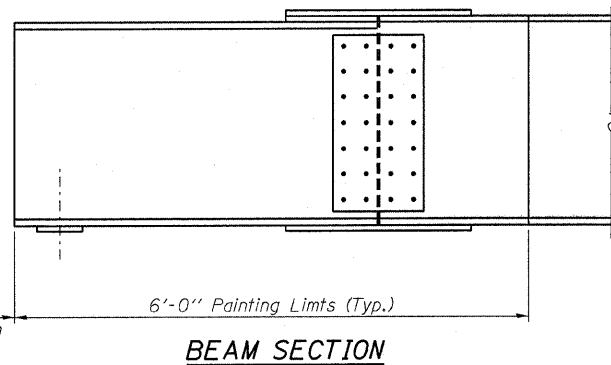
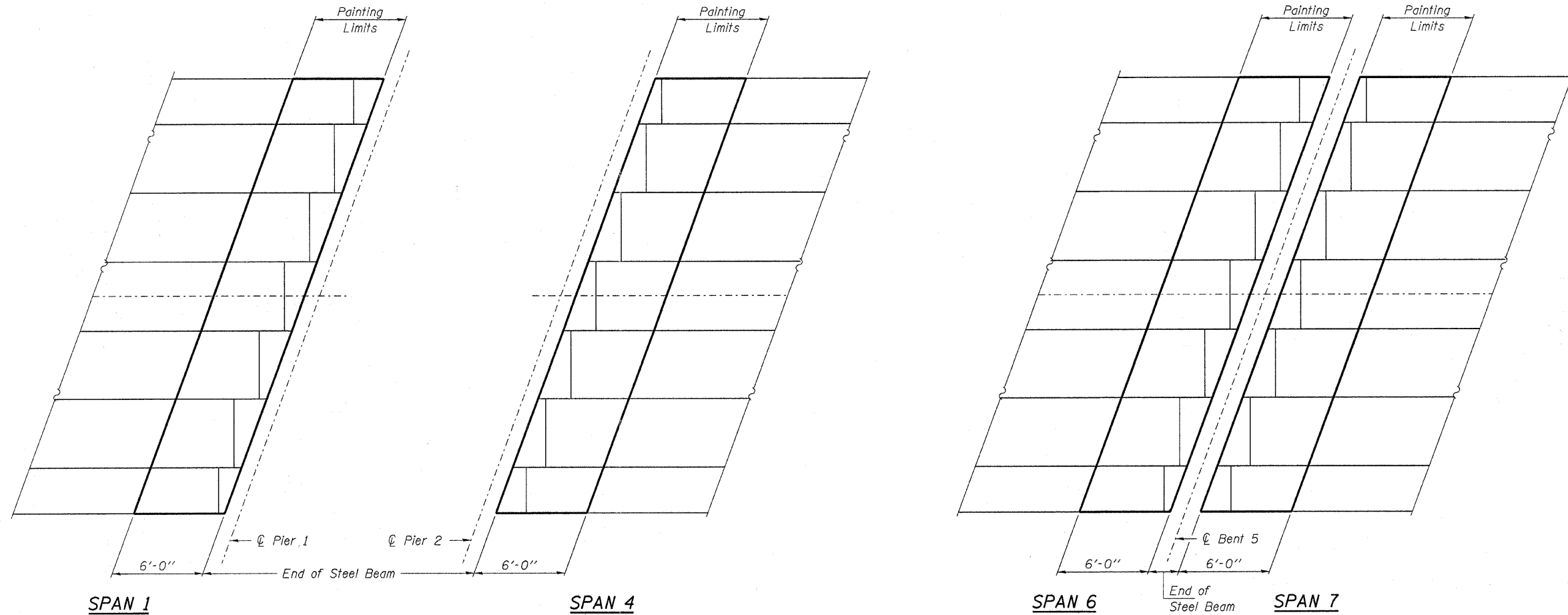

Notes:
 Painting limits were set at 6'-0" to fully include beam splices.
 Cleaning and painting of the existing structural steel shall be as specified in the special provision for "Cleaning and Painting Existing Steel Structures". All beams, bearings and other structural steel within 6 ft. (measured along the beam) of either side of deck joints shall be cleaned per Near White Blast Cleaning - SSPC-SP10.
 The designated areas cleaned per Near White Blast Cleaning - SSPC-SP10 and per Power Tool Cleaned - Commercial Grade shall be painted according to the requirements of Paint System 1 - OZ/E/U. The color of the final finish coat for all interior steel surfaces shall be Gray, Munsell No. 5B 7/1. The color of the final finish coat for the exterior and bottom flange of the fascia beams shall be Gray, Munsell No. 5B 7/1.

HAMPTON, LENZINI & RENWICK, INC.
 CIVIL & STRUCTURAL ENGINEERS
 LAND SURVEYORS

HLR

3085 STEVENSON DRIVE, SUITE 201
 SPRINGFIELD, ILLINOIS 62703
 (217) 546-3400

ELGIN • SPRINGFIELD

PROJECT NUMBER: 12-52-0007-1 DATE: 04/02/08
 DESIGNED: S.M.S. CHECKED: M.D.C. DRAWN: D.T.M.

PAINTING PLAN
 IL. ROUTE 146 OVER CACHE RIVER
 F.A.P. ROUTE 885 / SECTION 107BR-1
 JOHNSON COUNTY
 STATION 727+23.00
 STRUCTURE NO. 044-0014