

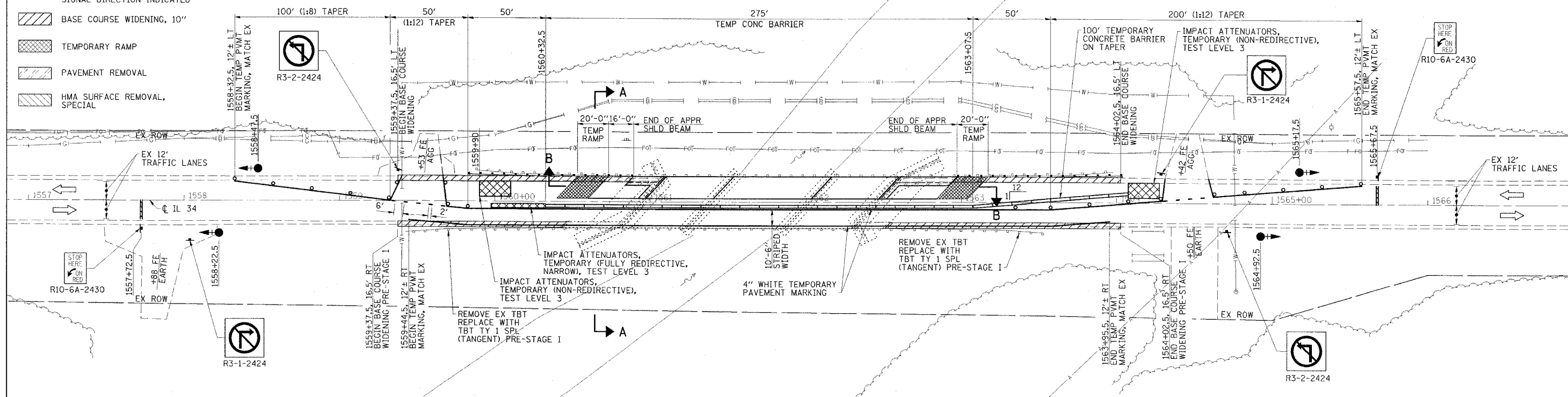

CONTRACT NO. 78031				
FAP RTE	SECTION	COUNTY	TOTAL SHEETS	SHEET NO.
869	105BR-2	SALINE	118	14
STA. 1557+00		TO STA. 1567+00		
FED. ROAD DIST. NO.	ILLINOIS	FED. AID PROJECT		

LEGEND

- TRAFFIC SIGNAL WITH BACKPLATE, SIGNAL DIRECTION INDICATED
- BASE COURSE WIDENING, 10"
- TEMPORARY RAMP
- PAVEMENT REMOVAL
- HMA SURFACE REMOVAL, SPECIAL

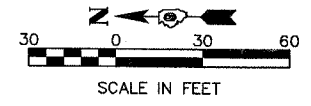

GENERAL NOTES

1. TRAFFIC CONTROL SHALL BE ERECTED AS SHOWN AND ACCORDING TO "TRAFFIC CONTROL AND PROTECTION, STANDARD 701321."
2. SEE SPECIAL PROVISIONS FOR ADDITIONAL TRAFFIC CONTROL REQUIREMENTS.
3. COORDINATE LOCATION OF SIGNALS WITH FINAL WORK AS DIRECTED BY THE ENGINEER.
4. CONSTRUCT TEMPORARY RUMBLE STRIPS AT LOCATIONS SHOWN ON STANDARD 701321.
5. THE DIMENSION SHOWN ON THE WIDTH RESTRICTION SIGN (W12-1102(O)-4B) SHOWN ON STANDARD 701321 SHALL BE 11'-0" FOR STAGE I CONSTRUCTION.
6. ADDITIONAL SIGNAGE AND BARRICADES SHOWN FOR SIDEROADS AND ENTRANCES SHALL BE INCLUDED IN THE COST OF STANDARD 701321.
7. THE EXISTING "TURNDOWN" TBT'S AT THE NW AND SW CORNERS OF THE BRIDGE MUST BE REMOVED AND REPLACED WITH NEW TBT'S TY 1 SPECIAL (TANGENT) PRIOR TO SHIFTING TRAFFIC TO THE STAGE I LANE.

SCHEDULE OF QUANTITIES

TEMPORARY CONCRETE BARRIER		
STATION TO	STATION	FEET
1560+32.5	1564+07.5	375
		TOTAL - 375
TEMPORARY BRIDGE TRAFFIC SIGNALS - 1 EACH		
TEMPORARY RUMBLE STRIPS - 6 EACH		
IMPACT ATTENUATORS, TEMPORARY (NON-REDIRECTIVE), TEST LEVEL 3 - 2 EACH		
IMPACT ATTENUATORS, TEMPORARY (FULLY REDIRECTIVE, NARROW), TEST LEVEL 3 - 1 EACH		

STAGE I CONSTRUCTION
FAP RTE 869 (IL 34)
SECTION 105BR-2
SALINE COUNTY

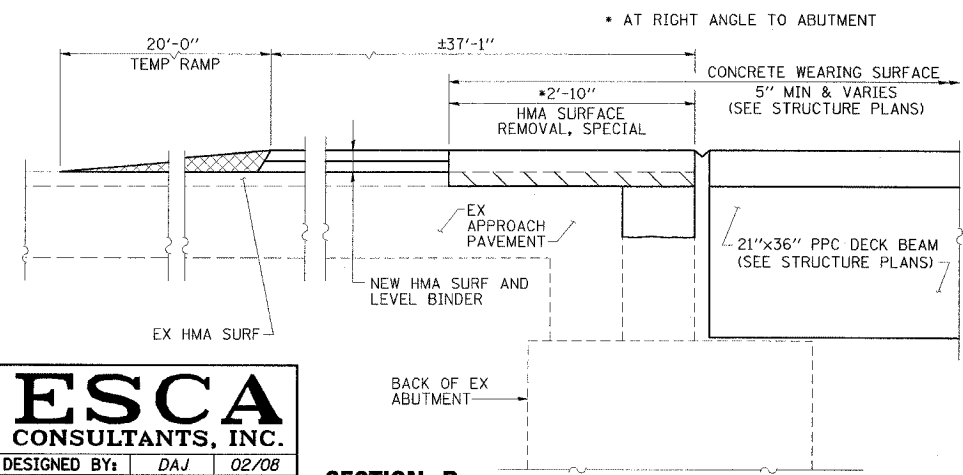

SECTION B

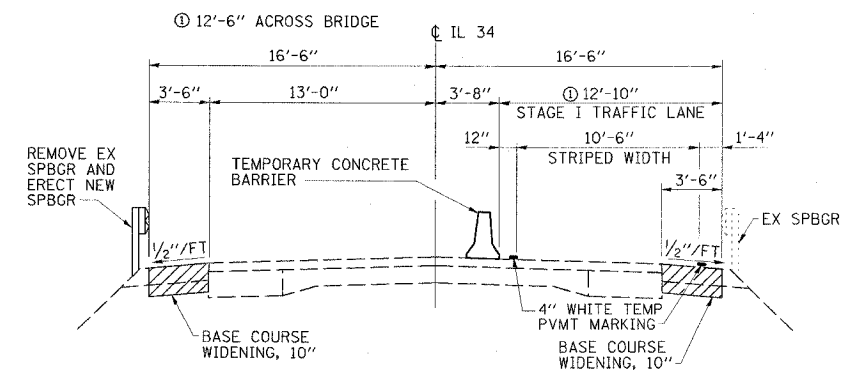

SECTION A-A

ESCA CONSULTANTS, INC.

DESIGNED BY:	DAJ	02/08
DRAWN BY:	JPC	02/08
CHECKED BY:	MTD	02/08
APPROVED BY:	RDP	04/08

PLOT DATE = 02/08
 PLOT NAME = 105BR-2
 PLOT SCALE = 1/4"=1'-0"
 REFERENCE = 02/08