

SCHEDULE OF QUANTITIES

TEMPORARY CONCRETE BARRIER	STATION TO STATION	FEET
	669+48 674+10.5	462.5

TEMPORARY BRIDGE TRAFFIC SIGNALS - 1 EACH

TEMPORARY RUMBLE STRIPS - 3 EACH

IMPACT ATTENUATORS, TEMPORARY (NON-REDIRECTIVE), TEST LEVEL 3 - 2 EACH

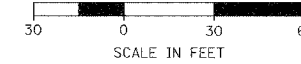

NOTES:

1. TRAFFIC CONTROL SHALL BE ERECTED AS SHOWN AND ACCORDING TO "TRAFFIC CONTROL AND PROTECTION, STANDARD 701321."
2. SEE SPECIAL PROVISIONS FOR ADDITIONAL TRAFFIC CONTROL REQUIREMENTS.
3. COORDINATE LOCATION OF SIGNALS WITH FINAL WORK AS DIRECTED BY THE ENGINEER.
4. CONSTRUCT TEMPORARY RUMBLE STRIPS AT LOCATIONS SHOWN ON STANDARD 701321 AT WEST END OF PROJECT ONLY.
5. PLACE TYPE III BARRICADES AT EAST END OF PRIVATE ENTRANCE (STA 669+87). COST INCLUDED WITH TRAFFIC CONTROL AND PROTECTION STANDARD 701321.

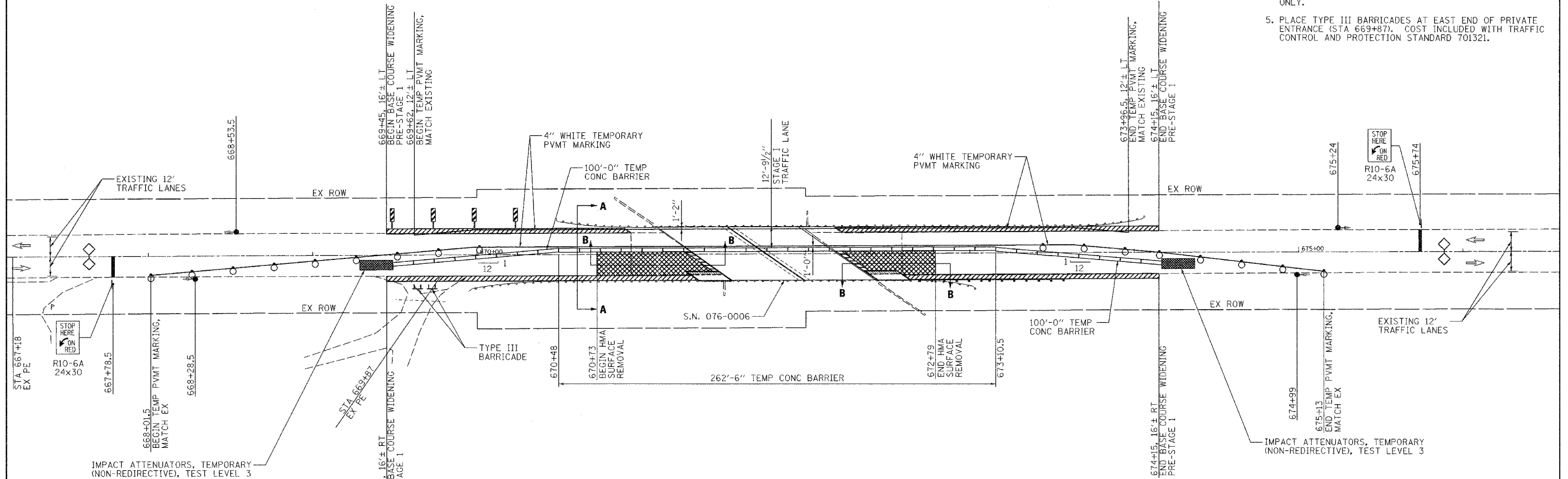

LEGEND

- TRAFFIC SIGNAL
- DRUM WITH STEADY BURNING LIGHT
- ▨ BASE COURSE WIDENING, 10"
- ▩ HMA SURFACE REMOVAL - BUTT JOINT
- ▧ HMA SURFACE REMOVAL (2" MIN & VARIES)
- ▦ PAVEMENT REMOVAL

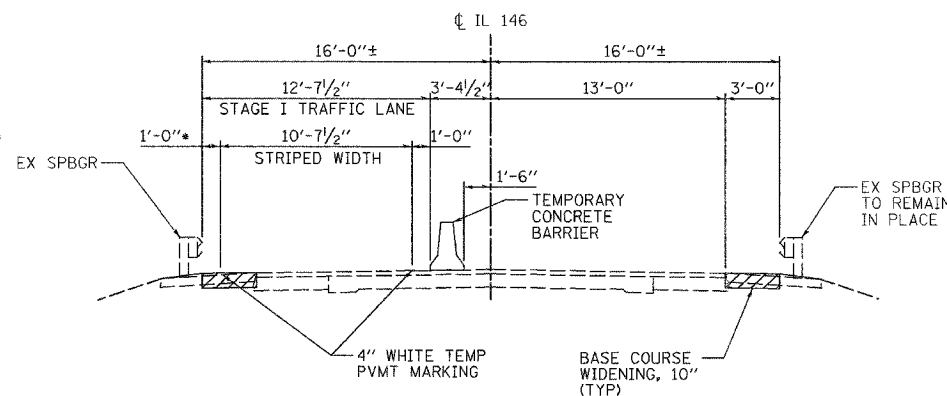

SECTION A-A
• 1'-2" ON STRUCTURE

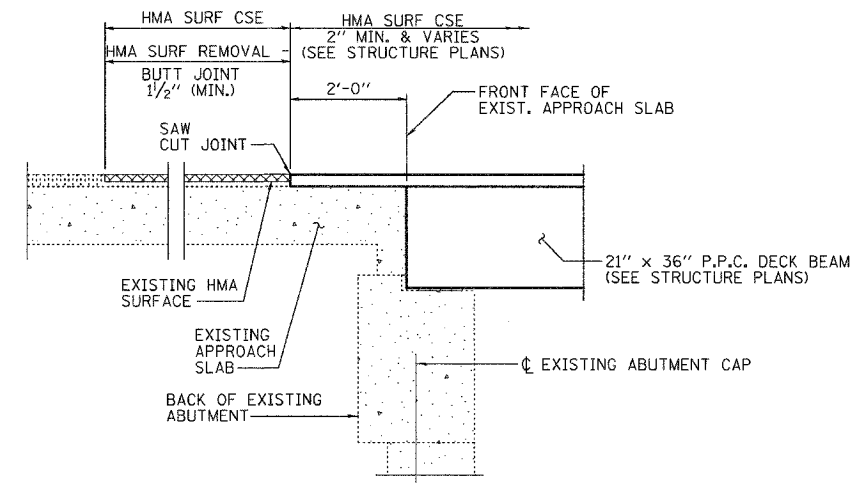

SECTION B-B

NOTE:
HORIZONTAL DIMENSION SHOWN IS AT RIGHT ANGLES TO BEAM ENDS.

EDSI
ENGINEERING DESIGN SOURCE, INC.
16141 SWINGLEY RIDGE RD
CHESTERFIELD, MO. 63017
SUITE 300
(636) 537-5585

FILE NAME =	USER NAME = #USER#	DESIGNED - JAH	REVISED -	STATE OF ILLINOIS DEPARTMENT OF TRANSPORTATION	FAP ROUTE 885 (IL 146) STAGE I CONSTRUCTION	F.A.P. RTE. 885	SECTION 111BR-1	COUNTY POPE	TOTAL SHEETS 69	SHEET NO. 7	
#FILES#	PLOT SCALE = #SCALE#	DRAWN - GDO	REVISED -			CONTRACT NO. 78033					
	PLOT DATE = #DATE#	CHECKED - JAH	REVISED -								
		DATE -	REVISED -								

SCALE: 1"=30' SHEET NO. 1 OF 2 SHEETS STA. 667+15 TO STA. 676+50 FED. ROAD DIST. NO. 7 ILLINOIS FED. AID PROJECT