

Bench Mark: Chiseled square in S.E. headwall of SN 076-0006, Elevation 368.02.

Existing Structure: The original two-span structure was built in 1929 with a reinforced concrete deck girder on reinforced concrete closed abutments and pier with a length of 90'-5 1/2" back-to-back of abutments. The structure was rehabilitated in 1981. The superstructure was replaced with P.P.C. deck beam with a total width of 33'-0" out-to-out of superstructure and substructure was modified accordingly.

Proposed Improvements: The existing superstructure is to be replaced with P.P.C. deck beams and a HMA surface course and waterproofing. Minor substructure repairs are required. Traffic to be maintained at all times utilizing stage construction.

No Salvage.

STATE OF ILLINOIS  
DEPARTMENT OF TRANSPORTATION

ROUTE NO. F.A.P. 885	SECTION 111BR-1	COUNTY POPE	DATE 69	SHEET NO. 12	SHEET NO. 1 15 SHEETS
FED. ROAD DIST. NO. 7		ILLINOIS FED. AID PROJECT			

Contract #78033

**DESIGN SPECIFICATIONS**

2007 AASHTO LRFD Bridge Design Specifications, 4th Edition

**LOADING HL-93**

No allowance for Future Wearing Surface.

**DESIGN STRESSES**

**FIELD UNITS**

$f'_c = 3,500$  psi  
 $f_y = 60,000$  psi (reinforcement)

**PRECAST PRESTRESSED UNITS**

$f'_c = 6,000$  psi  
 $f'_{ci} = 5,000$  psi  
 $f_{pu} = 270,000$  psi (1/2"  $\phi$  low lax. strands)  
 $f_{pb} = 201,960$  psi (1/2"  $\phi$  low lax. strands)

**PRECAST UNITS**

$f'_c = 4,500$  psi  
 $f_y = 60,000$  psi (Reinforcement)

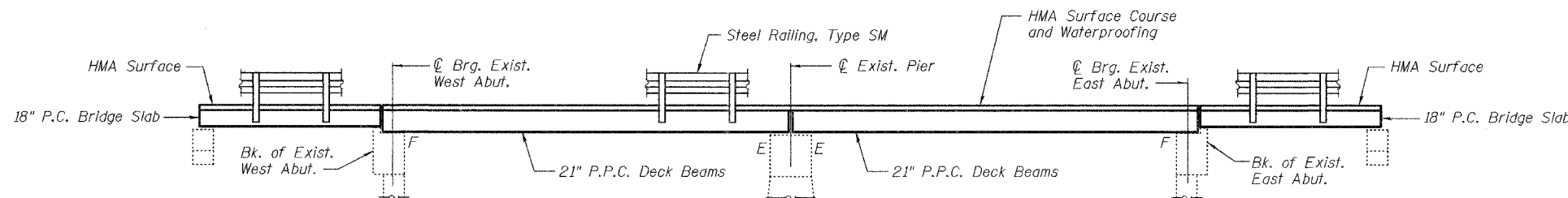

**ELEVATION**

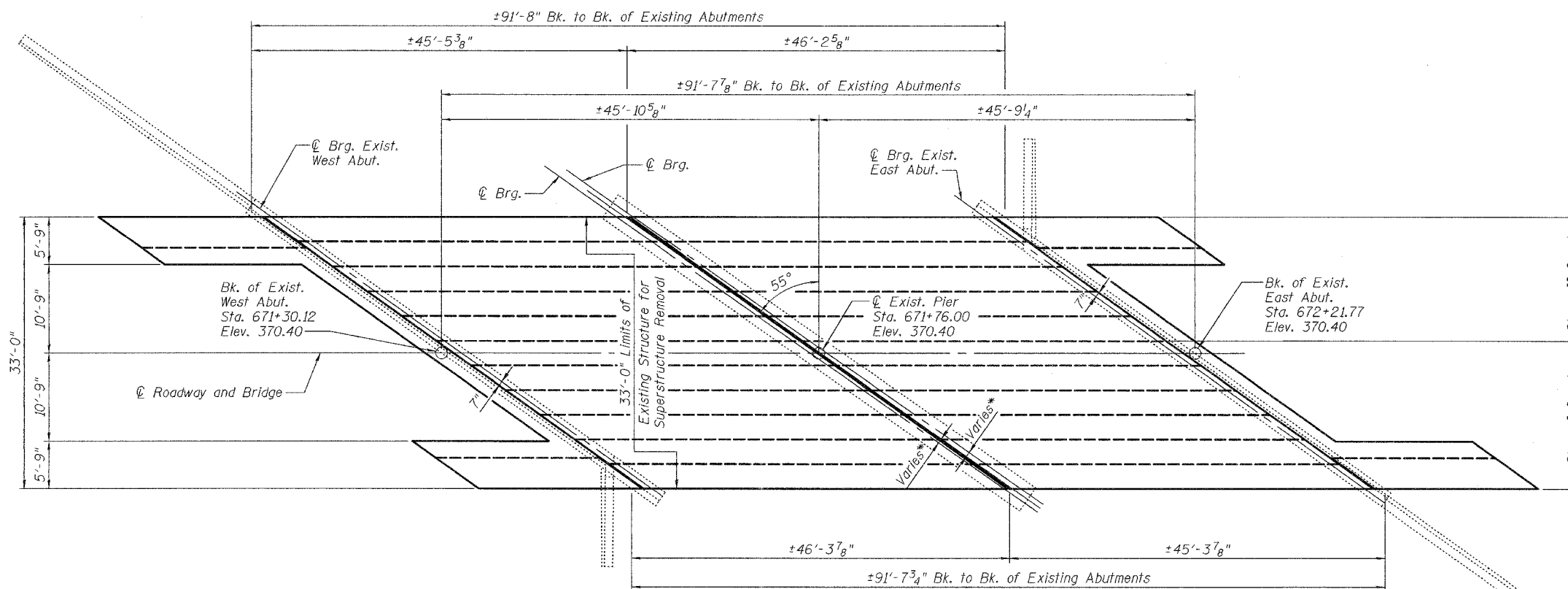

**PLAN**

\* See Sheet 14 of 15 for details.

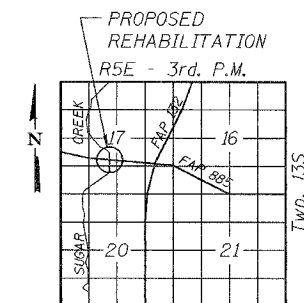

**LOCATION SKETCH**



STATION 671+76.00  
REBUILT 200\_ BY  
STATE OF ILLINOIS  
F.A.P. RT. 885 SEC. 111BR-1  
LOADING HL93  
STR. NO. 076-0006

**NAME PLATE**  
See Std. 515001

Notes:  
Existing name plate shall be cleaned and relocated adjacent to the new name plate. Cost included with Name Plates.  
Locate name plates at outside face of top steel railing tube at southwest corner of bridge.

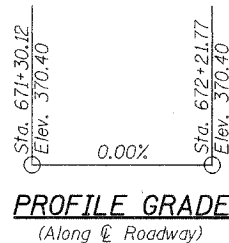

**PROFILE GRADE**  
(Along  $\phi$  Roadway)

DESIGNED	YSS
CHECKED	RLM
DRAWN	PRC
CHECKED	YSS

04/22/08

**APPROVED**  
FOR STRUCTURAL ADEQUACY ONLY  
*Ralph E. Anderson (top)*  
ENGINEER OF BRIDGES AND STRUCTURES



*David W. Petermeier 4/23/08*  
DAVID W. PETERMEIER  
EDWARDSVILLE, ILLINOIS  
ILLINOIS LICENSED STRUCTURAL  
ENGINEER NO. 081-005642  
EXPIRES NOV. 30, 2008

**GENERAL PLAN AND ELEVATION**  
**ILL. ROUTE 146 OVER SUGAR CREEK**  
**F.A.P. ROUTE 885 - SECTION 111BR-1**  
**POPE COUNTY**  
**STATION 671+76.00**  
**STRUCTURE NO. 076-0006**