

SEC. 13, T7S, R3E, 3RD P.M.

CONTRACT NO. 78034	
FAP RTE	SECTION
873	1078R-1
COUNTY	TOTAL SHEETS
FRANKLIN	73
STA. 1057+00	TO STA. 1063+00
FED. ROAD DIST. NO.	ILLINOIS FED. AID PROJECT

PLAN	SURVEYED	DATE
	ALIGNED	
	NOT CHECKED	
	PT. OF WAY CHECKED	
	SAID FILE NAME	

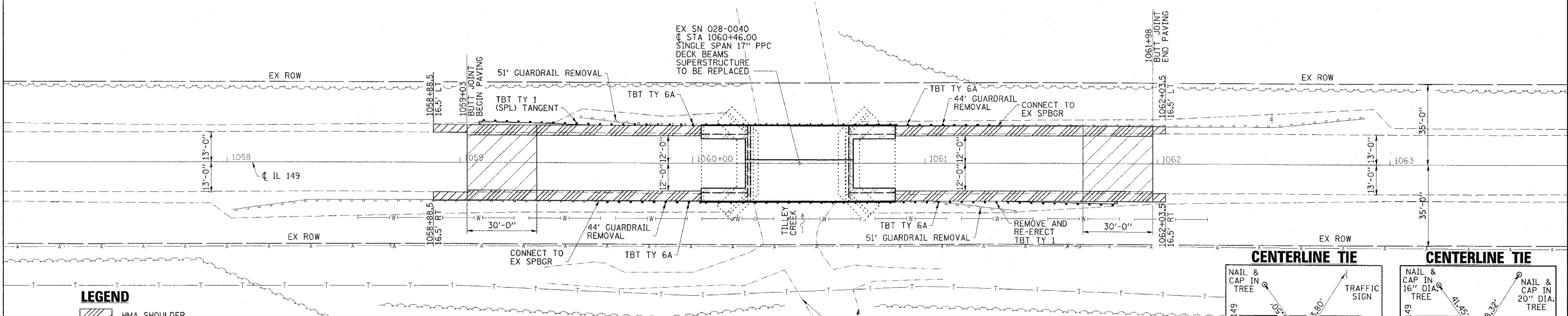

- LEGEND**
- HMA SHOULDER
 - HMA SURF REMOVAL - BUTT JOINT
 - PAVEMENT REMOVAL
 - HMA SURFACE REMOVAL, SPECIAL
 - BASE COURSE WIDENING, 10"

BENCHMARK
RAILROAD SPIKE IN POWER POLE SOUTH SIDE OF IL 149 AND FIRST POLE WSW OF SN 028-0040, STA 1058+72, 27' RT, EL 410.18

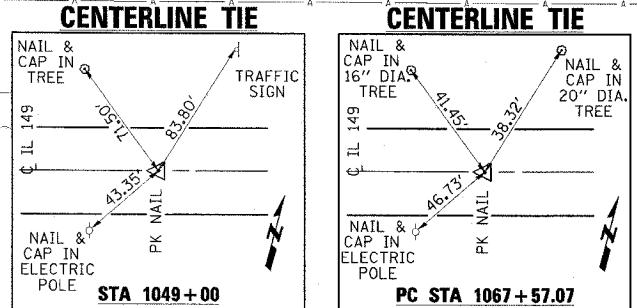

SEC. 13, T7S, R3E, 3RD P.M.

PROFILE	SURVEYED	DATE
	GRADED	
	NOT CHECKED	
	STRUCTURE NOTATIONS CHECKED	

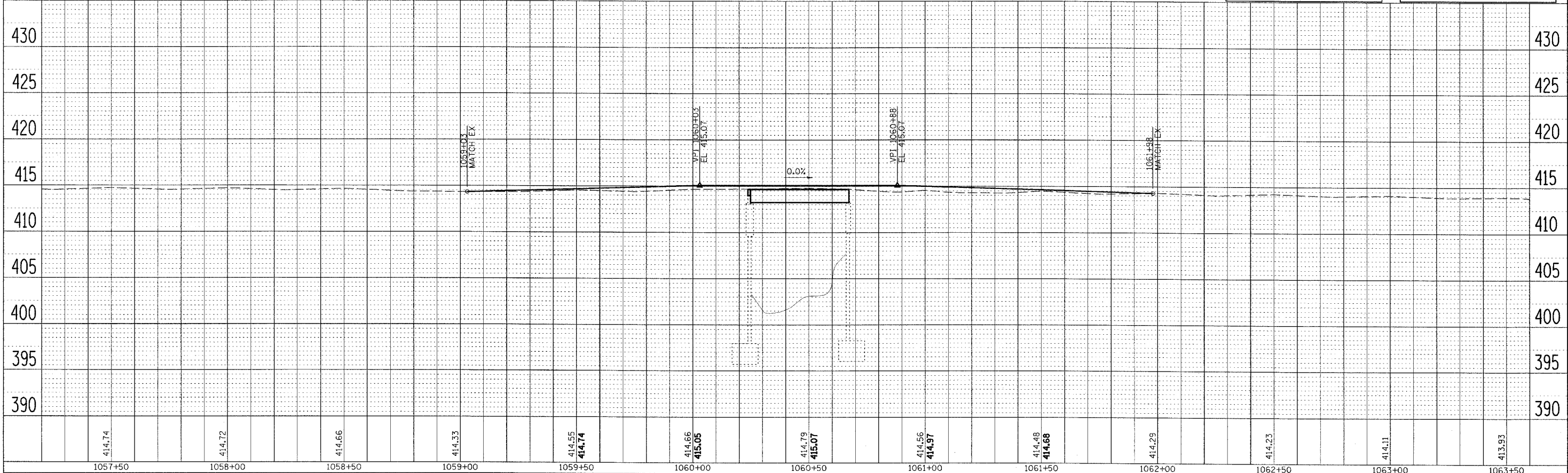

PLOT DATE = #DATE#
FILE NAME = #FILE#
PLOT SCALE = #SCALE#
REFERENCE = #REF#