

RTE.	CITY SECTION	COUNTY	TOTAL SHEETS	SHEET NO.
2887	07-00083-00-RS	COOK/WILL	10	6
STA. 13+54.2±		TO STA. 26+65.6±		
FED. RD. DIST. NO.	ILLINOIS	PROJECT - M - 8003 (853)		
CONTRACT # 8.3.9.6.9				

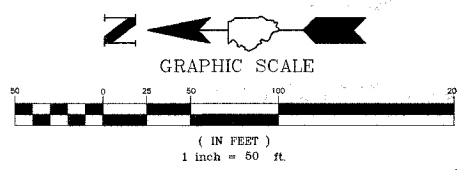

SHORT TERM PAVEMENT MARKING
 CENTERLINE 4" DOUBLE YELLOW - 4' LONG, 40' MAX. SPACING
 LANE LINE 4" WHITE - 4' LONG, 40' MAX. SPACING

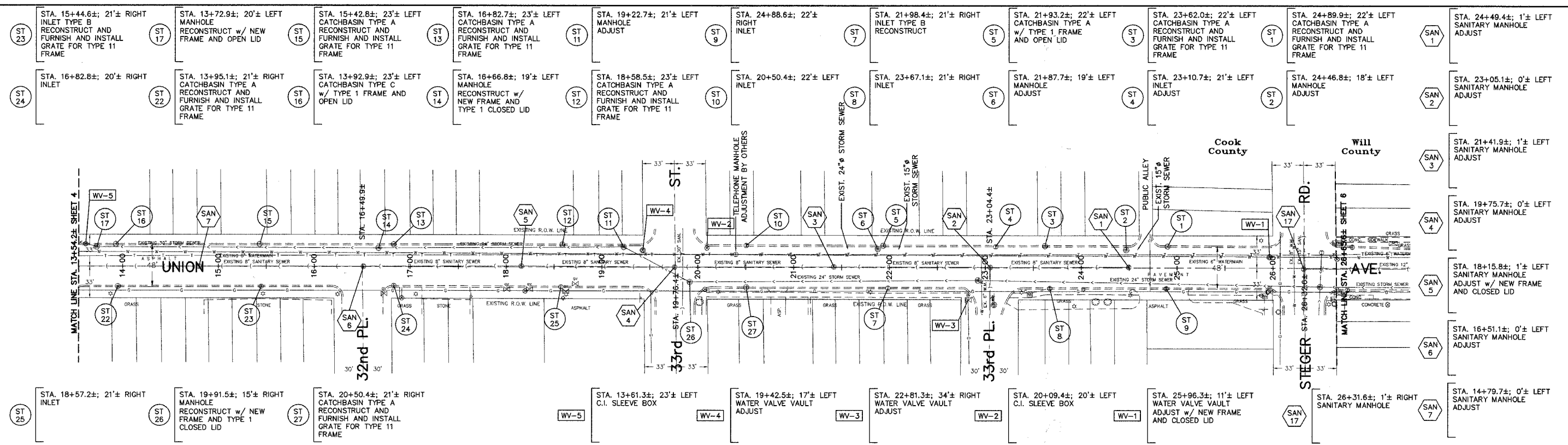
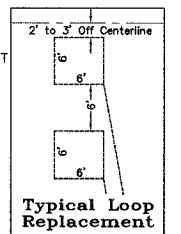
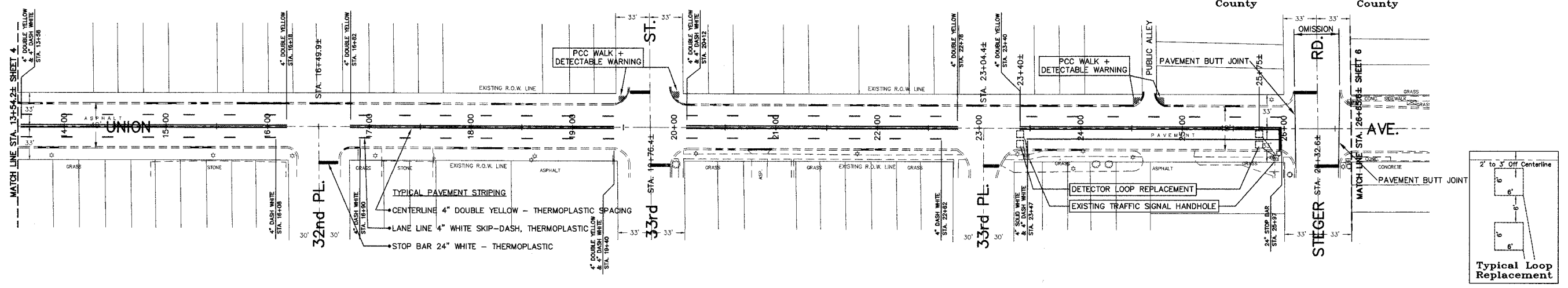

Joseph A. Schudt & Associates
 19350 S. HARLEM AVENUE FRANKFORT, IL 60423
 PHONE: 708-720-1000 FAX: 708-720-1065
 e-mail: jas@joseeng.com http://www.joseeng.com
 CIVIL ENGINEERING LAND SURVEYING ENVIRONMENTAL LAND PLANNING GPS SERVICES

Union Avenue Street Paving 30th Street to Richton Road

REVISIONS	
NAME	DATE

ILLINOIS DEPARTMENT OF TRANSPORTATION
CONSTRUCTION PLAN
 SHEET 6 OF 10
 SCALE: AS SHOWN DRAWN BY: J.A.R.
 DATE: 4-4-08 CHECKED BY: S.M.H.

07-22
07-022-JAR

M:\000707\025\0707-602-JAR.dwg, 08-30 SCALE: 4/2008 9:11 AM COPYRIGHT © JOSEPH A. SCHUDT & ASSOCIATES, JAR