

VERTICAL BARRICADES
SET ALONG EXTENSION OF
DRIVEWAY FLARES

TYPICAL DRIVEWAY
BARRICADING

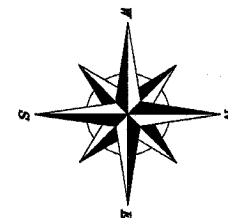

SCALE: 1" = 50'

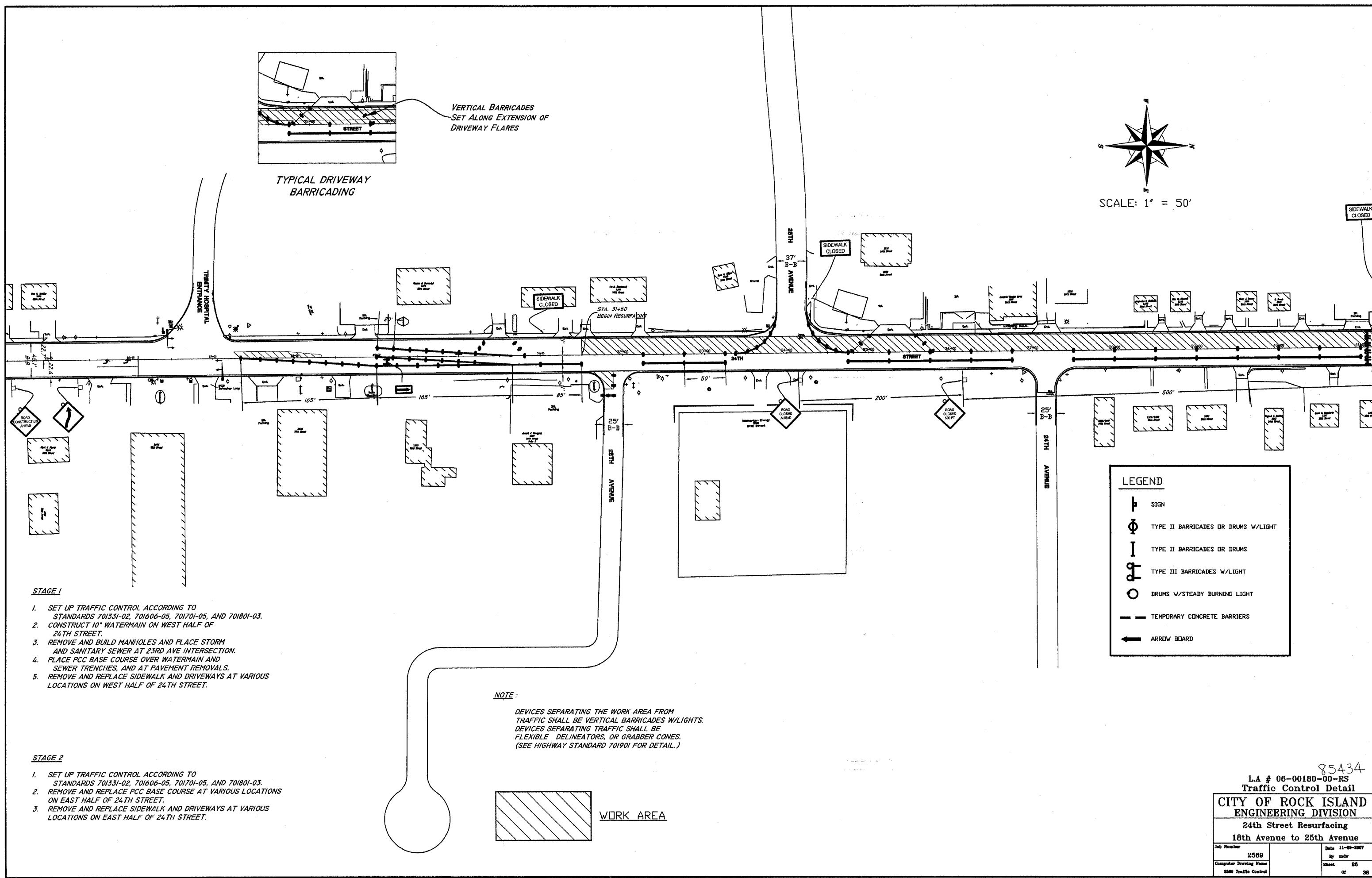

LEGEND

- SIGN
- TYPE II BARRICADES OR DRUMS W/LIGHT
- TYPE II BARRICADES OR DRUMS
- TYPE III BARRICADES W/LIGHT
- DRUMS W/STEADY BURNING LIGHT
- TEMPORARY CONCRETE BARRIERS
- ARROW BOARD

- STAGE 1**
1. SET UP TRAFFIC CONTROL ACCORDING TO STANDARDS 701331-02, 701606-05, 701701-05, AND 701801-03.
 2. CONSTRUCT 10" WATERMAIN ON WEST HALF OF 24TH STREET.
 3. REMOVE AND BUILD MANHOLES AND PLACE STORM AND SANITARY SEWER AT 23RD AVE INTERSECTION.
 4. PLACE PCC BASE COURSE OVER WATERMAIN AND SEWER TRENCHES, AND AT PAVEMENT REMOVALS.
 5. REMOVE AND REPLACE SIDEWALK AND DRIVEWAYS AT VARIOUS LOCATIONS ON WEST HALF OF 24TH STREET.

NOTE:
DEVICES SEPARATING THE WORK AREA FROM TRAFFIC SHALL BE VERTICAL BARRICADES W/LIGHTS.
DEVICES SEPARATING TRAFFIC SHALL BE FLEXIBLE DELINEATORS, OR GRABBER CONES.
(SEE HIGHWAY STANDARD 701901 FOR DETAIL.)

- STAGE 2**
1. SET UP TRAFFIC CONTROL ACCORDING TO STANDARDS 701331-02, 701606-05, 701701-05, AND 701801-03.
 2. REMOVE AND REPLACE PCC BASE COURSE AT VARIOUS LOCATIONS ON EAST HALF OF 24TH STREET.
 3. REMOVE AND REPLACE SIDEWALK AND DRIVEWAYS AT VARIOUS LOCATIONS ON EAST HALF OF 24TH STREET.



85434

L.A # 06-00180-00-RS
Traffic Control Detail

**CITY OF ROCK ISLAND
ENGINEERING DIVISION**

**24th Street Resurfacing
18th Avenue to 25th Avenue**

<small>Job Number</small> 2569	<small>Date</small> 11-20-2007
<small>Computer Drawing Name</small> 2569 Traffic Control	<small>By</small> msh <small>Sheet</small> 26 <small>of</small> 38