

F.A.U. RTE.	SECTION	COUNTY	TOTAL SHEETS	SHEET NO.
6208	07-00093-00-RP	KANKAKEE	43	20
MG2A# M2-096		CONTRACT NO.: 87342		

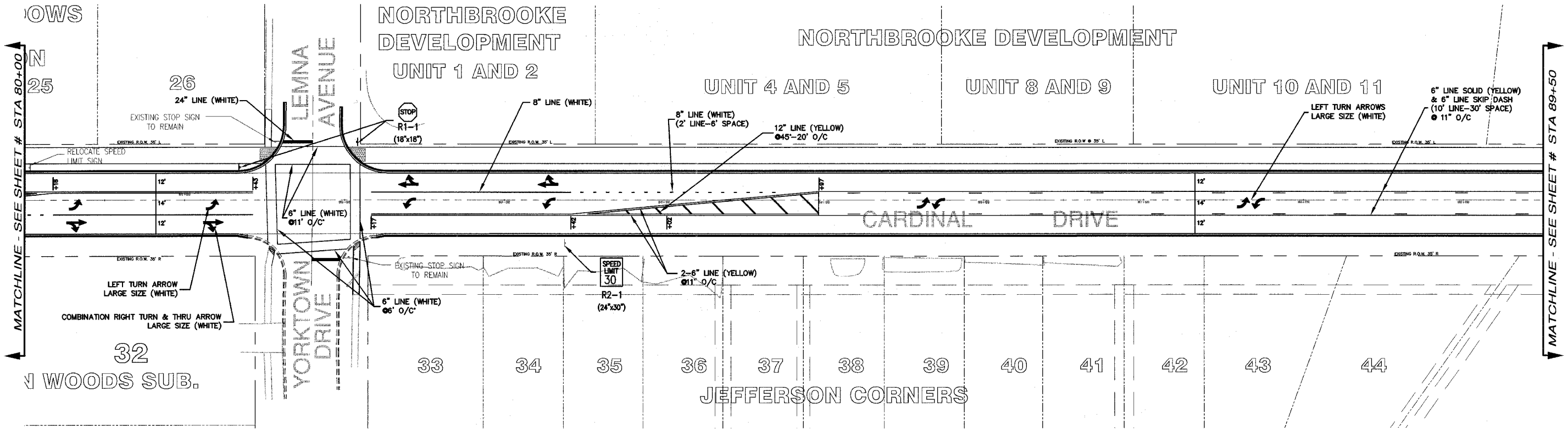
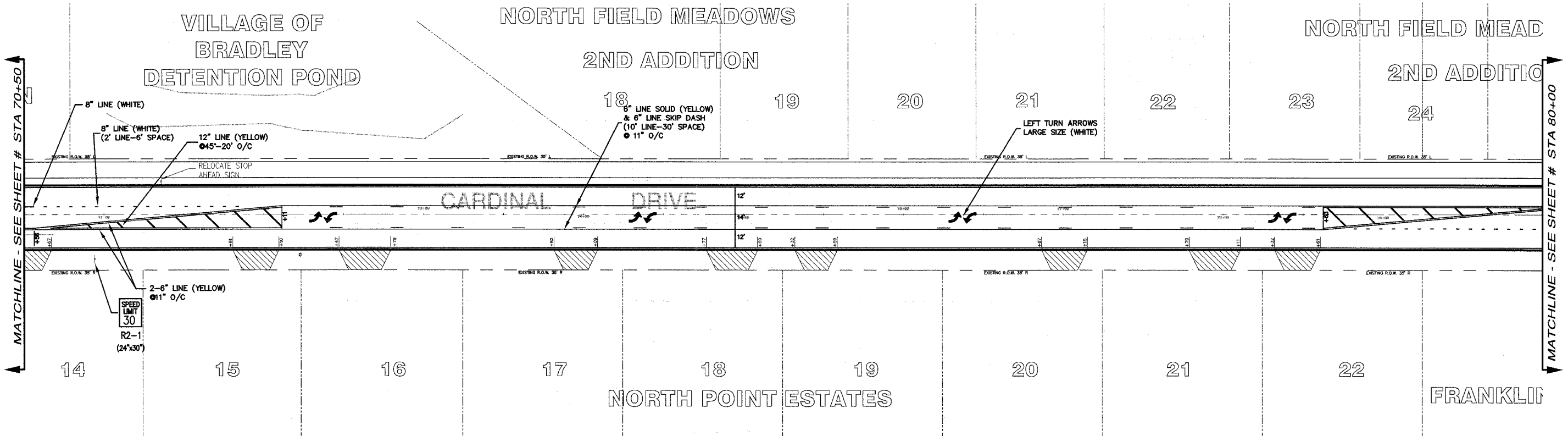

M. GINGERICH, GEREUX & ASSOCIATES

240 N. Industrial Drive
Bradley, Illinois 60915
815-939-4921
FAX: 815-939-9810

REVISIONS		
DATE	BY	DESCRIPTION
2/11/08	AJC/JWP	PER IDOT REVIEW
3/27/08	JWP	PER IDOT REVIEW

ILLINOIS DEPARTMENT OF TRANSPORTATION
PAVEMENT MARKING PLANS
CARDINAL DRIVE
STA 70+50 TO 89+50

SCALE: VERTICAL 1"=3'
HORIZONTAL 1"=30'

DATE: 1/4/08
DRAWN BY: MJO/AJC
CHECKED BY: JWP