

SEC 2,
T. 28 N.,
R. 14 W.,
2ND P.M.

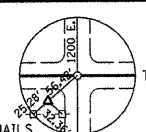

TABLET FO.

A.R. STA 86+60.30 30" CMP
W/ END SECTION ON LT.
USFL 651.06 @ 54.53' RT. STA 86+59.00
DSFL 650.90 @ 18.93' LT. STA 86+61.69

MAG. NAILS
IN PP

CP G
16.40' RT. STA. 85+83.45
1/2" Ø IRON PIN (SET)
N. 1552885.5132
E. 1102656.1004

NO CURVE
PI STA. 86+37.46
 $\Delta = 0^\circ 53' 10.46''$ (LT)
N. 1552903.5281
E. 1102709.5911

LT. STA. 89+41.00
CONSTRUCT 16' F.E.

LT. STA. 91+51.00
CONSTRUCT 28' P.E.

MAG. NAIL
IN 15" Ø CMP

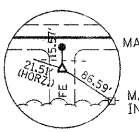

MAG. NAIL
IN PP

CP H
26.20' RT. STA. 96+66.13
1/2" Ø IRON PIN (SET)
N. 1552924.2700
E. 1103738.3800



MATCH LINE STA. 100+00

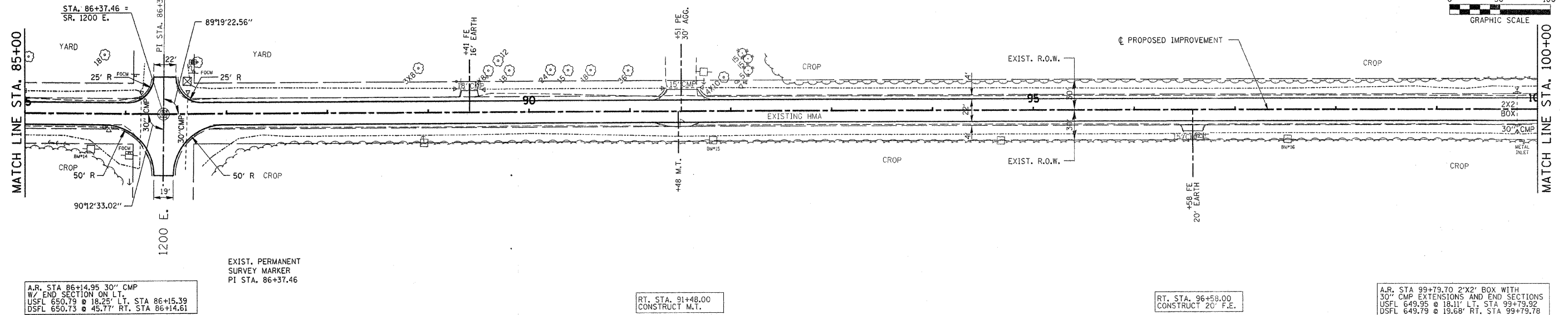

A.R. STA 86+14.95 30" CMP
W/ END SECTION ON LT.
USFL 650.79 @ 18.25' LT. STA 86+15.39
DSFL 650.73 @ 45.77' RT. STA 86+14.61

RT. STA. 91+48.00
CONSTRUCT M.T.

RT. STA. 96+58.00
CONSTRUCT 20' F.E.

A.R. STA 99+79.70 2'x2' BOX WITH
30" CMP EXTENSIONS AND END SECTIONS
USFL 649.95 @ 18.11' LT. STA 99+79.92
DSFL 649.79 @ 19.68' RT. STA 99+79.78

SEC 11, T. 28 N.,
R. 14 W., 2ND P.M.

SEC 12, T. 28 N., R. 14 W., 2ND P.M.

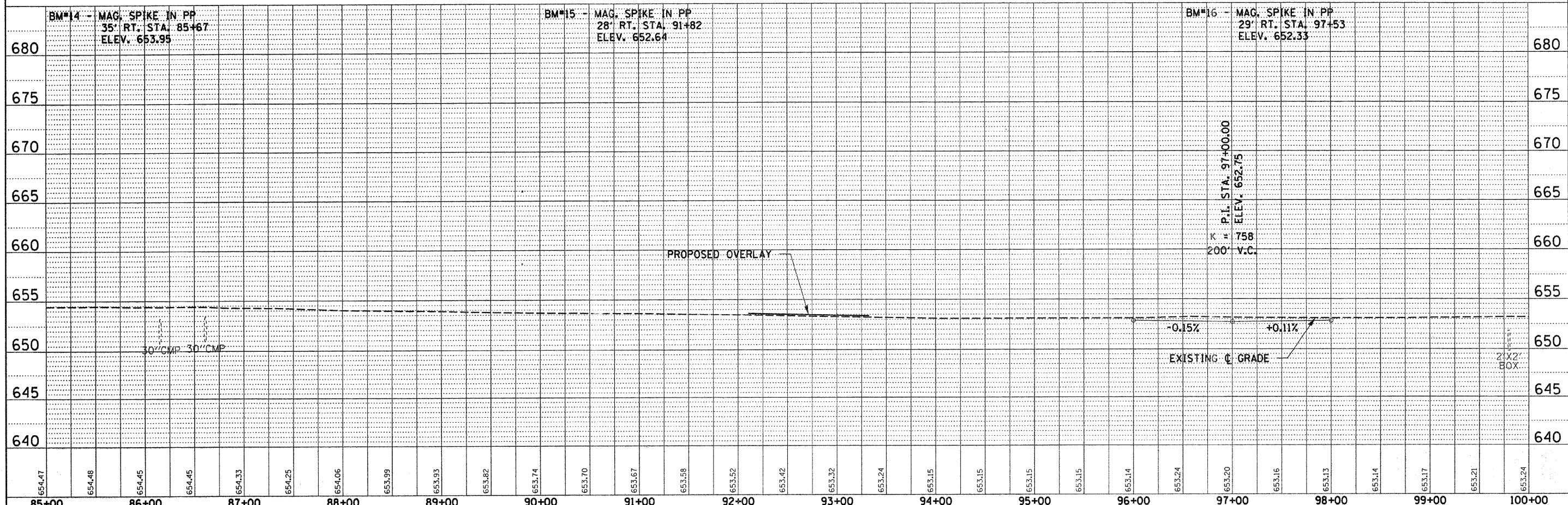

654.47	654.48	654.45	654.45	654.33	654.25	654.06	653.99	653.93	653.82	653.74	653.70	653.67	653.68	653.52	653.42	653.32	653.24	653.15	653.15	653.15	653.15	653.14	653.24	653.20	653.16	653.13	653.14	653.17	653.21	653.24
85+00	86+00	87+00	88+00	89+00	90+00	91+00	92+00	93+00	94+00	95+00	96+00	97+00	98+00	99+00	100+00															

FILE NAME = 46802-shp-pp07.dgn
USER NAME =
DESIGNED -
DRAWN -
CHECKED -
DATE -
PLOT SCALE =
PLOT DATE = 5/13/2008

DESIGNED -
DRAWN -
CHECKED -
DATE -
REVISED -
REVISED -
REVISED -
REVISED -

STATE OF ILLINOIS
DEPARTMENT OF TRANSPORTATION

HLR HAMPTON, LENZINI & RENWICK, INC.
CIVIL & STRUCTURAL ENGINEERS
LAND SURVEYORS

PLAN & PROFILE
F.A.S. 321/CH 4

F.A.S. 321	SECTION 05-00205-02-RS	COUNTY IROUOIS	TOTAL SHEETS 76	SHEET NO. 15
SCALE: SHEET NO. OF SHEETS STA. 85+00.00 TO STA. 100+00.00		CONTRACT NO. 87363		

DATE	BY

DATE	BY

DATE	BY