

BILL OF MATERIAL

(South Abutment Retaining Walls and Columns)

Bar	No.	Size	Length	Shape
h(E)	88	#5	17'-2"	
h1(E)	16	#5	20'-0"	
h2(E)	32	#5	3'-8"	
n(E)	96	#5	7'-0"	
n1(E)	200	#5	4'-7"	
n2(E)	24	#6	3'-8"	
s(E)	20	#5	9'-11"	
t(E)	48	#8	22'-3"	
t1(E)	47	#5	21'-7"	
t2(E)	51	#5	20'-5"	
t3(E)	6	#5	23'-6"	
t4(E)	4	#5	22'-3"	
v(E)	48	#8	8"-10"	
v1(E)	26	#5	11'-9"	
v2(E)	26	#5	5'-5"	
v3(E)	48	#8	9'-7"	
v4(E)	26	#5	8'-11"	
v5(E)	48	#5	6'-10"	
v6(E)	26	#5	6'-2"	
v7(E)	48	#5	4'-1"	
v8(E)	26	#5	3'-5"	
v9(E)	24	#6	9'-1"	
w(E)	90	#5	17'-4"	
w1(E)	30	#5	20'-7"	
w2(E)	4	#5	3'-8"	
w3(E)	15	#5	11'-2"	
w4(E)	30	#5	11'-11"	
w5(E)	45	#5	7'-3"	
w6(E)	12	#5	7'-1"	
Structure Excavation			Cu. Yd.	293
Concrete Structures			Cu. Yd.	150.8
Reinforcement Bars, Epoxy Coated			Pound	16,730

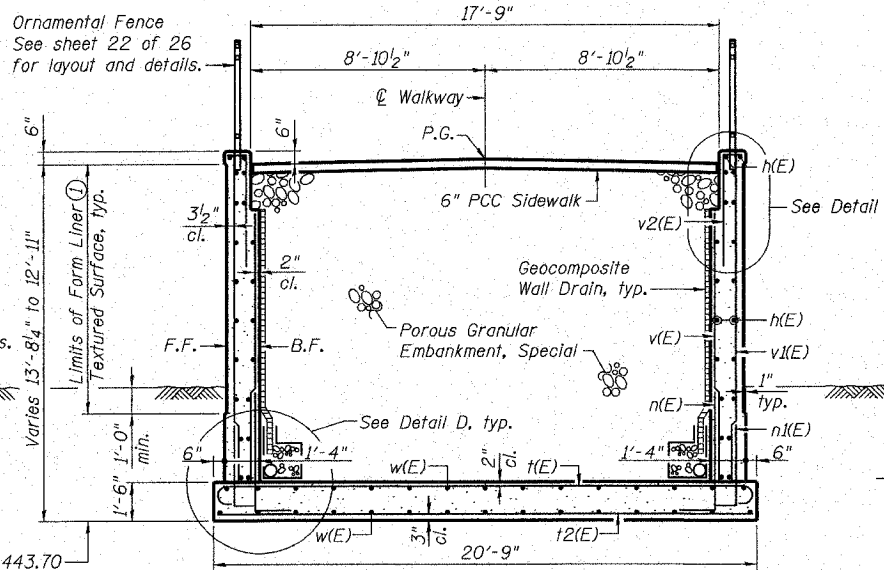

SECTION B-B

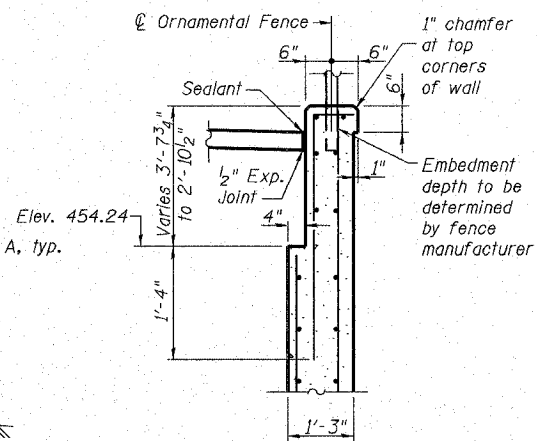

DETAIL A

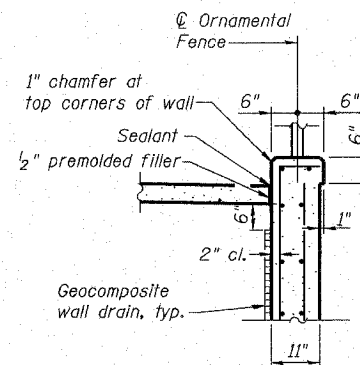

DETAIL B

A & B DIMENSIONS

Bar	A	B
n(E)	5'-8"	1'-4"
n1(E)	3'-9"	10"
v2(E)	4'-9"	8"
v3(E)	8'-11"	8"
v5(E)	6'-2"	8"
v7(E)	3'-5"	8"

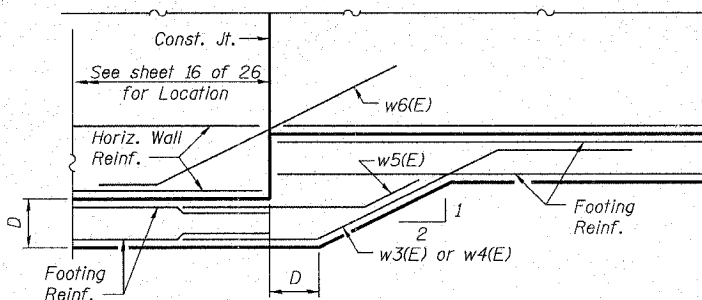

DETAIL C

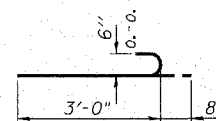

BAR n2(E)

BARS n(E), n1(E), v2(E), v3(E), v5(E) & v7(E)

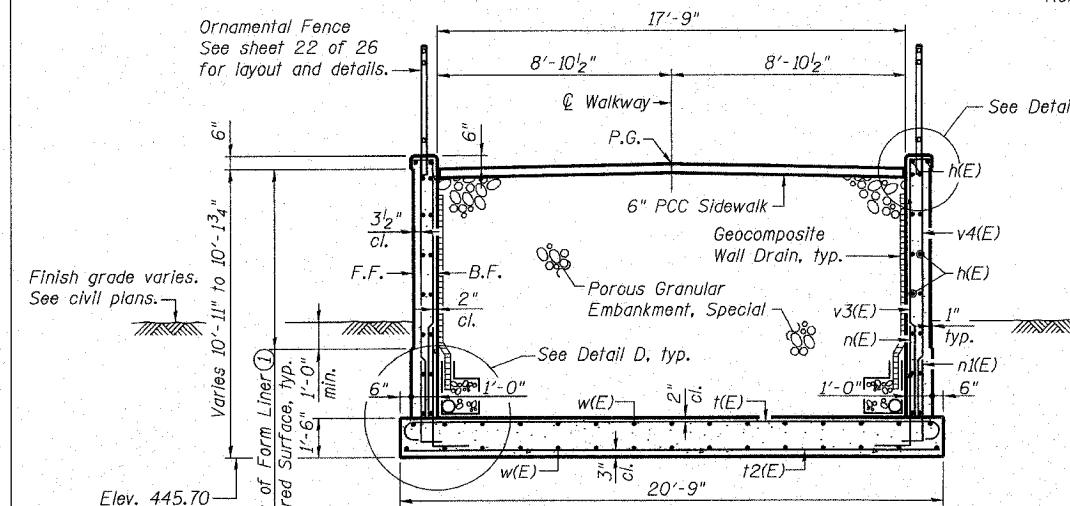

SECTION C-C

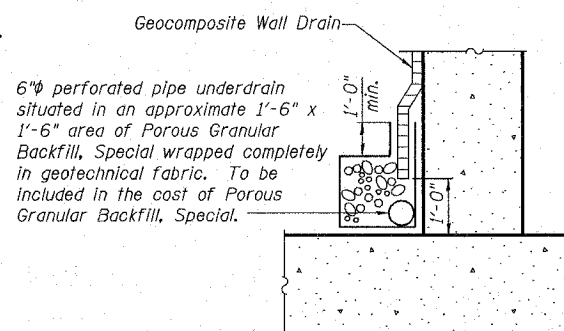

DETAIL D

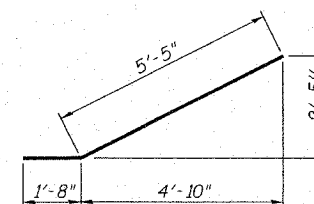

BAR w6(E)

C, D & E DIMENSIONS

Bar	C	D	E
t(E)	11"	20'-5"	8"
t1(E)	7"	20'-5"	5"
t3(E)	7"	22'-4"	5"

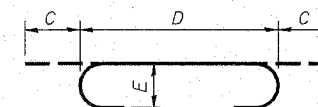

BARS t(E), t1(E) & t3(E)

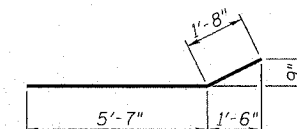

BAR w5(E)

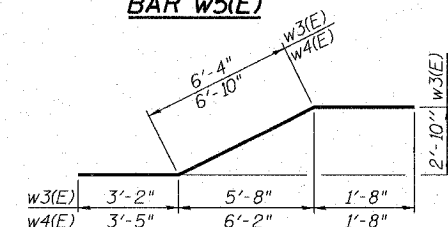

BARS w3(E) & w4(E)

Outlet pipe shall extend until intersecting with the side slopes. The pipe shall drain into concrete headwalls. See Article 601.05 of the Standard Specifications and Highway Standard 601101. To be included in the cost of Porous Granular Backfill, Special.

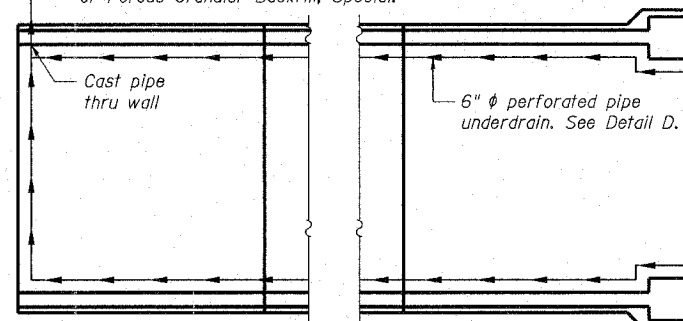

PIPE UNDERDRAIN LAYOUT

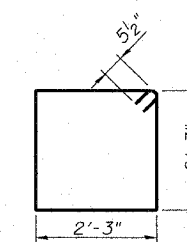

BAR s(E)

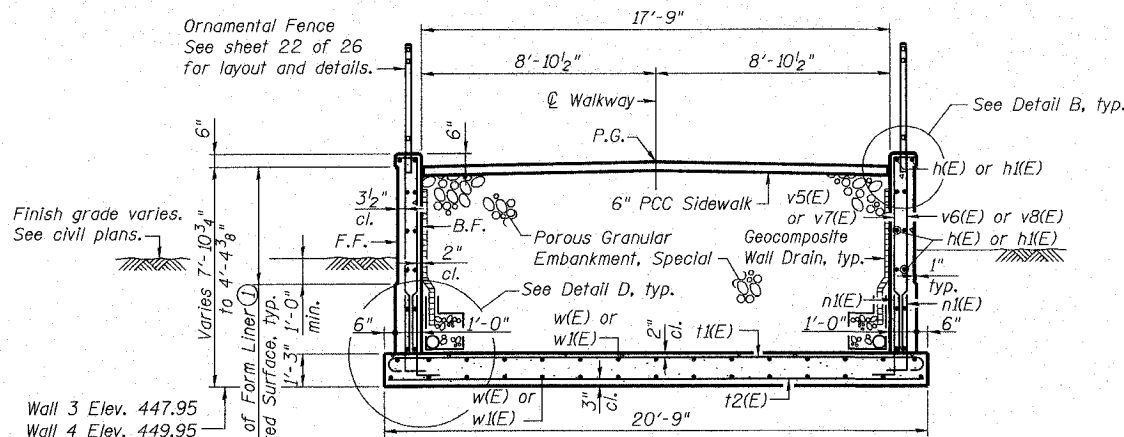

SECTION D-D

- Notes:
- See sheet 18 of 26 for limits of Form Liner Textured Surface and Rubbed Finish.
 - All edges shall have 1/2 inch chamfer unless noted otherwise.
 - B.F. denotes back face. F.F. denotes front face.

**SOUTH ABUTMENT RETAINING WALL
PLAN AND DETAILS
ALTON PEDESTRIAN WALKWAY OVER
UNION PACIFIC RAILROAD, NORFOLK
SOUTHERN RAILROAD AND US ROUTE 67
SECTION 06-00224-00-BR
MADISON COUNTY
STA. 2+42.54
STRUCTURE NO. 060-6111**

REVISIONS

Esport Business Center 1
100 Lister Court, Suite 1
Cullman, Illinois 62224
Phone: 618-342-2500
Fax: 618-342-7233
e-mail: info@oatesassociates.com
web-site: www.oatesassociates.com



ALTON, ILLINOIS
PEDESTRIAN OVERPASS AT LANGDON ST.

DWG. NO. S17
6111-26-SOUTHABT111.DGN
REF. BK. PG.
JOB NO.
DSN. BY: DCL
DWN. BY: NEL
CHK. BY: NEL
DATE: 3/28/08
SCALE:
SHEET 37 OF 54