

F.A. RTE.	SECTION	COUNTY	TOTAL SHEETS	SHEET NO.
9315	05-00032-02-PV	MONROE	55	38
STA.		TO STA.		
FED. ROAD DIST. NO.		ILLINOIS	FED. AID PROJECT	

BY	DATE

BY	DATE

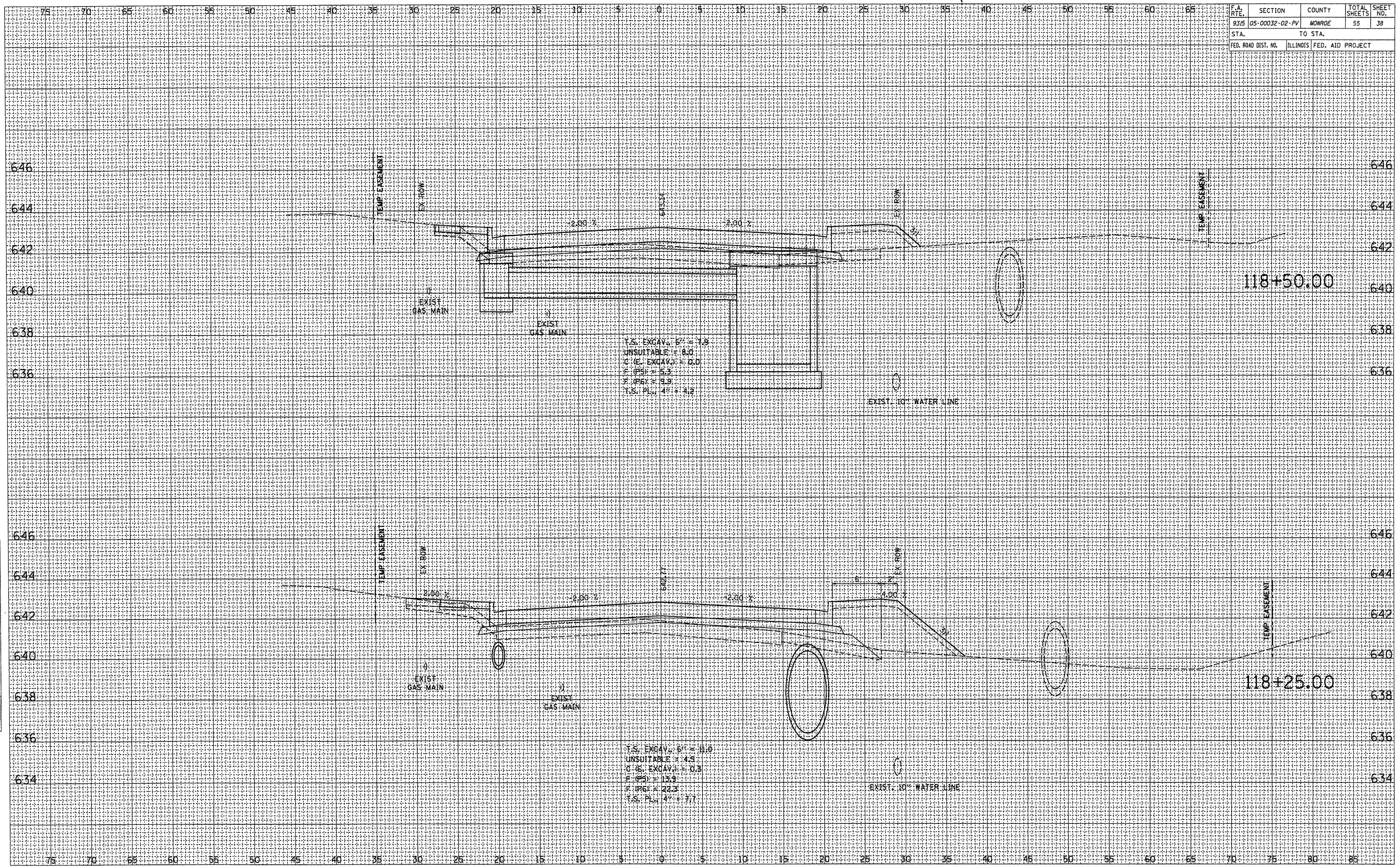

T.S. EXCAV. 5' = 7.8
 UNSUITABLE = 8.0
 C.I.C. EXCAV. = D.D
 F.(P5) = 5.3
 F.(P6) = 9.9
 T.S. PL. 4' = 4.2

T.S. EXCAV. 6' = 11.0
 UNSUITABLE = 4.5
 C.I.C. EXCAV. = 0.3
 F.(P5) = 13.9
 F.(P6) = 23.3
 T.S. PL. 4' = 7.7