



DATE	
BY	
FINAL SURVEY	
SHRIFTED	
NOTE BOOK	
AREAS CHECKED	

DATE	
BY	
ORIGINAL SURVEY	
SHRIFTED	
NOTE BOOK	
AREAS CHECKED	

CONTRACT NO. 98999	
FAP RTE 869	SECTION (105A)B-1
COUNTY SALINE	TOTAL SHEETS 71
STA. 1649+50.00	TO STA. 1650+49.10
FED. ROAD DIST. NO.	ILLINOIS FED. AID PROJECT

SCALES
HORIZ.: 1"=10'
VERT.: 1"=5'

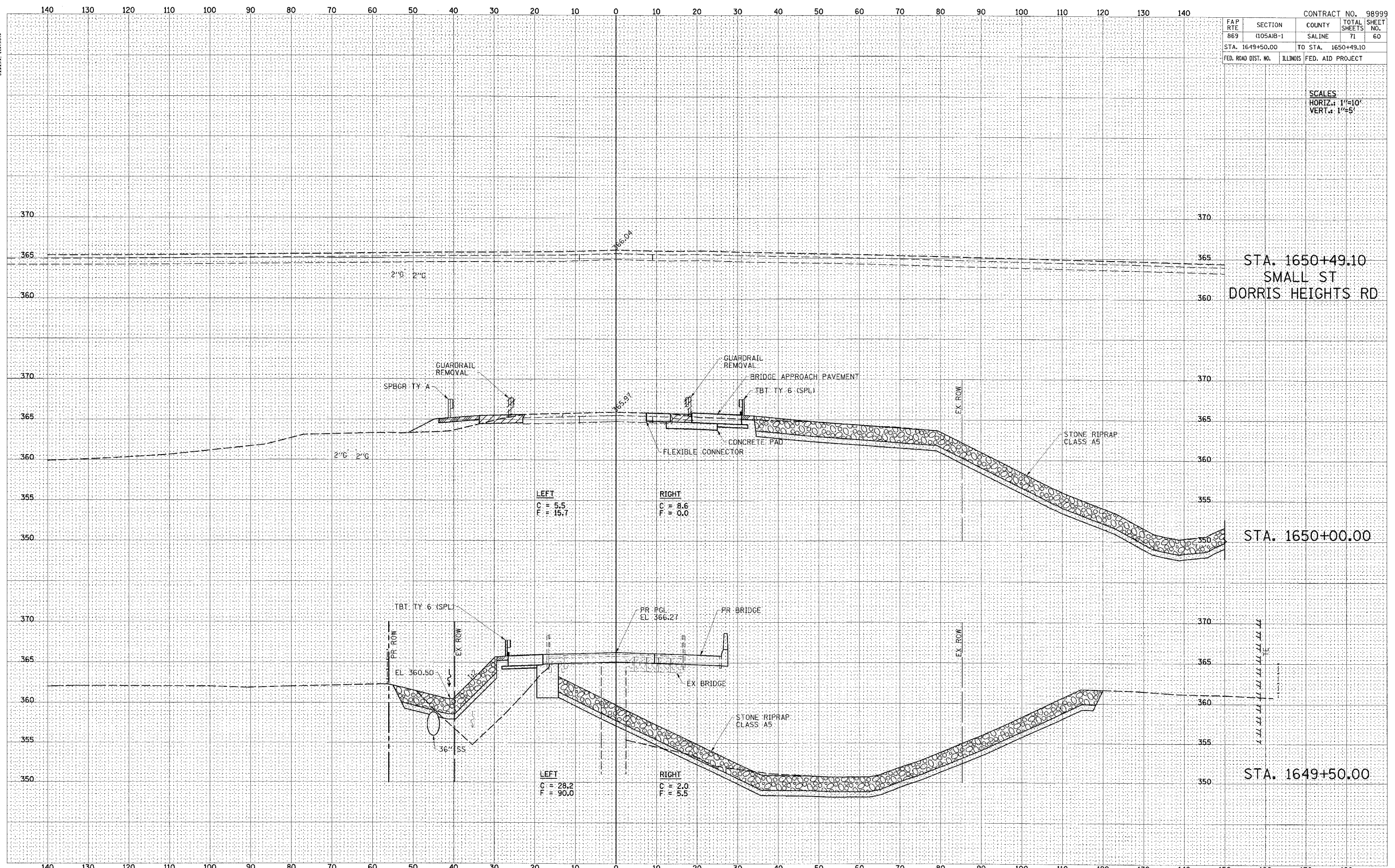

STA. 1650+49.10
SMALL ST
DORRIS HEIGHTS RD

STA. 1650+00.00

STA. 1649+50.00

LEFT
C = 5.5
F = 15.7

RIGHT
C = 8.6
F = 0.0

LEFT
C = 28.2
F = 90.0

RIGHT
C = 2.0
F = 5.5