

CONSTRUCTION PLANS

FOR

BENTON MUNICIPAL AIRPORT

REHABILITATE ENTRANCE ROAD AND PARKING LOT

ILLINOIS PROJECT NUMBER: H96-3753

AIP PROJECT NUMBER: 3-17-0005-B10

BENTON, ILLINOIS

DATE: JUNE 27, 2008

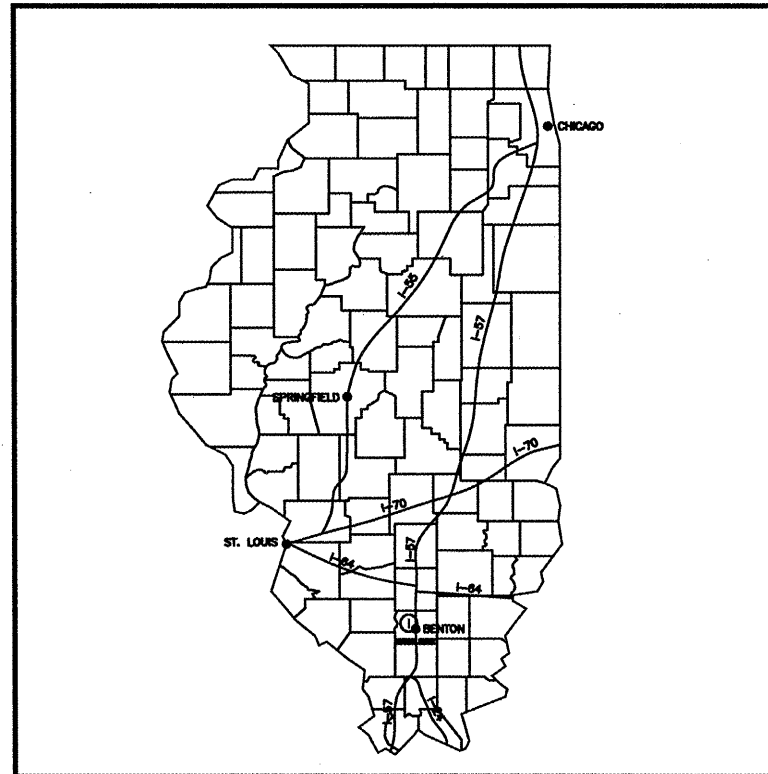

LOCATION MAP

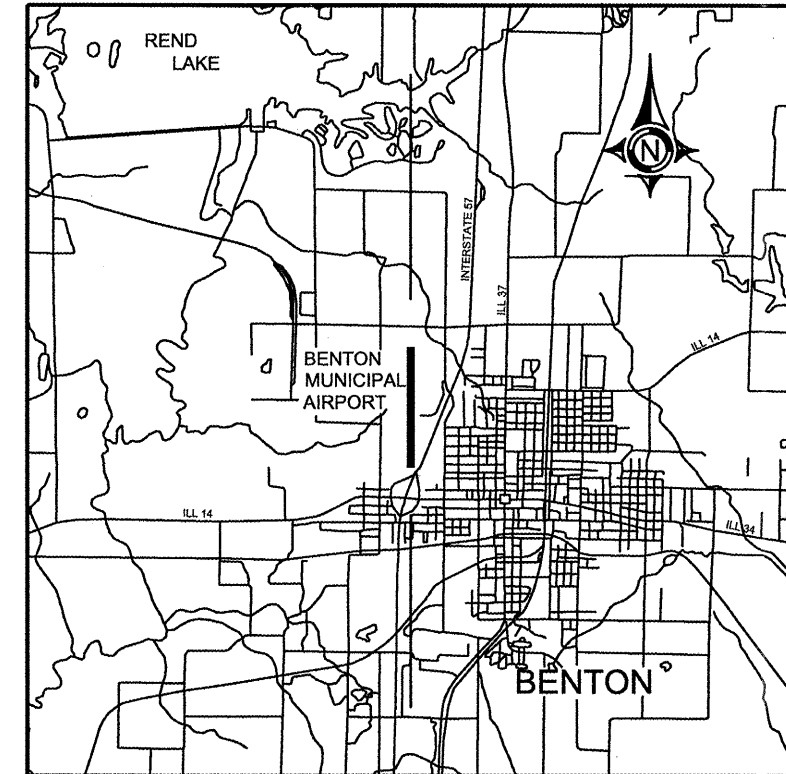

VICINITY MAP

BROWN AND ROBERTS, INC.
CONSULTING ENGINEER
PRESIDENT

SUBMITTED BY *Jim W. Brown*
JIM W. BROWN

DATE SUBMITTED 06/27/08

LISC. NUMBER 184-002518

LISC. EXP. DATE APRIL 30, 2009

PLANS PREPARED BY:



BROWN AND ROBERTS, INC.
1 WEST RIDGE ROAD
HARRISBURG, IL. 62946
(618) 252-8111

BENTON MUNICIPAL AIRPORT
CHAIRMAN

APPROVED BY *Michael J. Wyant*
MICHAEL J. WYANT CHAIRMAN

DATE 06/27/08

SUMMARY OF QUANTITIES

<u>ITEM NO.</u>	<u>DESCRIPTION</u>	<u>UNIT</u>	<u>QUANTITY</u>
AR152411	UNCLASSIFIED EXCAVATION	L.S.	1
AR201610	BITUMINOUS BASE COURSE	TON	875
AR209700	CRUSHED AGG. SHOULDER	S.Y.	1,700
AR401610	BITUMINOUS SURFACE COURSE	TON	650
AR603510	BITUMINOUS TACK COAT	GAL.	2,200
AR701312	12" RCP, CLASS II	L.F.	100
AR901525	SEEDING	L.S.	1

INDEX TO SHEETS

<u>SHEET NO.</u>	<u>DESCRIPTION</u>
1	COVER SHEET
2	SUMMARY OF QUANTITIES
3	RUNWAY SAFETY PLAN
4	EXISTING SITE & CONSTRUCTION PLAN
5	TYPICAL DETAILS
6-7	ENTRANCE ROAD PLAN
8-11	CROSS SECTIONS

SCOPE OF WORK

THE PROJECT SCOPE CONSISTS OF A BITUMINOUS CONCRETE OVERLAY OF THE AIRPORT ENTRANCE ROAD AND PARKING LOT.

PROPOSED SAFETY PLAN

GENERAL- THE BENTON MUNICIPAL AIRPORT CURRENTLY HAS A PAVED NORTH-SOUTH RUNWAY (4000-FT BY 75-FT).

CONTRACTOR'S RESPONSIBILITIES

IDENTIFICATION- THE CONTRACTOR'S VEHICLES AND EQUIPMENT SHALL BE PROPERLY MARKED WITH 3-FOOT SQUARE INTERNATIONAL ORANGE AND WHITE CHECKERED FLAGS ANYTIME THEY ARE ON AIRPORT PROPERTY.

THE CONTRACTOR AND HIS EMPLOYEES SHALL BE RESTRICTED TO THE WORK AREA. IT IS ANTICIPATED THAT NO CONSTRUCTION ACTIVITIES ASSOCIATED WITH THIS PROJECT WILL IMPACT ANY AIRCRAFT OPERATIONS ON THE AIRPORT RUNWAYS.

EQUIPMENT PARKING AND STORAGE- THE CONTRACTOR'S EQUIPMENT PARKING, STORAGE, AND EMPLOYEE PARKING WILL BE AT THE LOCATION SHOWN ON THIS SHEET. ONLY CONTRACTOR VEHICLES AND EQUIPMENT REQUIRED FOR CONSTRUCTION WILL BE ALLOWED OUTSIDE THIS AREA.

BARRICADES AND TRAFFIC CONES- IT WILL BE THE CONTRACTOR'S RESPONSIBILITY TO PLACE AND MAINTAIN BARRICADES AND TRAFFIC CONES AS REQUIRED AND AS DIRECTED BY THE RESIDENT ENGINEER. BARRICADES, THEIR MAINTENANCE, PLACEMENT, AND REMOVAL WILL BE CONSIDERED AS AN INCIDENTAL ITEM TO THE CONTRACT AND NO ADDITIONAL COMPENSATION WILL BE ALLOWED.

THE CONTRACTOR WILL NOT BE ALLOWED ON ANY AIRPORT PAVEMENT. THE CONTRACTOR WILL BE RESPONSIBLE FOR REPAIRING ANY DAMAGE TO EXISTING PAVEMENTS CAUSED BY HIS PERSONNEL OR EQUIPMENT.

HAUL ROUTE AND EQUIPMENT PARKING

THE CONTRACTOR WILL USE THE DESIGNATED HAUL ROUTE AND EQUIPMENT PARKING AREA SHOWN ON THIS SAFETY PLAN. THE PROPOSED EQUIPMENT PARKING AREA WILL BE APPROXIMATELY 100-FT BY 200-FT. THE CONTRACTOR WILL BE REQUIRED TO MAINTAIN THE PROPOSED HAUL ROUTE AND PARKING AREA THROUGHOUT THE COURSE OF THE PROJECT. AT THE CONCLUSION OF THE PROJECT, ALL AREAS DISTURBED WILL BE RESTORED AS NEEDED TO ITS ORIGINAL STATE. RESTORATION OF THE HAUL ROUTE AND EQUIPMENT PARKING AREA WILL BE CONSIDERED INCIDENTAL TO THE PROJECT AND NO ADDITIONAL COMPENSATION WILL BE ALLOWED.

UTILITY NOTE

THE CONTRACTOR IS RESPONSIBLE FOR CONTACTING ALL UTILITY COMPANIES AND ORGANIZATIONS THAT HAVE LINES OR CONDUITS IN THE PROPOSED WORK AREA. ALL LINES AND CONDUITS SHALL BE LOCATED AND IDENTIFIED FOR DEPTH BEFORE ANY EXCAVATION BEGINS. THE CONTRACTOR SHALL CALL JULIE (1-800-892-0123) TO ACCOMPLISH THESE REQUIREMENTS. THE CONTRACTOR IS RESPONSIBLE FOR IDENTIFYING ALL NON-JULIE UTILITIES LOCATED WITHIN THE PROPOSED CONSTRUCTION LIMITS. THESE UTILITIES ARE TO BE LOCATED PRIOR TO THE START OF CONSTRUCTION.

J.U.L.I.E. INFORMATION

COUNTY.....FRANKLIN
CITY.....BENTON
TOWNSHIP.....BROWNING
SECTION NO.....12 & 13
NEAREST MAJOR ROAD INTERSECTION...RT 37 PETROFF RD.
AIRPORT ADDRESS...BENTON MUNICIPAL AIRPORT
P.O. BOX 158
BENTON, IL. 62812

AIRPORT SECURITY

AIRPORT SECURITY WILL BE MAINTAINED AT ALL TIMES. THE PROPOSED HAUL ROUTE SHOWN ON THIS SAFETY PLAN IS THE ONLY ACCESS CONTRACTOR EQUIPMENT AND PERSONNEL WILL BE ALLOWED TO USE. THE CONTRACTOR SHALL PROVIDE BARRICADES AT THIS ACCESS AND ENSURE THE BARRICADES ARE IN PLACE AT THE END OF EACH WORKING DAY.

AIRCRAFT OPERATIONAL AREA

THE CONTRACTOR, HIS EMPLOYEES, OR ANY EQUIPMENT WILL NOT BE ALLOWED WITHIN THE AIRCRAFT OPERATIONAL AREA.

HEIGHT OF CONSTRUCTION EQUIPMENT

THE MAXIMUM ANTICIPATED HEIGHT OF THE CONSTRUCTION EQUIPMENT IS 20 FEET. THE TALLEST EQUIPMENT IS EXPECTED TO BE A SEMI-TRUCK IN THE UP POSITION.

BENTON MUNICIPAL AIRPORT
IL PROJECT NO. H96-3753
AIP NO. 3-17-0050-B10
RUNWAY SAFETY PLAN
SHEET 3 OF 11

BN013

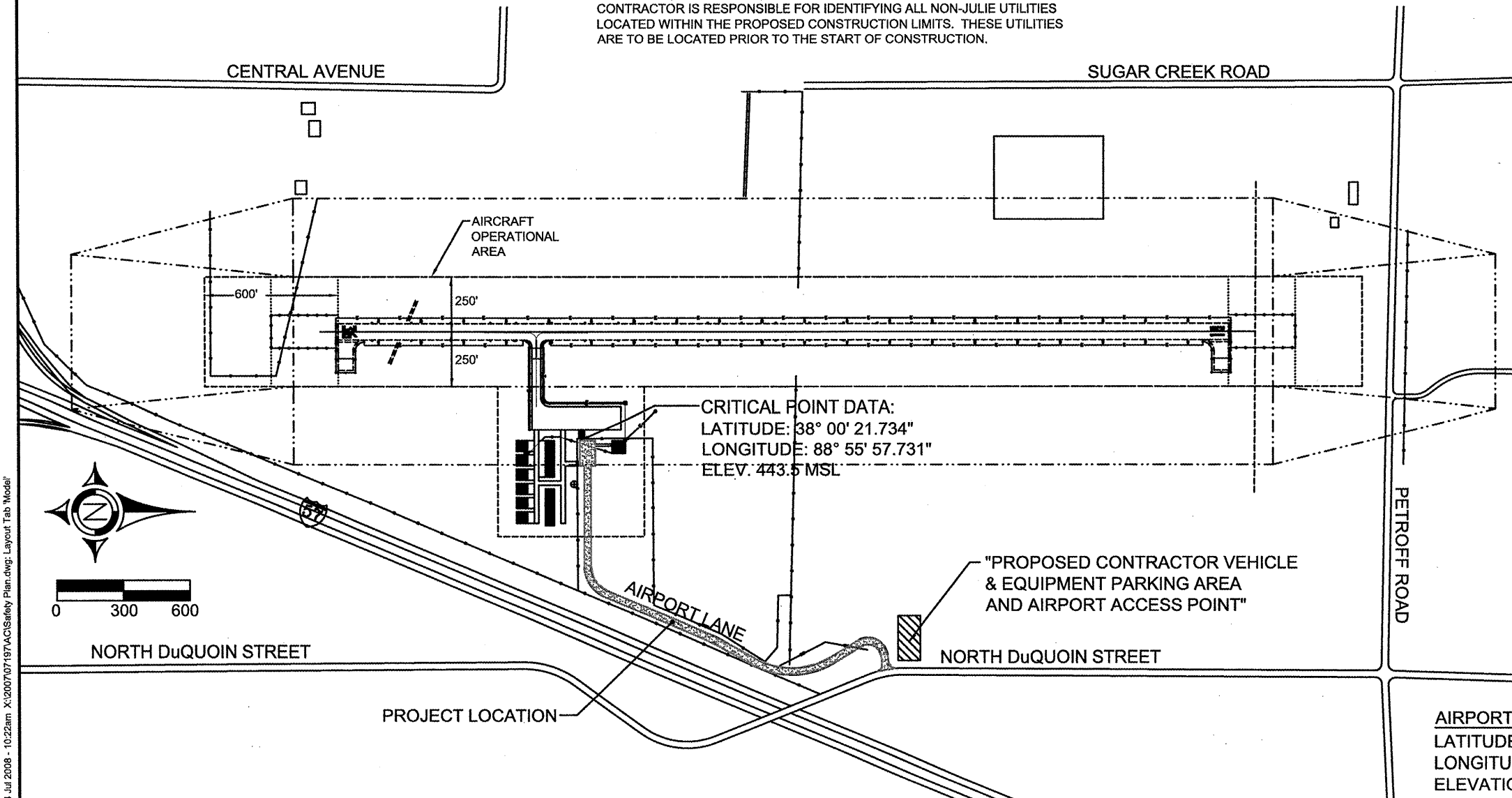

AIRPORT REFERENCE POINT:
LATITUDE: 38° 00' 24.334"N
LONGITUDE: 88° 56' 03.910"LN
ELEVATION: 444 MSL

14 Jul 2008 - 10:22am X:\2007\07197\ACIS\Safety Plan.dwg: Layout Tab Model

BN013

COORDINATE DATA				
NO	DESCRIPTION	NORTHING	EASTING	ELEV.
1	NGS POINT	489859.94	810945.20	440.16
2	NGS POINT	488030.31	810964.74	437.37
3	C STA 29+00	489809.14	811052.77	
4	C STA 46+00	491509.10	811042.15	

LEGEND

CONSTRUCTION LIMITS - - - - -

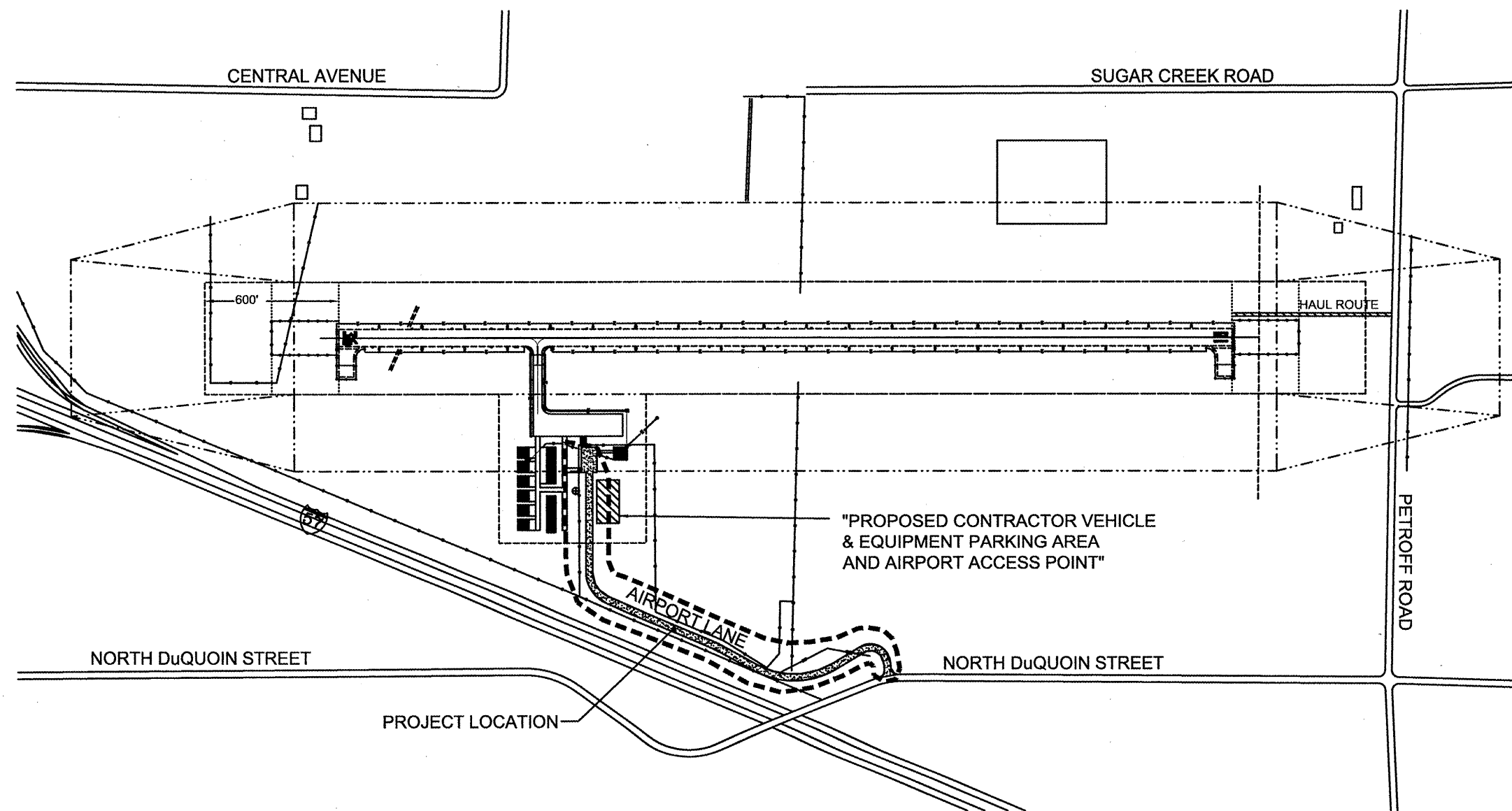
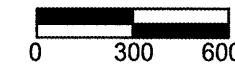

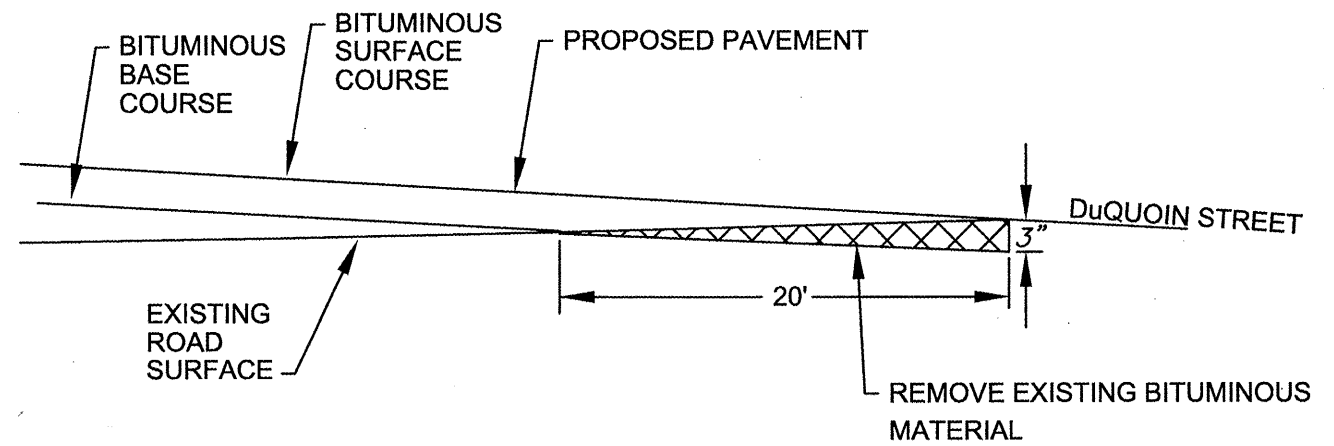

BUTT JOINT DETAIL
NO SCALE

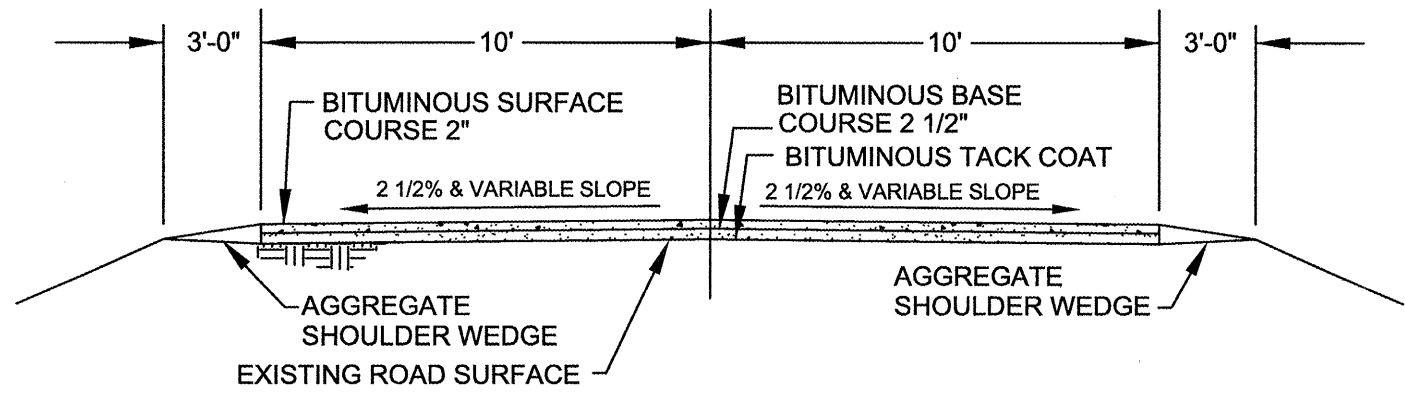

ENTRANCE ROAD SECTION
NO SCALE

NOTE: ENTRANCE ROAD AND PARKING LOT CROSS SLOPES ARE TO BE PROVIDED BY THE ENGINEER

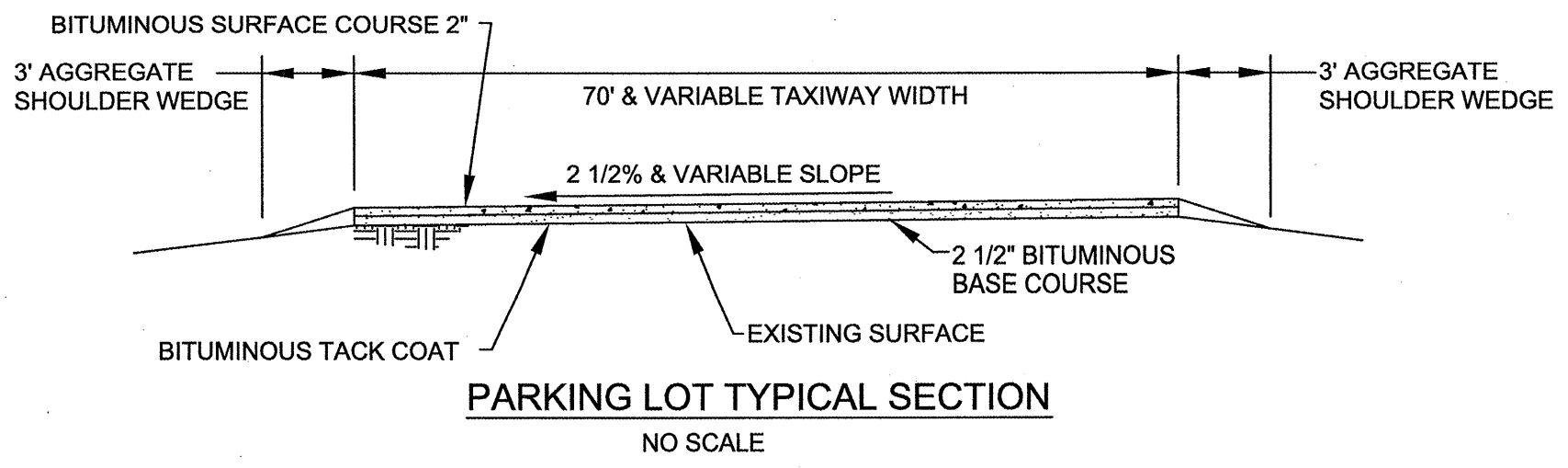

PARKING LOT TYPICAL SECTION
NO SCALE

14 Jul 2008 - 10:28am X:\2007\0719\AC\Typical Details.dwg: Layout Tab 'Model'

BENTON MUNICIPAL AIRPORT
 IL PROJECT NO. H96-3753
 AIP NO. 3-17-0050-B10
 ENTRANCE ROAD PLAN VIEW
 SHEET 6 OF 11

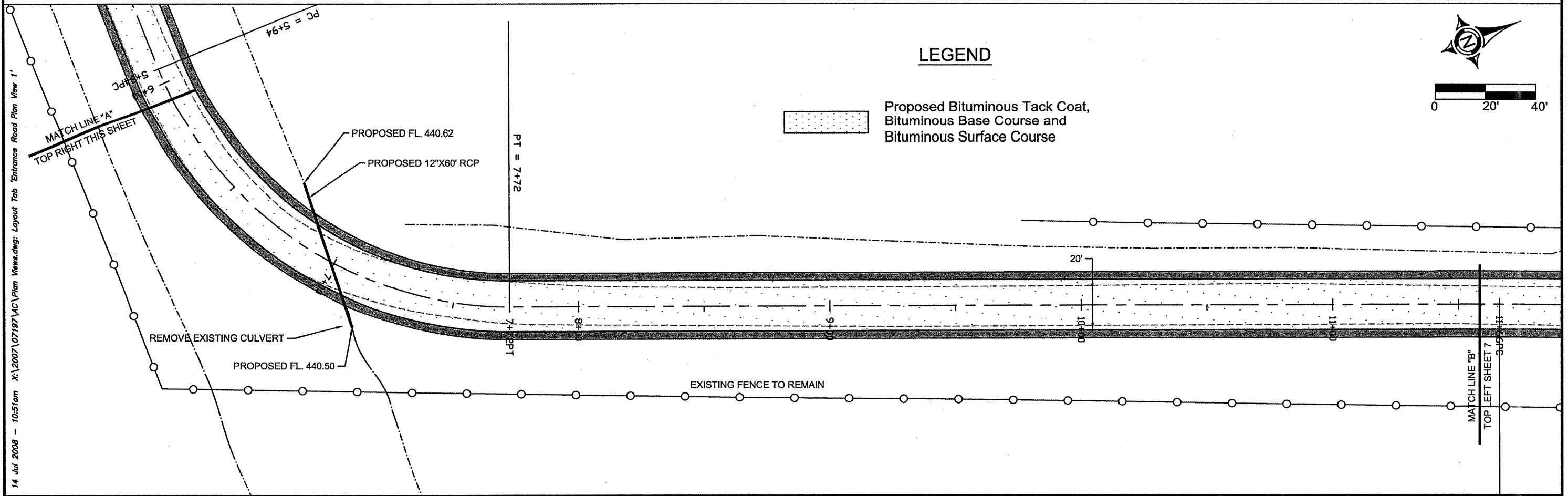
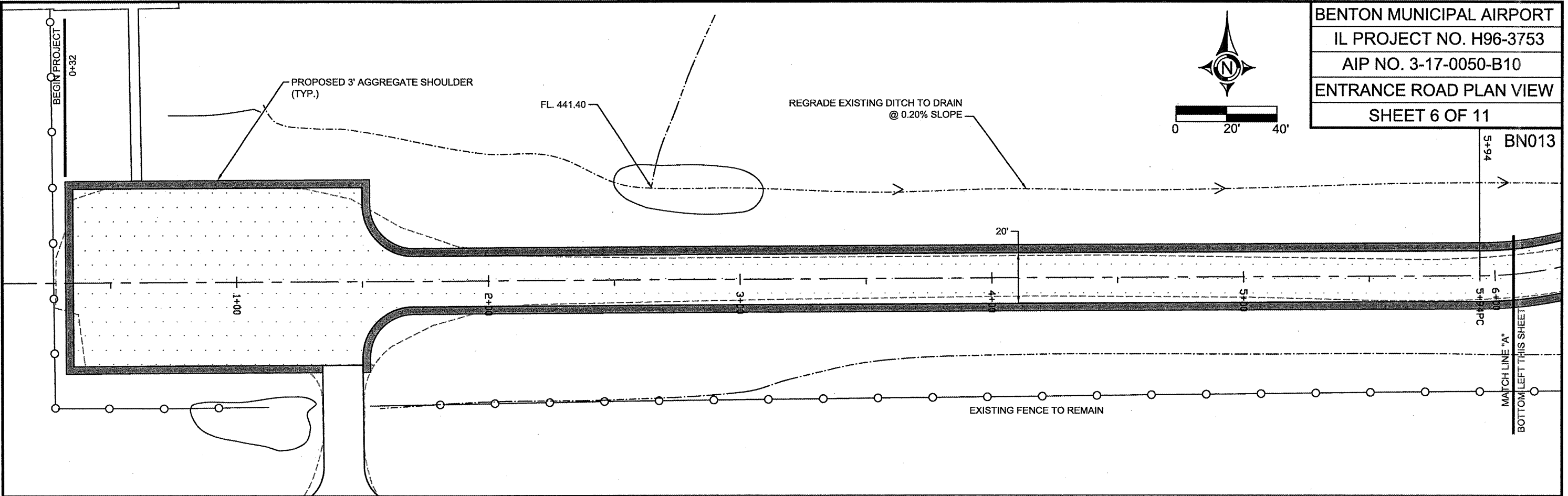
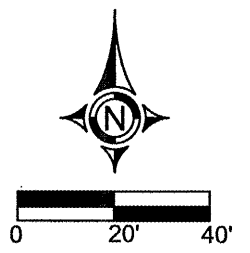

LEGEND

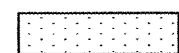
 Proposed Bituminous Tack Coat, Bituminous Base Course and Bituminous Surface Course

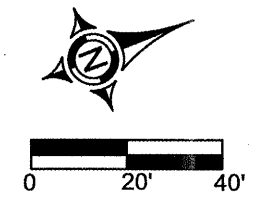

14 Jul 2008 - 10:51am X:\2007\07197\AC\Plan Views.dwg: Layout Tab Entrance Road Plan View 1'

BN013

LEGEND

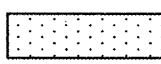
 Proposed Bituminous Tack Coat, Bituminous Base Course and Bituminous Surface Course

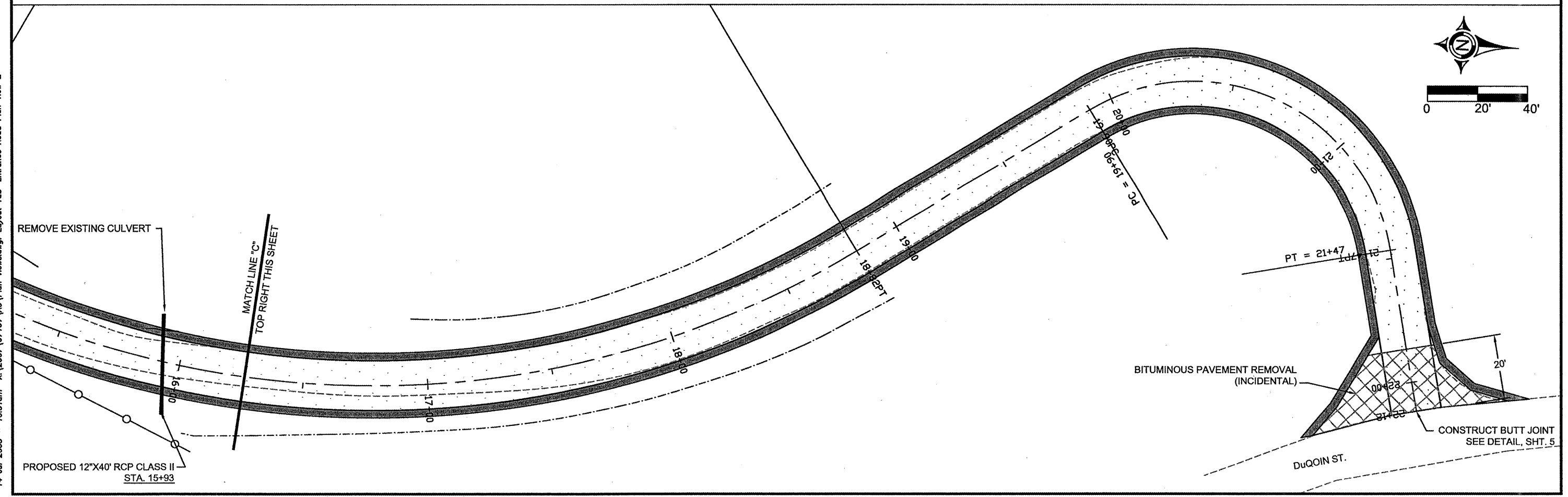
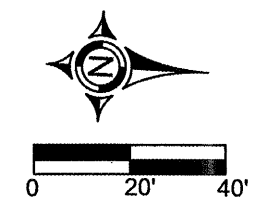
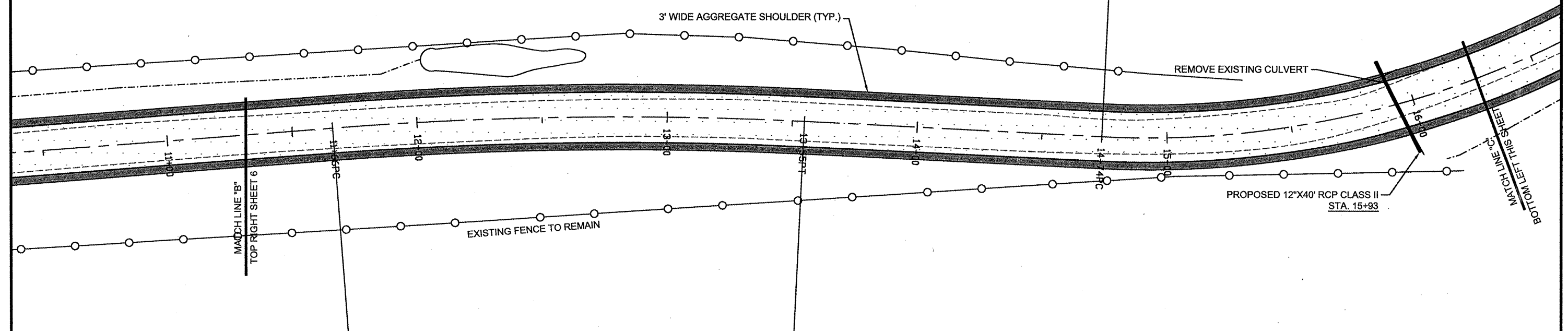
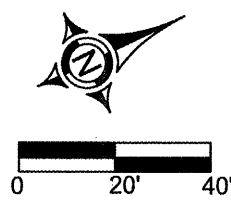

14 Jul 2008 - 10:51am X:\2007\07197\MC\Plan Views.dwg: Layout Tab Entrance Road Plan View 2'

ENTRANCE ROAD AND PARKING LOT OVERLAY	COUNTY	TOTAL SHEETS	SHEET NUMBER
	FRANKLIN	8	11

BENTON MUNICIPAL AIRPORT

BN013

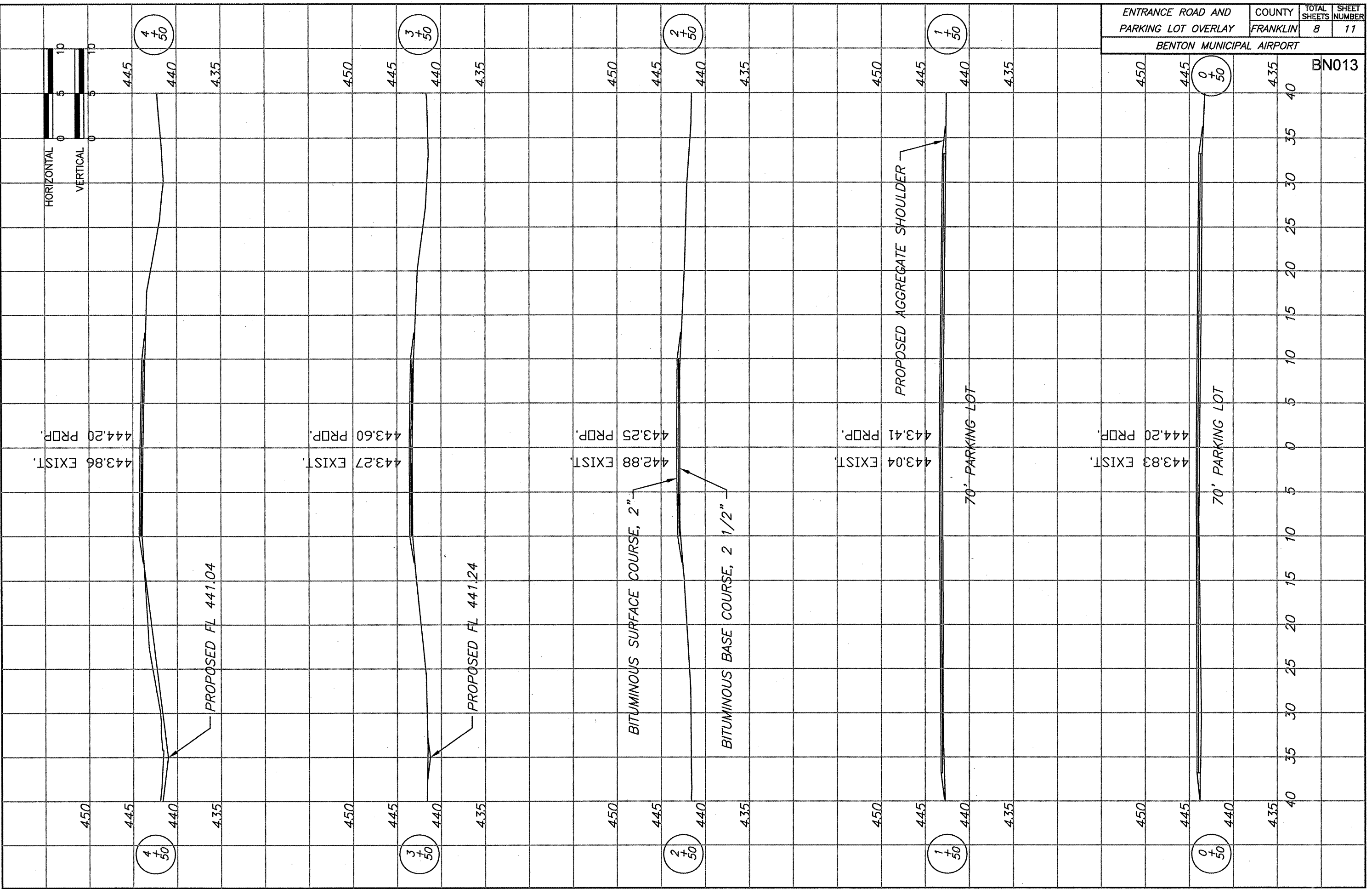

ENTRANCE ROAD AND PARKING LOT OVERLAY	COUNTY	TOTAL SHEETS	SHEET NUMBER
	FRANKLIN	9	11
BENTON MUNICIPAL AIRPORT			BN013

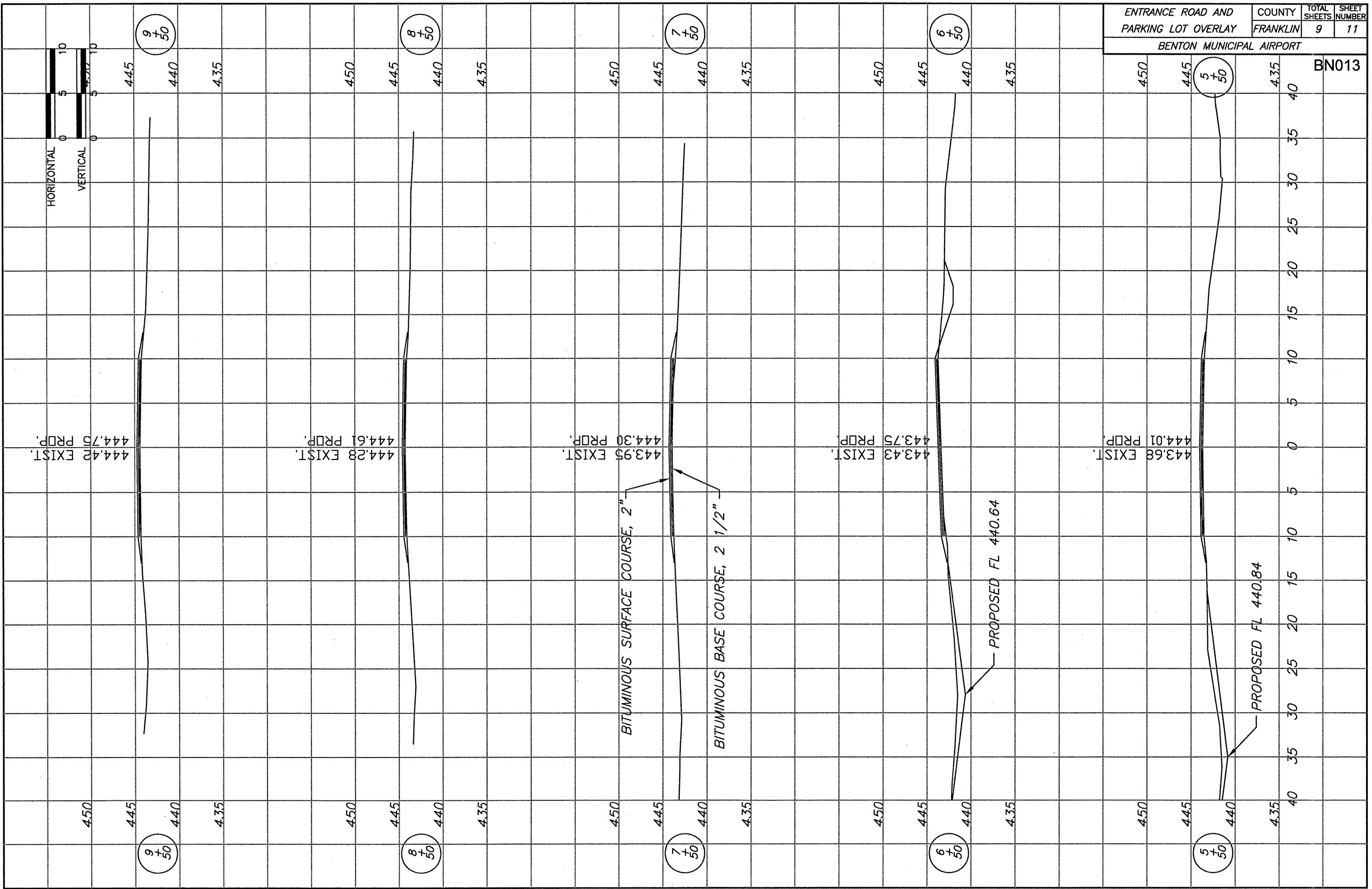

ENTRANCE ROAD AND PARKING LOT OVERLAY	COUNTY	TOTAL SHEETS	SHEET NUMBER
	FRANKLIN	10	11
BENTON MUNICIPAL AIRPORT			
450	445	440	435
			BN013

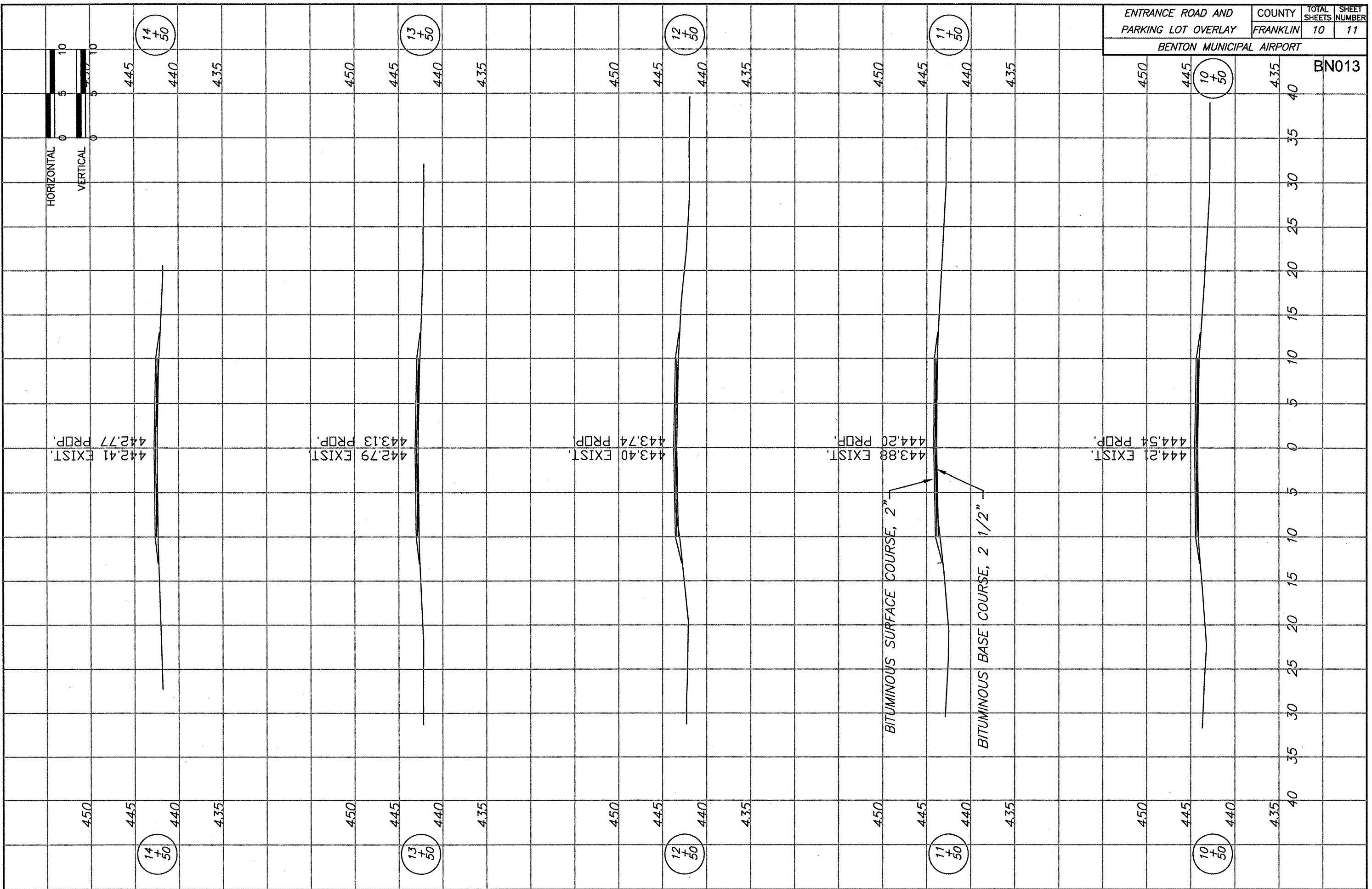
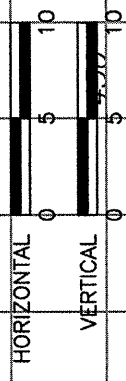

ENTRANCE ROAD AND PARKING LOT OVERLAY	COUNTY	TOTAL SHEETS	SHEET NUMBER
	FRANKLIN	11	11

BENTON MUNICIPAL AIRPORT

BN013

