

JUL 09 2008 2:56 PM RINKE00461  
 I:\AIRPORTS\MTCARME\08A0016\AIRPORT\SHEETS\R-156MRK.DWG - MARKING

MC022

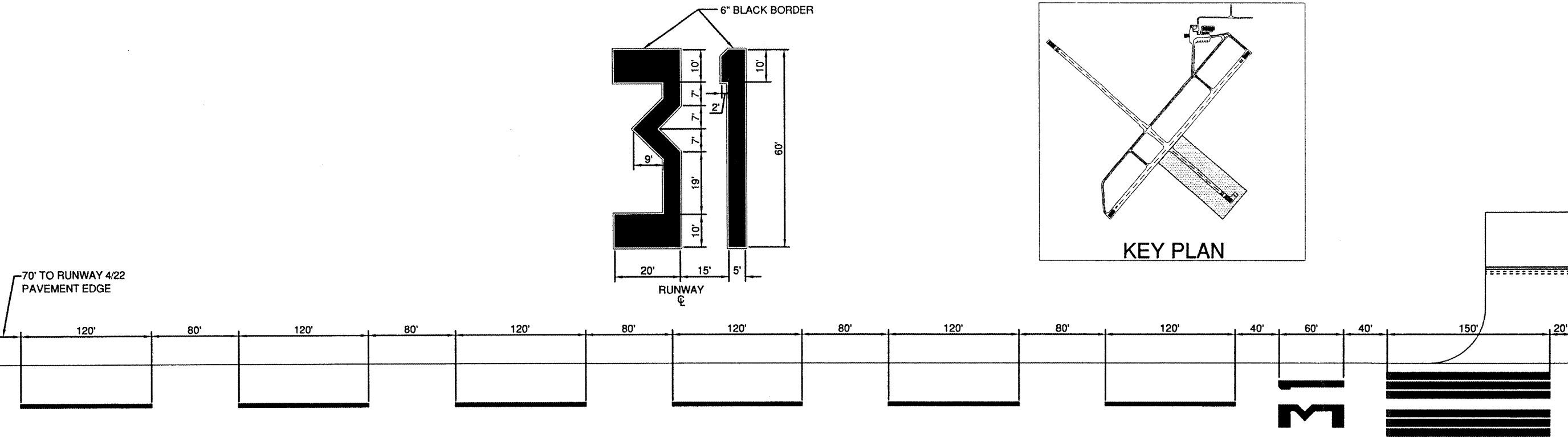

**LEGEND**  
 — PROPOSED PAINT MARKINGS

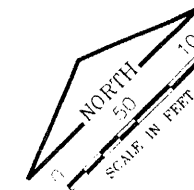
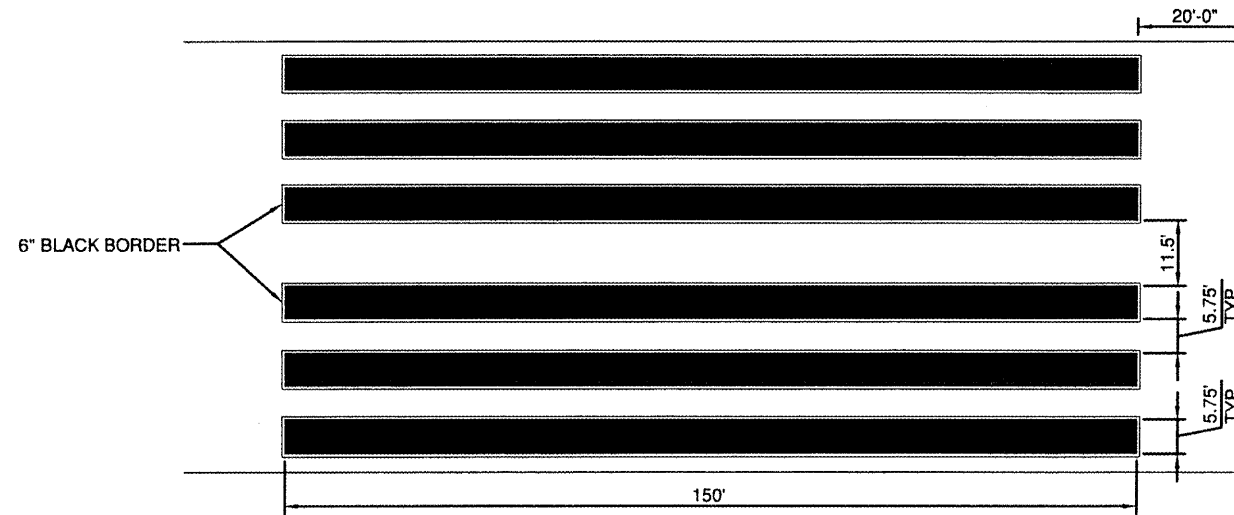

DATE	REVISION	BY

THE CITY OF  
**Mount Carmel**  
 MT. CARMEL MUNICIPAL AIRPORT

IL PROJ.: AIG-3779 A.I.P. PROJ.: 3-17-0073-813

HD Project No. 08A0016D\_0800  
 Filename: R-156MRK.DWG  
 Scale: 1" = 50'  
 Date: 04/24/08

LAYOUT	J.S.L.	04/24/08
DRAWN	B.A.K.	04/24/08
REVIEWED	xxx	xx/xx/xx

**HANSON**  
 Hanson Professional Services Inc.  
 1525 South Sixth Street  
 Springfield, Illinois 62705-2886  
 Chicago Nationwide

REHAB. PARALLEL TAXIWAY & MARKINGS  
 MARKING PLAN  
 RUNWAY 13/31