

# CONSTRUCTION PLANS FOR OLNEY-NOBLE AIRPORT OLNEY, RICHLAND COUNTY, ILLINOIS REHABILITATE ENTRANCE ROAD

**SCOPE OF WORK**

THIS PROJECT CONSISTS OF REHABILITATION OF THE AIRPORT ENTRANCE ROAD. ASSOCIATED WORK ITEMS WILL INCLUDE PAVEMENT REPAIR, BITUMINOUS SURFACE COURSE (1-3/4" DEPTH), POROUS FRICTION COURSE (0.10' DEPTH), EARTH FILLETS, PAVEMENT MARKING, SEEDING AND MULCHING.

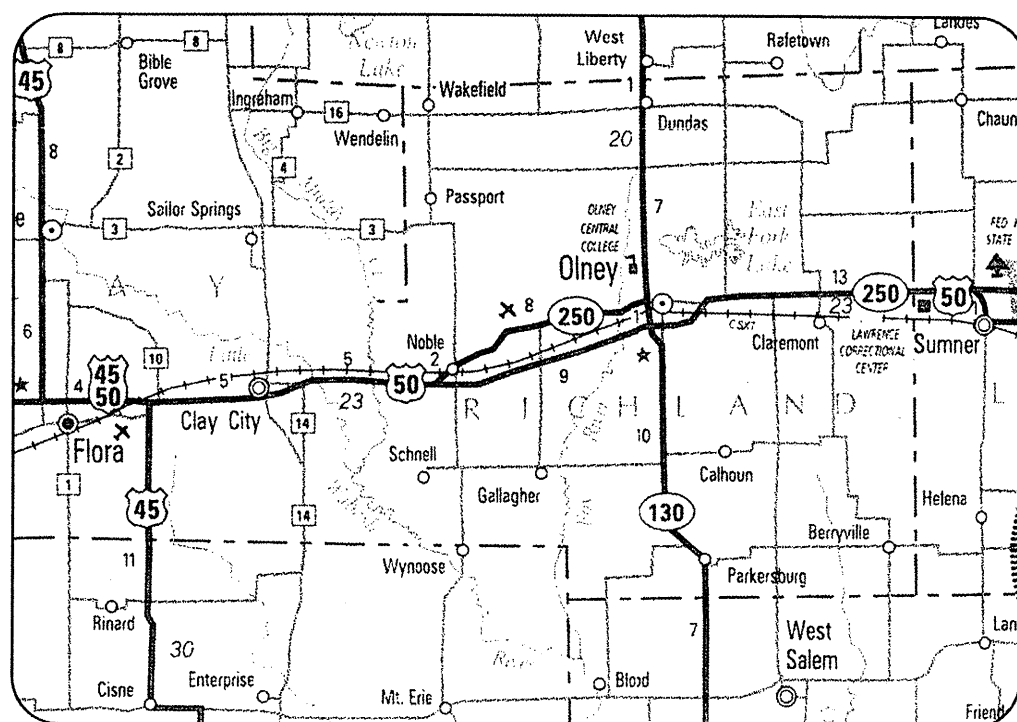

**LOCATION**

ILL. PROJ.: OLY-3759  
A.I.P. PROJ.: 3-17-0076-B8  
LATITUDE: 38° 44' 00"  
LONGITUDE: 88° 10' 33"  
ELEVATION: 481.0' M.S.L.  
DATE: JUNE 13, 2008

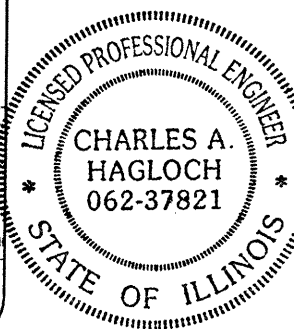

REVISED 6/27/2008

**HANSON**  
Hanson Professional Services Inc.

Submitted by *Charles A. Hagloch* ENG'R  
Date Submitted JUNE 30, 2008  
Lic. Exp. Date NOV. 30, 2009

**OLNEY-NOBLE AIRPORT AUTHORITY**

Approved *[Signature]* CHAIRMAN  
Date 6-28-08  
Approved \_\_\_\_\_ SECRETARY  
Date \_\_\_\_\_

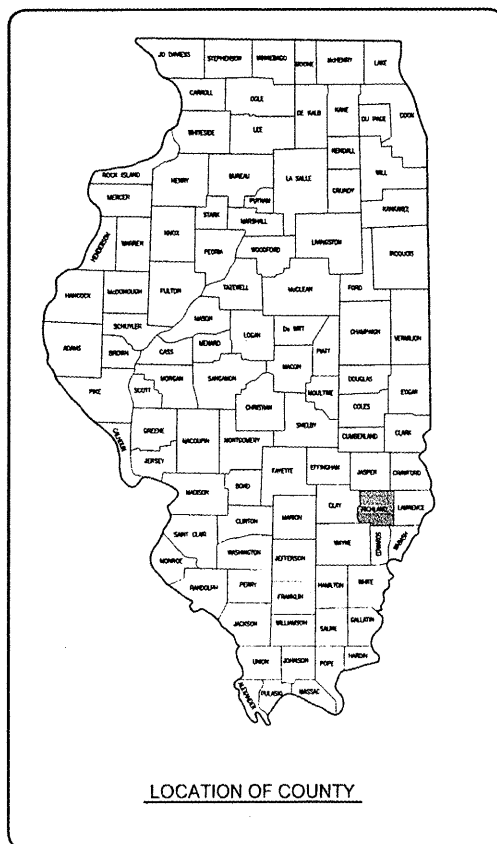

DATE	REVISION	BY
6/27/08	REVISED AS PER IDA REVIEW	CAH

**OLNEY-NOBLE AIRPORT  
OLNEY, ILLINOIS**

IL PROJ.: OLY-3759 A.I.P. PROJ.: 3-17-0076-B8

HEL. Project No. 07A0129D.0800	FILED R-001CVR.DWG	LAYOUT MDR 05/02/08
Scale NOT TO SCALE	Date 05/02/08	DRAWN MDR 05/02/08
		REVIEWED CAH 06/12/08

**HANSON**  
Hanson Professional Services Inc.  
1525 South Sixth Street  
Springfield, Illinois 62703-2886  
Offices Nationwide

REHABILITATE  
ENTRANCE ROAD

COVER SHEET

OL007

SUMMARY OF QUANTITIES

ITEM NO.	DESCRIPTION	UNIT	TOTAL QUANTITIES	AS BUILT QUANTITIES
AR150510	ENGINEER'S FIELD OFFICE	L.S.	1	
AR152442	OFFSITE BORROW EXCAVATION	C.Y.	40	
AR401610	BITUMINOUS SURFACE COURSE	TON	496	
AR401655	BUTT JOINT CONSTRUCTION	S.Y.	192	
AR401910	REMOVE & REPLACE BIT. PAVEMENT	S.Y.	62	
AR402622	POROUS FRICTION COURSE, 0.10'	S.Y.	4,723	
AR603510	BITUMINOUS TACK COAT	GAL.	1,417	
AR620520	PAVEMENT MARKING-WATERBORNE	S.F.	1,440	
AR901510	SEEDING	AC.	0.2	
AR908510	MULCHING	AC.	0.2	
AR910430	TRAFFIC MAINTENANCE (ROADWAY)	L.S.	1	

INDEX TO SHEETS

SHEET NO.	DESCRIPTION
1	COVER SHEET
2	SUMMARY OF QUANTITIES AND INDEX TO SHEETS
3	PROPOSED SAFETY PLAN
4	PROPOSED CONSTRUCTION PLAN
5	PROPOSED TYPICAL SECTION AND NOTES
6	PROPOSED MARKING PLAN
7	PROPOSED CROSS-SECTIONS FOR ENTRANCE ROAD STA. 10+00 TO STA. 11+50
8	PROPOSED CROSS-SECTIONS FOR ENTRANCE ROAD STA. 12+00 TO STA. 13+50
9	PROPOSED CROSS-SECTIONS FOR ENTRANCE ROAD STA. 14+00 TO STA. 15+50
10	PROPOSED CROSS-SECTIONS FOR ENTRANCE ROAD STA. 16+00 TO STA. 17+50
11	PROPOSED CROSS-SECTIONS FOR ENTRANCE ROAD STA. 18+00 TO STA. 19+50
12	PROPOSED CROSS-SECTIONS FOR ENTRANCE ROAD STA. 20+00 TO STA. 21+50
13	PROPOSED CROSS-SECTIONS FOR ENTRANCE ROAD STA. 22+00 TO STA. 23+50
14	PROPOSED CROSS-SECTIONS FOR ENTRANCE ROAD STA. 24+00 TO STA. 25+50
15	PROPOSED CROSS-SECTIONS FOR ENTRANCE ROAD STA. 26+00 TO STA. 27+50
16	PROPOSED CROSS-SECTIONS FOR ENTRANCE ROAD STA. 28+00 TO STA. 29+25

DATE	REVISION	BY

OLNEY-NOBLE AIRPORT  
 OLNEY, ILLINOIS

IL PROJ.: 0LY-3759 A.I.P. PROJ.: 3-17-0076-88

HEI Project No. 07A01290_0800	Element R-002FLP.DWG	Date 05/02/08
Scale NOT TO SCALE		
LAYOUT	MDR	05/02/08
DRAWN	MDR	05/02/08
REVIEWED	CAH	06/12/08



REHABILITATE  
 ENTRANCE ROAD  
 SUMMARY OF QUANTITIES  
 AND  
 INDEX TO SHEETS

**SCOPE OF WORK**

THIS PROJECT CONSISTS OF REHABILITATION OF THE AIRPORT ENTRANCE ROAD. ASSOCIATED WORK ITEMS WILL INCLUDE PAVEMENT REPAIR, BITUMINOUS SURFACE COURSE (1-3/4" DEPTH), POROUS FRICTION COURSE (0.10' DEPTH), EARTH FILLETS, PAVEMENT MARKING, SEEDING AND MULCHING.

**AIRPORT SECURITY NOTE**

AIRPORT SECURITY WILL BE MAINTAINED AT ALL TIMES.

**UTILITY NOTE**

THE CONTRACTOR SHALL CONTACT ALL UTILITY COMPANIES AND AGENCIES WHICH HAVE LINES OR CONDUITS IN THE PROPOSED WORK AREA. ALL LINES AND CONDUITS SHALL BE LOCATED AND IDENTIFIED FOR DEPTH BEFORE ANY EXCAVATION BEGINS. THE CONTRACTOR WILL CALL J.U.L.I.E. (1-800-892-0123) TO ACCOMPLISH THE ABOVE. IT IS THE CONTRACTOR'S RESPONSIBILITY TO IDENTIFY ALL UNDERGROUND NON-JULIE UTILITIES LOCATED WITHIN THE PROPOSED CONSTRUCTION LIMITS. THESE UNDERGROUND IMPROVEMENTS WILL BE LOCATED AT THE CONTRACTOR'S OWN EXPENSE PRIOR TO THE START OF CONSTRUCTION ACTIVITIES.

**HEIGHT OF CONSTRUCTION EQUIPMENT**

THE MAXIMUM ANTICIPATED HEIGHT OF THE CONSTRUCTION EQUIPMENT WILL BE 20 FEET. THE TALLEST EQUIPMENT IS EXPECTED TO BE A SEMI-TRUCK AND TRAILER.

**HAUL ROUTE AND VEHICLE PARKING**

THE CONTRACTOR WILL USE THE DESIGNATED PARKING AREA AS SHOWN ON THIS SHEET. THE PROPOSED PARKING AREA WILL BE 100' X 200'. THE CONTRACTOR WILL BE REQUIRED TO MAINTAIN THE PROPOSED PARKING AREA THROUGHOUT THE COURSE OF THE PROJECT. ANY AREAS DAMAGED OUTSIDE OF THESE AREAS WILL BE REPAIRED BY THE CONTRACTOR AND AT THE CONTRACTOR'S OWN EXPENSE. AT THE CONCLUSION OF THE PROJECT THE CONTRACTOR WILL GRADE, FERTILIZE, SEED AND MULCH THE PARKING AREA AS NEEDED TO RESTORE IT TO ITS' ORIGINAL STATE. RESTORATION OF THE PARKING AREA WILL BE CONSIDERED INCIDENTAL TO THE PROJECT AND NO ADDITIONAL COMPENSATION WILL BE ALLOWED.

THE CONTRACTOR WILL BE ALLOWED TO USE THE EXISTING AIRPORT ENTRANCE ROAD AS HIS PROPOSED HAUL ROUTE.

DURING THE PLACEMENT AND CURING OF THE BITUMINOUS TACK COAT AND THE PLACEMENT OF THE BITUMINOUS SURFACE COURSE THE CONTRACTOR WILL CONSTRUCT A TEMPORARY TURF ACCESS ROAD AS PART OF ITEM AR910430 "TRAFFIC MAINTENANCE (ROADWAY)".

**CONTRACTOR RESPONSIBILITIES**





THE CONTRACTOR'S EQUIPMENT PARKING AND STORAGE AREA WILL BE AS SHOWN ON THIS SHEET. THE CONTRACTOR'S EMPLOYEES WILL PARK THEIR VEHICLES IN THIS AREA. ONLY CONTRACTOR VEHICLES WILL BE ALLOWED OUTSIDE THIS AREA.

THE CONTRACTOR AND HIS EMPLOYEES WILL BE RESTRICTED TO THE WORK AREA AND ALL OTHER AREAS OF THE AIRPORT ARE "OFF LIMITS" TO THEM.

**BARRICADES AND TRAFFIC CONES**

IT WILL BE THE CONTRACTOR'S RESPONSIBILITY TO PLACE AND MAINTAIN BARRICADES AND TRAFFIC CONES AS DIRECTED BY THE AIRPORT MANAGER. THE BARRICADES WILL BE EQUIPPED WITH YELLOW FLASHING LIGHTS AND 20" SQUARE ORANGE FLAGS. THE BARRICADES, THEIR MAINTENANCE, PLACEMENT AND REMOVAL WILL BE CONSIDERED AS AN INCIDENTAL ITEM TO THE CONTRACT AND NO ADDITIONAL COMPENSATION WILL BE ALLOWED.

**LEGEND**

-  EXISTING IMPROVEMENTS
-  EXISTING BUILDINGS
-  PROPOSED IMPROVEMENTS
-  PROPOSED CONSTRUCTION EQUIPMENT PARKING AREA
-  PROPOSED BENCHMARK

THE LOCATION, SIZE AND TYPE OF MATERIAL OF EXISTING UNDERGROUND UTILITIES INDICATED ON THE PLANS IS NOT REPRESENTED AS BEING ACCURATE, SUFFICIENT OR COMPLETE. IT SHALL BE THE CONTRACTOR'S RESPONSIBILITY TO DETERMINE THE ACTUAL LOCATION OF ALL SUCH FACILITIES, INCLUDING SERVICE CONNECTIONS TO UNDERGROUND UTILITIES. PRIOR TO CONSTRUCTION, THE CONTRACTOR SHALL NOTIFY THE UTILITY COMPANIES OF HIS OPERATIONAL PLANS AND SHALL OBTAIN FROM THE RESPECTIVE UTILITY COMPANIES DETAILED INFORMATION AND ASSISTANCE RELATIVE TO THE LOCATION OF THEIR FACILITIES AND THE WORKING SCHEDULE OF THE COMPANIES FOR REMOVAL OR ADJUSTMENT WHERE REQUIRED. IN THE EVENT AN UNEXPECTED UTILITY INTERFERENCE IS ENCOUNTERED DURING CONSTRUCTION, THE CONTRACTOR SHALL IMMEDIATELY NOTIFY THE UTILITY COMPANY OF JURISDICTION. THE ENGINEER SHALL ALSO BE IMMEDIATELY NOTIFIED. ANY SUCH MAINS AND SERVICES SHALL BE RESTORED TO SERVICE AT ONCE AND PAID FOR BY THE CONTRACTOR AT NO ADDITIONAL COST TO THE CONTRACT.

CALL J.U.L.I.E. FOR UTILITY INFORMATION AT 1-800-892-0123.

**BENCHMARK DATA**

NO.	DESCRIPTION	ELEV.
1	WEST BOLT ON AIRPORT BEACON BASE	467.79
2	CHISELED SQUARE ON NORTH CORNER OF 4'x4' CONCRETE ENTRANCE PAN OF BLUE METAL HANGAR	467.19
3	SET R.R. SPIKE IN POWER POLE APPROX. 35' +/- WEST OF ENTRANCE ROAD, AND 35' +/- S.E. OF 60" FLARED END SECTION.	463.61
4	SET R.R. SPIKE IN POWER POLE WEST SIDE OF ENTRANCE ROAD, APPROX. 300' +/- NORTH OF ROUTE 250	469.30

OL007

**J.U.L.I.E. INFORMATION**

COUNTY \_\_\_\_\_ RICHLAND  
 CITY \_\_\_\_\_ OLNEY  
 TOWNSHIP \_\_\_\_\_ NOBLE  
 SECTION NO. \_\_\_\_\_ 2  
 ADDRESS \_\_\_\_\_ OLNEY-NOBLE AIRPORT  
 P.O. BOX 717  
 OLNEY, ILLINOIS 62450

**CRITICAL POINT DATA**

LATITUDE: 38° 43' 09.51281"  
 LONGITUDE: 88° 10' 23.68787"  
 ELEVATION: 467.47 M.S.L.

**PROPOSED SAFETY PLAN**

GENERAL - THE OLNEY-NOBLE AIRPORT IS COMPRISED OF TWO RUNWAYS. THE PROPOSED CONSTRUCTION WILL NECESSITATE CLOSING NEITHER RUNWAY.

**150-ENGINEER'S FIELD OFFICE NOTES**

THE CONTRACTOR WILL FURNISH A CELL PHONE TO THE RESIDENT ENGINEER FOR HIS EXCLUSIVE USE FOR THE DURATION OF THIS PROJECT. THE RESIDENT ENGINEER WILL USE THIS PHONE FOR PROJECT BUSINESS ONLY. THE CONTRACTOR WILL BE RESPONSIBLE FOR ALL CHARGES ASSOCIATED WITH THIS CELL PHONE.

THE PROPOSED ENGINEER'S FIELD OFFICE WILL BE PAID FOR UNDER ITEMS: AR150510 ENGINEER'S FIELD OFFICE \_\_\_\_\_ 1 L.S.

**EROSION CONTROL**

THIS PROJECT WILL DISTURB LESS THAN 1 ACRE OF LAND, THEREFORE NO N.P.D.E.S. PERMIT WILL BE REQUIRED.

**CERTIFIED PAYROLLS**

THE RESIDENT ENGINEER CANNOT FORWARD CONSTRUCTION REPORTS TO THE ILLINOIS DIVISION OF AERONAUTICS FOR PROCESSING UNTIL ALL CERTIFIED PAYROLLS FOR THE PERIOD HAVE BEEN RECEIVED.

**MATERIAL CERTIFICATION**

COMPLETED WORK CANNOT BE PLACED ON A CONSTRUCTION REPORT UNTIL ALL MATERIAL CERTIFICATIONS FOR THAT PAY ITEM HAVE BEEN RECEIVED, REVIEWED AND ACCEPTED BY THE RESIDENT ENGINEER.

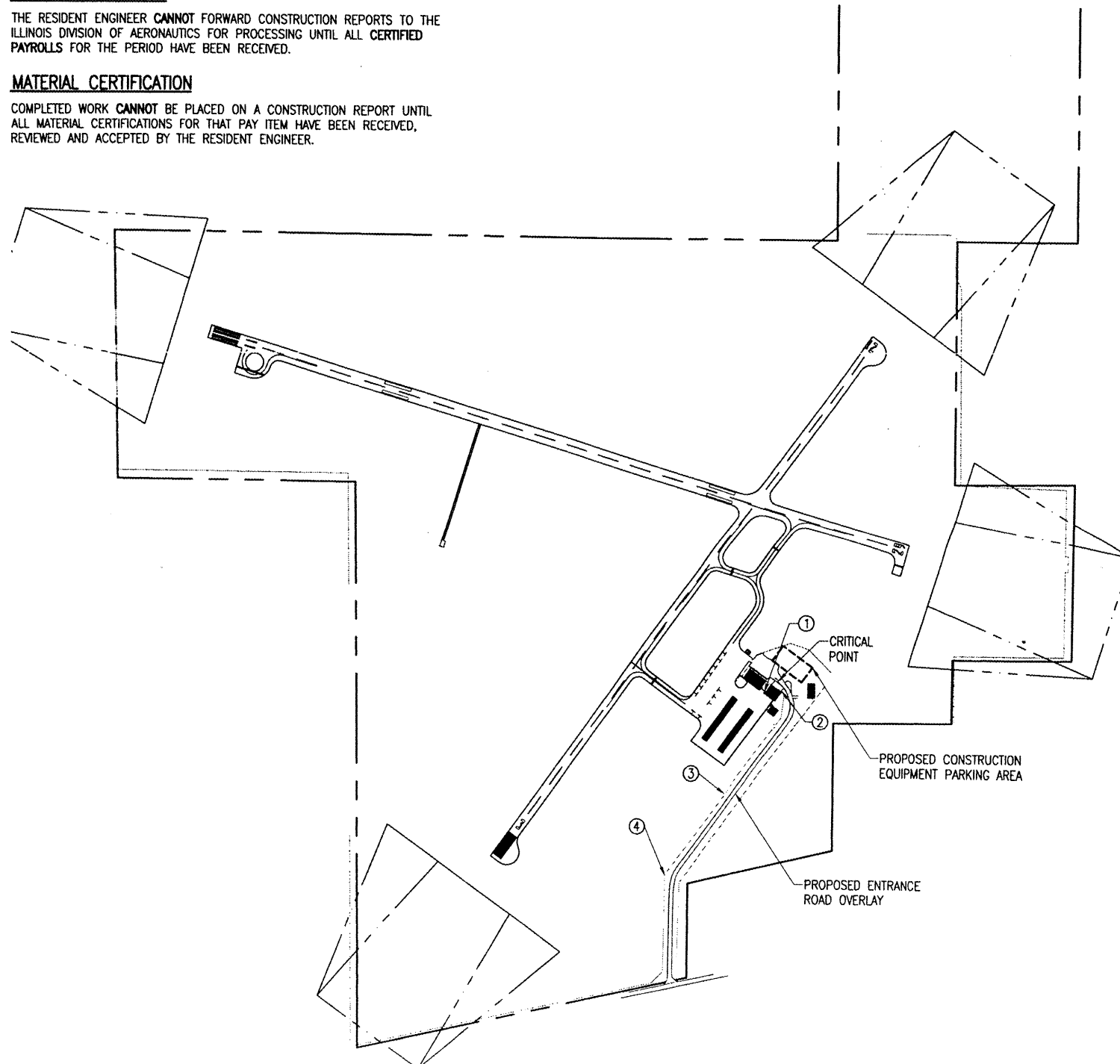

DATE	REVISION	BY

OLNEY-NOBLE AIRPORT  
 OLNEY, ILLINOIS  
 I.L. PROJ.: OLY-3759  
 A.I.P. PROJ.: 3-17-0076-88

150 Project No. 07A01290_0800	05/02/08
File Name: R-0035FY.DWG	MDR
Scale: 1" = 400'	MDR
Date: 05/02/08	CAH
LAYOUT	05/02/08
DRAWN	05/02/08
REVIEWED	06/12/08

**HANSON**  
 Hanson Professional Services Inc.  
 1525 South Sixth Street  
 Springfield, Illinois 62705-2886  
 Office: Nationwide

REHABILITATE  
 ENTRANCE ROAD  
 PROPOSED  
 SAFETY  
 PLAN

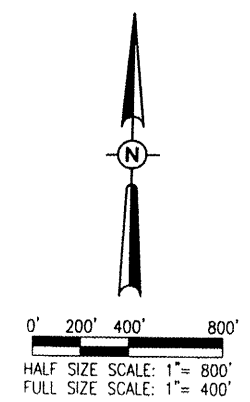

J:\IN\10\_2008\1-21 PM HAGL000382\1-airports\OLNEY\07A0129\AIRPORT\07A0129\0035FY.DWG - Layout1

DATE	REVISION	BY

**OLNEY-NOBLE AIRPORT  
OLNEY, ILLINOIS**

IL. PROJ.: OLY-3759 A.I.P. PROJ.: 3-17-0076-BB

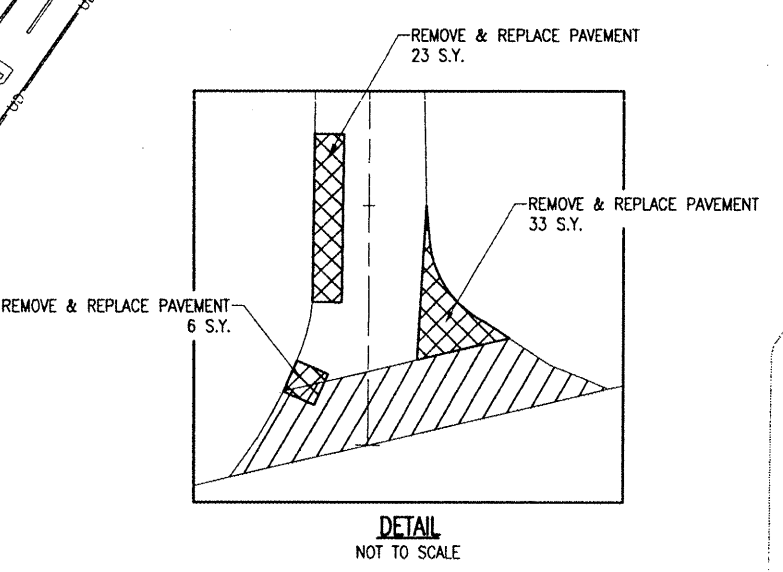
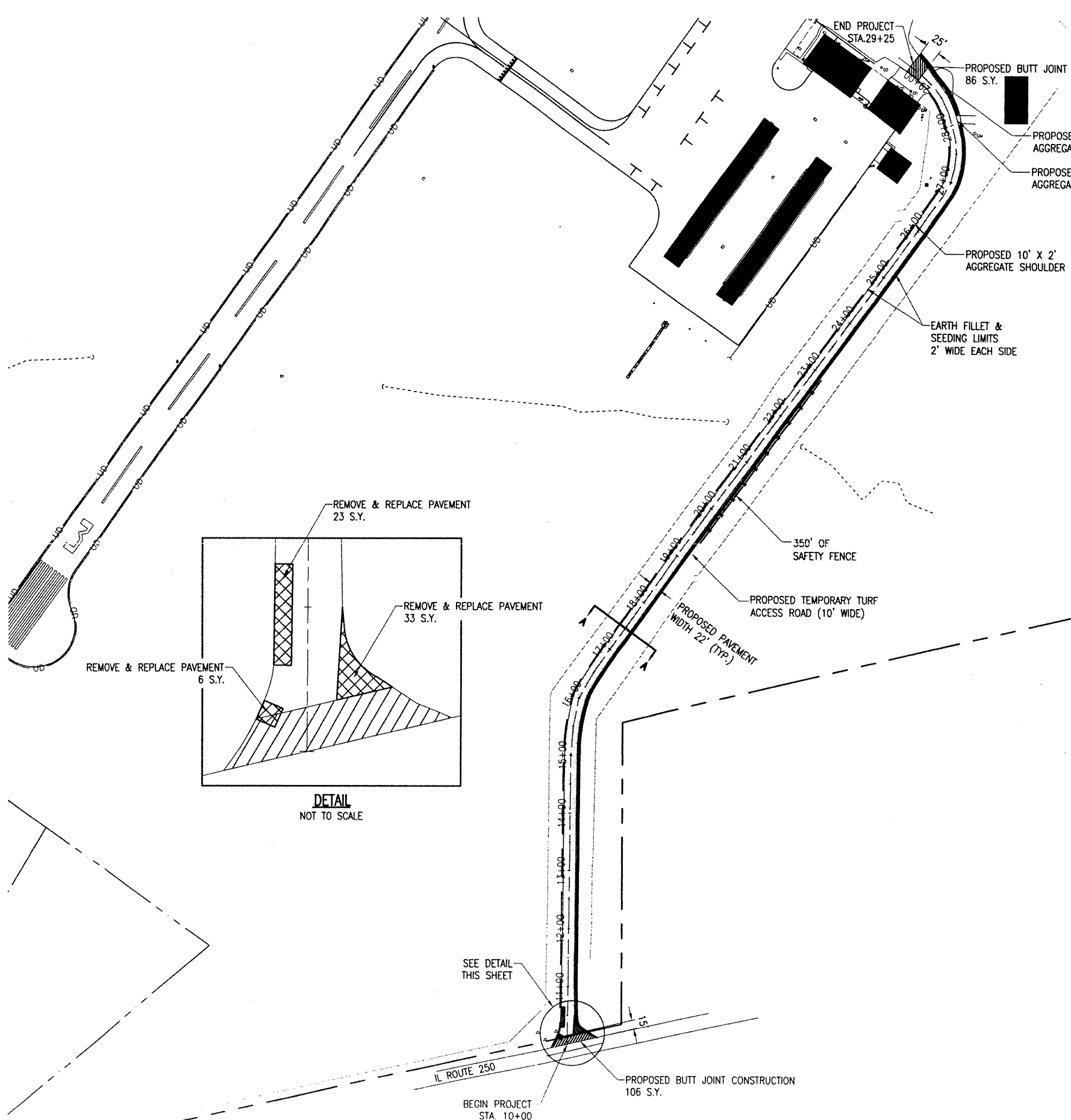

**AR401655 BUTT JOINT CONSTRUCTION NOTES**

THE PROPOSED BUTT JOINTS SHALL BE CONSTRUCTED IN ACCORDANCE WITH ITEM AR401655 "BUTT JOINT CONSTRUCTION" AS STATED ON PAGE 295 OF THE SUPPLEMENTAL SPECIFICATION AND RECURRING SPECIAL PROVISIONS, ADOPTED JULY 1, 2004.

THIS ITEM SHALL CONSIST OF REMOVING THE EXISTING BITUMINOUS PAVEMENT SURFACE BY MILLING IN ORDER TO CONSTRUCT A BUTT JOINT FOR THE TRANSITION OF THE PROPOSED BITUMINOUS OVERLAY AT THE LOCATIONS AS SHOWN ON THE PLANS.

THE PAVEMENT SURFACE WILL BE MILLED TO A DEPTH OF 0.17 FT. AT THE BUTT END AND WILL TAPER TO 0 IN. AT THE OPPOSITE END. THE PLANNER MUST BE CAPABLE OF MILLING THE SURFACE TO THE DESIRED ELEVATIONS AND GRADES.

ANY ADJACENT PAVEMENT DAMAGED BY THE MILLING OPERATIONS WILL BE REPAIRED AT THE CONTRACTOR'S OWN EXPENSE.

ALL BITUMINOUS PAVEMENT MILLING AREAS WILL BE LOCATED AND MARKED BY THE RESIDENT ENGINEER.

ALL MILLED MATERIAL WILL BE DISPOSED OF OFF THE AIRPORT SITE AT THE CONTRACTOR'S OWN EXPENSE.

THE PAVEMENT MILLING WILL BE PAID FOR UNDER ITEM:  
AR401655 "BUTT JOINT CONSTRUCTION" \_\_\_\_\_ PER S.Y.

**PROPOSED AGGREGATE SHOULDERS**

THE PROPOSED AGGREGATE SHOULDERS WILL BE CONSTRUCTED ADJACENT TO PAVEMENT OVERLAY AREAS. THE PROPOSED AGGREGATE SHOULDERS ARE SHOWN ON THE CONSTRUCTION PLAN SHEETS. THE AGGREGATE SHOULDERS WILL BE FLUSH WITH THE PAVEMENT EDGE. THE PROPOSED AGGREGATE SHOULDERS WILL REQUIRE COMPACTING AND SHAPING.

THE AGGREGATE MATERIAL, WORK AND EVERYTHING ASSOCIATED WITH THE AGGREGATE SHOULDERS WILL BE CONSIDERED INCIDENTAL TO THE OFFSITE BORROW EXCAVATION.

**PROPOSED TEMPORARY TURF ACCESS ROAD NOTES:**

ACCESS TO AND FROM THE AIRPORT WILL BE DONE ON THE RIGHT HAND SIDE OF THE AIRPORT ENTRANCE ROAD WHILE PAVING AND BITUMINOUS TACK COAT IS CURING.

THERE WILL BE 350 L.F. OF SAFETY FENCE NEEDED ALONG THE RIGHT SIDE OF THE ENTRANCE ROAD WHERE THE TREES ENCRANCH.

THE TREE IN THIS AREA WILL BE TRIMMED BACK TO ALLOW TRAFFIC TO PASS ON THE RIGHT SIDE OF THE ENTRANCE ROAD.

AFTER THIS JOB IS COMPLETED THE TEMPORARY ACCESS ROAD WILL BE RESTORED TO ITS ORIGINAL STATE.

THE INSTALLATION AND REMOVAL OF THE SAFETY FENCE, TRIMMING OF TREES AND RESTORATION OF THE TEMPORARY ACCESS WILL BE PAID FOR UNDER:  
AR910430 TRAFFIC MAINTENANCE (ROADWAY) \_\_\_\_\_ PER L.S.

**LEGEND**

- EXISTING PAVEMENT
- EXISTING BUILDINGS
- EXISTING PROPERTY LINE
- PROPOSED IMPROVEMENTS
- PROPOSED BUTT JOINT CONSTRUCTION
- PROPOSED REMOVE & REPLACE CONSTRUCTION
- PROPOSED EARTH FILLETS & SEEDING LIMITS

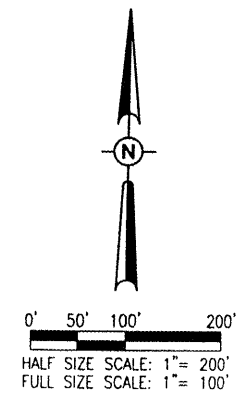

HL Project No. 07A0129D.0800  
 Filename: R-121CON.DWG  
 Scale: 1" = 100'  
 Date: 05/20/08

LAYOUT	MDR	CAH
	05/20/08	05/20/08
DRAWN	MDR	05/20/08
REVIEWED	CAH	06/12/08



Hanson Professional Services Inc.  
 1525 South Sixth Street  
 Springfield, IL 62703-2886  
 Office: Hahmerville

**REHABILITATE  
ENTRANCE ROAD**

**PROPOSED  
CONSTRUCTION  
PLAN**

JUN 30, 2008 1:23 PM HAGL000382  
 I:\AIRPORTS\OLNEY\07A0129\AIRPORT\SHEETS\R-121CON.DWG - CONSTRUCTION

DATE	REVISION	BY
6/27/08	REVISED AS PER IDA REVIEW	CAH

**OLNEY-NOBLE AIRPORT  
OLNEY, ILLINOIS**

A.I.P. PROJ.: 3-17-0076-BB  
IL. PROJ.: OLY-3759

HD Project No. 07A0129D-0800	DATE	05/20/08
Element R-121CONLDWG	MDR	05/20/08
Scale NOT TO SCALE	MDR	05/20/08
Date 05/20/08	CAH	06/12/08
LAYOUT	REVIEWED	
DRAWN		



**REHABILITATE  
ENTRANCE ROAD**

**PROPOSED  
TYPICAL SECTION  
AND NOTES**

**LEGEND**

- ① PROPOSED 401 - BITUMINOUS SURFACE COURSE (1 3/4" DEPTH)
- ② PROPOSED 603 - BITUMINOUS TACK COAT (0.25 GAL./S.Y.)
- ③ PROPOSED 402 - POROUS FRICTION COURSE (0.10' DETPH)
- ④ EXISTING PAVEMENT
- ⑤ PROPOSED EARTH FILLET
- ⑥ EXISTING GRADE

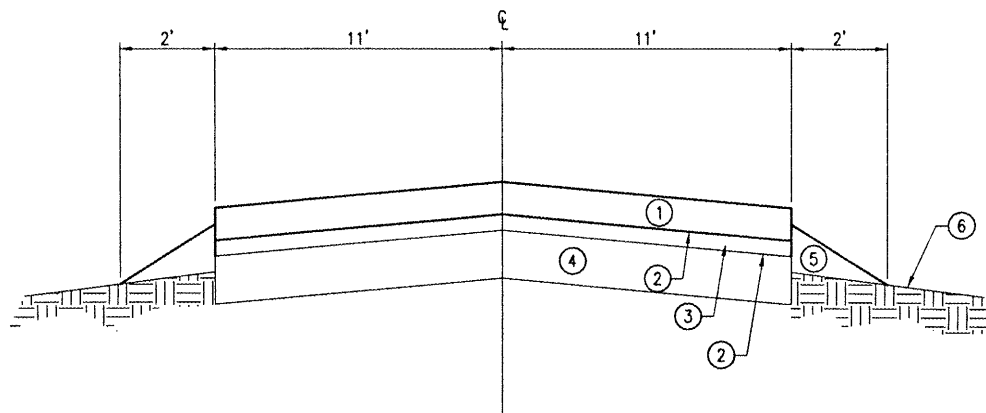

**TYPICAL SECTION "A-A"**  
NOT TO SCALE

**AR401611 BITUMINOUS SURFACE COURSE - METHOD 1**

THE BITUMINOUS SURFACE COURSE (401) SHALL BE PLACED IN ACCORDANCE WITH ITEM AR401003 "BITUMINOUS SURFACE COURSE-METHOD 1, SUPERPAVE" AS STATED ON PAGE 273 OF THE INTERIM REVISIONS OF THE SUPPLEMENTAL SPECIFICATIONS AND RECURRING SPECIAL PROVISIONS, ADOPTED MAY 11, 2007.

THIS ITEM OF WORK SHALL CONSIST OF CONSTRUCTING ONE LIFT OF BITUMINOUS SURFACE COURSE (1-3/4 INCH DEPTH) ON THE PROPOSED POROUS FRICTION COURSE.

THE CONTRACTOR SHALL BE RESPONSIBLE FOR THE QUALITY CONTROL IN THE PRODUCTION AND CONSTRUCTION OF THE BITUMINOUS SURFACE COURSE.

PRIOR TO STARTING THE BITUMINOUS SURFACE COURSE OPERATION, THE CONTRACTOR SHALL SUBMIT TO THE RESIDENT ENGINEER A DETAILED OUTLINE SHOWING AREAS AND ORDER OF PAVING WIDTHS OF PAVING LANES, AND REQUIRED OFFSETS FOR ELECTRONIC GRADE.

A STRING LINE WILL NOT BE REQUIRED.

THE PROPOSED BITUMINOUS SURFACE COURSE WILL BE DESIGNED TO A MARSHALL DESIGN OF LESS THAN 60,000 POUNDS.

401-4.9 ADD THE FOLLOWING TO THIS SECTION:

WHEN HAND SPREADING IS PERMITTED, THE MIXTURE WILL BE DISTRIBUTED AND SPREAD USING HAND TOOLS. WHEN THE WORK IS COMPLETED, THE LAYER WILL HAVE THE REQUIRED THICKNESS AND CONFORM TO THE GRADE AND SURFACE CONTOUR SHOWN ON THE PLANS.

401-4.12 ADD THE FOLLOWING TO THIS PARAGRAPH:

ALL PAVEMENT EDGES (LONGITUDINAL, RADIUS, AND PAVEMENT ENDS) MUST BE LEFT IN PROPER ALIGNMENT AS SHOWN ON THE PLANS. THIS MAY BE ACCOMPLISHED BY THE TRIMMING METHOD OUTLINED ABOVE OR AT THE CONTRACTOR'S OPTION BY SAWING AFTER THE PAVING HAS BEEN COMPLETED. NO ADDITIONAL COMPENSATION WILL BE MADE IF THE SAWING METHOD IS USED.

**603-BITUMINOUS TACK COAT NOTES:**

THE BITUMINOUS TACK COAT (603) SHALL BE PLACED IN ACCORDANCE WITH ITEM AR603 "BITUMINOUS TACK COAT" AS STATED ON PAGE 62 OF THE SUPPLEMENTAL SPECIFICATIONS AND RECURRING SPECIAL PROVISIONS, ADOPTED JULY 1, 2004.

THE PROPOSED BITUMINOUS TACK COAT SHALL BE PLACED ON THE EXISTING BITUMINOUS PAVEMENT PRIOR TO THE PLACEMENT OF THE NEXT LIFT OF PROPOSED BITUMINOUS MATERIAL.

THE PROPOSED BITUMINOUS TACK COAT WILL BE PAID FOR UNDER ITEM: AR603510 BITUMINOUS TACK COAT \_\_\_\_\_ PER GAL.

**POROUS FRICTION COURSE**

THE PROPOSED POROUS FRICTION COURSE WILL BE CONSTRUCTED IN ONE LAYER, HAVING A COMPACTED NOMINAL THICKNESS OF 0.10 FOOT.

POROUS FRICTION COURSE SHALL BE PLACED ON A CLEAN AND PREPARED SURFACE ONLY AFTER THE APPROVAL OF THE RESIDENT ENGINEER.

POROUS FRICTION COURSE WILL BE CONSTRUCTED IN THE LOCATIONS SHOWN ON THE CONSTRUCTION PLANS AND IN ACCORDANCE WITH THE SPECIAL PROVISIONS.

**GENERAL PAVEMENT PREPARATION**

THE CONTRACTOR WILL BE RESPONSIBLE FOR THE FOLLOWING WORK ITEMS BEFORE A TACK COAT CAN BE APPLIED:

BLADE THE EARTH AND SOD BACK FROM EDGE OF THE PAVEMENT.

USE A PESTICIDE TO KILL ALL WEEDS ON THE EXISTING PAVEMENT SURFACE.

ONCE THE WEEDS HAVE DIED USE A TORCH TO BURN OFF WEEDS.

POWER BROOM THE LOOSE UNWANTED MATERIAL OFF THE PAVEMENT.

THE ABOVE WORK WILL BE CONSIDERED INCIDENTAL TO PAY ITEM AR603510 "BITUMINOUS TACK COAT" AND NO ADDITIONAL COMPENSATION WILL BE ALLOWED.

**REMOVE AND REPLACE BITUMINOUS PAVEMENT**

THE AREAS TO BE REMOVED AND REPLACED WILL BE LOCATED BY THE RESIDENT ENGINEER AT THE TIME OF CONSTRUCTION. THE AREAS WILL BE REMOVED (FULL DEPTH) AND REPLACED WITH BITUMINOUS MATERIAL. THE BITUMINOUS MATERIAL USED IN THE REPLACEMENT WILL BE CONSIDERED AS AN INCIDENTAL ITEM TO THE PROPOSED REMOVAL AND REPLACEMENT AND NO ADDITIONAL COMPENSATION WILL BE ALLOWED. ALL REMOVED MATERIAL WILL BE DISPOSED OF OFF THE AIRPORT SITE.

WHERE THE PROPOSED REMOVAL AND REPLACEMENT AREA ABUTS THE EXISTING PAVEMENT, THE PAVEMENT WILL BE SAWED. THE SAWING WILL BE CONSIDERED AS AN INCIDENTAL ITEM TO THE PROPOSED PAVEMENT REMOVAL AND REPLACEMENT AND NO ADDITIONAL COMPENSATION WILL BE ALLOWED.

ANY ADJACENT PAVEMENT DAMAGED BY THE PAVEMENT REMOVAL AND REPLACEMENT OPERATIONS WILL BE REPAIRED AT THE CONTRACTOR'S OWN EXPENSE.

THIS ITEM OF WORK SHALL BE PAID FOR UNDER ITEM: AR401910 "REMOVE & REPLACE BIT. PAVEMENT" - PER S.Y.

**EARTH FILLETS**

EARTH FILLETS WILL BE CONSTRUCTED ADJACENT TO ALL PAVEMENT OVERLAY AREAS. THE EARTH FILLETS ARE SHOWN ON THE CROSS-SECTIONS AND THE STAKING PLAN SHEETS AS THE PROPOSED GRADING, SEEDING AND MULCHING LIMITS. THE EARTH FILLETS WILL NOT REQUIRE COMPACTING OR GRADING, OTHER THAN LIGHT ROLLING AND SHAPING. THE MATERIAL FOR THE PROPOSED EARTH FILLETS WILL BE OBTAINED FROM OFF-SITE.

THE MATERIAL FOR THE PROPOSED EARTH FILLETS WILL BE PAID FOR UNDER ITEM: AR152442 OFFSITE BORROW EXCAVATION \_\_\_\_\_ PER C.Y.

**AGGREGATE FILLETS**

THERE ARE SEVERAL AREAS ADJACENT TO THE PAVEMENT OVERLAY AREAS THAT WILL REQUIRE AN AGGREGATE FILLET. THE FILLET WILL EXTEND OUTWARD FROM THE PAVEMENT FOR A DISTANCE OF TWO FEET.

THE AGGREGATE USED IN THESE AREAS WILL BE A CA-6.

THE AGGREGATE FILLETS WILL REQUIRE LIGHT COMPACTION TO THE SATISFACTION OF THE RESIDENT ENGINEER.

THE AGGREGATE WILL BE CONSIDERED AS AN INCIDENTAL ITEM TO THE EARTH FILLETS AND NO ADDITIONAL COMPENSATION WILL BE ALLOWED.

**901 SEEDING NOTES**

THE PROPOSED SEEDING SHALL BE ACCOMPLISHED IN ACCORDANCE WITH ITEM 901 "SEEDING" AS STATED ON PAGE 120 OF THE SUPPLEMENTAL SPECIFICATIONS AND RECURRING SPECIAL PROVISIONS, ADOPTED JULY 1, 2004.

ALL DISTURBED AREAS LOCATED WITHIN THE PROPOSED GRADING AND SEEDING LIMITS WILL BE SEEDED IN ACCORDANCE WITH THE ABOVE NOTED SPECIFICATION. ALL AREAS OUTSIDE THE DESIGNATED GRADING AND SEEDING LIMITS WILL ALSO BE SEEDED BUT AT THE CONTRACTOR'S OWN EXPENSE.

ALL MATERIALS AND/OR DEBRIS RESULTING FROM THE SEEDING OPERATIONS WILL BE REMOVED FROM THE PAVEMENTS AND MISCELLANEOUS STRUCTURES PRIOR TO OPENING THE RUNWAY.

901-3.4 MAINTENANCE OF SEEDED AREAS. DELETE THE SECOND PARAGRAPH OF THIS SECTION AND ADD THE FOLLOWING:

"THE CONTRACTOR WILL BE REQUIRED TO ESTABLISH A GOOD STAND OF GRASS OF UNIFORM COLOR AND DENSITY TO THE SATISFACTION OF THE RESIDENT ENGINEER. IF AT THE TIME WHEN THE CONTRACT HAS BEEN OTHERWISE COMPLETED, IT IS NOT POSSIBLE TO MAKE AN ADEQUATE DETERMINATION OF COLOR, DENSITY, AND UNIFORMITY OF SUCH STAND OF GRASS, THE ITEM OF WORK WILL BE REVIEWED AT A LATER DATE DETERMINED BY THE ILLINOIS DIVISION OF AERONAUTICS."

DATE SEEDING COMPLETED \_\_\_\_\_

THE PROPOSED SEEDING WILL BE PAID FOR UNDER ITEMS: AR901510 SEEDING \_\_\_\_\_ PER ACRES

**908 MULCHING NOTES**

THE PROPOSED MULCHING SHALL BE ACCOMPLISHED IN ACCORDANCE WITH ITEM 908 "MULCHING" AS STATED ON PAGE 127 OF THE SUPPLEMENTAL SPECIFICATIONS AND RECURRING SPECIAL PROVISIONS, ADOPTED JULY 1, 2004.

THIS ITEM SHALL CONSIST OF THE FURNISHING, TRANSPORTING, AND PLACING MULCH OVER THE SEEDED AREA. DISTURBED AREAS OUTSIDE THE GRADING LIMITS SHALL ALSO BE MULCHED AND PARTICIPATION WILL BE THE SAME AS FOR SEEDED AREAS.

908-2.1 MULCH MATERIAL: THE CONTRACTOR MAY EITHER FURNISH STRAW OR HYDROMULCH AS THE TYPE OF MULCH MATERIAL TO BE USED ON THIS PROJECT.

908-3.1 MULCHING: THE HYDRAULIC MULCH SHALL BE APPLIED AS A SLURRY OF 2,500 POUNDS OF MULCH AND NOT LESS THAN 2,500 GALLONS OF WATER PER ACRE.

908-3.4 STRUCTURE CLEANING: AFTER THE PROPOSED MULCH HAS BEEN APPLIED, THE CONTRACTOR WILL CLEAN THE MULCH OFF ALL STRUCTURES (DRAINAGE, ELECTRICAL, LIGHTS, ETC.).

DATE MULCHING COMPLETED \_\_\_\_\_

THE PROPOSED MULCHING WILL BE PAID FOR UNDER ITEMS: AR908510 MULCHING \_\_\_\_\_ PER ACRES

OL007

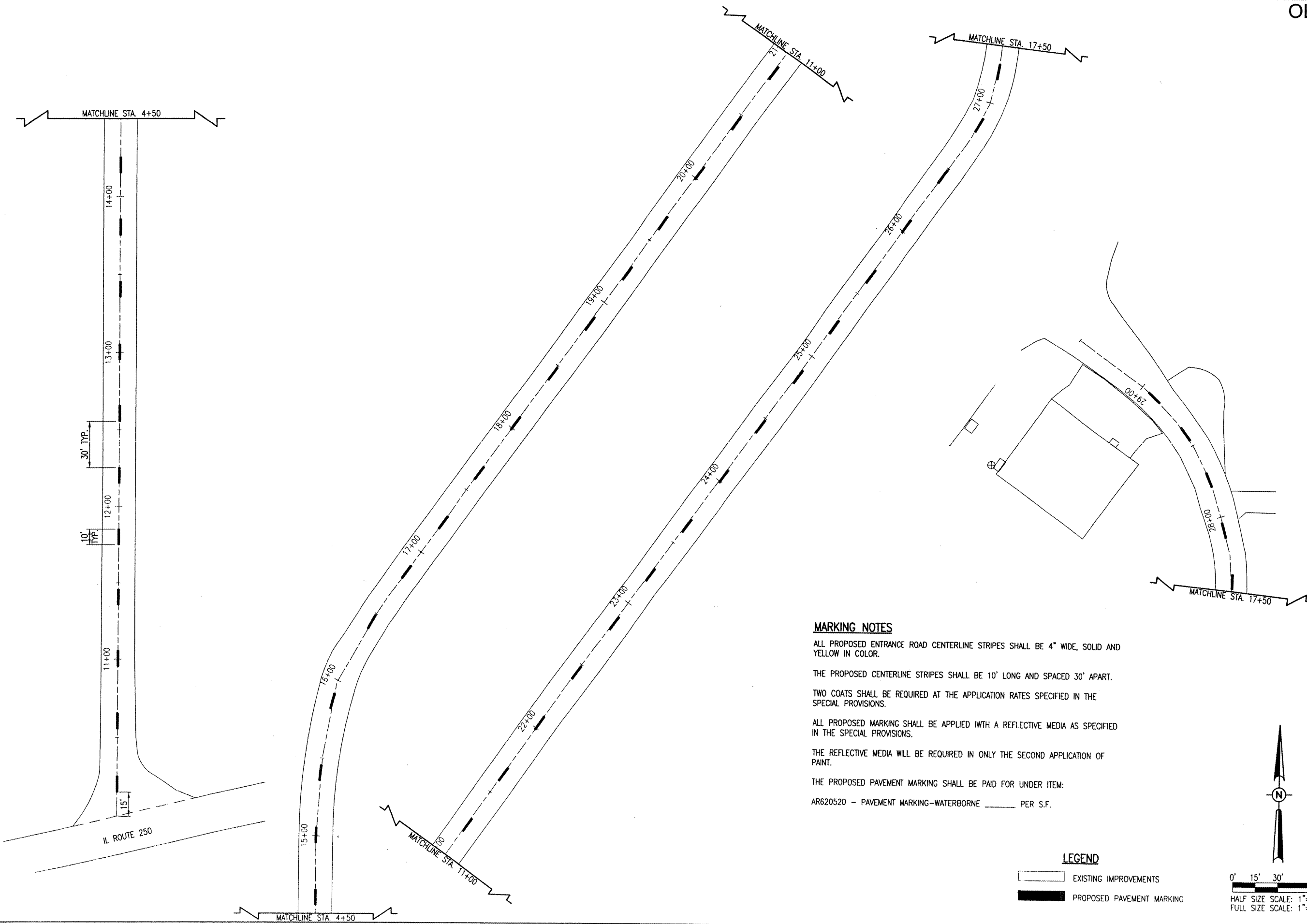

**MARKING NOTES**

ALL PROPOSED ENTRANCE ROAD CENTERLINE STRIPES SHALL BE 4" WIDE, SOLID AND YELLOW IN COLOR.

THE PROPOSED CENTERLINE STRIPES SHALL BE 10' LONG AND SPACED 30' APART.

TWO COATS SHALL BE REQUIRED AT THE APPLICATION RATES SPECIFIED IN THE SPECIAL PROVISIONS.

ALL PROPOSED MARKING SHALL BE APPLIED WITH A REFLECTIVE MEDIA AS SPECIFIED IN THE SPECIAL PROVISIONS.

THE REFLECTIVE MEDIA WILL BE REQUIRED IN ONLY THE SECOND APPLICATION OF PAINT.

THE PROPOSED PAVEMENT MARKING SHALL BE PAID FOR UNDER ITEM:

AR620520 - PAVEMENT MARKING-WATERBORNE PER S.F.

**LEGEND**

- EXISTING IMPROVEMENTS
- PROPOSED PAVEMENT MARKING

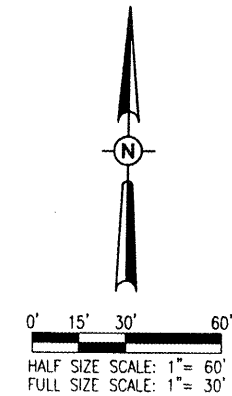

DATE	REVISION	BY

**OLNEY-NOBLE AIRPORT  
 OLNEY, ILLINOIS**

IL PROJ.: OLY-3759 A.I.P. PROJ.: 3-17-0076-B8

Heli Project No. 07A0129D\_0800  
 Filename: R-151MRK.DWG  
 Scale: 1" = 30'  
 Date: 05/20/08

LAYOUT	MDR	CAH



Hanson Professional Services Inc.  
 1325 South Sixth Street  
 Springfield, Illinois 62703-2886  
 Office: 618.288.6666

**REHABILITATE  
 ENTRANCE ROAD**

**PROPOSED  
 MARKING  
 PLAN**

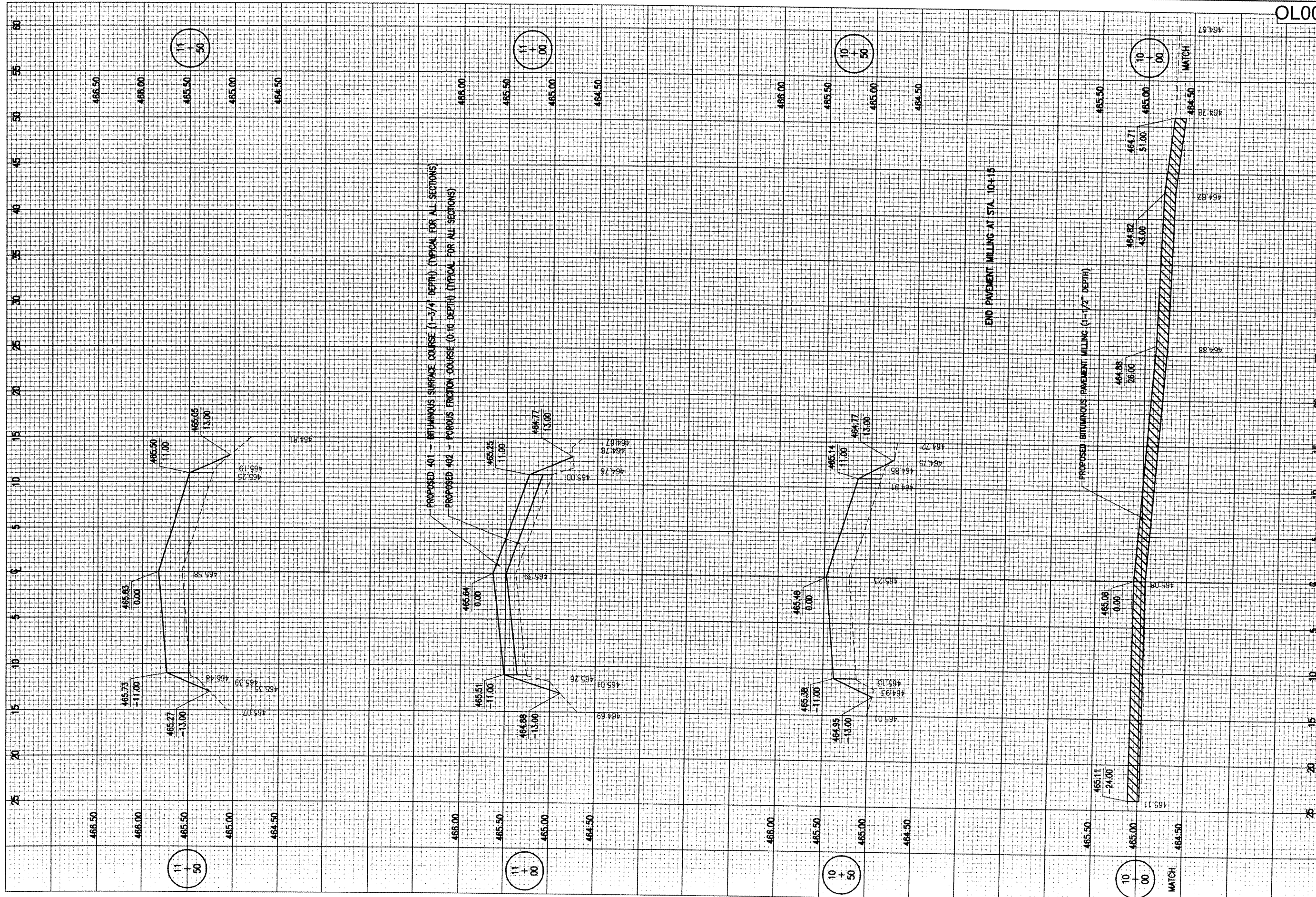

OL007

DATE	REVISION	BY
5/27/08	REVISED AS PER IDA REVIEW	CAH

**OLNEY-NOBLE AIRPORT**  
**OLNEY, ILLINOIS**

IL PROJ.: OLY-XXXX A.I.P. PROJ.: 3-17-00XX-XX

HET Project No. 07A0129D.0800 Filename: R-301.XS.DWG Scale: H, 1" = 5' V, 1" = 0.50' Date: 06/04/08	LAYOUT JEO 06/04/08 DRAWN BAK 06/04/08 REVIEWED CAH 06/12/08
--	--



**REHABILITATE ENTRANCE ROAD**  
 PROPOSED CROSS-SECTIONS FOR ENTRANCE ROAD  
 STA. 10+00 TO STA. 11+50

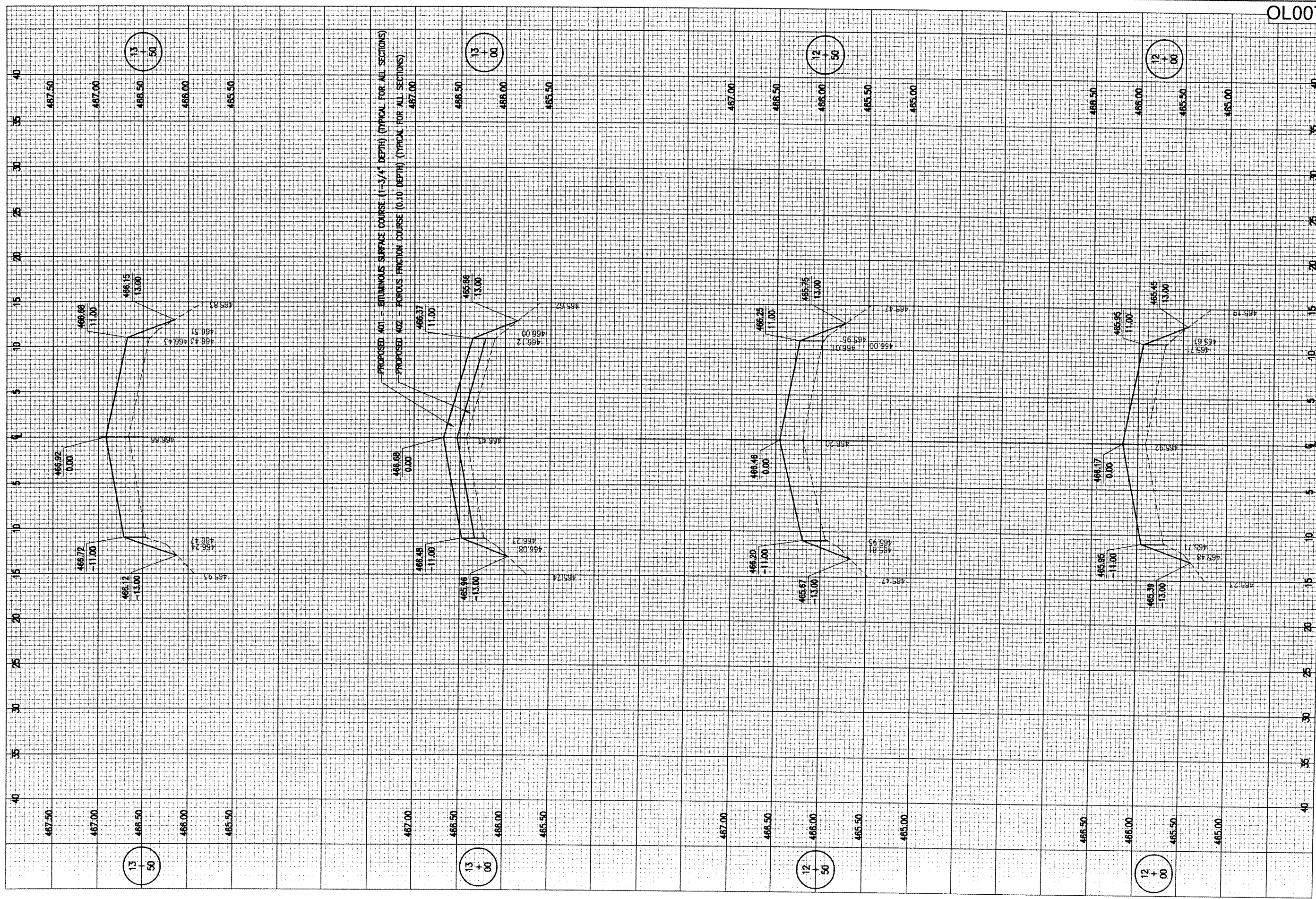

OL007

DATE	REVISION	BY
5/27/08	REVISED AS PER IDA REVIEW	CAH

**OLNEY-NOBLE AIRPORT**  
**OLNEY, ILLINOIS**

IL PROJ.: OLY-XXXX A.I.P. PROJ.: 3-17-00XX-XX

ILL. Project No. 07A0129D_0800 Filename: R-302XS.DWG Scale: H. 1" = 5' V. 1" = 0.50' Date: 06/04/08	LAYOUT JEO 06/04/08 DRAWN BAK 06/04/08 REVIEWED CAH 06/12/08
--	--

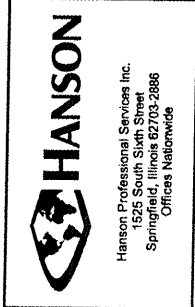

**REHABILITATE ENTRANCE ROAD**  
**PROPOSED CROSS-SECTIONS FOR ENTRANCE ROAD**  
 STA. 12+00 TO STA. 13+50



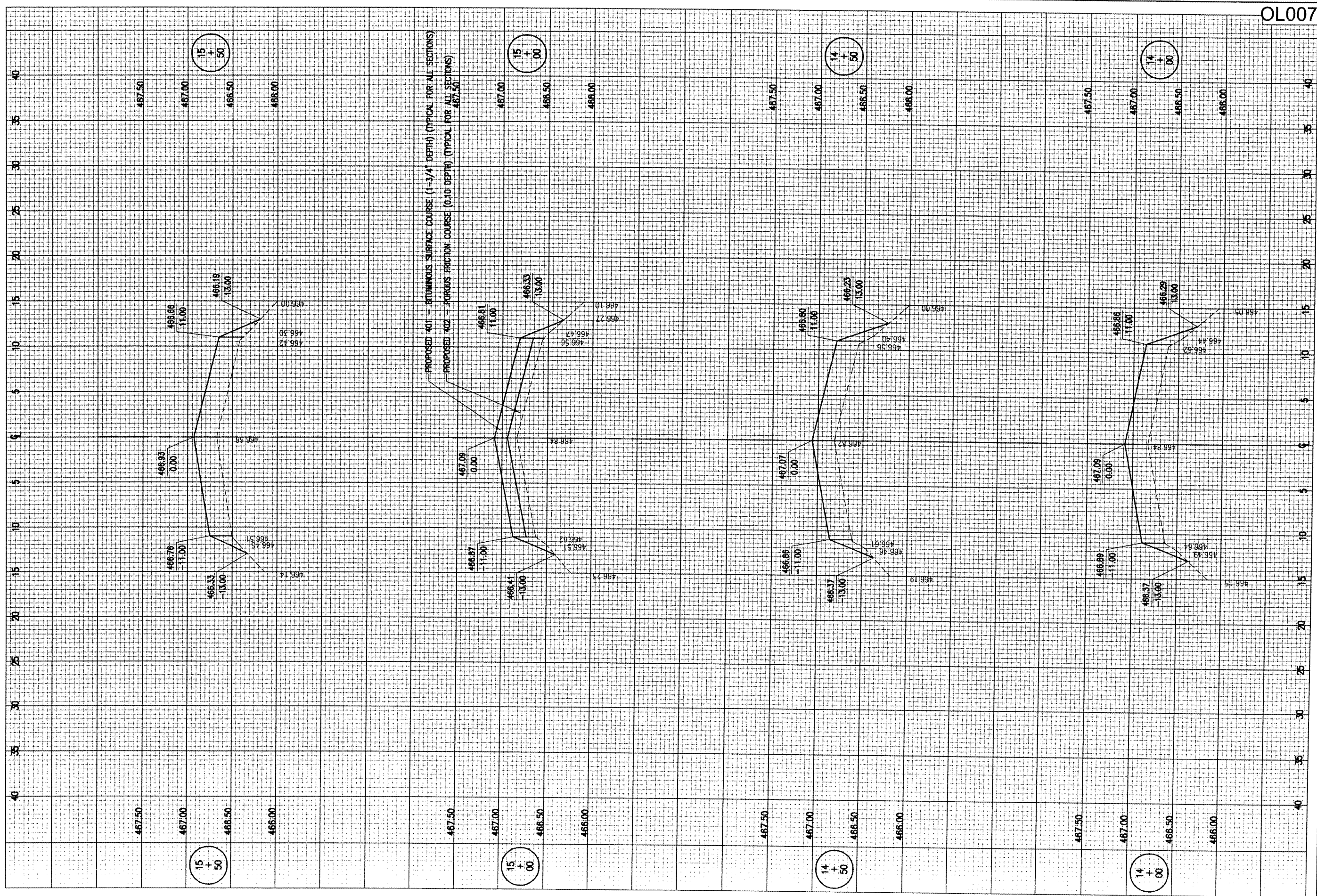

OL007

DATE	REVISION	BY
5/27/08	REVISED AS PER IMA REVIEW	CAH

**OLNEY-NOBLE AIRPORT**  
**OLNEY, ILLINOIS**

IL PROJ.: 01Y-XXXX A.I.P. PROJ.: 3-17-00XX-XX

H&L Project No. 07A0129D\_0800  
 Filename: R-303XS.DWG  
 Scale: H, 1" = 5' V, 1" = 0.50'  
 Date: 06/04/08

LAYOUT	JEO	06/04/08
DRAWN	BAK	06/04/08
REVIEWED	CAH	06/12/08



**REHABILITATE ENTRANCE ROAD**  
**PROPOSED CROSS-SECTIONS FOR ENTRANCE ROAD**  
 STA. 14+00 TO STA. 15+50

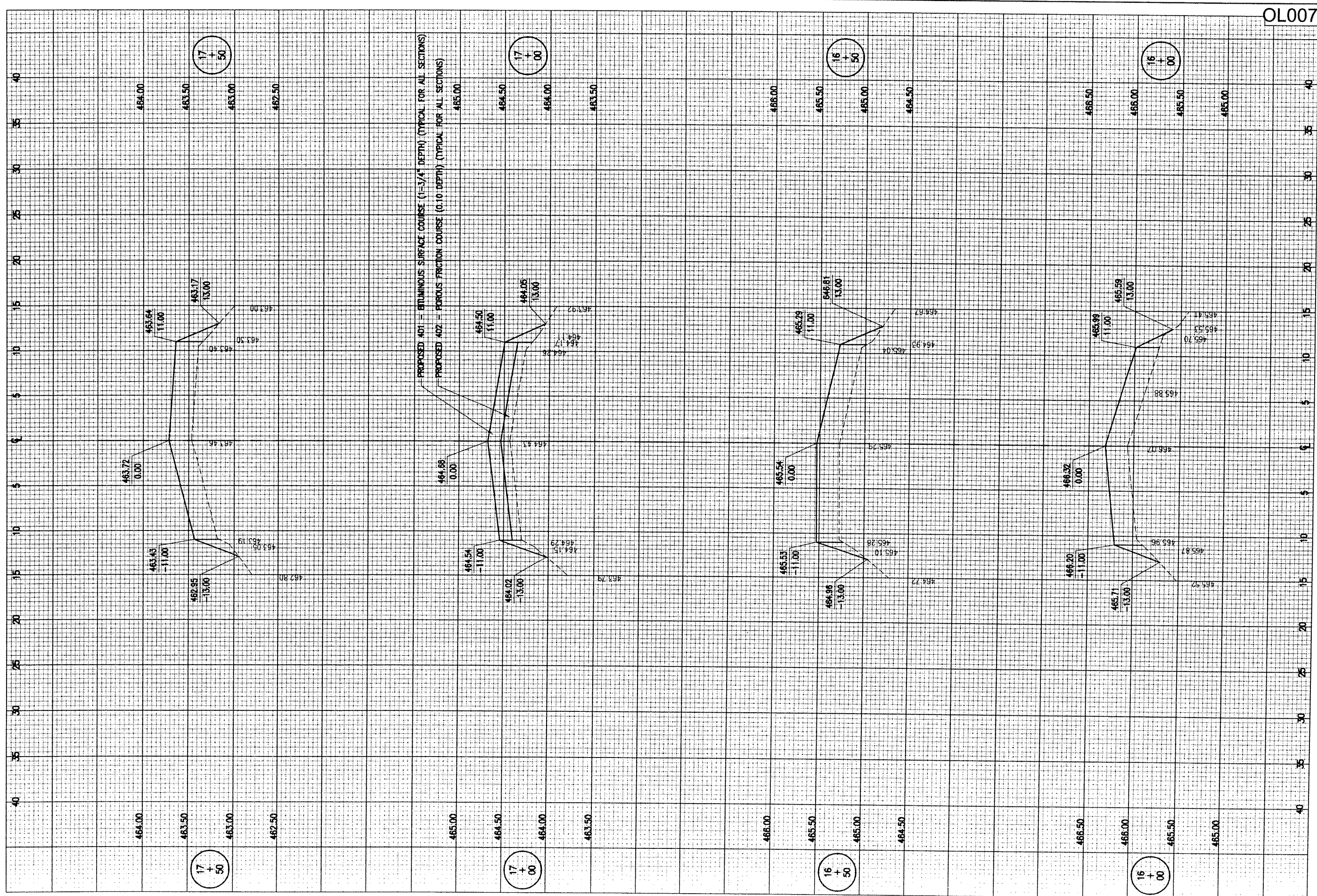

OL007

DATE	REVISION	BY
6/2/08	REVISED AS PER DIAL REVIEW	CAH

**OLNEY-NOBLE AIRPORT**  
**OLNEY, ILLINOIS**

IL. PROJ.: 01Y-XXXX A.I.P. PROJ.: 3-17-00XX-XX

H.S. Project No. 07A0129D.0800 Element R-304XS.DWG Scale H. 1" = 5', V. 1" = 0.50' Date 06/04/08	LAYOUT JEO 06/04/08 DRAWN BAK 06/04/08 REVIEWED CAH 06/12/08
---	--

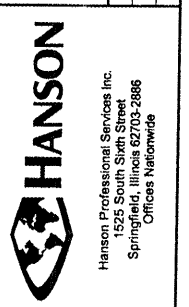

**REHABILITATE ENTRANCE ROAD**  
 PROPOSED CROSS-SECTIONS FOR ENTRANCE ROAD  
 STA. 16+00 TO STA. 17+50

**10**

10 of 16 sheets

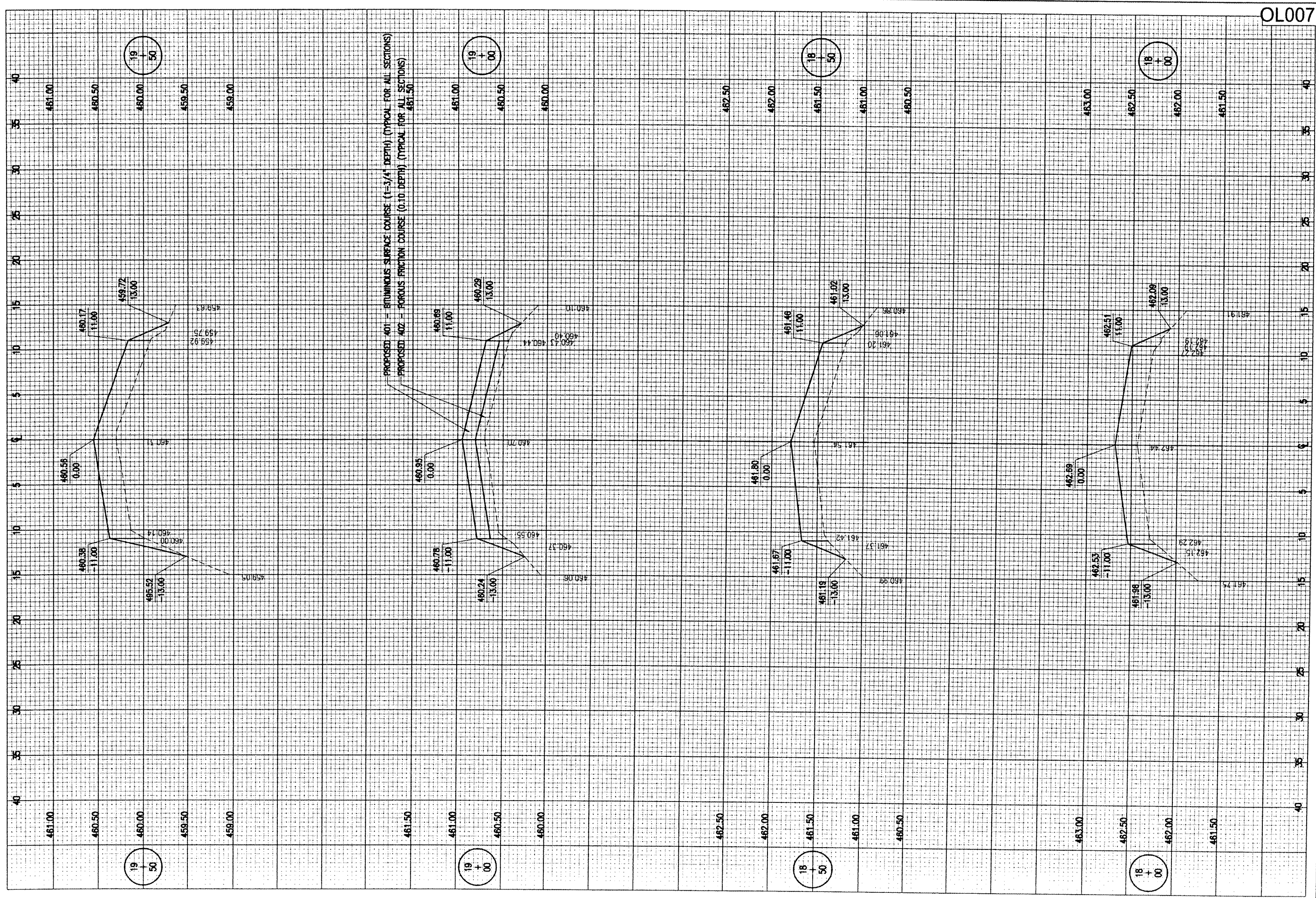

OL007

DATE	REVISION	BY
6/27/08	REVISED AS PER O&A REVIEW	CAH

**OLNEY-NOBLE AIRPORT**  
**OLNEY, ILLINOIS**

IL PROJ.: OLY-XXXX A.L.P. PROJ.: 3-17-00XX-XX

HD Project No. 07A0129D.0800 File Name: R-305XS.DWG Scale: H 1" = 5' V 1" = 0.50' Date: 06/04/08	LAYOUT JCO 06/04/08 DRAWN BAK 06/04/08 REVIEWED CAH 06/12/08
---	--



**REHABILITATE ENTRANCE ROAD**  
 PROPOSED CROSS-SECTIONS FOR ENTRANCE ROAD  
 STA. 18+00 TO STA. 19+50

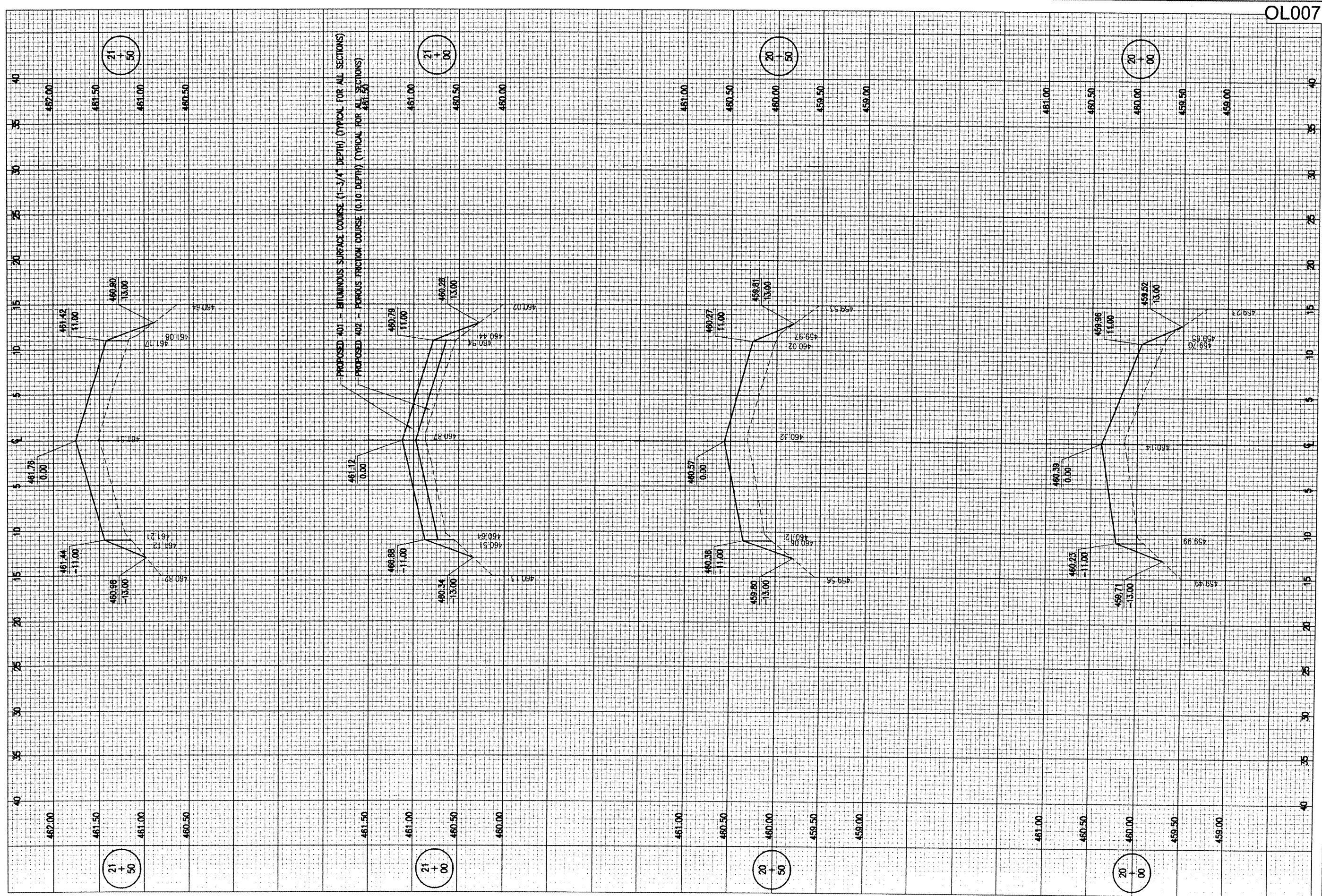

OL007

<b>12</b> <small>12 of 16 sheets</small>	<b>REHABILITATE                  ENTRANCE ROAD</b> PROPOSED CROSS-SECTIONS FOR ENTRANCE ROAD STA. 20+00 TO STA. 21+50	 Hanson Professional Services Inc. 1000 S. State Street Springfield, Illinois 62760-2886 Offices Nationwide	HE Project No. 07A0129D_0800 Elevation R-306XS.DWG Scale H. 1" = 5' V. 1" = 0.50' Date 06/04/08	LAYOUT JEO 06/04/08 DRAWN BAK 06/04/08 REVIEWED CAH 06/12/08	<b>OLNEY-NOBLE AIRPORT                  OLNEY, ILLINOIS</b> IL. PROJ.: OLY-XXXX A.I.P. PROJ.: 3-17-00XX-XX	DATE 6/27/08 REVISION REVISOR BY AS PER IGA REVIEW CAH
---	--	--	--	--	---	--

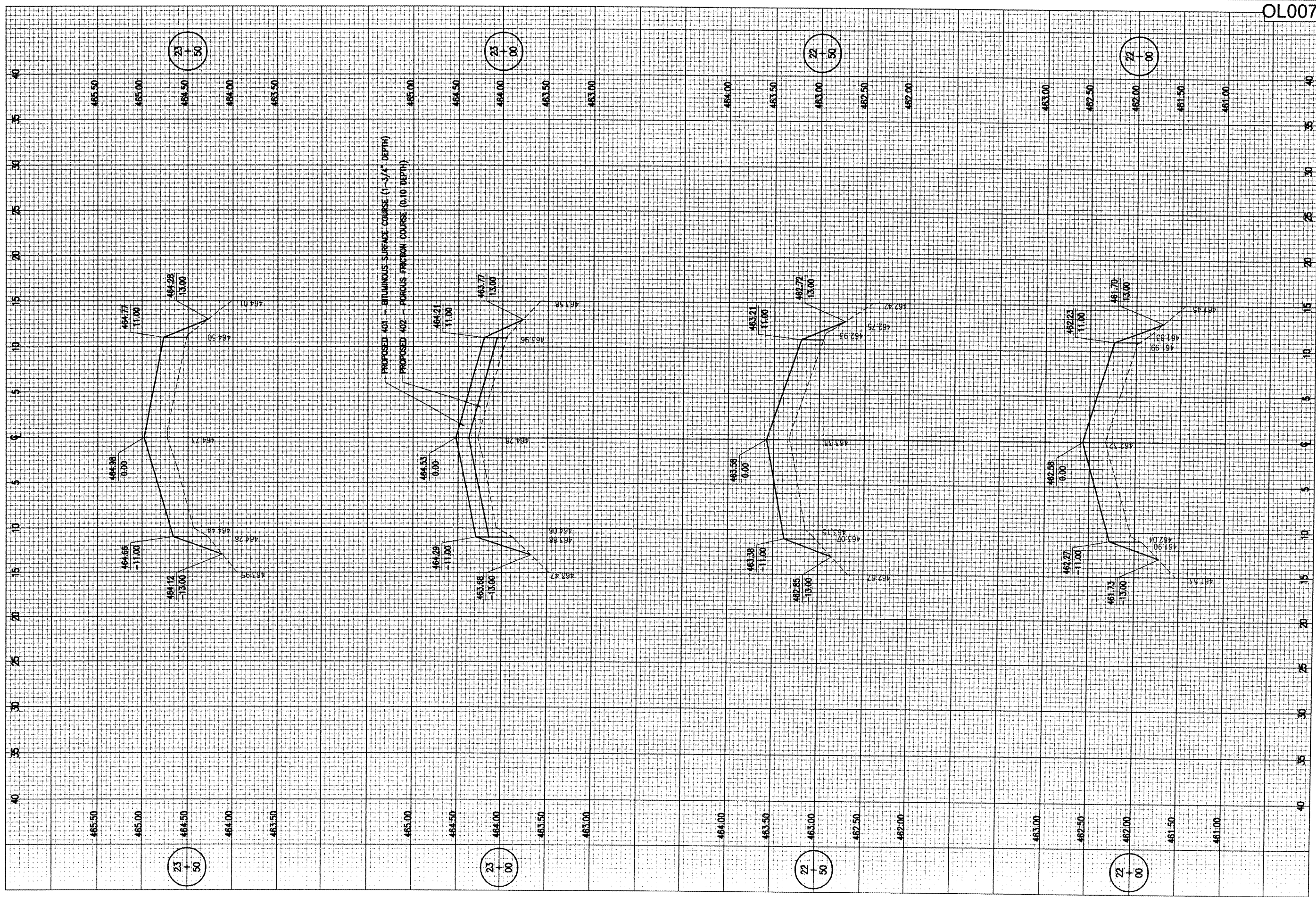

OL007

<b>13</b>	REHABILITATE ENTRANCE ROAD PROPOSED CROSS-SECTIONS FOR ENTRANCE ROAD STA. 22+00 TO STA. 23+50	SHEET NO. 07A0129D_0800 Filename: R-307XS.DWG Scale: H. 1" = 5' V. 1" = 0.50' Date: 06/04/08
 Hanson Professional Services Inc. 1525 South State Street Springfield, Illinois 62705-2886 Offices Nationwide		LAYOUT JFC 06/04/08 DRAWN BAK 06/04/08 REVIEWED CAH 06/12/08
OLNEY-NOBLE AIRPORT OLNEY, ILLINOIS		IL PROJ.: OLY-XXXX      A.I.P. PROJ.: 3-17-00XX-XX
DATE _____ REVISION _____ BY _____		DATE _____ REVISION _____ BY _____

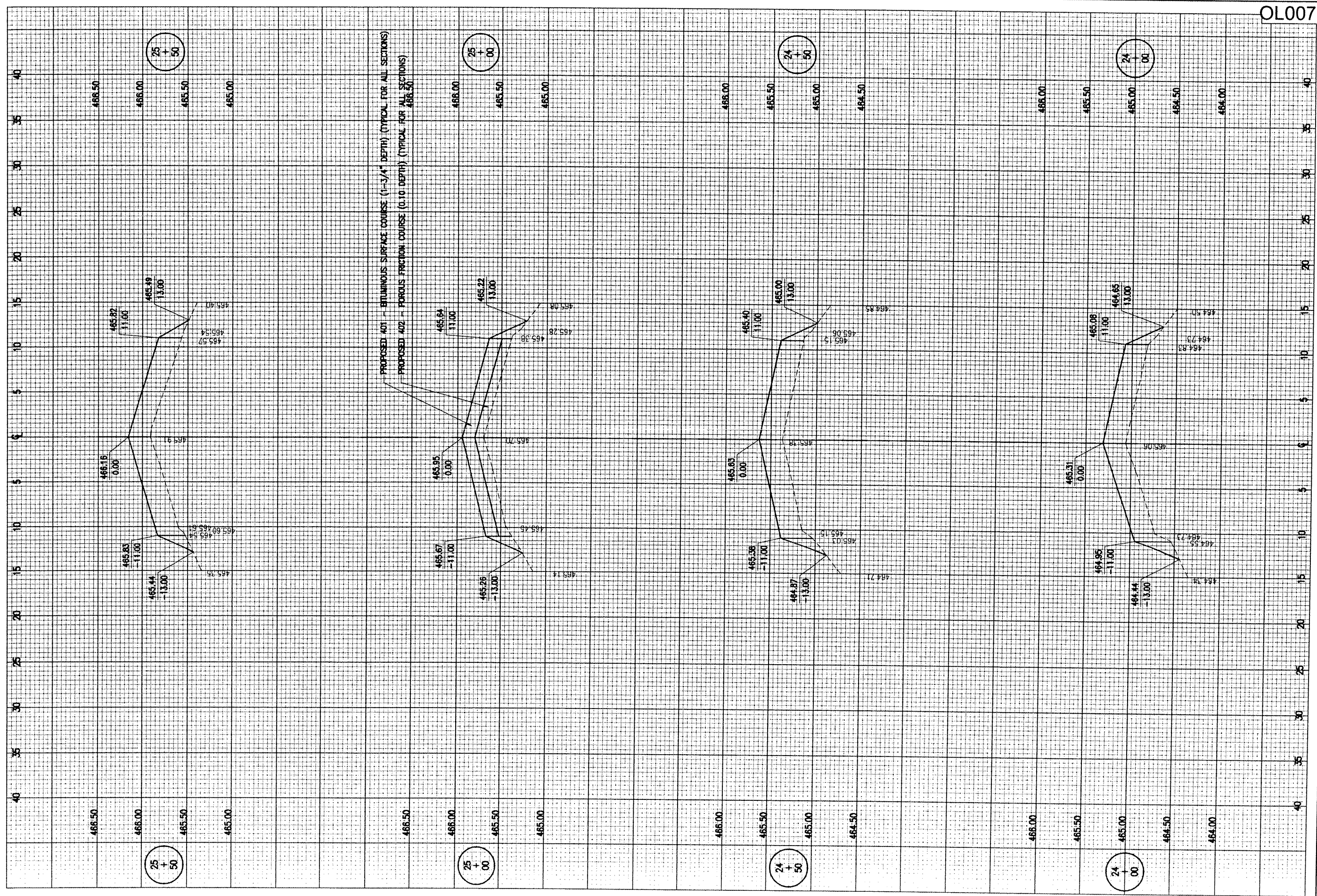

OL007

DATE	REVISION	BY
5/27/08	REVISED AS PER DA REVIEW	CAH

**OLNEY-NOBLE AIRPORT  
 OLNEY, ILLINOIS**

IL PROJ.: 01Y-XXXX A.I.P. PROJ.: 3-17-00XX-XX

HD Project No. 07A0129D.0800 Element R-308XS.DWG Scale H. 1" = 5' V. 1" = 0.50' Date 06/04/08	LAYOUT JEO 06/04/08 DRAWN BAK 06/04/08 REVIEWED CAH 06/12/08
--	--



**REHABILITATE  
 ENTRANCE ROAD**

PROPOSED CROSS-SECTIONS  
 FOR ENTRANCE ROAD  
 STA. 24+00 TO STA. 25+50

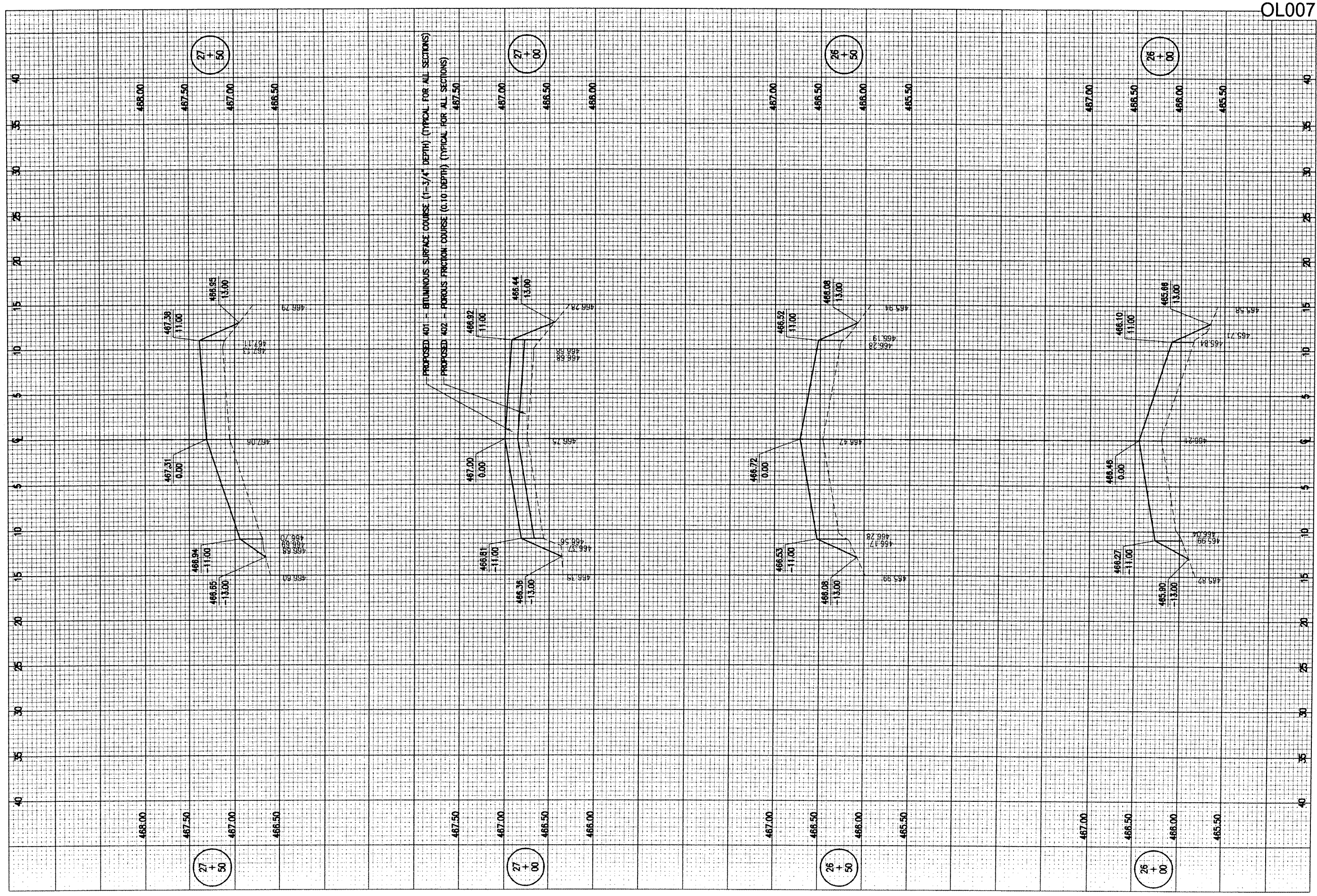

OL007

<p><b>15</b></p>	<p>REHABILITATE ENTRANCE ROAD</p>	<p>PROPOSED CROSS-SECTIONS FOR ENTRANCE ROAD STA. 26+00 TO STA. 27+50</p>	<p>Hanson Professional Services Inc. 1526 South Sixth Street Springfield, IL 62766 Offices Nationwide</p>	<p>HEI Project No. 07A0129D_0800          Filename: R-309XS.DWG          Scale: H. 1" = 5' V. 1" = 0.50'          Date: 06/04/08</p> <table border="1" style="width: 100%; border-collapse: collapse;"> <tr> <td>LAYOUT</td> <td>JEO</td> <td>06/04/08</td> </tr> <tr> <td>DRAWN</td> <td>BAK</td> <td>06/04/08</td> </tr> <tr> <td>REVIEWED</td> <td>CAH</td> <td>06/12/08</td> </tr> </table>	LAYOUT	JEO	06/04/08	DRAWN	BAK	06/04/08	REVIEWED	CAH	06/12/08		
	LAYOUT	JEO	06/04/08												
DRAWN	BAK	06/04/08													
REVIEWED	CAH	06/12/08													
<p><b>OLNEY-NOBLE AIRPORT OLNEY, ILLINOIS</b></p>		<p>IL PROJ.: OLY-XXXX      A.I.P. PROJ.: 3-17-00XX-XX</p>	<table border="1" style="width: 100%; border-collapse: collapse;"> <tr> <th>DATE</th> <th>REVISION</th> <th>BY</th> </tr> <tr> <td>6/27/08</td> <td>REVISED AS PER IGA REVIEW</td> <td>CAH</td> </tr> <tr> <td> </td> <td> </td> <td> </td> </tr> <tr> <td> </td> <td> </td> <td> </td> </tr> </table>	DATE	REVISION	BY	6/27/08	REVISED AS PER IGA REVIEW	CAH						
DATE	REVISION	BY													
6/27/08	REVISED AS PER IGA REVIEW	CAH													

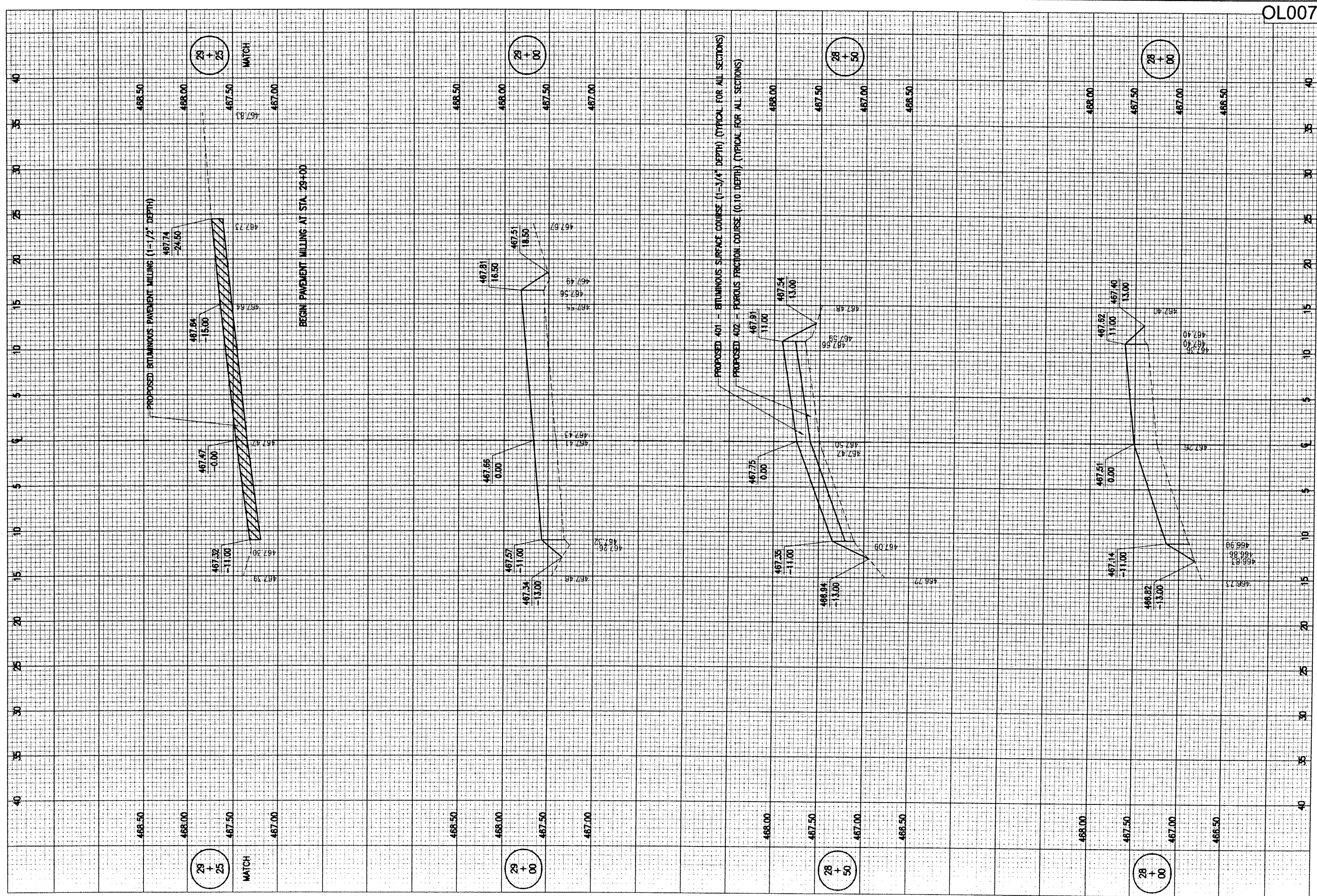

OL007

<p>REHABILITATE ENTRANCE ROAD</p> <p>PROPOSED CROSS-SECTIONS FOR ENTRANCE ROAD STA. 28+00 TO STA. 29+25</p>	<p><b>HANSON</b></p> <p>Hanson Professional Services Inc.          1525 South Sixth Street          Springfield, Illinois 62703-2886          Offices Nationwide</p>	<p>FILED PROJECT NO. 07A0129D 0800</p> <p>FORMAT R-310XS.DWG</p> <p>SCALE H. 1" = 5' V. 1" = 0.50'</p> <p>DATE 06/04/08</p>	<p>DATE 6/27/08</p> <p>REVISION REVISED AS PER IDA REVIEW CAH</p>
		<p>LAYOUT JEO 06/04/08</p> <p>DRAWN BAK 06/04/08</p> <p>REVIEWED CAH 06/12/08</p>	<p>IL PROJ.: OLY-XXXX</p> <p>A.I.P. PROJ.: J-17-00XX-XX</p>