

NOTE: ELEVATIONS PROVIDED AT LOCATIONS THAT MATCH EXISTING PAVEMENTS OR BUILDING FOUNDATIONS ARE FOR REFERENCE ONLY. THE CONTRACTOR SHALL CONSTRUCT THE PROPOSED BUT JOINTS FLUSH WITH EXISTING AS INTENDED. CONTRACTOR IS RESPONSIBLE FOR VERIFYING EXISTING ELEVATIONS AT MATCH POINTS.

LEGEND

EXISTING PAVEMENT

PROPOSED BITUMINOUS PAVEMENT

PROPOSED SPOT ELEVATION

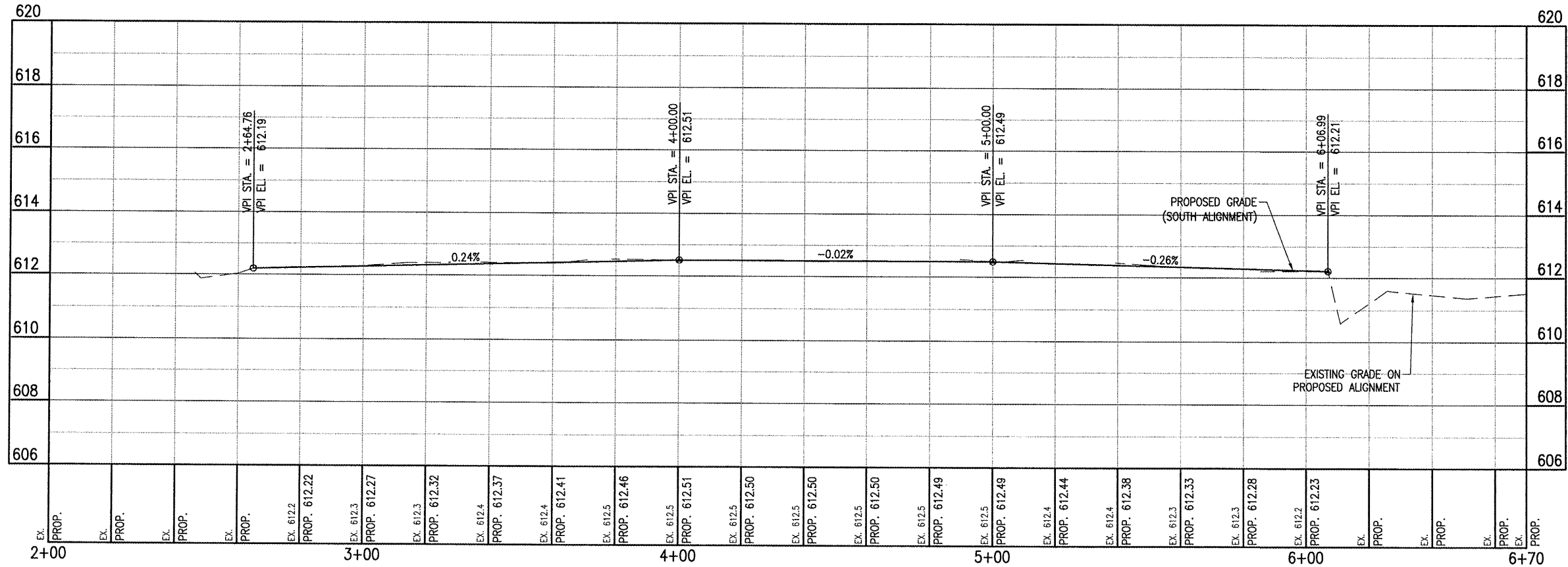

SE003

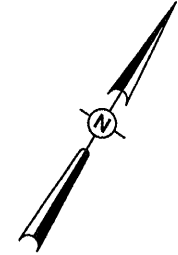

DATE	REVISION	BY

SHELBY COUNTY AIRPORT
 SHELBYVILLE, IL

IL PROJ.: 2HW-3781 A.I.P. PROJ.: 3-17-0093-B8

Hanson No.	827-03THG
Filename	R-703PMP.DWG
Scale	1"=20'
Date	06/20/08
LAYOUT	SSK 06/23/08
DRAWN	SSK 06/23/08
REVIEWED	JDW 06/24/08



REHABILITATE
 T-HANGAR PAVEMENTS
 PROPOSED
 PLAN AND PROFILE
 SOUTH ALIGNMENT