

COPYRIGHT © 2011 BY BAXTER & WOODMAN, INC.  
 STATE OF ILLINOIS - PROFESSIONAL DESIGN FIRM  
 215 S. WABASH ST., CHICAGO, ILL. 60604  
 312.467.3000 FAX 312.467.3001  
 WWW.BAXTERANDWOODMAN.COM  
 PROJECT: C:\projects\CrystalLake\DOT\00053\40-Design\WO-16\_138\_DeSign\WO-16\_138\_DeSign - TC-11FF.dgn  
 5/22/2014 3:24:55 PM

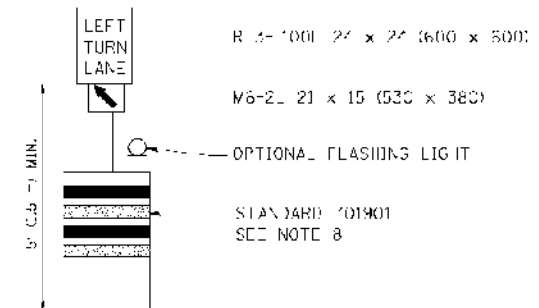

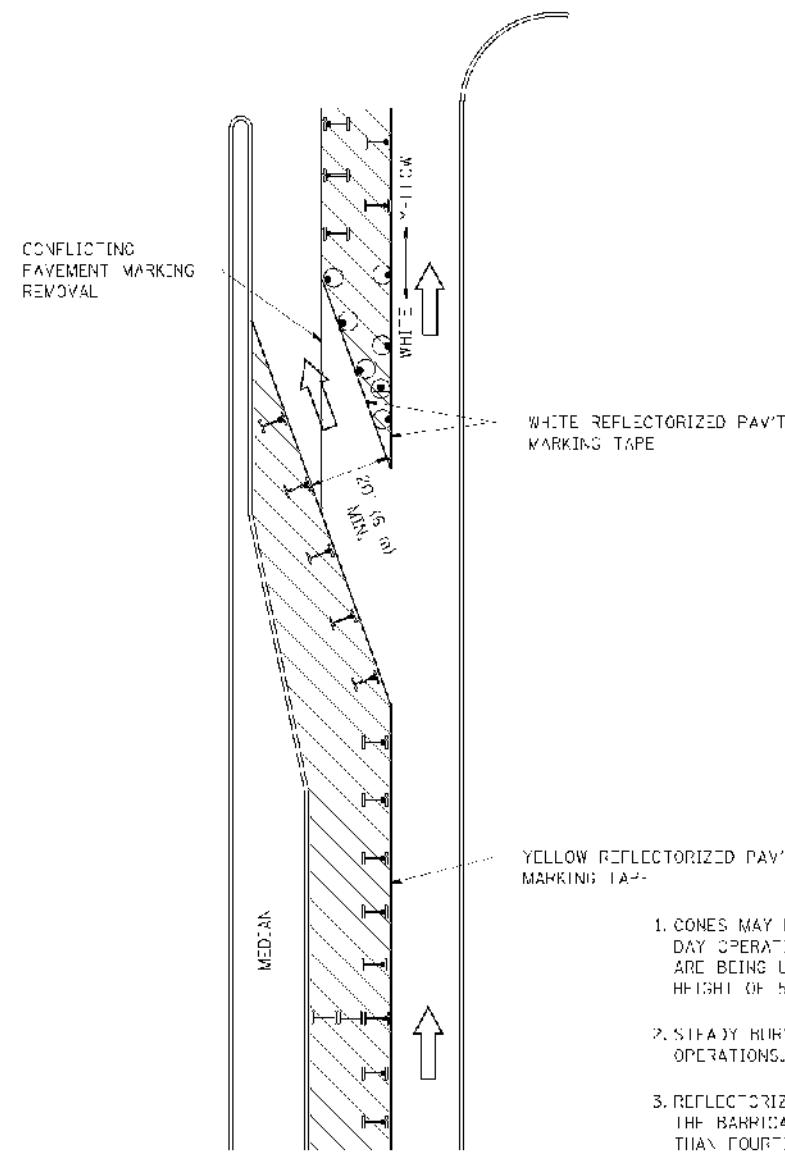



**GENERAL NOTES**

- CONES MAY BE SUBSTITUTED FOR BARRICADES OR DRUMS AT HALF THE SPACING DURING DAY OPERATIONS. CONES SHALL BE A MINIMUM OF 28 (7.0) IN HEIGHT, WHEN CONES ARE BEING USED, THE "LEFT TURN LANE" SIGN MAY BE SAID MOUNTED AT A MINIMUM HEIGHT OF 5' (1.5 M).
- STEADY BURNING LIGHTS WILL NOT BE REQUIRED ON BARRICADES OR DRUMS FOR DAY OPERATIONS. ALL LIGHTS SHALL BE MONODIRECTIONAL.
- REFLECTORIZED TEMPORARY PAVEMENT MARKING TAPE SHALL BE PLACED TO OUTLINE THE BARRICADED AREA OF EACH TURN BAY WHERE THE CLOSURE TIME IS GREATER THAN FOURTEEN DAYS.
- THIS APPLICATION ALSO APPLIES WHEN WORK IS BEING PERFORMED IN THE RIGHT LANES AND THE RIGHT TURN BAY IS TO REMAIN OPEN. UNDER THIS CONDITION, "RIGHT TURN LANE" 23 (5) 24 x 24 (600 x 600) AND M6 21 21 x 15 (530 x 380) SHALL BE USED.
- THESE CONTROLS SHALL SUPPLEMENT MAINLINE TRAFFIC CONTROL FOR LANE CLOSURES.
- LONGITUDINAL DIMENSIONS MAY BE ADJUSTED TO FIT FIELD CONDITIONS.
- FORM CTR 725 IS REQUIRED.
- IF A DRUM OR TYPE II BARRICADE WITH AN ATTACHED SIGN PANEL WHICH MEETS MOTOR 350 REQUIREMENTS IS NOT AVAILABLE, THE SIGNS SHALL BE MOUNTED ABOVE THE BARRICADES, ON SEPARATE SIGNS SUPPORTS THAT MEET MOTOR 350 REQUIREMENTS.
- TRAFFIC CONTROL AND PROTECTION AT TURN BAYS (TO REMAIN OPEN TO TRAFFIC) SHALL BE INCLUDED IN THE COST SPECIFIED TRAFFIC CONTROL STANDARDS OR ITEMS.

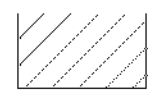
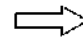
All dimensions are in inches (millimeters) unless otherwise shown.

**LEGEND**

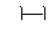
-  WORK AREA
-  LANE OPEN TO TRAFFIC
-  TYPE I OR II BARRICADE WITH STEADY BURN LIGHT
-  DRUM WITH STEADY BURN LIGHT
-  DRUM WITH SIGN (WITH OPTIONAL FLASHING LIGHT) SEE DETAIL
-  TYPE I OR II CHECK BARRICADE WITH FLASHING LIGHT

FILE NAME	USER NAME	REVISED	-T. RAMVACHER 09-06-94	REVISED	- R. BORO 09-14-01
		REVISED	- A. HOUSEH 11-07-95	REVISED	
		REVISED	- A. HOUSEH 10-12-96	REVISED	
		REVISED	-T. RAMVACHER 01-06-00	REVISED	

**STATE OF ILLINOIS  
DEPARTMENT OF TRANSPORTATION**

**TRAFFIC CONTROL AND PROTECTION AT TURN BAYS  
(TO REMAIN OPEN TO TRAFFIC)**

SCALE: NONE | SHEET NO. 1 OF 1 SHEETS | STA. TO STA.

TRAFFIC CONTROL AND PROTECTION AT TURN BAYS (TO REMAIN OPEN TO TRAFFIC)	SECTION	COUNTY	TOTAL SHEETS	SHEET NO.
567	5R-RS-3	KANE	30	27
<b>TC-14</b>			CONTRACT NO. 60N37	
C-91-307-11				