

- | | |
|---|---|
| ① THERMOPLASTIC PAVEMENT MARKING - LINE, 4" WHITE 10' DASH 30' SPACE WITH RAISED REFLECTIVE PAVEMENT MARKERS, 2 @ 80' C-C | ⑤ THERMOPLASTIC PAVEMENT MARKING - LINE, 6" WHITE |
| ② THERMOPLASTIC PAVEMENT MARKING - LINE, 4" YELLOW | ⑥ THERMOPLASTIC PAVEMENT MARKING - LINE, 6" WHITE 2' DASH 6' SPACE |
| ③ THERMOPLASTIC PAVEMENT MARKING - LINE, 4" YELLOW 2 @ 11" C-C WITH RAISED REFLECTIVE PAVEMENT MARKERS, 2 @ 40' C-C | ⑦ THERMOPLASTIC PAVEMENT MARKING - LINE, 12" YELLOW @ 45° @ 75' C-C (MIN 5) |
| ④ THERMOPLASTIC PAVEMENT MARKING - LINE, 6" WHITE WITH RAISED REFLECTIVE PAVEMENT MARKERS @ 40' C-C (MIN 4) | ⑧ THERMOPLASTIC PAVEMENT MARKING - LINE, 24" WHITE STOP BAR |
| | ⑨ THERMOPLASTIC PAVEMENT MARKING - LETTERS & SYMBOLS |

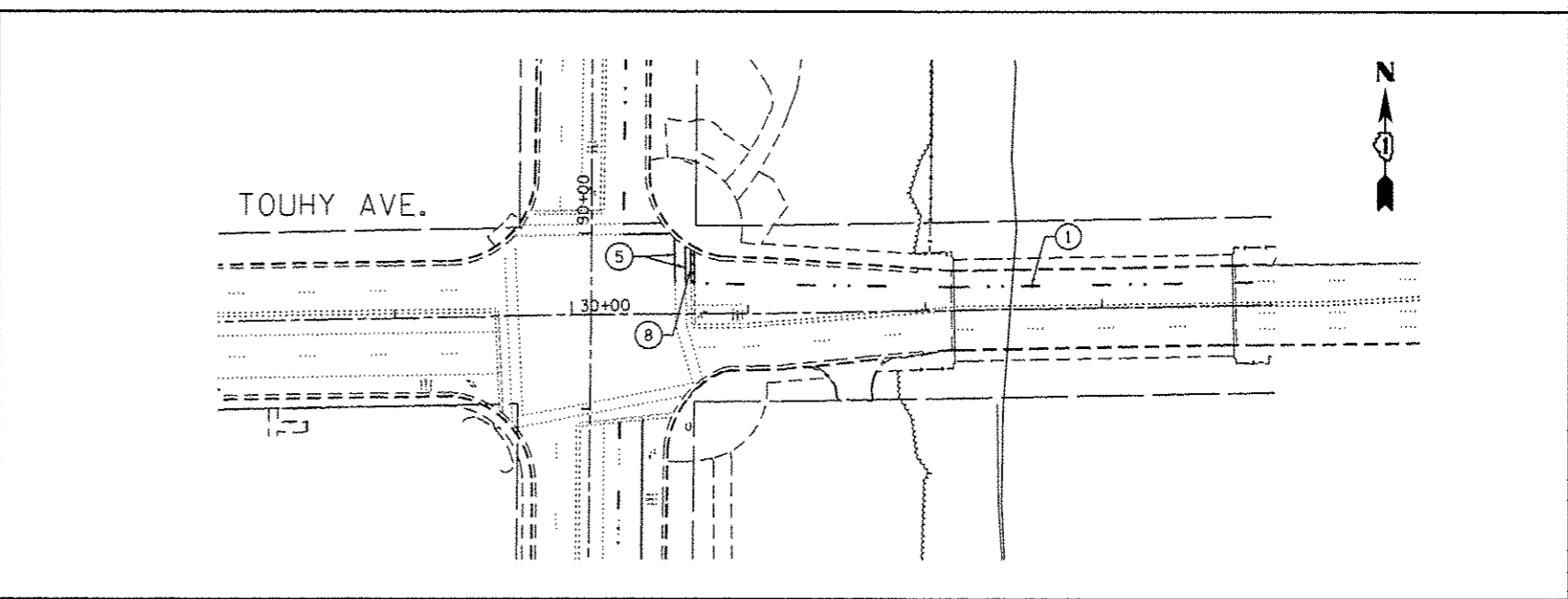
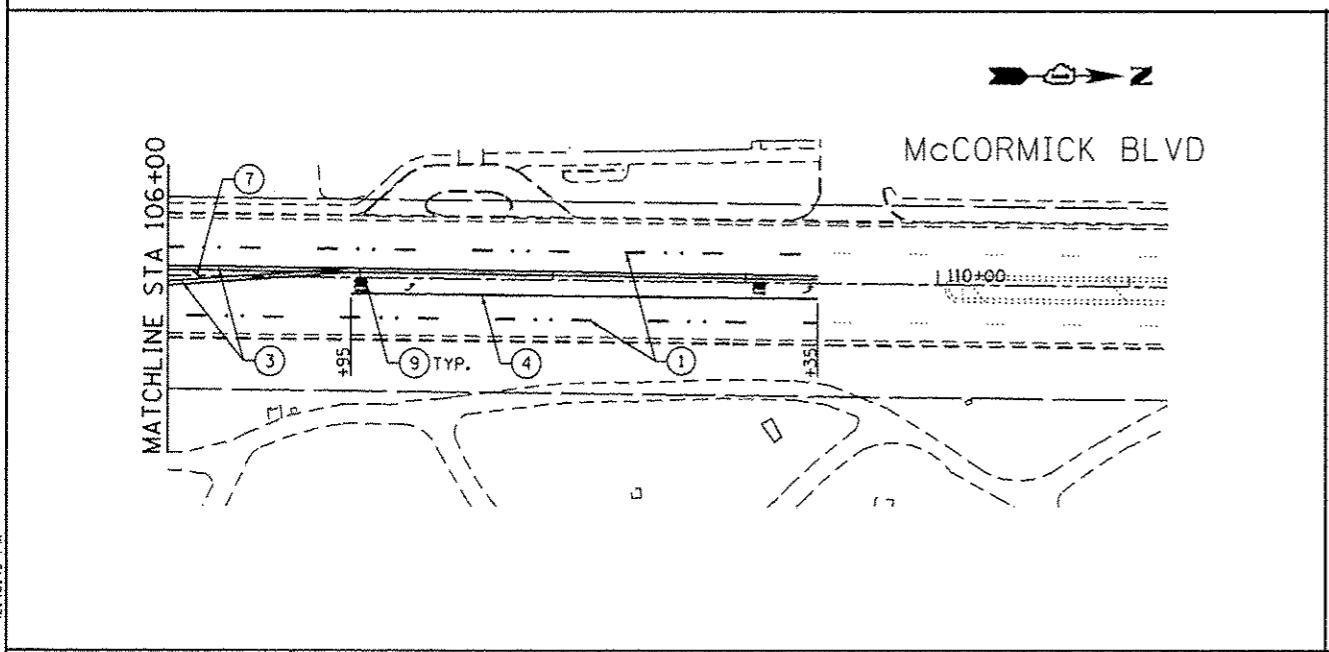
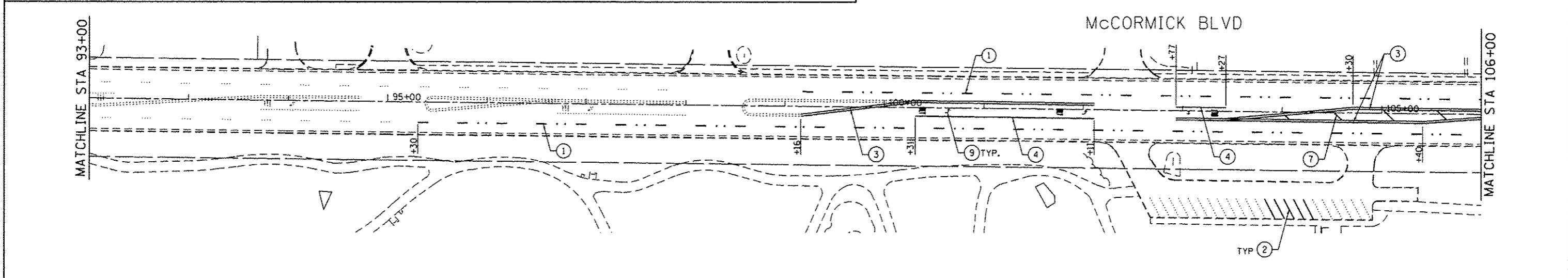

27/11/2013 12:40:49 PM
 FILES

| | | | |
|---|--------------------------------|-------------------|-----------|
| GRAEF 8501 W. Higgins Road Suite 280 Chicago, Illinois 60631 (773) 399-0112 | USER NAME - 1485 | DESIGNED - RS | REVISED - |
| | PLOT SCALE - 1/80.0000' / 1" = | DRAWN - ED | REVISED - |
| | PLOT DATE - 12/11/2013 | CHECKED - RS | REVISED - |
| | | DATE - 12/17/2013 | REVISED - |

STATE OF ILLINOIS
DEPARTMENT OF TRANSPORTATION

McCORMICK BLVD - HOWARD STREET TO TOUHY AVENUE
PAVEMENT MARKING PLAN

SCALE: 1"=50' SHEET OF SHEETS STA. TO STA.

| | | | | |
|---------------------------|----------------|-------------|-----------------|--------------|
| F.A.U. RTE. 0378 | SECTION 3738-T | COUNTY COOK | TOTAL SHEETS 28 | SHEET NO. 19 |
| CONTRACT NO. 60R07 | | | | |
| ILLINOIS FED. AID PROJECT | | | | |