

EXISTING TYPICAL CROSS SECTION
(HMA BASE COURSE)
BARRINGTON ROAD
STA. 10+07 TO STA. 56+96
STA. 66+75 TO STA. 121+06

LEGEND

- ① EXIST. HMA SURF. CSE., ±4"
- ② EXIST. HMA BASE CSE., ±10-1/2"
- ③ EXIST. PCC BASE COURSE, ±10-1/2"
- ④ EXIST. SUB-BASE GRANULAR MATERIAL, TYPE A, 4"
- ⑤ EXIST. STABILIZED MEDIAN SURFACE, 12"
- ⑥ EXIST. COMB. CONC. CURB & GUTTER, TYPE B-6.24
- ⑦ EXIST. COMB. CONC. CURB & GUTTER, TYPE M-2.12
- ⑧ EXIST. GROUND
- ⑨ PROP. HMA SURF. REMOVAL, 2-1/2"
- ⑩ PROP. POLY. HMA SURF. CSE. MIX "F", N90, 1-3/4"
- ⑪ PROP. POLY. LEVELING BINDER (MM), IL-4.75, N50, 3/4"
- *⑫ PROP. COMB. CONC. CURB & GUTTER REM. & REPL.

* LOCATIONS TO BE DETERMINED BY THE FIELD ENGINEER.
" THE CONTRACTOR SHALL PATCH FIRST PRIOR TO MILLING".

ANY SAW CUTTING REQUIRED TO REMOVE AN ITEM ADJACENT TO AN ITEM TO BE SAVED WILL BE CONSIDERED AS PART OF THE REMOVAL ITEM AND WILL NOT BE PAID FOR SEPARATELY.

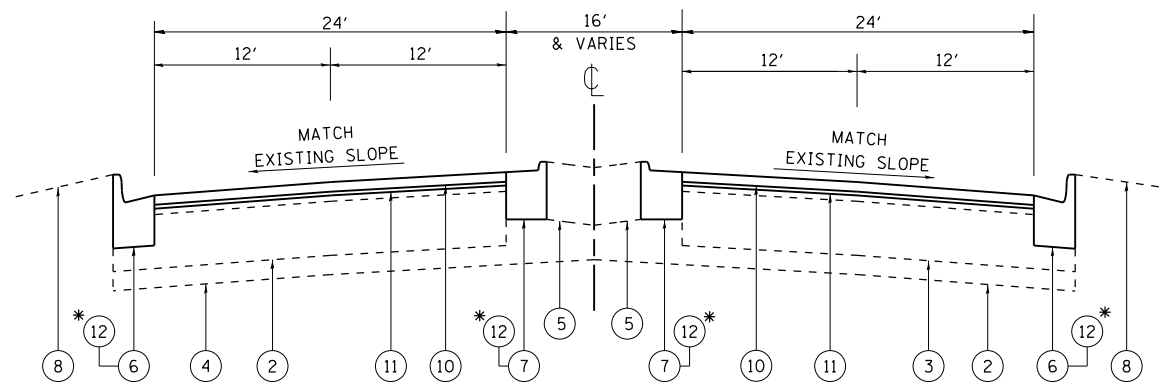

PROPOSED TYPICAL CROSS SECTION
(HMA BASE COURSE)
BARRINGTON ROAD
STA. 10+07 TO STA. 56+96
STA. 66+75 TO STA. 121+06

NOTE:
OMISSION DONE BY OTHERS:
(STA. 63+88 - STA. 66+57) &
(STA. 100+42 - 109+45)

FILE NAME = c:\pwwork\pwwork\galbenj\d0293296\012\012-sht-typical.dgn	USER NAME = galbenj	DESIGNED -	REVISED -	STATE OF ILLINOIS DEPARTMENT OF TRANSPORTATION	EXISTING AND PROPOSED TYPICAL SECTIONS BARRINGTON ROAD (SCHAUMBURG RD. - US RTE. 20)	F.A.P. RTE.	SECTION	COUNTY	TOTAL SHEETS	SHEET NO.
	PLOT SCALE = 100.0000' / in.	CHECKED -	REVISED -			362	0105RS-3	COOK	29	6
Default	PLOT DATE = 5/30/2014	DATE -	REVISED -	SCALE:	SHEET OF SHEETS	STA. TO STA.	ILLINOIS FED. AID PROJECT CONTRACT NO. 60R96			