

WORK SHALL MEET THE REQUIREMENTS OF THE SPECIAL PROVISION, "TRAFFIC SIGNAL SPECIFICATIONS FOR DETECTOR LOOP REPLACEMENT AND/OR INSTALLATION ON ROADWAY GRINDING, RESURFACING AND PATCHING OPERATIONS". SPECIAL ATTENTION MUST BE MADE TO THE SECTIONS "INSPECTION OF CONSTRUCTION" AND "DETECTOR LOOP REPLACEMENT" FOR INSTALLATION AND INSPECTION REQUIREMENTS. LOOP REPLACEMENT WORK THAT DOES NOT MEET THE CONTRACT REQUIREMENTS SHALL NOT BE PAID. WORK NECESSARY TO COMPLETE THE LOOP REPLACEMENT WORK MAY BE ASSIGNED BY THE ENGINEER TO IDOT'S ELECTRICAL MAINTENANCE CONTRACTOR (EMC); ALL RELATED COSTS WILL BE THE RESPONSIBILITY OF THE CONTRACTOR.

PROPOSED EXISTING

SIGNAL HEAD WITH BACKPLATE  
 SIGNAL HEAD  
 GALVANIZED STEEL CONDUIT IN TRENCH OR PUSHED  
 DETECTOR LOOP  
 VEHICLE DETECTOR, NON COMPENSATED MAGNETIC TYPE  
 RACEWAY FOR MAGNETIC DETECTOR, TYPE I OR TYPE II

Resurfacing Limits

Resurfacing Limits

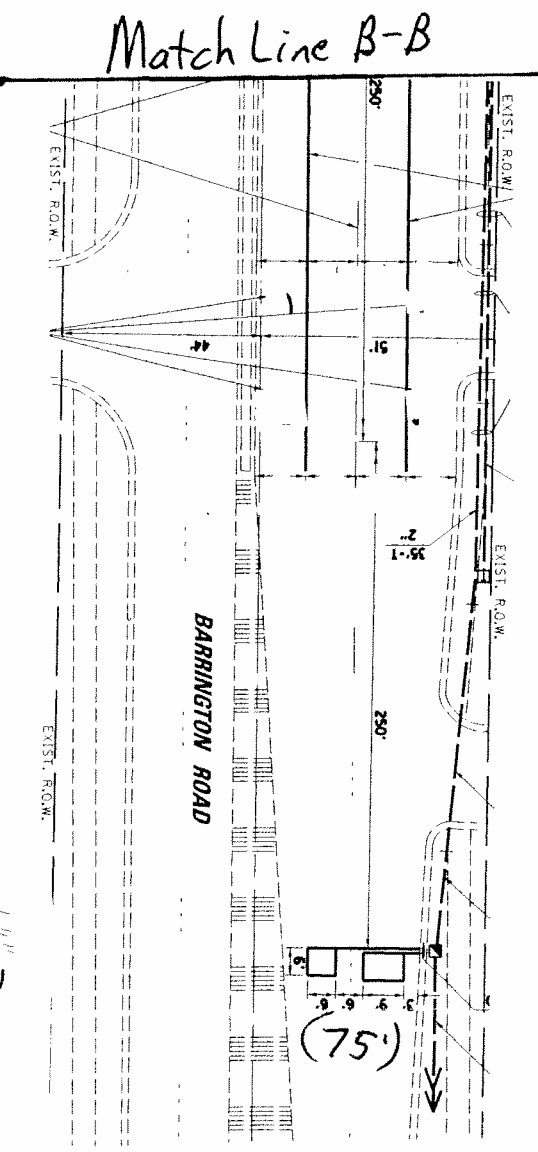
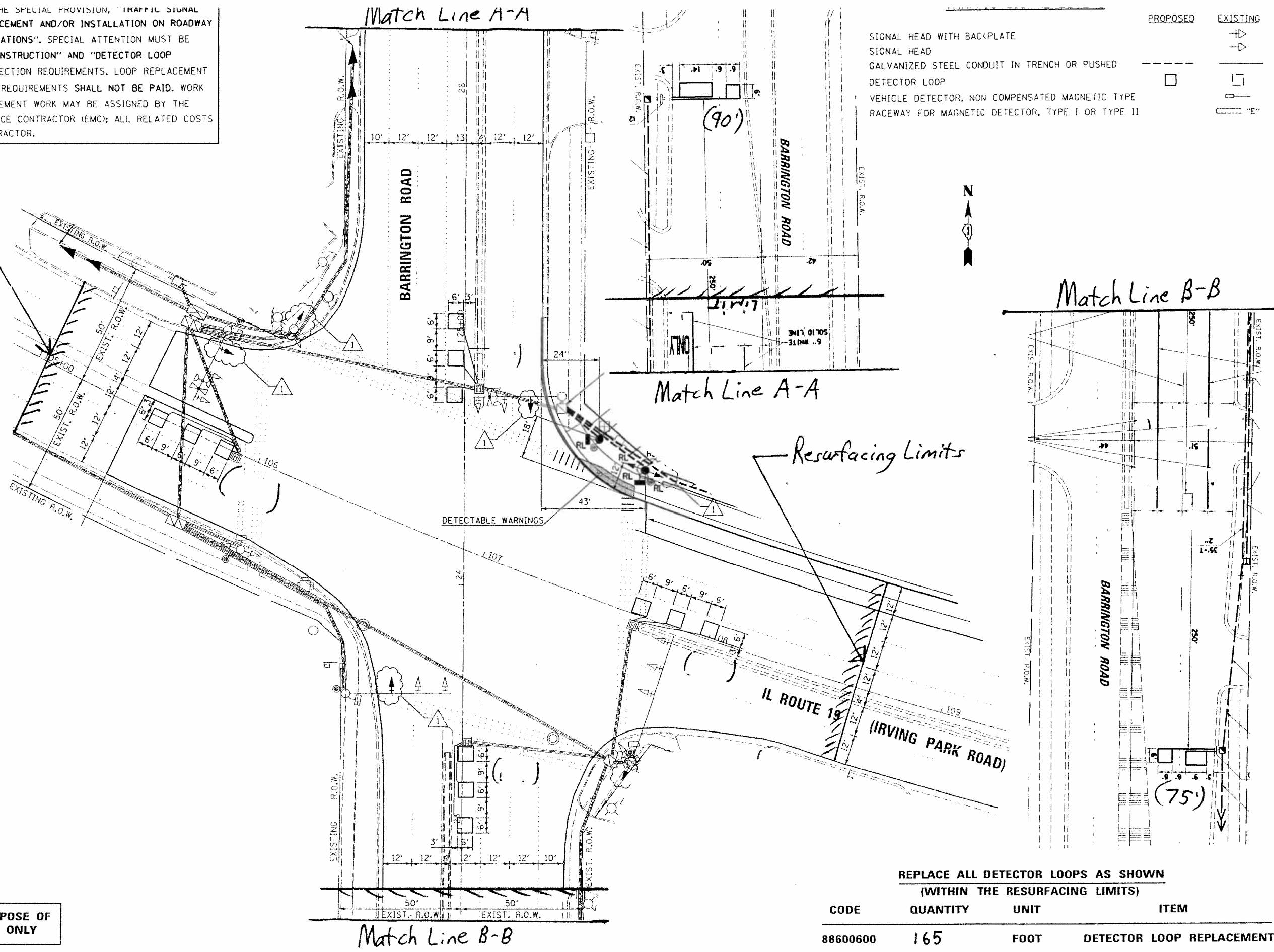

THIS PLAN IS FOR THE SOLE PURPOSE OF  
 DETECTOR LOOP REPLACEMENTS ONLY

REPLACE ALL DETECTOR LOOPS AS SHOWN  
 (WITHIN THE RESURFACING LIMITS)

| CODE     | QUANTITY | UNIT | ITEM                      |
|----------|----------|------|---------------------------|
| 88600600 | 165      | FOOT | DETECTOR LOOP REPLACEMENT |