

**M.O.T. TYPICAL SECTION STAGE 2
IL ROUTE 47**

STA. 110+70 TO STA. 120+00
(LOOKING NORTH)

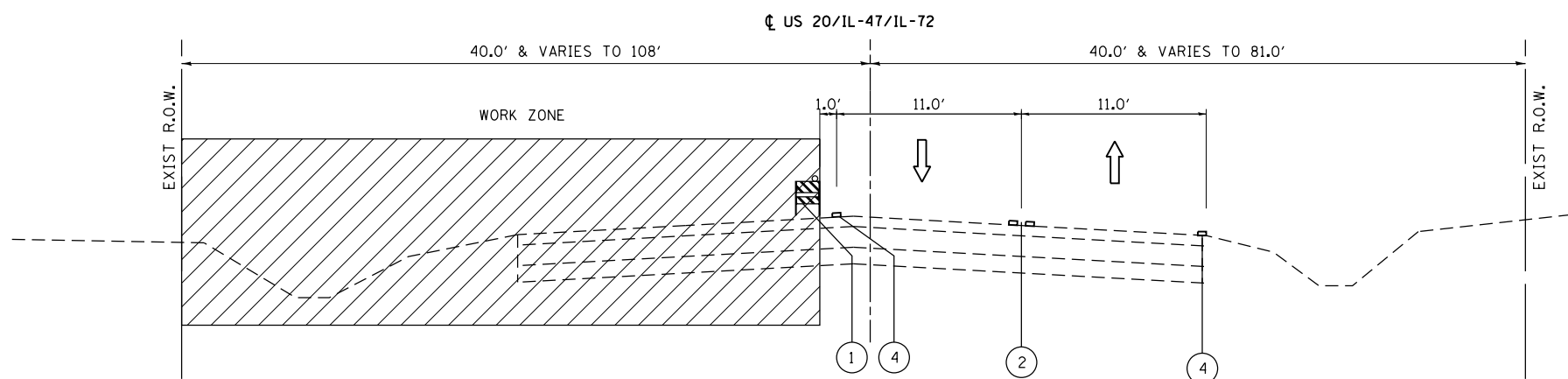

**M.O.T. TYPICAL SECTION - STAGE 2
U.S. ROUTE 20 /IL ROUTE 47 /IL ROUTE 72**

STA. 120+00 TO STA. 129+00
(LOOKING NORTH)

LEGEND

- ① TYPE II BARRICADE, DRUM OR VERTICAL BARRICADE
- ② EXISTING 4" DOUBLE SOLID YELLOW (11" C-C)
- ③ TEMPORARY PAVEMENT MARKING - LINE 6" (WHITE)
- ④ TEMPORARY PAVEMENT MARKING - LINE 4" (WHITE)
- ← DIRECTION OF TRAFFIC
- ▨ WORK ZONE

NOTES

1. PRIOR TO INSTALLING POST MOUNTED SIGNS, THE CONTRACTOR SHALL CONTACT J.U.L.I.E.
2. SEE STAGING PLAN AND STANDARD 701326 FOR ADDITIONAL INFORMATION.

FILE NAME =	USER NAME = chrtsfish	DESIGNED - MTM	REVISED -	STATE OF ILLINOIS DEPARTMENT OF TRANSPORTATION	SUGGESTED MAINTENANCE OF TRAFFIC STAGE 2 TYPICAL SECTION - SOUTH JUNCTION	F.A.P. RTE.	SECTION	COUNTY	TOTAL SHEETS	SHEET NO.
	Default	PLOT SCALE = 10.0000' / in.	CHECKED - BA			REVISED -	345	106-S-N-2	KANE	147
	PLOT DATE = 4/1/2014	DATE - 3/31/14	REVISED -		SCALE: N.T.S.	SHEET 4 OF 7 SHEETS		STA.	TO STA.	
						ILLINOIS FED. AID PROJECT CONTRACT NO. 60T09				