

NOTE: FOR DOUBLE CELL CULVERT REMOVAL SEE STRUCTURAL PLANS AND DETAILS

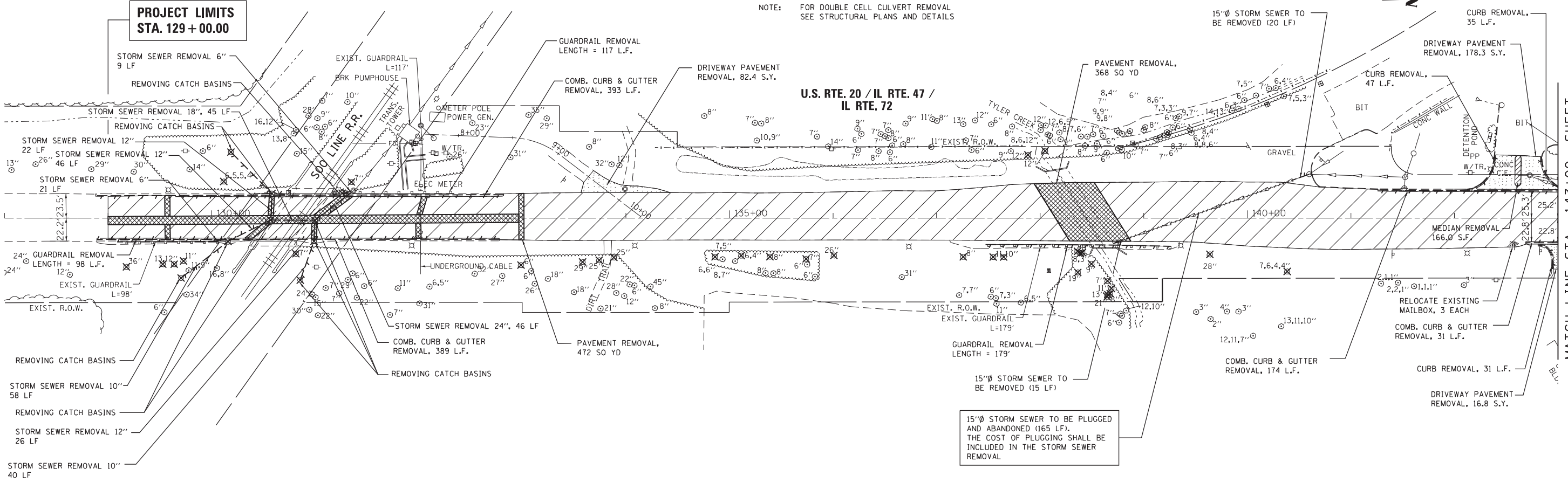

G:\Projects\ILLINOIS Department of Transportation\PTB 162 - Item 7 - Various Various Work Order No. 10 (North) - US 20 et. IL 47 & IL 72 Civil Cadd Sheets\160110-sht-removal.dgn

MATCH LINE STA. 147+00 - SHEET

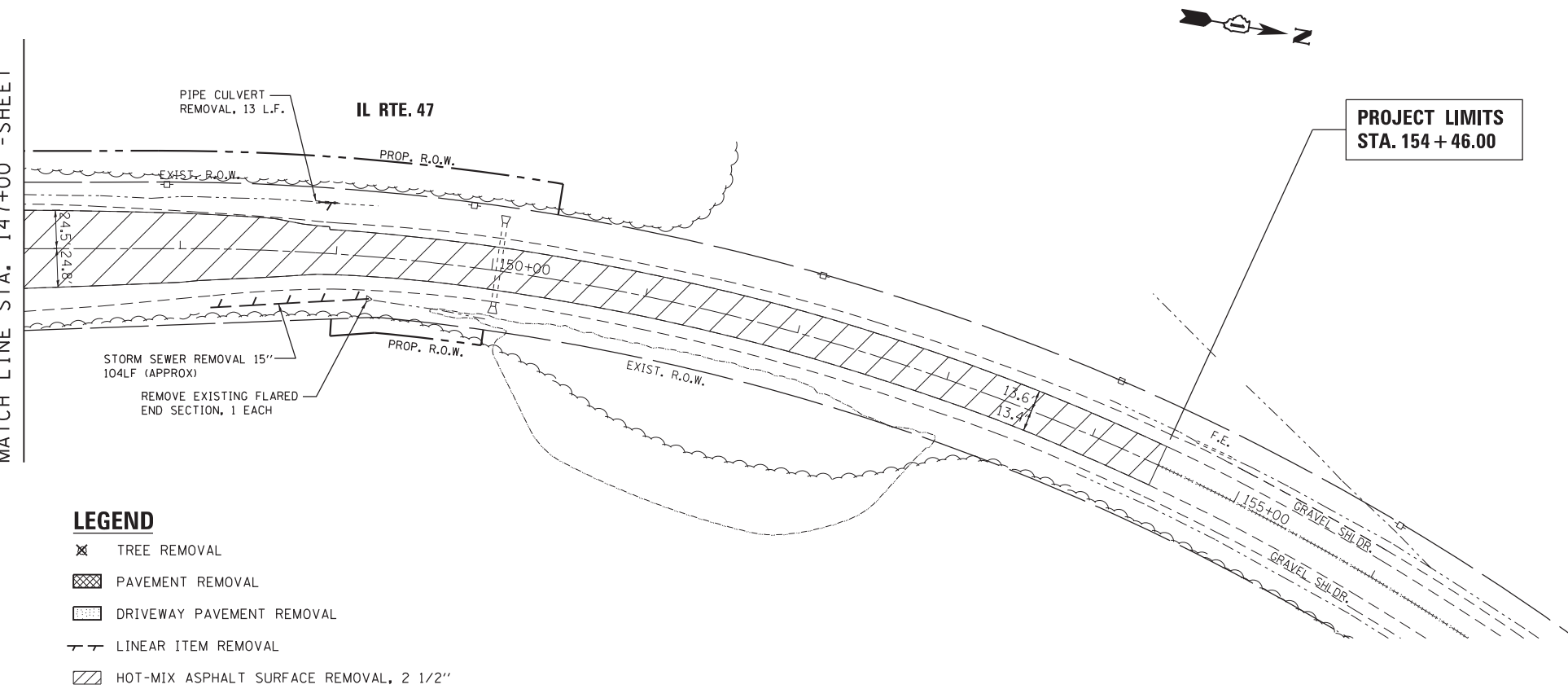

TREE REMOVAL SCHEDULE

STATION	OFFSET	UNIT	Ø	STATION	OFFSET	UNIT	Ø	STATION	OFFSET	UNIT	Ø	STATION	OFFSET	UNIT	Ø
35+48.51	39.7'	RT	14"	36+86.93	67.3'	LT	16"	136+00.77	36.2'	RT	26"				
35+56.56	39.7'	RT	18"	36+88.91	44.0'	LT	8"	137+25.69	37.3'	RT	8"				
35+66.40	39.7'	RT	19"	36+96.80	45.1'	LT	10"	137+54.61	37.5'	RT	11"				
35+69.96	52.6'	RT	32"	129+17.71	47.0'	RT	36"	137+64.77	37.5'	RT	10"				
35+77.23	39.9'	RT	20"	129+52.75	44.5'	RT	13"	137+88.13	61.2'	LT	12"				
35+87.70	37.5'	RT	7"	129+63.82	44.5'	RT	12"	138+04.72	65.0'	LT	12"				
36+38.44	48.4'	LT	6"	129+72.77	41.4'	RT	11"	138+36.04	32.0'	RT	7"				
36+38.44	53.9'	LT	8"	130+11.62	35.4'	LT	6"	138+36.31	52.4'	RT	19"				
36+42.00	48.4'	LT	7"	130+81.32	34.4'	RT	7"	138+38.79	34.0'	RT	8"				
36+44.09	53.9'	LT	8"	131+34.95	35.0'	LT	7"	138+40.73	33.2'	RT	8"				
36+47.05	66.2'	LT	12"	132+98.70	45.3'	RT	6"	138+49.50	44.2'	RT	9"				
36+58.96	44.6'	LT	12"	133+58.12	42.4'	RT	29"	138+64.70	76.0'	RT	21"				
36+73.60	57.6'	LT	6"	133+74.17	40.7'	RT	25"	138+65.00	60.6'	RT	7"				
36+80.52	61.0'	LT	17"	133+88.28	38.0'	RT	25"	138+65.40	74.0'	RT	13"				
36+82.02	42.9'	LT	6"	134+86.01	37.3'	RT	7"	138+67.60	72.8'	RT	8"				
36+82.12	64.6'	LT	11"	135+11.32	36.3'	RT	6"	138+68.72	68.0'	RT	11"				
36+83.02	63.8'	LT	11"	135+39.02	37.2'	RT	8"	139+63.79	35.0'	RT	28"				
36+85.26	64.2'	LT	11"	135+73.96	39.3'	RT	7"	140+38.49	51.6'	RT	7"				

- LEGEND**
- ✕ TREE REMOVAL
 - ▨ PAVEMENT REMOVAL
 - ▨ DRIVEWAY PAVEMENT REMOVAL
 - LINEAR ITEM REMOVAL
 - ▨ HOT-MIX ASPHALT SURFACE REMOVAL, 2 1/2"

FILE NAME =	USER NAME = chr1s1f1sh	DESIGNED - MTM	REVISED -
		DRAWN - MTM	REVISED -
	PLOT SCALE = 100.0000' / in.	CHECKED - BA	REVISED -
	PLOT DATE = 4/1/2014	DATE - 3/31/14	REVISED -

**STATE OF ILLINOIS
DEPARTMENT OF TRANSPORTATION**

**EXISTING CONDITIONS AND REMOVAL PLAN
US RTE 20 (NORTH JUNCTION)**

SCALE: 1"=50' SHEET 2 OF 2 SHEETS STA. TO STA.

F.A.P. RTE.	SECTION	COUNTY	TOTAL SHEETS	SHEET NO.
345	106-S-N-1	KANE	167	29
CONTRACT NO. 60T10				
ILLINOIS FED. AID PROJECT				