



PROJECT LIMITS  
STA. 17 + 84.00

END  
WORK ZONE  
SPEED LIMIT  
G20-1103(O)-3660



MATCH LINE STA. 27+00 - SEE BELOW

U.S. RTE. 20

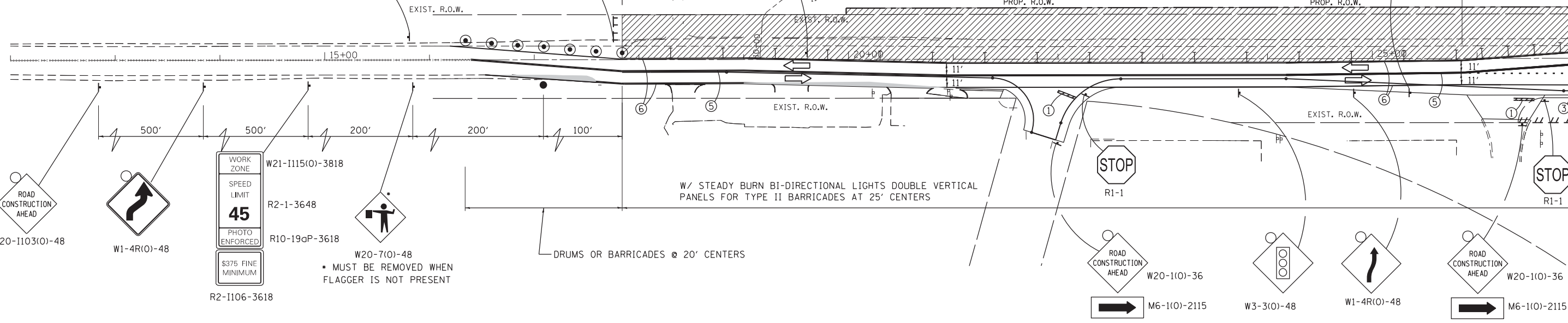

WORK ZONE  
SPEED LIMIT  
45  
PHOTO ENFORCED  
R2-1-3648  
R10-19aP-3618  
R2-1106-3618

W20-7(O)-48  
• MUST BE REMOVED WHEN FLAGGER IS NOT PRESENT

W/ STEADY BURN BI-DIRECTIONAL LIGHTS DOUBLE VERTICAL PANELS FOR TYPE II BARRICADES AT 25' CENTERS

DRUMS OR BARRICADES @ 20' CENTERS

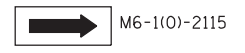
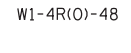
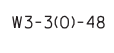
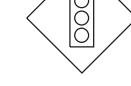
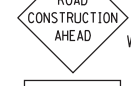

MATCH LINE STA. 147+00 - SHEET 6

PROJECT LIMITS  
STA. 40 + 40.00



MATCH LINE STA. 42+00 - SEE SHEET 5

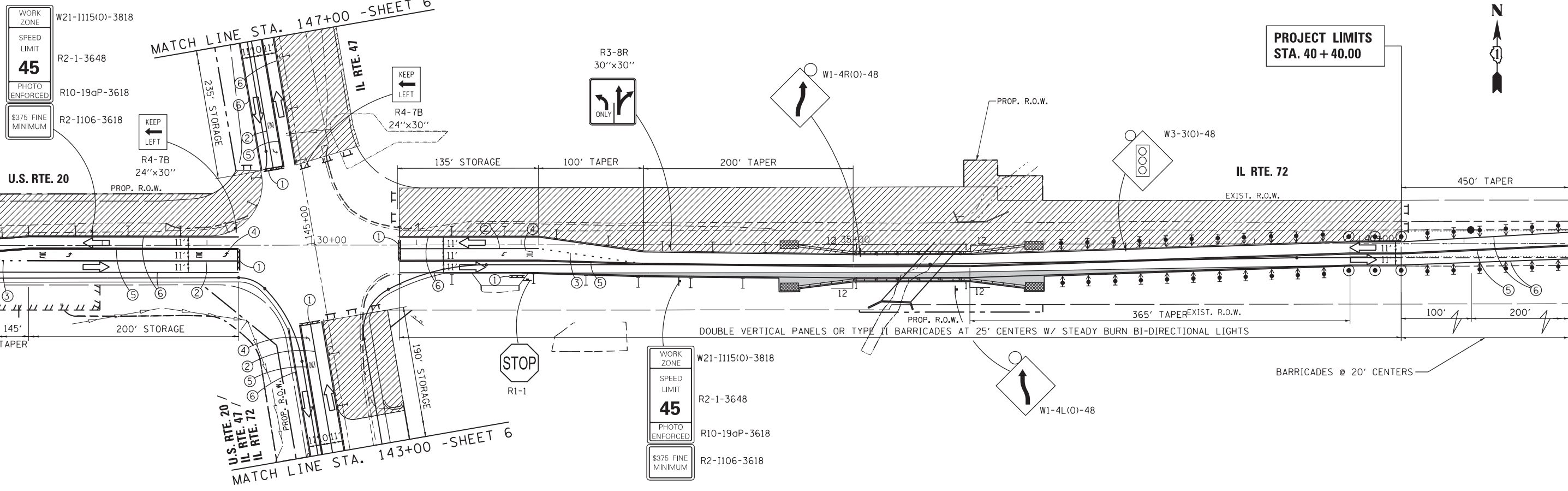

WORK ZONE  
SPEED LIMIT  
45  
PHOTO ENFORCED  
R2-1-3648  
R10-19aP-3618  
R2-1106-3618

KEEP LEFT  
R4-7B  
24''x30''

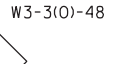
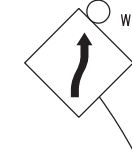

WORK ZONE  
SPEED LIMIT  
45  
PHOTO ENFORCED  
R2-1-3648  
R10-19aP-3618  
R2-1106-3618



BARRICADES @ 20' CENTERS

FILE NAME =	USER NAME = chr1sf1sh	DESIGNED - MTM	REVISED -	STATE OF ILLINOIS DEPARTMENT OF TRANSPORTATION	SUGGESTED MAINTENANCE OF TRAFFIC - STAGE 3 US RTE 20 (NORTH JUNCTION)			F.A.P. RTE. 345	SECTION 106-S-N-1	COUNTY KANE	TOTAL SHEETS 167	SHEET NO. 43
	PLOT SCALE = 100.0000' / in.	CHECKED - BA	REVISED -		SCALE: 1"=50'	SHEET 4	OF 6 SHEETS	STA. 17+84	TO STA. 40+40	CONTRACT NO. 60T10		
Default	PLOT DATE = 4/1/2014	DATE = 3/31/14	REVISED -					ILLINOIS FED. AID PROJECT				

G:\Projects\ILLINOIS Department of Transportation\PTB 162 - Item 7 - Various Various Work Order No. 10 (Mort-1) - US 20 st. IL 47 & IL 72\Civil\Cadd Sheets\160T10-sht-3-stage2.dgn