

- ① PROP. SIDEWALK REMOVAL
- PROP. PCC SIDEWALK RAMP (SEE HWY STD. ON SHEET 2)
- PROP. DETECTABLE WARNINGS

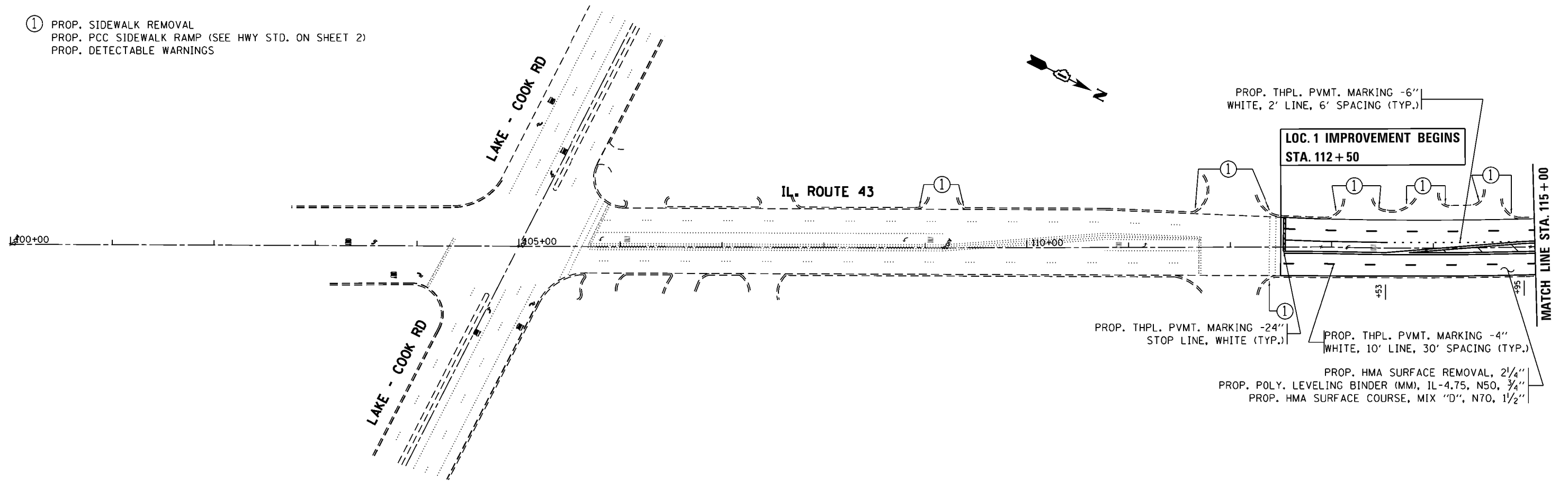

- ① PROP. SIDEWALK REMOVAL
- PROP. PCC SIDEWALK RAMP (SEE HWY STD. ON SHEET 2)
- PROP. DETECTABLE WARNINGS

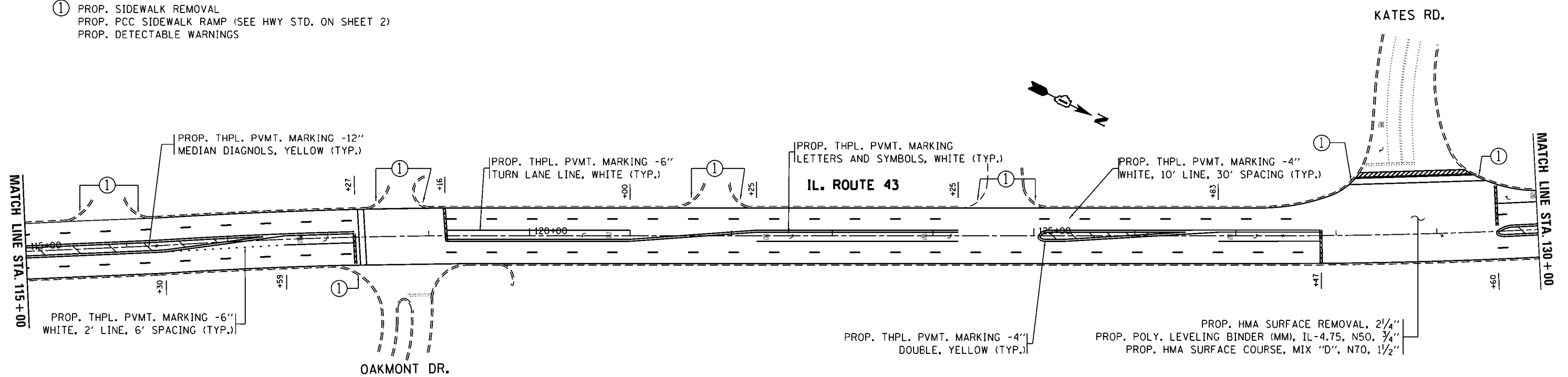

FILE NAME =	USER NAME = pyrozenawskirb	DESIGNED -	REVISED -
ci:\pwwork\pwwork\pyrozenawskirb\0311620	D151112-sh1-plan.dgn	DRAWN -	REVISED -
Default	PLOT SCALE = 100.000' / in.	CHECKED -	REVISED -
	PLOT DATE = 6/6/2014	DATE -	REVISED -

**STATE OF ILLINOIS
DEPARTMENT OF TRANSPORTATION**

IL. ROUTE 43 FROM N. OF LAKE-COOK RD. TO OSTERMAN AVE.

SCALE: SHEET OF SHEETS STA. TO STA.

F.A.U. RTE.	SECTION	COUNTY	TOTAL SHEETS	SHEET NO.
2706	(AY&BY)RS-2	LAKE	28	8
CONTRACT NO. 60V04			ILLINOIS FED. AID PROJECT	