

GENERAL NOTES

THE CONTRACTOR SHALL USE ALL NECESSARY PRECAUTIONARY AND PROTECTIVE MEASURES REQUIRED TO MAINTAIN AND PROTECT EXISTING TRAFFIC CONDUITS AND HANDHOLES AND APPURTENANCES THAT MUST BE KEPT IN OPERATION. IN PARTICULAR, THE CONTRACTOR SHALL TAKE ADEQUATE MEASURES TO PREVENT THE UNDERMINING OF CONDUITS AND HANDHOLES WHICH ARE STILL IN SERVICE. THE CONTRACTOR SHALL COORDINATE WITH THE ENGINEER AND UTILITIES COMPANY IF IT IS DETERMINED THAT TEMPORARY BRACING OR SUPPORT OF THE TRAFFIC SIGNAL EQUIPMENT IS REQUIRED. THE PROTECTION AND/OR TEMPORARY BRACING OR SUPPORT OF THE TRAFFIC SIGNAL EQUIPMENT WILL NOT BE PAID FOR SEPERATELY BUT SHALL BE CONSIDERED AS INCLUDED IN THE UNIT BID PRICES OF THE CONTRACT AND NO ADDITIONAL COMPENSATION WILL BE ALLOWED.

THE CONTRACTOR SHALL COORDINATE CONSTRUCTION ACTIVITIES WITH UTILITY COMPANIES, LOCAL GOVERNMENT AGENCIES AND IDOT.

THE CONTRACTOR IS RESPONSIBLE FOR RETURNING ALL AREAS AFFECTED BY EQUIPMENT OR LABORERS TO EXISTING CONDITIONS. THE CONTRACTOR IS ALSO RESPONSIBLE FOR PROTECTING ALL NEW WORK UNTIL COMPLETION OF THIS CONTRACT.

EXISTING UTILITIES: WHEN THE PLANS OR SPECIAL PROVISIONS INCLUDE INFORMATION PERTAINING TO THE LOCATION OF UNDERGROUND UTILITY FACILITIES, SUCH INFORMATION IS BASED ON RECORD INFORMATION PROVIDED BY THE INDIVIDUAL UTILITY OWNERS. IT SHALL BE THE CONTRACTOR'S RESPONSIBILITY TO DETERMINE THE ACTUAL LOCATION OF ALL SUCH FACILITIES. THE CONTRACTOR SHALL ALSO CONTACT J.U.L.I.E. TO OBTAIN LOCATES OF THE RESPECTIVE UTILITY COMPANIES' UNDERGROUND FACILITIES.

BEFORE STARTING ANY EXCAVATION, THE CONTRACTOR SHALL CALL "J.U.L.I.E." AT (800) 892-0123 OR 811 FOR FIELD LOCATIONS OF BURIED ELECTRIC, TELEPHONE AND GAS UTILITIES. 48 HOUR NOTIFICATION IS REQUIRED.

CONSTRUCTION NOTE:

- THE CONTRACTOR SHOULD COORDINATE WITH THE PRESIDENT ENGINEER ON CONTRACT 60T97 (BRYAN HOFSTETTER; 630-595-5350) TO SCHEDULE FOR THE INSTALLATION OF THE STORM SEWER.

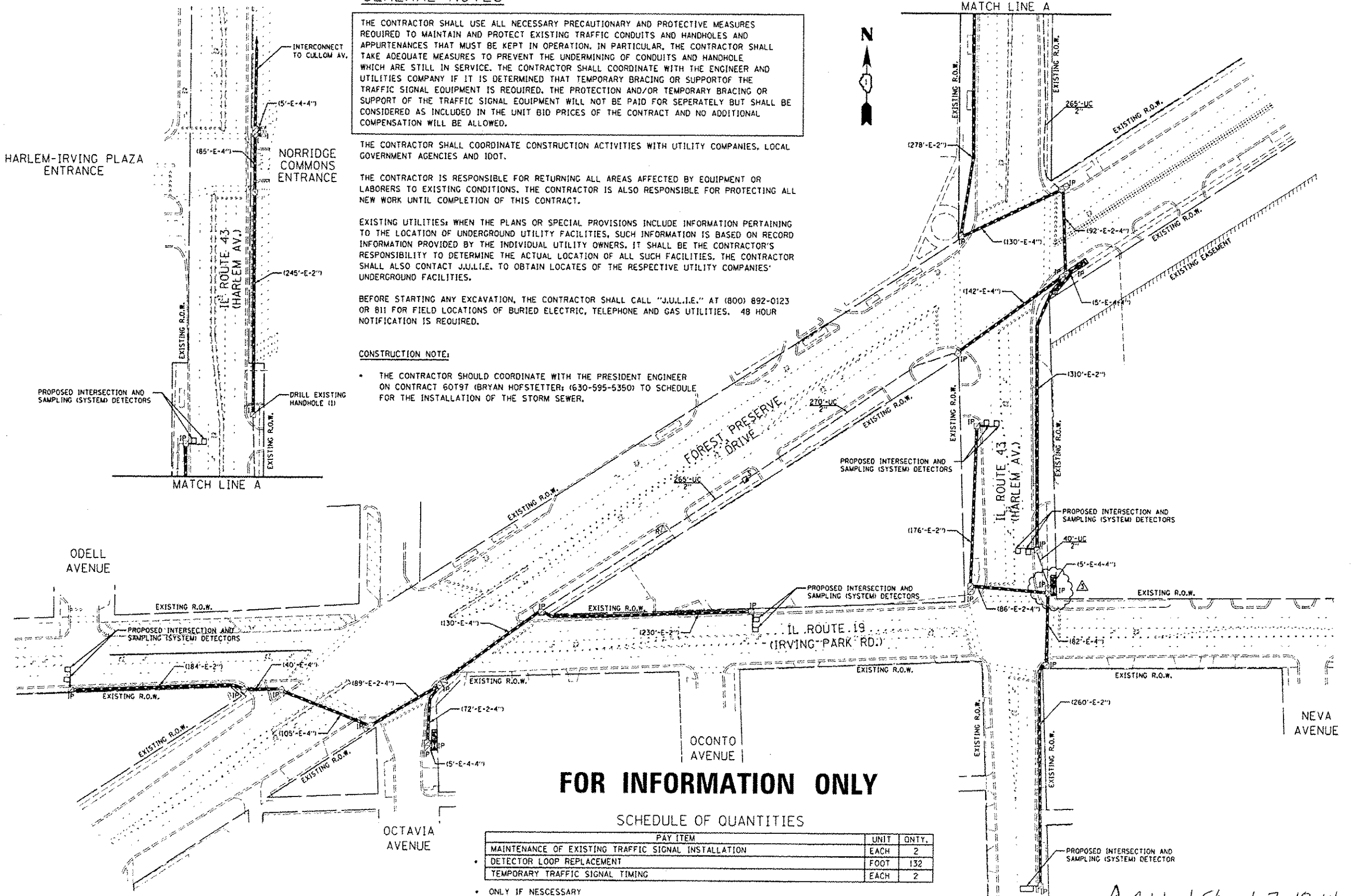

FOR INFORMATION ONLY

SCHEDULE OF QUANTITIES

PAY ITEM	UNIT	QNTY.
MAINTENANCE OF EXISTING TRAFFIC SIGNAL INSTALLATION	EACH	2
DETECTOR LOOP REPLACEMENT	FOOT	132
TEMPORARY TRAFFIC SIGNAL TIMING	EACH	2

• ONLY IF NECESSARY

Added Sheet 7-18-14

USER NAME: <i>mgp/mg</i> PLOT SCALE: 1" = 100.0000' PLOT DATE: 7/14/2014	DESIGNED: _____ DRAWN: _____ CHECKED: _____ DATE: _____ #DDATE	REVISED: _____ REVISED: _____ REVISED: _____ REVISED: _____	STATE OF ILLINOIS DEPARTMENT OF TRANSPORTATION	INTERCONNECT PLAN IL ROUTE 19 (IRVING PARK RD.), IL ROUTE 43 (HARLEM AV.) AND FOREST PRESERVE DRIVE SCALE: 1" = 50' SHEET NO. 1 OF 1 SHEETS STA. TO STA.	SECTION: 3134-T(14) COUNTY: COOK TOTAL SHEETS: 17 SHEET NO.: 7A CONTRACT NO. 60Y36 ILLINOIS FED. AID PROJECT
--	---	--	---	--	---