

STATE OF ILLINOIS
DEPARTMENT OF TRANSPORTATION
DIVISION OF HIGHWAYS

**PROPOSED
HIGHWAY PLANS**
FAP ROUTE 348: IL 43 (HARLEM AVE.)
FOREST PRESERVE DR. TO ILL 19 (IRVING PARK RD.)
SECTION: 3134-T(14)
DRAINAGE IMPROVEMENT
COOK COUNTY
C-91-368-14

F.A.P. RTE.	SECTION	COUNTY	TOTAL SHEETS	SHEET NO.
348	3134-T(14)	COOK	16	1
ILLINOIS			CONTRACT NO. 60Y36	

**16 + 1 = 17*

D-91-368-14

FOR INDEX OF SHEETS, SEE SHEET NO. 2

THIS IMPROVEMENT IS LOCATED IN THE VILLAGES OF NORRIDGE, HARWOOD HEIGHTS AND THE CITY OF CHICAGO

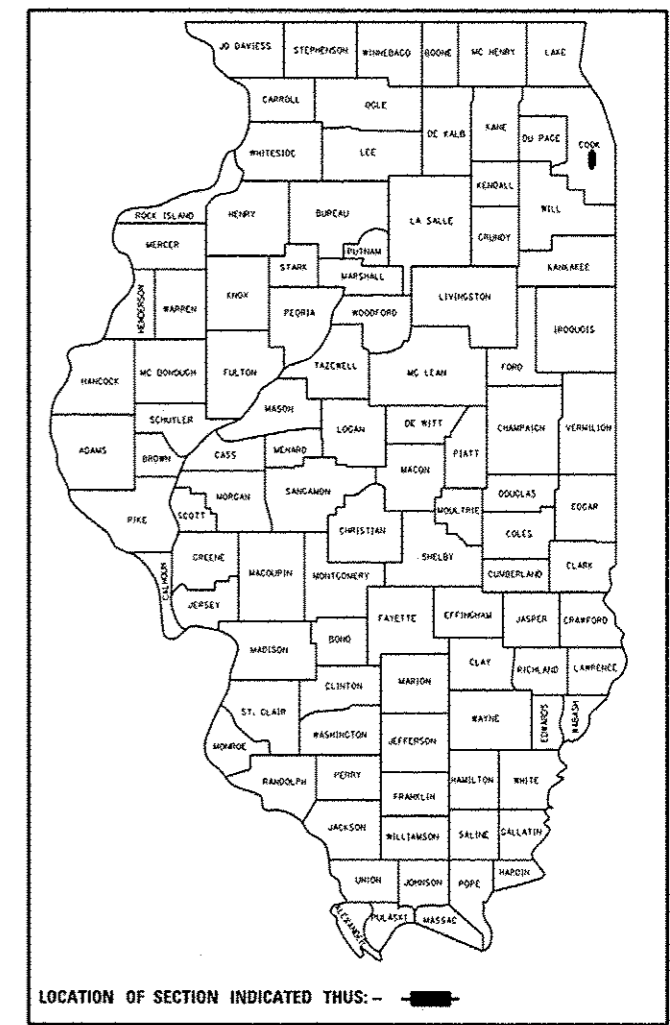

DRAINAGE IMPROVEMENT LOCATION

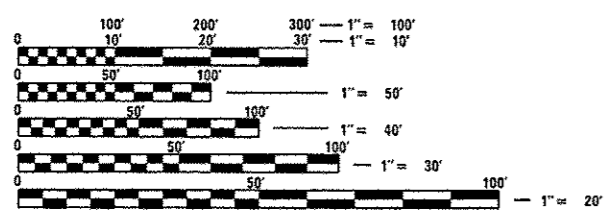
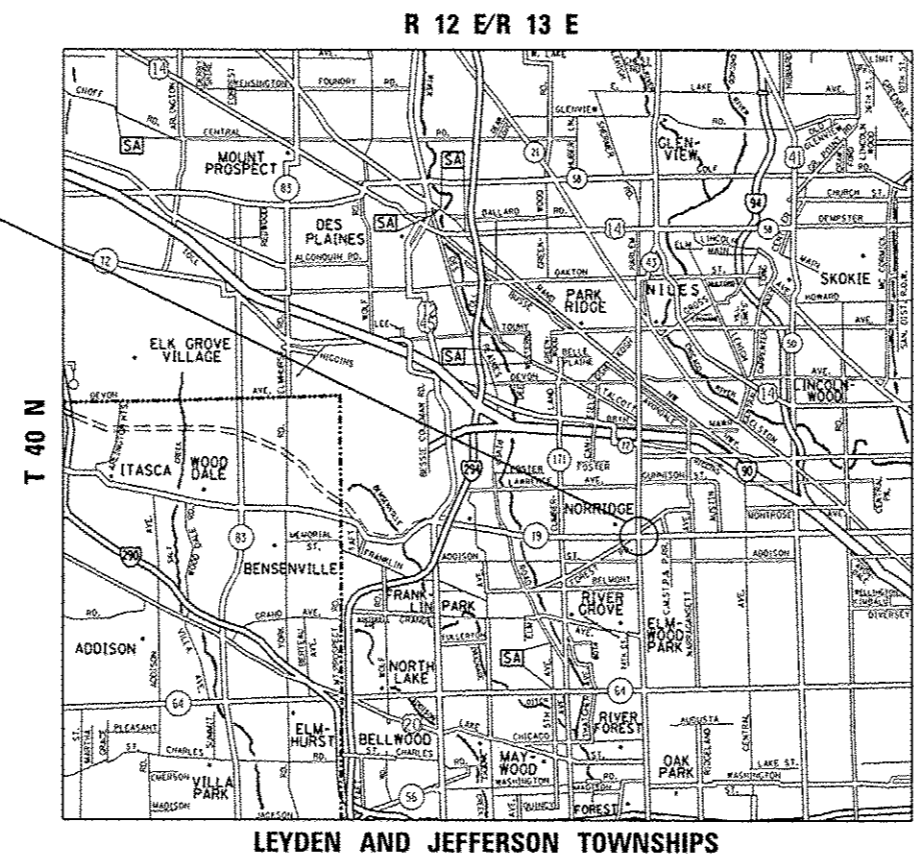

FULL SIZE PLANS HAVE BEEN PREPARED USING STANDARD ENGINEERING SCALES. REDUCED SIZED PLANS WILL NOT CONFORM TO STANDARD SCALES. IN MAKING MEASUREMENTS ON REDUCED PLANS, THE ABOVE SCALES MAY BE USED.

J.U.L.I.E.
JOINT UTILITY LOCATION INFORMATION FOR EXCAVATION
1-800-892-0123
OR 811

PROJECT ENGINEER: JEAN ALAIN MIDY (847) 221-3056
PROJECT MANAGER: ISSAM RYAN (847) 705-4178

CONTRACT NO. 60Y36

GROSS AND NET LENGTH OF IMPROVEMENT = 182 LINEAL FEET = .03 MILE

TRAFFIC DATA
ADT (2011) = 15100
SPEED LIMIT = 35 MPH

STATE OF ILLINOIS
DEPARTMENT OF TRANSPORTATION
DIVISION OF HIGHWAYS

SUBMITTED *May 27 20 14*
John Fortmann
DEPUTY DIRECTOR OF HIGHWAYS, REGION ENGINEER

June 27 20 14
John D. Baranzelli, PE, Jr.
ENGINEER OF DESIGN AND ENVIRONMENT

June 27 20 14
Omer Osman, PE, Jr.
DIRECTOR OF HIGHWAYS, CHIEF ENGINEER

PRINTED BY THE AUTHORITY
OF THE STATE OF ILLINOIS

Rev. 7-

INDEX OF SHEETS

SHEET NO.	DESCRIPTION
1	COVER SHEET
2	INDEX OF SHEETS, STANDARDS, AND GENERAL NOTES
3-4	SUMMARY OF QUANTITIES
5	ALIGNMENT, TIES & BENCHMARKS PLAN
6	EXISTING DRAINAGE PLAN
* 7	PROPOSED DRAINAGE PLAN
8	OUTLET CONTROL STRUCTURE W/WEIR DETAILS
9	CITY OF CHICAGO DRAINAGE DETAILS (BD-9)
10	CITY OF CHICAGO PC CONCRETE DRIVEWAY, ALLEY RETURN AND SIDEWALK (BD-17)
11	PAVEMENT PATCHING FOR HMA SURFACED PAVEMENT (BD-22)
12	CURB OR CURB AND GUTTER REMOVAL AND REPLACEMENT (BD-24)
13	CITY OF CHICAGO CATCH BASINS, INLET AND MANHOLE DETAILS (BD-47)
14	TRAFFIC CONTROL AND PROTECTION FOR SIDE ROADS, INTERSECTION AND, DRIVEWAYS (TC-10)
15	TRAFFIC CONTROL AND PROTECTION AT TURN BAYS (TO REMAIN OPEN TO TRAFFIC) (TC-14)
16	ARTERIAL ROAD INFORMATION SIGN (TC-22)

* 7A. INTERCONNECT PLAN

LIST OF STATE STANDARDS

STANDARD NO.	DESCRIPTION
000001-06	STANDARD SYMBOLS, ABBREVIATIONS AND PATTERNS
280001-07	TEMPORARY EROSION CONTROL SYSTEMS
442201-03	CLASS C AND D PATCHES
602001-02	CATCH BASIN, TYPE A
604001-03	FRAME AND LIDS, TYPE 1
604086-02	FRAME AND GRATE TYPE 23
606001-05	COMBINATION CONCRETE CURB AND GUTTER
701001-02	OFF-ROAD OPERATIONS, 2L, 2W, MORE THAN 4.5 M (15') AWAY FROM PAVEMENT EDGE
701301-04	LANE CLOSURE, 2L, 2W, SHORT TIME OPERATIONS
701311-03	LANE CLOSURE, 2L, 2W, MOVING OPERATIONS - DAY ONLY
701606-04	URBAN LANE CLOSURE, MULTILANE, 2W, WITH MOUNTABLE MEDIAN
701701-09	URBAN LANE CLOSURE, MULTILANE INTERSECTION
701801-05	SIDEWALK CORNER OR CROSSWALK CLOSURE
701901-03	TRAFFIC CONTROL DEVICES

GENERAL NOTES

BEFORE STARTING ANY EXCAVATION, THE CONTRACTOR SHALL CALL "JULIE" AT 800-892-0123 OR 811 FOR FIELD LOCATIONS OF BURIED ELECTRIC, TELEPHONE AND GAS FACILITIES. (48 HOUR NOTIFICATION IS REQUIRED).

THE CONTRACTOR SHALL COORDINATE CONSTRUCTION ACTIVITIES WITH UTILITY COMPANIES AND THE VILLAGES OF NORRIDGE, HARWOOD HEIGHTS AND THE CITY OF CHICAGO

THE CONTRACTOR WILL NOT BE ALLOWED TO SET UP A YARD OR FIELD OFFICE ON STATE PROPERTY WITHOUT WRITTEN PERMISSION FROM THE DEPARTMENT

THE ENGINEER SHALL CONTACT MR. JOE ECKERT AREA TRAFFIC FIELD ENGINEER AT (224) 217-8632 A MINIMUM OF 2 WEEKS PRIOR TO PLACEMENT OF PERMANENT PAVEMENT MARKING.

IT SHALL BE THE CONTRACTOR'S RESPONSIBILITY TO VERIFY ALL DIMENSIONS AND CONDITIONS EXISTING IN THE FIELD PRIOR TO CONSTRUCTION AND ORDERING OF MATERIALS

THE CONTRACTOR SHALL CONTACT THE DISTRICT ONE TRAFFIC CONTROL SUPERVISOR AT (847)705-4470 A MINIMUM OF 72 HOURS IN ADVANCE OF BEGINNING WORK.

THE CONTRACTOR SHALL BE REQUIRED TO PROVIDE ACCESS TO ADJUTING PROPERTY AT ALL TIMES DURING THE CONSTRUCTION OF THIS PROJECT.

TOP OF FRAME ("RIM") ELEVATIONS GIVEN ON THE PLANS ARE ONLY TO ASSIST THE CONTRACTOR IN DETERMINING THE APPROXIMATE OVERALL HEIGHT OF EACH STRUCTURE. FRAMES ON ALL NEW STRUCTURES SHALL BE ADJUSTED TO THE FINAL ELEVATIONS OF THE AREAS IN WHICH THEY ARE LOCATED, AS PART OF THE STRUCTURE COST.

CHICAGO NOTES

BEFORE STARTING ANY EXCAVATION, THE CONTRACTOR SHALL CALL "C.U.A.N" AT 312-744-700 FOR FIELD LOCATIONS OF BURIED ELECTRIC, TELEPHONE AND GAS FACILITIES. (48 HOUR NOTIFICATION IS REQUIRED).

ALL CATCH BASINS IN THE CITY OF CHICAGO MUST MEET THE DEPARTMENT OF SEWERS' STANDARDS.

SEWER SIZES 21" DIAMETER OR SMALLER MUST BE EXTRA-STRENGTH VITRIFIED CLAY PIPE C-700 WITH C-425 JOINTS, OR DUCTILE IRON PIPE WITH PUSH-ON OR MECHANICAL JOINTS. SEWER SIZES 24" DIAMETER OR LARGER MUST BE REINFORCED CONCRETE PIPE TYPE C-76, CLASS III, WALL "B" WITH "O-RING" JOINTS.

PERMITS FROM THE DEPARTMENT OF SEWERS ARE REQUIRED FOR ALL UNDERGROUND STORM, SANITARY OR COMBINED SEWER SYSTEM CONSTRUCTION, AND FOR RESURFACING WORK INVOLVING ADJUSTMENT OF SEWER STRUCTURES. THE DEPARTMENT OF SEWERS' PERMIT MUST BE OBTAINED BY A LICENSED SEWER DRAIN LAYER PRIOR TO START OF CONSTRUCTION.

THE LICENSED SEWER CONTRACTOR/SUB-CONTRACTOR MUST SUBMIT TWO (2) SETS OF PLANS APPROVED BY THE DEPARTMENT OF SEWERS FOR THE ISSUE OF THE SEWER PERMIT IN SUITE 410-333 SOUTH STATE STREET, CHICAGO, IL 60604. INSPECTION WILL BE PROVIDED BY THE DEPARTMENT OF SEWERS.

PERFORATED LIDS SHALL BE PLACED ON ALL MANHOLES AND CATCH BASINS.

THE CONTRACTOR SHALL CONTACT JIM LITTLE TWO WEEKS IN ADVANCE PRIOR TO THE REMOVAL AND INSTALLATION OF THE EXISTING P.A.C.E BUS CANOPY.

ILLINOIS CONVENIENCE AND SAFETY
6624 W. IRVING PARK ROAD
CHICAGO, IL 60634

TEL. 773-545-5296
FAX. 773-545-0298
CELL. 773-255-1032

Rev 7-18-14

FILE NAME -	USER NAME - gulliaumejp	DESIGNED -	REVISED -	STATE OF ILLINOIS DEPARTMENT OF TRANSPORTATION	IL 43 (HARLEM AVE.)		F.A.P. RITE	SECTION	COUNTY	TOTAL SHEETS	SHEET NO.	
cs:\pwork\pwork\gulliaumejp\08391037\0	26914-shs-plan.dgn	DRAWN -	REVISED -		INDEX OF SHEETS, STATE STANDARDS AND GENERAL NOTES			348	3134-T(14)	COOK	16	2
	PLOT SCALE = 100,0000 / 1 in.	CHECKED -	REVISED -		SCALE: 1"=50'	SHEET NO. 1 OF 1	SHEETS	STA.	TO STA.	CONTRACT NO. 60Y36		
	PLOT DATE = 6/11/2014	DATE -	REVISED -		FED. ROAD DIST. NO. ILLINOIS FED. AID PROJECT							

GENERAL NOTES

THE CONTRACTOR SHALL USE ALL NECESSARY PRECAUTIONARY AND PROTECTIVE MEASURES REQUIRED TO MAINTAIN AND PROTECT EXISTING TRAFFIC CONDUITS AND HANDHOLES AND APPURTENANCES THAT MUST BE KEPT IN OPERATION. IN PARTICULAR, THE CONTRACTOR SHALL TAKE ADEQUATE MEASURES TO PREVENT THE UNDERMINING OF CONDUITS AND HANDHOLES WHICH ARE STILL IN SERVICE. THE CONTRACTOR SHALL COORDINATE WITH THE ENGINEER AND UTILITIES COMPANY IF IT IS DETERMINED THAT TEMPORARY BRACING OR SUPPORT OF THE TRAFFIC SIGNAL EQUIPMENT IS REQUIRED. THE PROTECTION AND/OR TEMPORARY BRACING OR SUPPORT OF THE TRAFFIC SIGNAL EQUIPMENT WILL NOT BE PAID FOR SEPERATELY BUT SHALL BE CONSIDERED AS INCLUDED IN THE UNIT BID PRICES OF THE CONTRACT AND NO ADDITIONAL COMPENSATION WILL BE ALLOWED.

THE CONTRACTOR SHALL COORDINATE CONSTRUCTION ACTIVITIES WITH UTILITY COMPANIES, LOCAL GOVERNMENT AGENCIES AND IDOT.

THE CONTRACTOR IS RESPONSIBLE FOR RETURNING ALL AREAS AFFECTED BY EQUIPMENT OR LABORERS TO EXISTING CONDITIONS. THE CONTRACTOR IS ALSO RESPONSIBLE FOR PROTECTING ALL NEW WORK UNTIL COMPLETION OF THIS CONTRACT.

EXISTING UTILITIES: WHEN THE PLANS OR SPECIAL PROVISIONS INCLUDE INFORMATION PERTAINING TO THE LOCATION OF UNDERGROUND UTILITY FACILITIES, SUCH INFORMATION IS BASED ON RECORD INFORMATION PROVIDED BY THE INDIVIDUAL UTILITY OWNERS. IT SHALL BE THE CONTRACTOR'S RESPONSIBILITY TO DETERMINE THE ACTUAL LOCATION OF ALL SUCH FACILITIES. THE CONTRACTOR SHALL ALSO CONTACT J.U.L.I.E. TO OBTAIN LOCATES OF THE RESPECTIVE UTILITY COMPANIES' UNDERGROUND FACILITIES.

BEFORE STARTING ANY EXCAVATION, THE CONTRACTOR SHALL CALL "J.U.L.I.E." AT (800) 892-0123 OR 811 FOR FIELD LOCATIONS OF BURIED ELECTRIC, TELEPHONE AND GAS UTILITIES. 48 HOUR NOTIFICATION IS REQUIRED.

CONSTRUCTION NOTE:

- THE CONTRACTOR SHOULD COORDINATE WITH THE PRESIDENT ENGINEER ON CONTRACT 60T97 (BRYAN HOFSTETTER; 630-595-5350) TO SCHEDULE FOR THE INSTALLATION OF THE STORM SEWER.

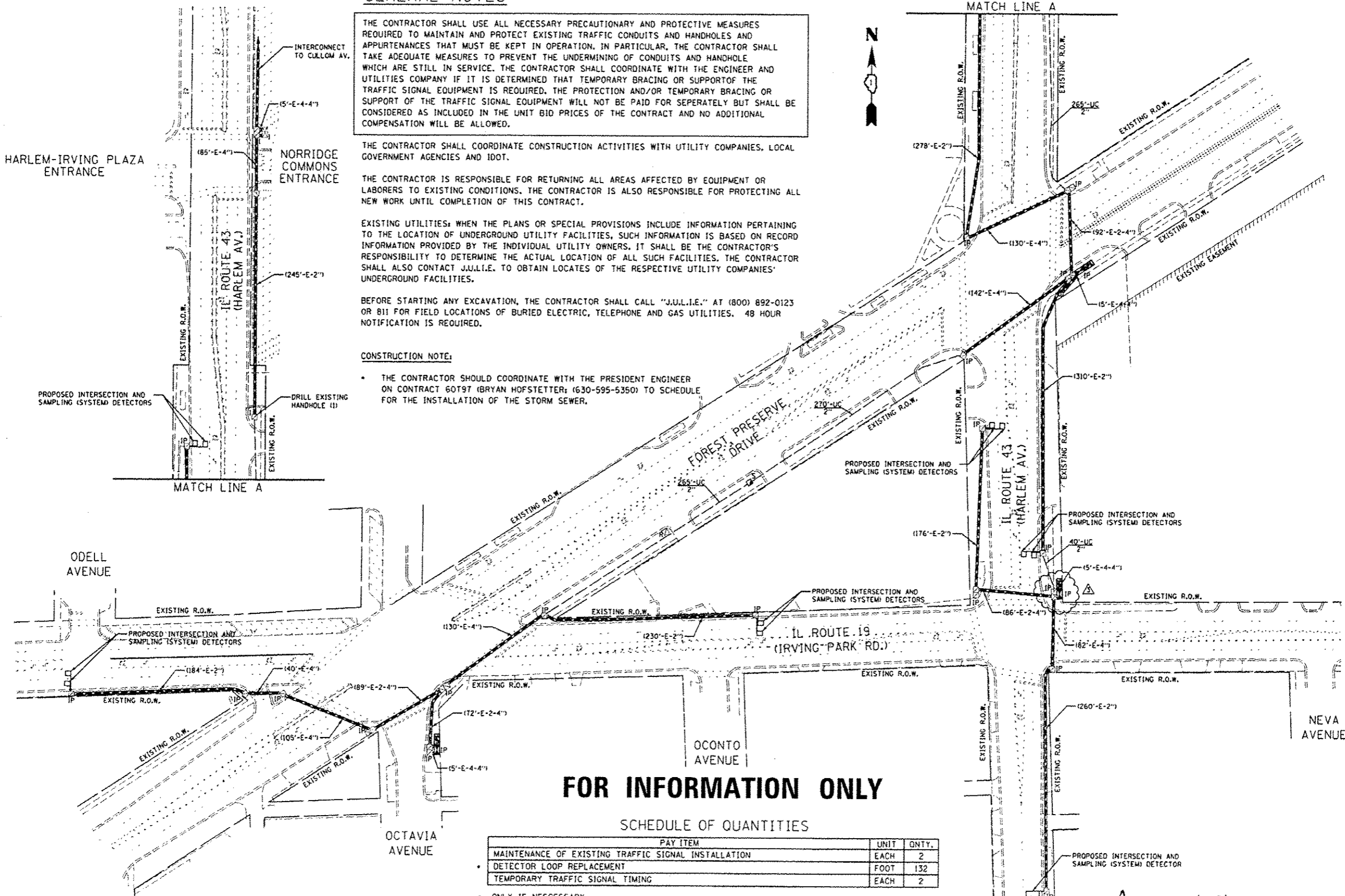

FOR INFORMATION ONLY

SCHEDULE OF QUANTITIES

PAY ITEM	UNIT	QNTY.
MAINTENANCE OF EXISTING TRAFFIC SIGNAL INSTALLATION	EACH	2
DETECTOR LOOP REPLACEMENT	FOOT	132
TEMPORARY TRAFFIC SIGNAL TIMING	EACH	2

• ONLY IF NECESSARY

Added Sheet 7-18-14

USER NAME: <i>mgp/mg</i> PLOT SCALE: 1"=100.0000' PLOT DATE: 7/14/2014	DESIGNED: _____ DRAWN: _____ CHECKED: _____ DATE: _____ #DDATE	REVISED: _____ REVISED: _____ REVISED: _____ REVISED: _____	STATE OF ILLINOIS DEPARTMENT OF TRANSPORTATION	INTERCONNECT PLAN IL ROUTE 19 (IRVING PARK RD.), IL ROUTE 43 (HARLEM AV.) AND FOREST PRESERVE DRIVE SCALE: 1" = 50' SHEET NO. 1 OF 1 SHEETS STA. TO STA.	SECTION: 3134-T(14) COUNTY: COOK TOTAL SHEETS: 17 SHEET NO.: 7A CONTRACT NO. 60Y36 ILLINOIS FED. AID PROJECT
--	---	--	---	--	---