

STATE OF ILLINOIS  
DEPARTMENT OF TRANSPORTATION  
DIVISION OF HIGHWAYS  
**PLANS FOR PROPOSED  
FEDERAL AID HIGHWAY**

F. A. I. D. NO.	SECTION	COUNTY	TOTAL SHEETS	SHEET NO.
2829	14-00085-00-RS	COOK	12	1
STA.		TO STA.		
FED. ROAD DIST. NO. 1		ILLINOIS	FED. AID PROJECT M-4003 (279)	

CONTRACT #61A60

**INDEX OF SHEETS**

1. COVER SHEET, INDEX OF SHEETS & STATE STANDARDS
2. SUMMARY OF QUANTITIES & GENERAL NOTES
3. TYPICAL SECTIONS
4. PAVEMENT PLAN
5. PAVEMENT MARKING PLAN
- 6.-12. IDOT DISTRICT 1 STANDARD DETAILS

**HIGHWAY STANDARDS**

- |           |   |
|-----------|---|
| 000001-06 | STANDARD SYMBOLS, ABBREVIATIONS AND PATTERNS                  |
| 424001-07 | PERPENDICULAR CURB RAMPS                                      |
| 442201-03 | CLASS C AND D PATCHES   |
| 606001-05 | CONCRETE CURB TYPE B AND COMBINATION CONCRETE CURB AND GUTTER |
| 701501-06 | URBAN LANE CLOSURE, 2L,2W, UNDIVIDED                          |
| 701801-05 | SIDEWALK, CORNER OR CROSSWALK CLOSURE                         |
| 701901-03 | TRAFFIC CONTROL DEVICES                                       |

**FAU 2829 (CHARLEMAGNE AVENUE)  
MUN 2055 (GRENOBLE DRIVE) TO FAU 1068 (FOUNTAINBLEAU DRIVE)  
ROADWAY RESURFACING  
PROJECT NO.: M-4003 (279)  
SECTION NO.: 14-00085-00-RS  
VILLAGE of HAZEL CREST  
COOK COUNTY  
JOB NO.: C-91-215-14**

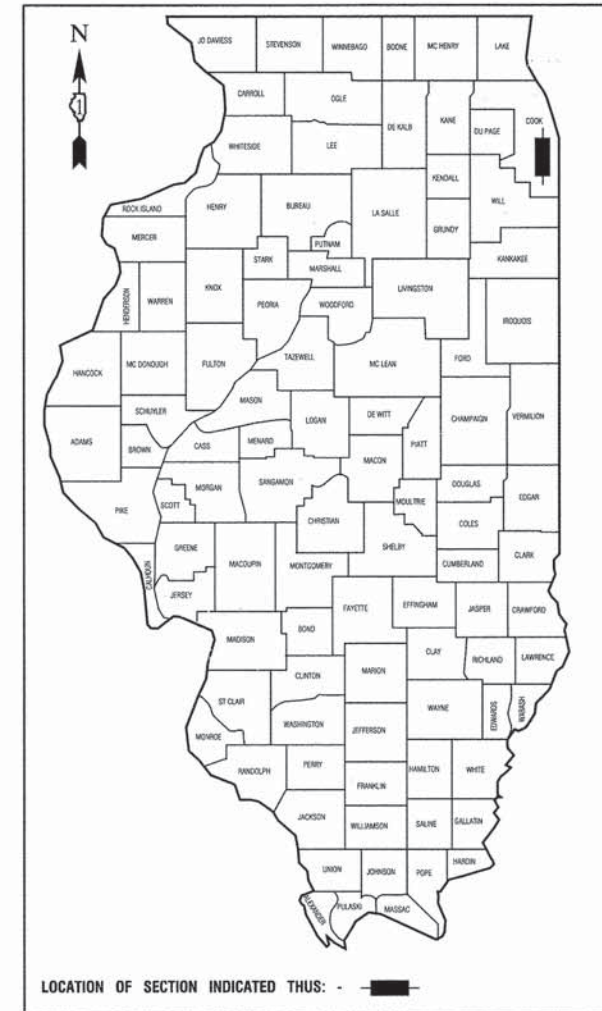

CHARLEMAGNE AVENUE	
2013 ADT -	2,000
2040 ADT -	2,000
POSTED SPEED LIMIT -	25 mph
DESIGN PERIOD -	20 YEARS
DESIGN SPEED LIMIT -	30 mph
STREET CLASSIFICATION -	COLLECTOR URBAN

**PROJECT LOCATED IN THE  
VILLAGE OF HAZEL CREST**

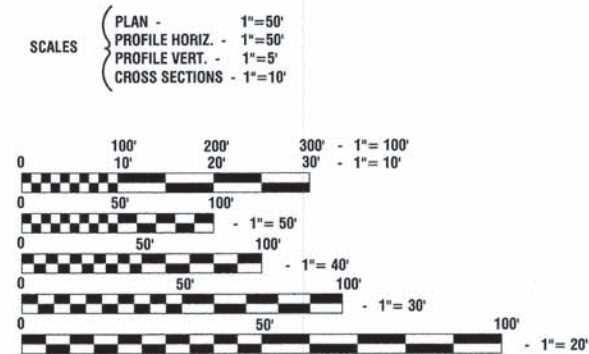

FULL SIZE PLANS HAVE BEEN PREPARED USING STANDARD ENGINEERING SCALES, REDUCED SIZED PLANS WILL NOT CONFORM TO STANDARD SCALES, IN MAKING MEASUREMENTS ON REDUCED PLANS, THE ABOVE SCALES MAY BE USED.

J. U. L. I. E.  
JOINT UTILITY LOCATION INFORMATION FOR EXCAVATION  
1-800-892-0123 or 811

**CONTRACT NO. 61A60**

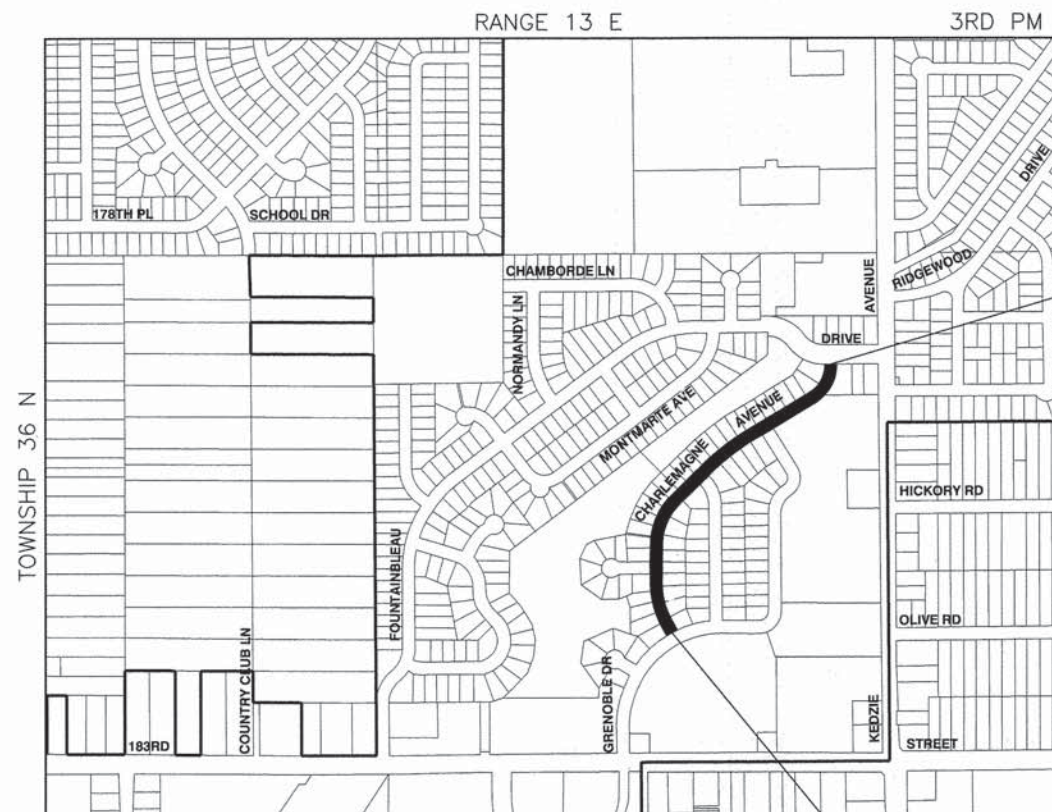

**LOCATION MAP**

GROSS LENGTH=1,854 FEET=0.35 MILES  
NET LENGTH=1,854 FEET=0.35 MILES

BEGIN IMPROVEMENTS  
CHARLEMAGNE AVENUE STA 5+13.93

END OF IMPROVEMENTS  
CHARLEMAGNE AVENUE STA 23+68.28

STATE OF ILLINOIS DEPARTMENT OF TRANSPORTATION  
DIVISION OF HIGHWAYS

Approved: 5-8-2014  
*Van J. [Signature]*  
President, Village of Hazel Crest

Passed: MAY 22, 2014  
*CH [Signature]* CHRISTOPHER HOLT  
District 1 Engineer of Local Roads & Streets

Released for Bid Based on Limited Review: May 22, 2014  
*John [Signature]*  
Deputy Director of Highways, Region 1 Engineer

**PRINTED BY THE AUTHORITY OF  
THE STATE OF ILLINOIS**

PREPARED BY OR UNDER THE  
DIRECT SUPERVISION OF:

5-8-2014



LICENSE EXPIRES: 11/30/15

FEDERAL AID PROGRAM ENGINEER: FAWAD AQUEEL, P.E. 847-705-4021, SCHAUMBURG, IL.  
CONSULTANTS: ROBINSON ENGINEERING, LTD. 708-331-6700



SUMMARY OF QUANTITIES				CONSTRUCTION TYPE CODE
S.I.	CODE NO.	PAY ITEM	UNIT	TOTAL QUANTITY
	20101700	SUPPLEMENTAL WATERING	UNIT	2
	21101615	TOPSOIL FURNISH AND PLACE, 4"	SQ YD	180
	30300001	AGGREGATE SUBGRADE IMPROVEMENT	CU YD	50
	40600400	MIXTURE FOR CRACKS, JOINTS, AND FLANGEWAYS	TON	10
	40600827	POLYMERIZED LEVELING BINDER (MACHINE METHOD), IL-4.75, N50	TON	313
	40600982	HOT-MIX ASPHALT SURFACE REMOVAL - BUTT JOINT	SQ YD	87
	40603335	HOT-MIX ASPHALT SURFACE COURSE, MIX "D", N50	TON	643
	42400200	PORTLAND CEMENT CONCRETE SIDEWALK 5 INCH	SQ FT	1619
	42400800	DETECTABLE WARNINGS	SQ FT	206
	44000159	HOT-MIX ASPHALT SURFACE REMOVAL, 2 1/2"	SQ YD	5573
	44000200	DRIVEWAY PAVEMENT REMOVAL	SQ YD	15
	44000600	SIDEWALK REMOVAL	SQ FT	1295
	44201725	CLASS D PATCHES, TYPE I, 7 INCH	SQ YD	73
	44201729	CLASS D PATCHES, TYPE II, 7 INCH	SQ YD	73
	44201733	CLASS D PATCHES, TYPE III, 7 INCH	SQ YD	73
	44201735	CLASS D PATCHES, TYPE IV, 7 INCH	SQ YD	73
	60250200	CATCH BASINS TO BE ADJUSTED	EACH	15
	60255500	MANHOLES TO BE ADJUSTED	EACH	2
	67100100	MOBILIZATION	L SUM	1
	70102620	TRAFFIC CONTROL AND PROTECTION, STANDARD 701501	L SUM	1
	70102640	TRAFFIC CONTROL AND PROTECTION, STANDARD 701801	L SUM	1
	70300100	SHORT TERM PAVEMENT MARKING	FOOT	979
	70301000	WORK ZONE PAVEMENT MARKING REMOVAL	SQ FT	327
	72000100	SIGN PANEL - TYPE 1	SQ FT	37

SUMMARY OF QUANTITIES				CONSTRUCTION TYPE CODE
S.I.	CODE NO.	PAY ITEM	UNIT	TOTAL QUANTITY
	72400310	REMOVE SIGN PANEL - TYPE 1	SQ FT	32
	72900200	METAL POST - TYPE B	FOOT	15
*	78000200	THERMOPLASTIC PAVEMENT MARKING - LINE 4"	FOOT	10
*	78000400	THERMOPLASTIC PAVEMENT MARKING - LINE 6"	FOOT	351
*	78000600	THERMOPLASTIC PAVEMENT MARKING - LINE 12"	FOOT	10
*	78000650	THERMOPLASTIC PAVEMENT MARKING - LINE 24"	FOOT	10
	X2520700	SODDING, SPECIAL	SQ YD	180
	X4060110	BITUMINOUS MATERIALS (PRIME COAT)	LBS	3780
	X6030310	FRAMES AND LIDS TO BE ADJUSTED (SPECIAL)	EACH	2
	Z0004514	HOT-MIX ASPHALT DRIVEWAY PAVEMENT, 4"	SQ YD	15
	Z0004562	COMBINATION CURB AND GUTTER REMOVAL AND REPLACEMENT	FOOT	454
	Z0013798	CONSTRUCTION LAYOUT	L SUM	1

\* - INDICATES SPECIALTY ITEMS

**GENERAL NOTES**

- BEFORE STARTING ANY EXCAVATION THE CONTRACTOR SHALL CALL "J.U.L.I.E." AT (800) 892-0123 OR 811 AND (312) 744-7000 FOR FIELD LOCATIONS OF BURIED ELECTRIC, TELEPHONE AND GAS UTILITIES. (48 HOUR NOTIFICATION REQUIRED)
- UTILITIES INDICATED ON THE PLANS ARE PROVIDED FOR THE CONTRACTOR'S USE AND ARE BASED UPON INFORMATION AVAILABLE AT THE TIME OF THE ADVERTISEMENT FOR BIDS. THE OWNER AND ENGINEER DO NOT GUARANTEE THE ACCURACY OF UTILITY INFORMATION.
- IT SHALL BE THE CONTRACTOR'S RESPONSIBILITY TO VERIFY ALL DIMENSIONS AND CONDITIONS EXISTING IN THE FIELD PRIOR TO CONSTRUCTION AND ORDERING OF MATERIALS.
- THE THICKNESS OF HMA MIXTURE STATED IN THE SPECIFICATIONS IS THE NOMINAL THICKNESS. DEVIATIONS FROM THE NOMINAL THICKNESS WILL BE PERMITTED WHEN SUCH DEVIATIONS OCCUR DUE TO IRREGULARITIES IN THE EXISTING SURFACE OR BASE ON WHICH THE HMA SURFACE IS PLACED.
- ACCESS TO DRIVEWAYS SHALL BE MAINTAINED AT ALL TIMES BY LIMITING CURB AND GUTTER REPAIR TO ONE-HALF THE DRIVEWAY WIDTH AT ONE TIME AS WELL AS TEMPORARY AGGREGATE. ANY TEMPORARY AGGREGATE REQUIRED SHALL BE CONSIDERED INCLUDED IN THE COST OF THE RELATED PAY ITEM IT IS NEEDED FOR WHEN DIRECTED BY THE ENGINEER.
- THE REMOVAL AND/OR REPLACEMENT OF ANY DRIVEWAYS, PAVEMENT, CURB, SIDEWALK, ETC. SHALL BE ACCOMPLISHED BY MEANS OF A SAW CUT JOINT, AT THE DIRECTION OF THE ENGINEER. SAW CUTTING WILL NOT BE PAID FOR SEPARATELY, BUT SHALL BE INCLUDED IN THE UNIT PRICE FOR THE VARIOUS REMOVAL ITEMS.
- ANY LOOSE MATERIAL DEPOSITED IN THE FLOW LINE OF DITCHES, GUTTERS OR OTHER DRAINAGE STRUCTURES SHALL BE REMOVED BY THE END OF EACH DAY BY THE CONTRACTOR AT THEIR EXPENSE.
- THE CONTRACTOR SHALL LEAVE ANY CLEAN EXCESS ORGANIC FILL EXCAVATED DURING THE CURB AND GUTTER AND SIDEWALK REMOVAL AND REPLACEMENT OPERATIONS ON SITE. ANY EXCESS MATERIAL SHALL BE SPREAD OR PLACED AT LOCATIONS DETERMINED BY THE ENGINEER. THIS WORK WILL NOT BE PAID FOR SEPARATELY, BUT SHALL BE INCLUDED IN THE UNIT PRICE FOR THE VARIOUS REMOVAL AND REPLACEMENT ITEMS. RESTORATION OF AREAS WHERE EXCESS MATERIALS IS PLACED SHALL BE PAID FOR AS SEEDING (COMPLETE).
- CLASS D PATCHING QUANTITIES FOR THIS CONTRACT SHALL BE PERFORMED AT THE DIRECTION OF THE ENGINEER AFTER PAVEMENT MILLING.

FILE NAME = 13667-QUAN-01 - IDOT P01

USER NAME =	DESIGNED - JPH	REVISED -
	CHECKED - PKB	REVISED -
PLOT SCALE =	DRAWN - LTL	REVISED -
PLOT DATE = 05-07-14	CHECKED - AG	REVISED -

STATE OF ILLINOIS  
DEPARTMENT OF TRANSPORTATION

ROADWAY RESURFACING FAU 2829 (CHARLEMAGNE AVENUE) SUMMARY OF QUANTITIES		F.A.U. RTE. 2829	SECTION 14-00085-00-RS	COUNTY COOK	TOTAL SHEETS 12	SHEET NO. 2
SCALE:	SHEET NO. 2	OF 12 SHEETS	STA.	TO STA.	CONTRACT NO. 61A60	
FED. ROAD DIST. NO. 1 ILLINOIS FED. AID PROJECT M-4003 (279)						



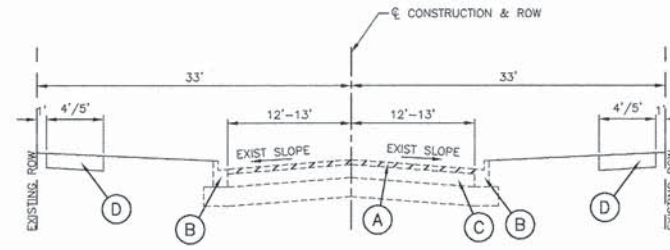

**EXISTING TYPICAL SECTION**

CHARLEMAGNE AVENUE  
 GRENOBLE DRIVE TO FOUNTAINBLEAU DRIVE  
 STA. 5+13.93 TO STA. 23+68.28

- EXISTING LEGEND**
- (A) HOT MIX ASPHALT SURFACE REMOVAL, 2 1/2"
  - (B) EXISTING CURB & GUTTER TO BE REMOVED AT LOCATIONS SHOWN ON PLANS OR DIRECTED BY ENGINEER
  - (C) EXISTING HOT-MIX ASPHALT PAVEMENT
  - (D) EXISTING PCC SIDEWALK TO BE REMOVED AT LOCATIONS SHOWN ON PLANS OR DIRECTED BY ENGINEER

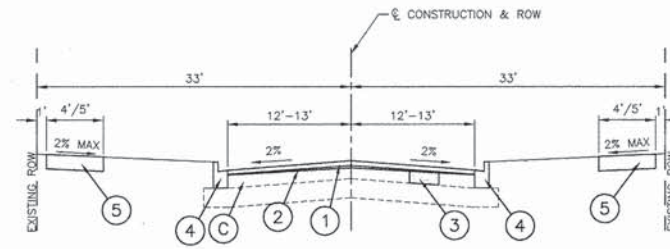

**PROPOSED TYPICAL SECTION**

CHARLEMAGNE AVENUE  
 GRENOBLE DRIVE TO FOUNTAINBLEAU DRIVE  
 STA. 5+13.93 TO STA. 23+68.28  
 NOTE: CONTRACTOR SHALL MILL BEFORE PATCHING

- PROPOSED LEGEND**
- (1) HOT MIX ASPHALT SURFACE COURSE, MIX "D", N50, 2"
  - (2) POLYMERIZED LEVELING BINDER (MACHINE METHOD), IL-4.75, N50, 3/4"
  - (3) CLASS D PATCH, 7" AT LOCATIONS SHOWN ON PLANS OR DIRECTED BY ENGINEER
  - (4) PROPOSED CURB AND GUTTER TO BE INSTALLED AT LOCATIONS SHOWN ON PLAN OR DIRECTED BY ENGINEER (IN KIND)
  - (5) PROPOSED PORTLAND CEMENT CONCRETE SIDEWALK 5" (REPLACEMENT AT LOCATIONS DIRECTED BY THE ENGINEER)

**HOT-MIX ASPHALT MIXTURE REQUIREMENTS**

(CONTRACTOR SHALL MILL BEFORE PATCHING)

MIXTURE TYPE	AIR VOIDS @ Ndes
<b>RESURFACING</b>	
HOT-MIX ASPHALT SURFACE COURSE, MIX "D", N50, 2" (IL 9.5 MM)	4% @ 50 Gyr.
POLYMERIZED LEVELING BINDER (MACHINE METHOD), IL-4.75, N50, 3/4"	3.5% @ 50 Gyr.
<b>PATCHING</b>	
CLASS D PATCHES, TYPE I, II, III, IV, (HMA BINDER IL-19.0mm): 7" (IN 2 LIFTS)	4% @ 70 Gyr.
<b>DRIVEWAYS</b>	
HOT-MIX ASPHALT SURFACE COURSE, MIX "D", N50, 1-3/4" (IL 9.5 MM)	4% @ 50 Gyr.
HOT-MIX ASPHALT BINDER COURSE, IL-19.0, N50, 2-1/4"	4% @ 50 Gyr.
<b>CURB PATCH</b>	
HOT-MIX ASPHALT PATCH (HMA BINDER IL-19.0mm): 7" (IN 2 LIFTS)	4% @ 70 Gyr.

**NOTES:**

1. THE UNIT WEIGHT USED TO CALCULATE ALL HMA SURFACE MIXTURE QUANTITIES IS 112 LBS/SQ YD/IN.
2. THE "AC TYPE" FOR POLYMERIZED HMA MIXES SHALL BE "SBS/SBR PG 76-22" AND FOR NON-POLYMERIZED HMA THE "AC TYPE" SHALL BE "PG 64-22" UNLESS MODIFIED BY DISTRICT ONE SPECIAL PROVISIONS. FOR USE OF RECYCLED MATERIALS SEE SPECIAL PROVISIONS.

**NOTE:**  
 CLASS D PATCHES, TYPE I, II, III & IV AT APPROXIMATE STATIONS AS SHOWN ON THE PLANS OR AS DIRECTED BY THE ENGINEER.

FILE NAME = 13667-TYPX-01 - TYPX-01

USER NAME =	DESIGNED -- JPH	REVISED --
	CHECKED -- PKB	REVISED --
PLOT SCALE =	DRAWN -- LTL	REVISED --
PLOT DATE = 05-07-14	CHECKED -- AG	REVISED --

STATE OF ILLINOIS  
 DEPARTMENT OF TRANSPORTATION



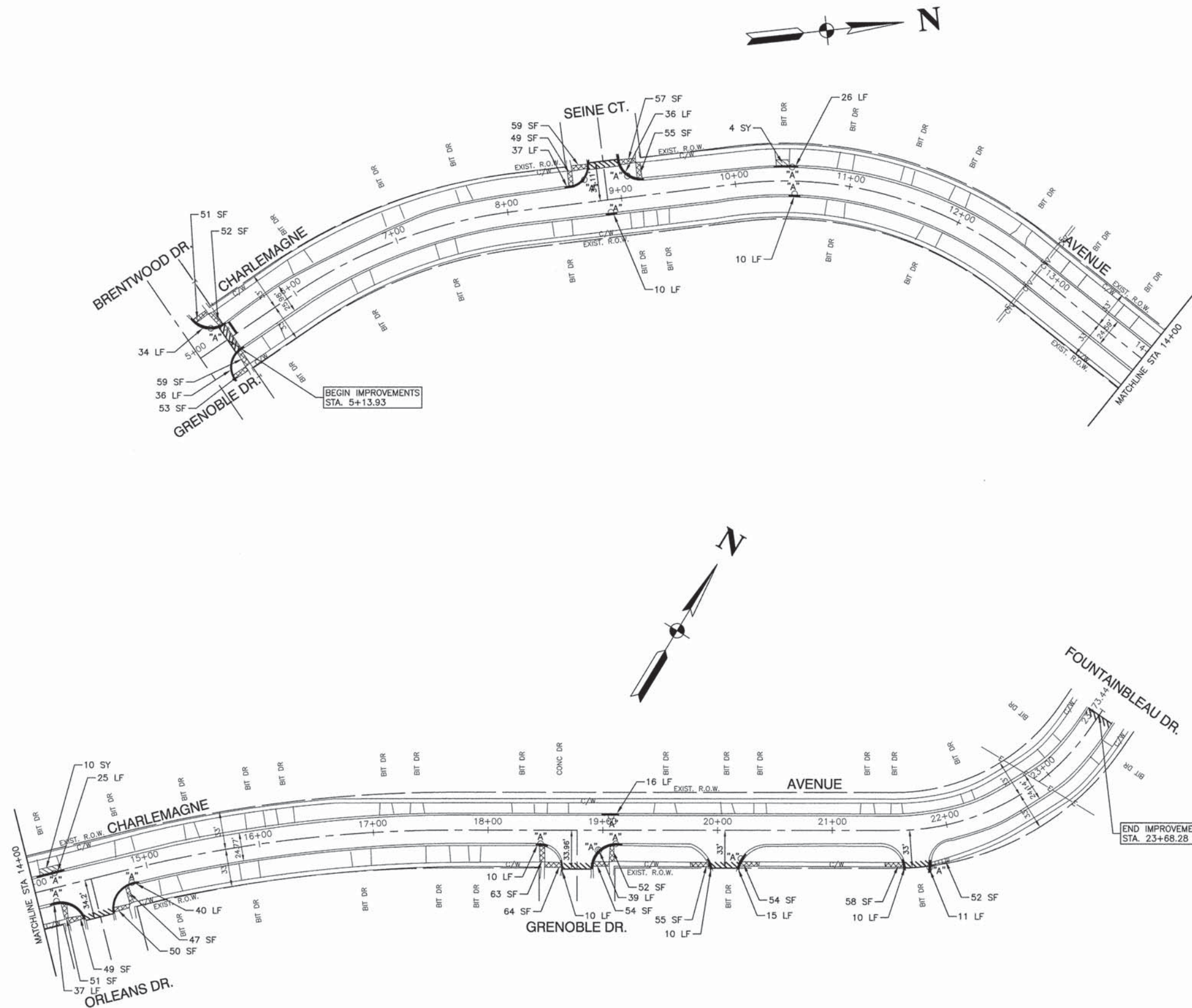

ROADWAY RESURFACING  
 FAU 2829 (CHARLEMAGNE AVENUE)  
 TYPICAL CROSS SECTIONS

SCALE: SHEET NO. 3 OF 12 SHEETS STA. TO STA.

FAU RTE.	SECTION	COUNTY	TOTAL SHEETS	SHEET NO.
2829	14-00085-00-RS	COOK	12	3
CONTRACT NO. 61A60				
FED. ROAD DIST. NO. 1 ILLINOIS FED. AID PROJECT M-4003 (279)				



**LEGEND**

-  HMA DRIVEWAY REMOVAL AND REPLACEMENT
-  CONCRETE SIDEWALK REMOVAL AND REPLACEMENT
-  BUTT JOINTS
-  COMBINATION CURB AND GUTTER REMOVAL AND REPLACEMENT
- "A" STRUCTURE TO BE ADJUSTED

**NOTES:**  
 DETECTABLE WARNING PLATES SHALL BE INSTALLED PER STANDARD 424001-07 AT ALL LOCATIONS OF CONCRETE SIDEWALK REMOVAL AND REPLACEMENT SHOWN ON THE PLANS. DETECTABLE WARNING PLATES SHALL HAVE A HEIGHT OF 2 FEET.  
 CLASS D PATCHES SHALL BE COMPLETED AT THE DIRECTION OF THE ENGINEER.

FILE NAME = 13667-PLAN-01 - IDOT P01	USER NAME =	DESIGNED -- JPH	REVISED --	STATE OF ILLINOIS DEPARTMENT OF TRANSPORTATION	FAU 2829 (CHARLEMAGNE AVENUE) ROADWAY RESURFACING PROPOSED PLAN	F.A.U. RTE.	SECTION	COUNTY	TOTAL SHEETS	SHEET NO.	
		CHECKED -- PKB	REVISED --			2829	14-00085-00-RS	COOK	12	4	
	PLOT SCALE =	DRAWN -- LTL	REVISED --			CONTRACT NO. 61A60					
	PLOT DATE = 05-07-14	CHECKED -- AG	REVISED --			FED. ROAD DIST. NO. 1 ILLINOIS FED. AID PROJECT M-4003 (279)					



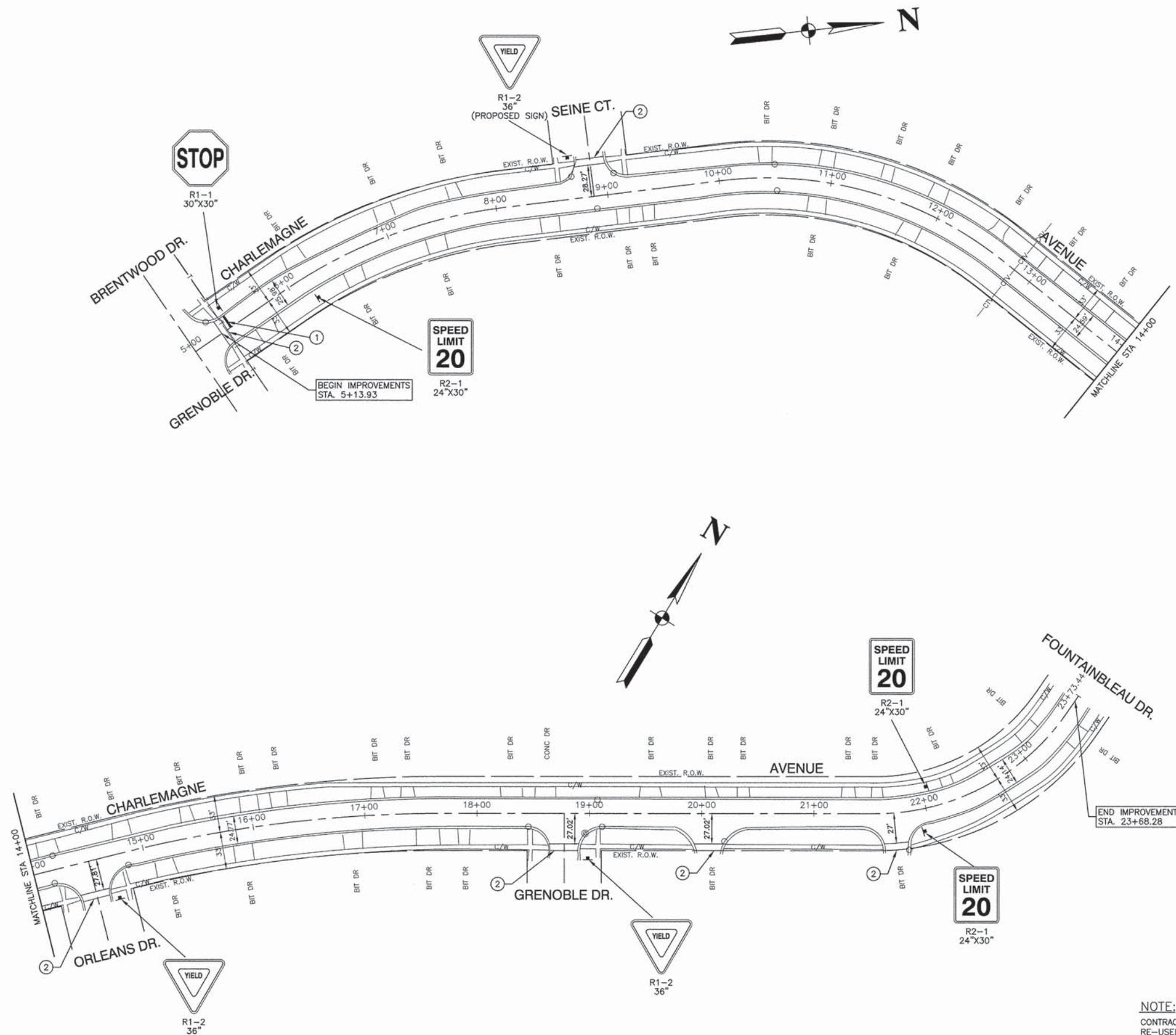

**PAVEMENT MARKING LEGEND**

- ① 24" WHITE STOP BAR
- ② 6" WHITE CROSSWALK (6' C/C)

**NOTE:**

CONTRACTOR SHALL REMOVE AND REPLACE ALL SIGNAGE SHOWN. EXISTING MOUNTING HARDWARE RE-USED. ANY REPLACEMENT MOUNTING HARDWARE SHALL BE CONSIDERED INCIDENTAL TO THE PROPOSED SIGN PANELS.

FILE NAME = 13667-PLAN-01 - IDOT P02

USER NAME =	DESIGNED -- JPH	REVISED --
	CHECKED -- PKB	REVISED --
PLOT SCALE =	DRAWN -- LTL	REVISED --
PLOT DATE = 05-07-14	CHECKED -- AG	REVISED --

**STATE OF ILLINOIS  
DEPARTMENT OF TRANSPORTATION**

**FAU 2829 (CHARLEMAGNE AVENUE)  
ROADWAY RESURFACING  
PAVEMENT MARKING**

SCALE: 1"=50' SHEET NO. 5 OF 12 SHEETS STA. TO STA.

F.A.U. RTE.	SECTION	COUNTY	TOTAL SHEETS	SHEET NO.
2829	14-00085-00-RS	COOK	12	5
CONTRACT NO. 61A60				
FED. ROAD DIST. NO. 1 ILLINOIS FED. AID PROJECT M-4003 (279)				

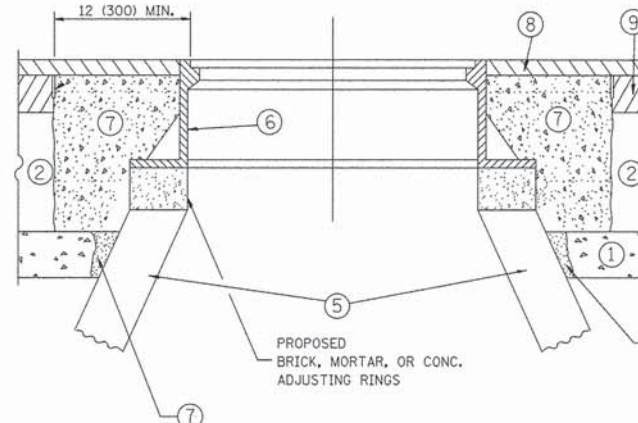
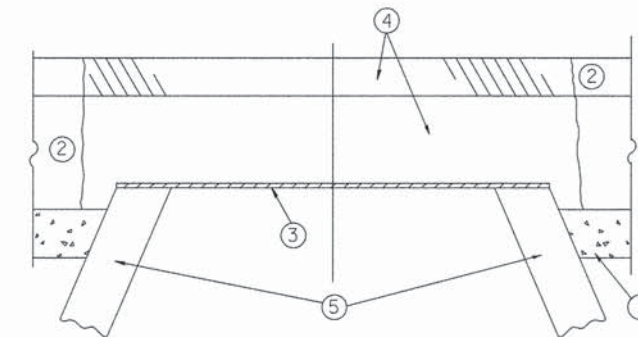

**NOTES:**

EXISTING BROKEN FRAMES AND LIDS SHALL BE REMOVED AND DISPOSED OF BY THE CONTRACTOR AND SHALL BE REPLACED AS DIRECTED BY THE ENGINEER. REPLACEMENT FRAMES AND LIDS WILL BE PAID FOR IN ACCORDANCE WITH ARTICLE 109.04 OF THE STANDARD SPECIFICATIONS UNLESS A SEPARATE PAY ITEM HAS BEEN PROVIDED.

IF THE EXISTING LIDS ARE OPEN, THE FRAME WILL BE ADJUSTED TO THE ELEVATION OF THE MILLED PAVEMENT SURFACE PRIOR TO THE MILLING OPERATION. THE FRAME WILL NOT BE REMOVED AND COVERED BY THE METAL PLATE.

CITY OF CHICAGO CASTINGS ARE THE PROPERTY OF THE CITY AND THE CONTRACTOR SHALL NOTIFY THE CITY FOR REMOVAL AND DISPOSITION OF THE CASTINGS.

THE METAL PLATE USED TO COVER THE STRUCTURE SHALL REMAIN THE PROPERTY OF THE CONTRACTOR.

WHEN STRUCTURES ARE TO BE ADJUSTED OR RECONSTRUCTED, THE LOWERING AND RAISING OF THE FRAMES AND LIDS WILL NOT BE PAID FOR SEPARATELY BUT WILL BE INCLUDED IN THE COST OF THE CORRESPONDING PAY ITEM.

**CONSTRUCTION PROCEDURES**

- STAGE 1 (BEFORE PAVEMENT MILLING)**
- A) REMOVE A MINIMUM OF 12 (300) OF THE PAVEMENT FROM AROUND THE STRUCTURE.
  - B) REMOVE THE EXISTING FRAME AND LID FROM THE STRUCTURE.
  - C) COVER THE STRUCTURE OPENING WITH A 36 (900) DIAMETER METAL PLATE.
  - D) BACKFILL WITH CRUSHED STONE AND A MINIMUM 1/2 (40) THICK HMA SURFACE MIX APPROVED BY THE ENGINEER.

- STAGE 2 (AFTER PAVEMENT MILLING)**
- A) REMOVE THE HMA SURFACE MIX AND CRUSHED STONE.
  - B) INSTALL THE FRAME AND LID; ADJUST THE FRAME TO ITS FINAL SURFACE ELEVATION.
  - C) THE SURROUNDING SPACE SHALL BE FILLED WITH CLASS PP-1\* CONCRETE TO THE ELEVATION OF THE SURFACE OF THE EXISTING BASE COURSE OR THE BINDER COURSE.
- \* UNLESS OTHERWISE SPECIFIED IN THE PLANS.

THE PROCEDURE EXPLAINED ABOVE SHALL CONFORM TO THE APPLICABLE PORTIONS OF SECTIONS 353, 406, 602, AND 603 OF THE STANDARD SPECIFICATIONS EXCEPT THAT THE CONTRACTOR SHALL ADJUST THE STRUCTURES TO THE FINISHED PAVEMENT ELEVATION NO MORE THAN 5 CALENDAR DAYS PRIOR TO PLACEMENT OF THE FINAL LIFT OF SURFACE UNLESS APPROVED BY THE ENGINEER.

**LEGEND**

- ① SUB-BASE GRANULAR MATERIAL
- ② EXISTING PAVEMENT
- ③ 36 (900) DIAMETER METAL PLATE
- ④ PROPOSED CRUSHED STONE AND HMA SURFACE MIX
- ⑤ EXISTING STRUCTURE
- ⑥ FRAME AND LID (SEE NOTES)
- ⑦ CLASS PP-1\* CONCRETE
- ⑧ PROPOSED HMA SURFACE COURSE
- ⑨ PROPOSED HMA BINDER COURSE

**LOCATION OF STRUCTURES:**

THE CONTRACTOR WILL BE REQUIRED TO KEEP A RECORD OF THE LOCATIONS OF THE BURIED STRUCTURES ACCORDING TO THE STATION AND DISTANCE LEFT OR RIGHT OF THE CENTERLINE OF PAVEMENT. UPON COMPLETION OF THE WORK, THE CONTRACTOR WILL DELIVER THE RECORD TO THE ENGINEER.

**BASIS OF PAYMENT:**

REMOVING FRAMES AND LIDS ON DRAINAGE AND UTILITY STRUCTURES IN THE PAVEMENT PRIOR TO MILLING, AND ADJUSTING TO FINAL GRADE PRIOR TO PLACING THE SURFACE COURSE, WILL BE PAID FOR AT THE CONTRACT UNIT PRICE EACH FOR "FRAMES AND LIDS TO BE ADJUSTED (SPECIAL)."

THIS WORK WILL NOT BE PAID FOR WHEN DRAINAGE AND UTILITY STRUCTURES ARE SPECIFIED FOR PAYMENT AS STRUCTURE RECONSTRUCTION.

NEW FRAMES AND LIDS, WHEN SPECIFIED, WILL BE PAID FOR SEPARATELY.

**DETAILS FOR FRAMES AND LIDS ADJUSTMENT WITH MILLING**

ALL DIMENSIONS ARE IN INCHES (MILLIMETERS) UNLESS OTHERWISE SHOWN

REVISIONS		ILLINOIS DEPARTMENT OF TRANSPORTATION			
NAME	DATE	DETAILS FOR FRAMES AND LIDS ADJUSTMENT WITH MILLING			
R. SHAH	10/25/94	SCALE: VERT. NONE HORIZ. _____ DRAWN BY _____ CHECKED BY _____			
R. SHAH	01/30/95				
R. SHAH	03/10/95				
A. ABBAS	03/21/97				
R. WIEDEMAN	05/14/04				
R. BORO	01/01/07				
R. BORO	03/09/11				
R. BORO	12/06/11				



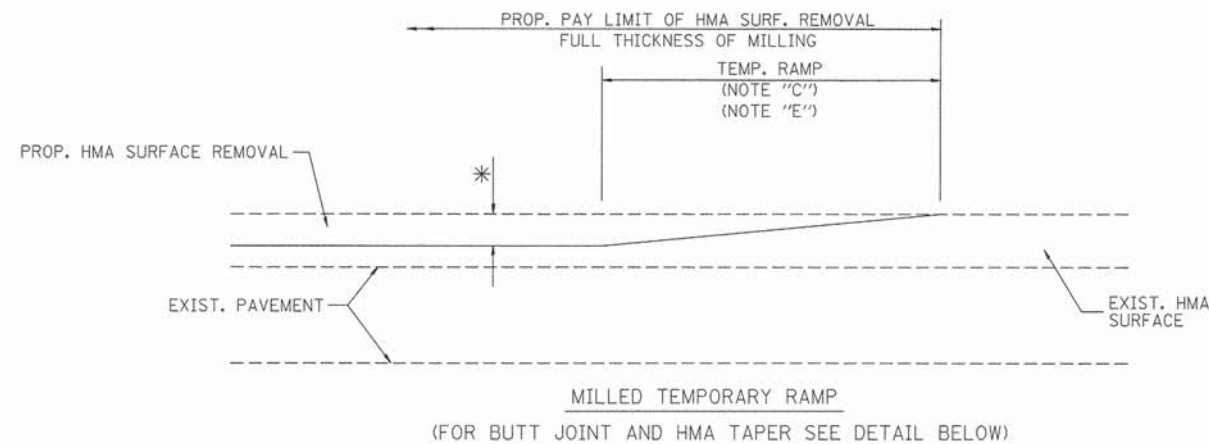

OPTION 1

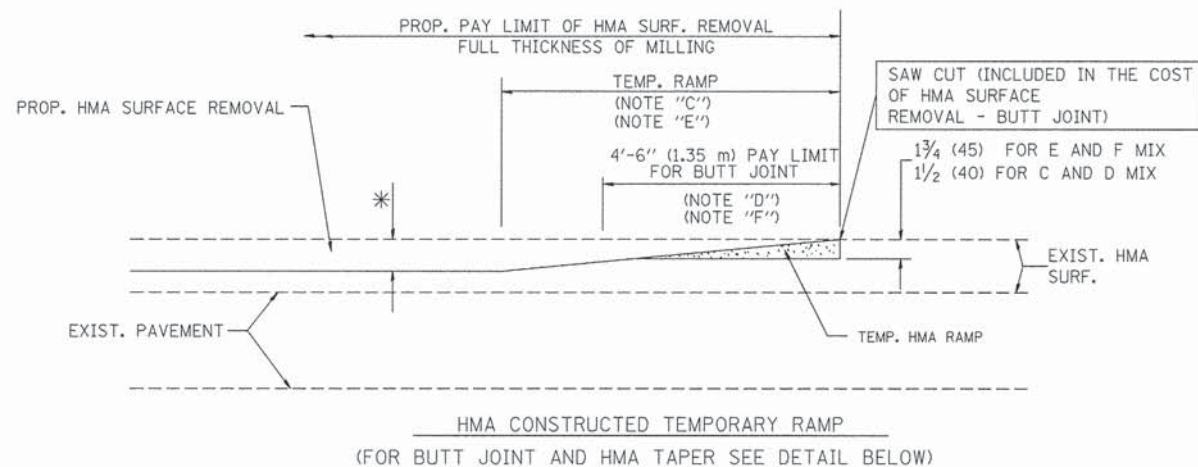

OPTION 2  
TYPICAL TEMPORARY RAMP

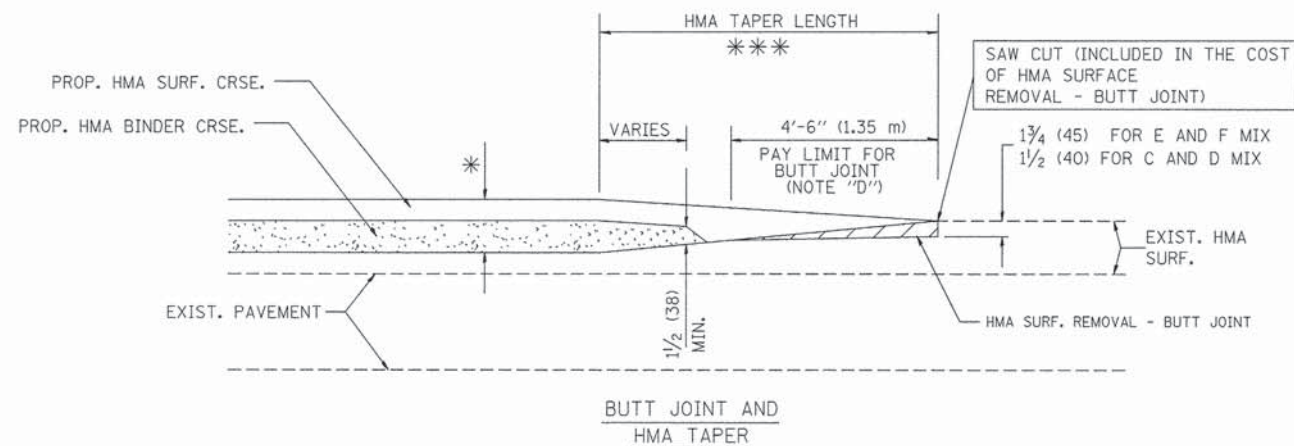

TYPICAL BUTT JOINT AND HMA TAPER  
FOR MILLING AND RESURFACING

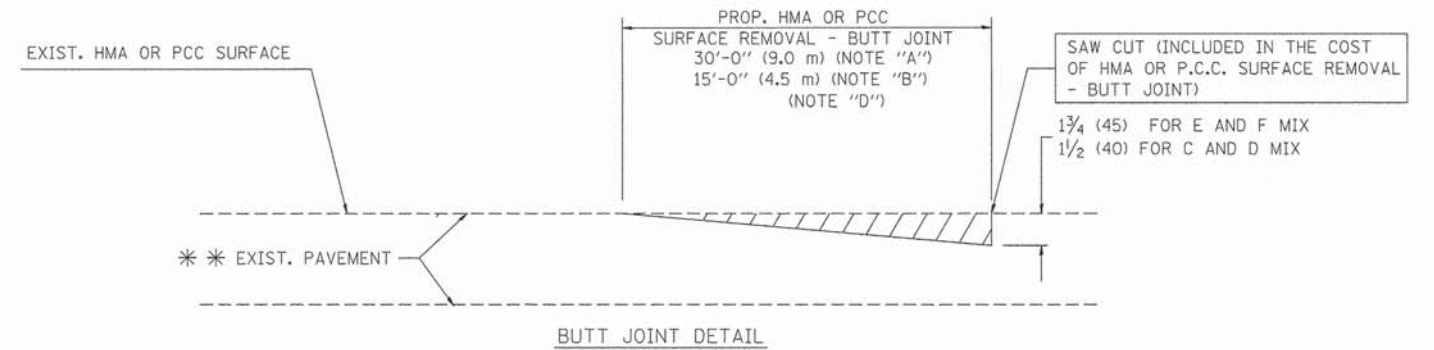

BUTT JOINT DETAIL

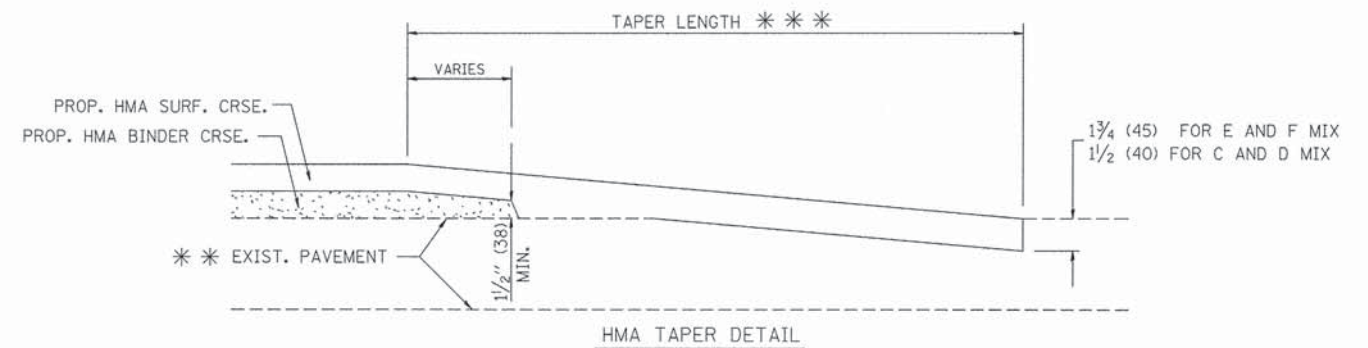

HMA TAPER DETAIL

TYPICAL BUTT JOINT AND HMA TAPER  
FOR RESURFACING ONLY

\*\*\* PC CONCRETE, HMA OR HMA RESURFACED PAVEMENT.

NOTES

- A: MAINLINE ROADWAYS AND MAJOR SIDE ROADS.
  - B: MINOR SIDE ROADS.
  - C: THE TEMP. RAMP SHALL BE CONSTRUCTED IMMEDIATELY UPON REMOVAL OF THE EXISTING HMA SURFACE.
  - D: THE BUTT JOINT SHALL BE CONSTRUCTED IMMEDIATELY PRIOR TO PLACING THE PROPOSED HMA COURSES.
  - E: TAPER THE TEMP. RAMP AT A RATE OF 3'-0" (900 mm) PER 1 INCH (25 mm) OF MILLING THICKNESS.
  - F: INSTALLATION AND REMOVAL OF THE 4'-6" (1.35 m) TEMP. RAMP IS INCLUDED IN COST OF HMA SURFACE REMOVAL - BUTT JOINT
  - G: SEE ARTICLE 406.08 AND 406.14 OF THE STANDARD SPECIFICATIONS FOR "HMA AND/OR PCC SURFACE REMOVAL, BUTT JOINT".
- \* SEE TYPICAL SECTIONS FOR MILLING THICKNESS.
- \*\*\* 20'-0" (6.1 m) PER 1 (25) RESURFACING (NOTE "A")  
10'-0" (3.0 m) PER 1 (25) RESURFACING (NOTE "B")

BASIS OF PAYMENT:

THE BUTT JOINT WILL BE PAID FOR AT THE CONTRACT UNIT PRICE PER SQUARE YARD (SQUARE METER) FOR "HOT-MIX ASPHALT SURFACE REMOVAL - BUTT JOINT" OR FOR "PORTLAND CEMENT CONCRETE SURFACE REMOVAL - BUTT JOINT".

ALL DIMENSIONS ARE IN INCHES (MILLIMETERS) UNLESS OTHERWISE SHOWN.

FILE NAME = W:\diststd\22x34\bd32.dgn

USER NAME = goglianobt	DESIGNED - M. DE YONG	REVISED - R. SHAH 10-25-94
PLOT SCALE = 50.0000' / IN.	CHECKED -	REVISED - A. ABBAS 03-21-97
PLOT DATE = 1/4/2008	DATE - 06-13-90	REVISED - M. GOMEZ 04-06-01
		REVISED - R. BORO 01-01-07

STATE OF ILLINOIS  
DEPARTMENT OF TRANSPORTATION

DISTRICT ONE  
BUTT JOINT AND HMA TAPER  
DETAILS

SCALE: NONE SHEET NO. 7 OF 12 SHEETS STA. TO STA.

F.A.U. RTE.	SECTION	COUNTY	TOTAL SHEETS	SHEET NO.
2829	14-00085-00-RS	COOK	12	7
BD400-05 BD32		CONTRACT NO. 61A60		
FED. ROAD DIST. NO. 1 ILLINOIS FED. AID PROJECT M-4003 (279)				



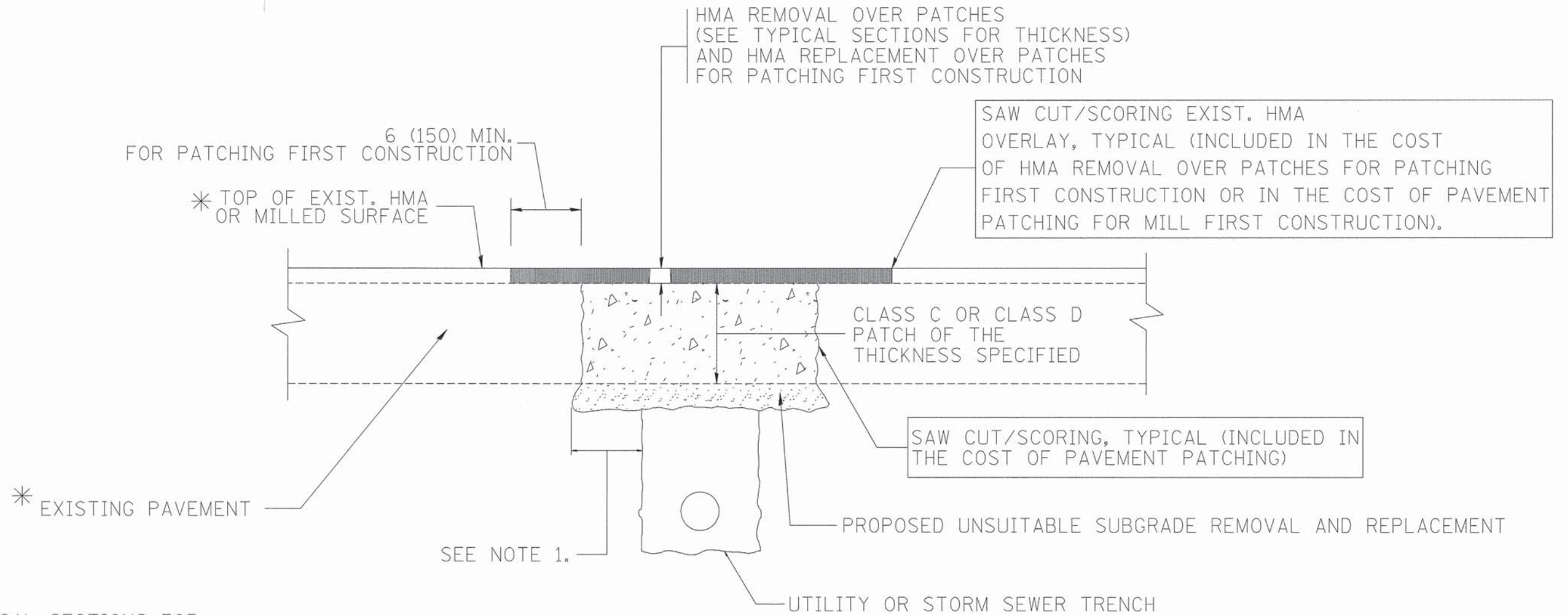

\* SEE TYPICAL SECTIONS FOR THICKNESS AND MATERIALS

NOTES:

1. THE WIDTH OF THE FULL DEPTH PATCH OVER A TRENCH SHALL BE 12 (300) WIDER ON EACH SIDE OF THE TRENCH.
2. FOR METHOD OF MEASUREMENT AND BASIS OF PAYMENT, SEE RECURRING SPECIAL PROVISION "PATCHING WITH HOT-MIX ASPHALT OVERLAY REMOVAL".

SEQUENCE OF CONSTRUCTION (PATCHING FIRST)

1. REMOVE THE EXISTING HMA MATERIAL OVER THE AREA TO BE PATCHED.
2. REMOVE AND REPLACE WITH CLASS C OR D PATCH.
3. REPLACE HMA MATERIAL OVER THE AREA TO BE PATCHED.

SEQUENCE OF CONSTRUCTION (MILLING FIRST)

1. MILL HMA FIRST IF THERE IS AT LEAST 4 1/2 INCHES OR MORE OF HMA MATERIAL ON TOP OF THE EXISTING PAVEMENT OR IF THE PAVEMENT IS FULL DEPTH HMA. A MINIMUM OF 2 INCHES OF HMA MATERIAL SHALL BE IN PLACE AFTER MILLING.
2. REMOVE AND REPLACE WITH FULL DEPTH CLASS D PATCHES TO TOP OF MILLED SURFACE.

ALL DIMENSIONS ARE IN INCHES (MILLIMETERS) UNLESS OTHERWISE SHOWN.

FILE NAME = c:\projects\distatd22x34\bd22.dgn	USER NAME = bauerdl	DESIGNED - R. SHAH	REVISED - A. ABBAS 04-27-98	<b>STATE OF ILLINOIS DEPARTMENT OF TRANSPORTATION</b>	<b>DISTRICT ONE PAVEMENT PATCHING FOR HMA SURFACED PAVEMENT</b>			F.A.U. RTE. 2829	SECTION 14-00085-00-RS	COUNTY COOK	TOTAL SHEETS 12	SHEET NO. 8
	PLOT SCALE = 50.000 ' / IN.	CHECKED -	REVISED - R. BORO 01-01-07		SCALE: NONE	SHEET NO. 8	OF 12 SHEETS	STA.	TO STA.	<b>BD400-04 (BD-22)</b>		
	PLOT DATE = 10/27/2008	DATE - 10-25-94	REVISED - R. BORO 09-04-07					CONTRACT NO. 61A60				
			REVISED - K. ENG 10-27-08					FED. ROAD DIST. NO. 1 ILLINOIS FED. AID PROJECT M-4003 (279)				



VARIABLE - TO MEET EXISTING DIMENSIONS AND FIELD CONDITIONS (SEE NOTE ②)

PROP. CONC. CURB OR CURB AND GUTTER REPLACEMENT IN ACCORDANCE WITH STATE STANDARD 606001. (SEE NOTE ②)

SAW CUT FULL DEPTH - INCLUDED IN THE COST OF SIDEWALK, DRIVEWAY OR MEDIAN SURFACE REMOVAL PAY ITEM.

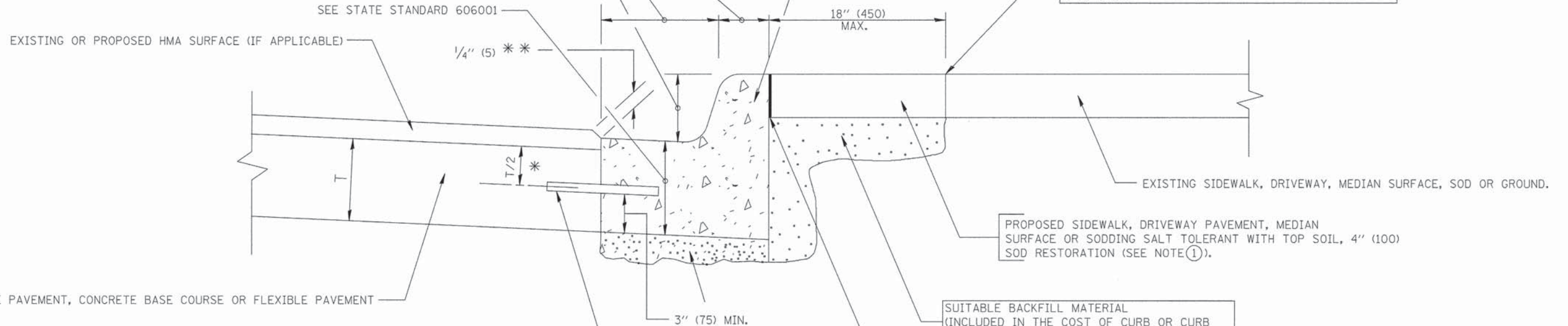

\* 3" (75) MINIMUM FROM TOP AND BOTTOM OF THE CONCRETE PAVEMENT OR BASE COURSE.

\*\* IF THE FINAL SURFACE OF THE PAVEMENT IS CONCRETE, THE GUTTER IS TO BE FLUSH WITH THE PAVEMENT.

NOTE: ① SIDEWALK, DRIVEWAY PAVEMENT OR MEDIAN SURFACE SHALL BE SIMILAR TO THE MATERIAL BEING REMOVED AND WILL BE PAID FOR SEPARATELY.

SODDING, SPECIAL AND TOP SOIL, FURNISH AND PLACE 4" WILL BE PAID FOR SEPARATELY,

② FERTILIZER FOR THE PLACEMENT OF THE SOD IS NOT REQUIRED

③ CURB OR CURB AND GUTTER REPLACEMENT SHALL MATCH THE SHAPE OF THE EXISTING CURB OR CURB AND GUTTER UNLESS OTHERWISE SPECIFIED.

④ FOR CURB OR CURB AND GUTTER REMOVAL AND REPLACEMENT ADJACENT TO FLEXIBLE PAVEMENT DELETE EPOXY COATED TIE BARS.

⑤ LONGITUDINAL BARS, IF ENCOUNTERED IN THE EXISTING CURB OR CURB AND GUTTER, ARE NOT TO BE REPLACED. CUTTING AND REMOVING LONGITUDINAL BARS SHALL BE INCLUDED IN THE COST OF CURB OR CURB AND GUTTER REMOVAL AND REPLACEMENT.

⑥ THE COST OF HMA SURFACE REMOVAL IN THE EXISTING GUTTER FLAG SHALL BE INCLUDED IN THE COST OF THE CURB AND GUTTER REMOVAL AND REPLACEMENT.

⑦ THE REMOVAL AND REPLACEMENT OF THE EXISTING CURB OR CURB AND GUTTER SHALL BE DONE IN ACCORDANCE WITH THE APPLICABLE PORTIONS OF SECTION 440 AND 606 OF THE STANDARD SPECIFICATIONS.

⑧ THE LOCATIONS OF REMOVAL AND REPLACEMENT OF EXISTING CURB OR CURB AND GUTTER SHALL BE DETERMINED BY THE RESIDENT ENGINEER AT THE TIME OF CONSTRUCTION.

SUITABLE BACKFILL MATERIAL (INCLUDED IN THE COST OF CURB OR CURB AND GUTTER REMOVAL AND REPLACEMENT)

PROPOSED 3/4" (20) PREFORMED EXPANSION JOINT AT CONCRETE SIDEWALKS, DRIVEWAYS, AND MEDIANS. (INCLUDED IN THE COST OF CURB OR CURB AND GUTTER REMOVAL AND REPLACEMENT.)

UNSUITABLE SUB-BASE MATERIAL TO BE REMOVED, IF DIRECTED BY THE ENGINEER, SHALL BE REPLACED WITH EITHER SUB-BASE GRANULAR MATERIAL, TYPE B OR ADDITIONAL THICKNESS OF CONCRETE.

REMOVAL AND REPLACEMENT 4" (100) OR LESS IS INCLUDED IN THE COST OF CURB OR CURB AND GUTTER REMOVAL AND REPLACEMENT.

REMOVAL AND REPLACEMENT IN EXCESS OF 4" (100) WILL BE PAID FOR IN ACCORDANCE WITH ARTICLE 109.04 OF THE STANDARD SPECIFICATIONS.

PROPOSED #6 (20) EPOXY COATED TIE BARS 24" (600) LONG AT 24" (600) CENTERS WILL NOT BE PAID FOR SEPARATELY. DELETE EPOXY COATED TIE BARS IF EXISTING TIE BARS ARE USUABLE AS DETERMINED BY THE ENGINEER. (SEE NOTE ③).

**BASIS OF PAYMENT:**

THIS WORK WILL BE PAID FOR AT THE CONTRACT UNIT PRICE PER FOOT (METER) FOR "CURB REMOVAL AND REPLACEMENT" OR "COMBINATION CONCRETE CURB AND GUTTER REMOVAL AND REPLACEMENT".

# CURB OR CURB AND GUTTER REMOVAL AND REPLACEMENT

ALL DIMENSIONS ARE IN INCHES (MILLIMETERS) UNLESS OTHERWISE SHOWN.

FILE NAME =	USER NAME = drsvakosgn	DESIGNED - A. HOUSEH	REVISED - R. SHAH 10-03-96
os\pw\work\p\dot\drsvakosgn\d0108315\bd24.dgn		DRAWN -	REVISED - A. ABBAS 03-21-97
	PLOT SCALE = 50.000' / IN.	CHECKED -	REVISED - M. GOMEZ 01-22-01
	PLOT DATE = 12/15/2009	DATE - 03-11-94	REVISED - R. BORO 12-15-09

STATE OF ILLINOIS  
DEPARTMENT OF TRANSPORTATION

CURB OR CURB AND GUTTER  
REMOVAL AND REPLACEMENT

SCALE: NONE SHEET NO. 9 OF 12 SHEETS STA. TO STA.

F.A.U. RTE.	SECTION	COUNTY	TOTAL SHEETS	SHEET NO.
2829	14-00085-00-RS	COOK	12	9
BD600-06 (BD-24)		CONTRACT NO. 61A60		
FED. ROAD DIST. NO. 1		ILLINOIS FED. AID PROJECT M-4003 (279)		



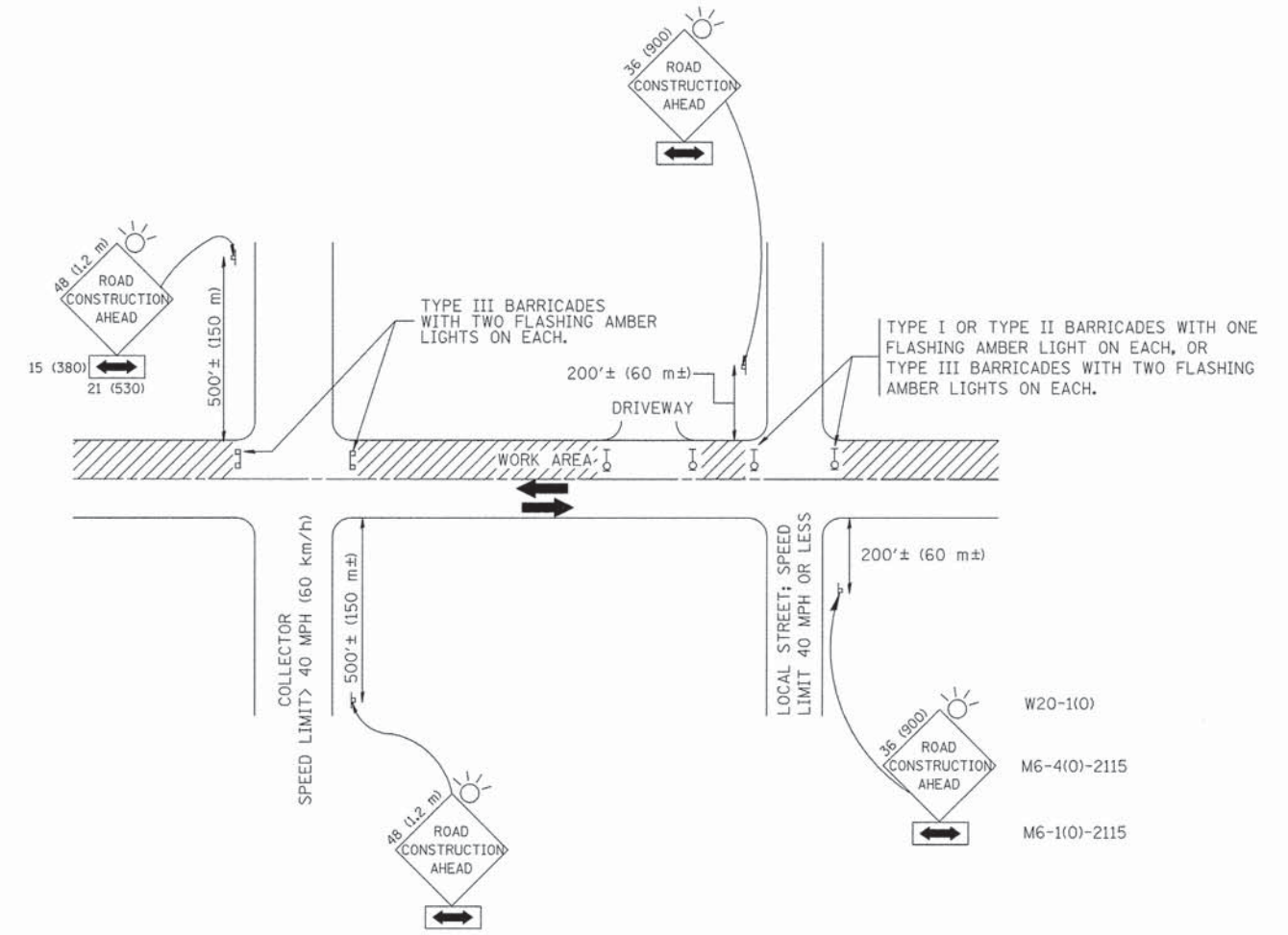

TRAFFIC CONTROL AND PROTECTION FOR SIDE ROADS, INTERSECTIONS, AND DRIVEWAYS

NOTES:

- A. FOR NO LANE RESTRICTION ON THE SIDE ROAD OR DRIVEWAYS
- SIDE ROAD WITH A SPEED LIMIT OF 40 MPH (60 km/h) OR LESS AS SHOWN ON THE DRAWING AND AS DIRECTED BY THE ENGINEER:
    - ONE **ROAD CONSTRUCTION AHEAD** SIGN 36 x 36 (900x900) WITH A FLASHER AND FLAG MOUNTED ON IT APPROXIMATELY 200' (60 m) IN ADVANCE OF THE MAIN ROUTE.
    - THE CLOSED PORTION OF THE MAIN ROUTE SHALL BE PROTECTED BY BLOCKING WITH TYPE I, TYPE II OR TYPE III BARRICADES, 1/3 OF THE CROSS SECTION OF THE CLOSED PORTION.
  - SIDE ROAD WITH A SPEED LIMIT GREATER THAN 40 MPH (60 km/h) AS SHOWN ON THE DRAWING AND AS DIRECTED BY THE ENGINEER:
    - ONE **ROAD CONSTRUCTION AHEAD** SIGN 48 x 48 (1.2 m x 1.2 m) WITH A FLASHER MOUNTED ON IT APPROXIMATELY 500' (150 m) IN ADVANCE OF THE MAIN ROUTE.
    - THE CLOSED PORTION OF THE MAIN ROUTE SHALL BE PROTECTED BY BLOCKING WITH TYPE III BARRICADES, 1/2 OF THE CROSS SECTION OF THE CLOSED PORTION.
  - WHEN THE SIDE ROAD LIES BETWEEN THE BEGINNING OF THE MAINLINE SIGNING AND THE WORK ZONE, A SINGLE HEADED ARROW (M6-1) SHALL BE USED IN LIEU OF THE DOUBLE HEADED ARROW (M6-4).
- B. FOR A LANE CLOSURE ON A SIDE ROAD OR DRIVEWAY:
- USE APPLICABLE PORTIONS OF THE TYPICAL APPLICATION OF TRAFFIC CONTROL DEVICES (STD. 701501, STD. 701606 OR THE APPROPRIATE STANDARD). THE SPACING OF SIGNS AND BARRICADES SHALL BE ADJUSTED FOR FIELD CONDITIONS AS DIRECTED BY THE ENGINEER. THE DIRECTIONAL ARROW SHALL BE COVERED OR REMOVED WHEN NO LONGER CONSISTENT WITH THE SIDE ROAD LANE CLOSURE.
- C. ADVANCE WARNING SIGNS ARE TO BE OMITTED ON DRIVEWAY UNLESS OTHERWISE NOTED.
- D. THE TRAFFIC CONTROL AND PROTECTION FOR SIDE ROADS, INTERSECTIONS, AND DRIVEWAYS SHALL BE INCIDENTAL TO THE COST OF SPECIFIED TRAFFIC CONTROL STANDARDS OR ITEMS.

All dimensions are in millimeters (inches) unless otherwise shown.

FILE NAME = W:\diststd\22x34\tcl0.dgn	USER NAME = goglianobt	DESIGNED - LHA	REVISED - J. OBERLE 10-18-95	STATE OF ILLINOIS DEPARTMENT OF TRANSPORTATION	DISTRICT ONE TRAFFIC CONTROL AND PROTECTION FOR SIDE ROADS, INTERSECTIONS, AND DRIVEWAYS	F.A.U. RTE. 2829	SECTION 14-00085-00-RS	COUNTY COOK	TOTAL SHEETS 12	SHEET NO. 10	
	PLOT SCALE = 50.0000' / IN.	CHECKED -	REVISED - A. HOUSEH 03-06-96			SCALE: NONE	SHEET NO. 10 OF 12 SHEETS	TC-10		CONTRACT NO. 61A60	
	PLOT DATE = 1/4/2008	DATE - 06-89	REVISED - T. RAMMACHER 01-06-00			STA.	TO STA.	FED. ROAD DIST. NO. 1		ILLINOIS FED. AID PROJECT M-4003 (279)	
All dimensions are in millimeters (inches) unless otherwise shown.											



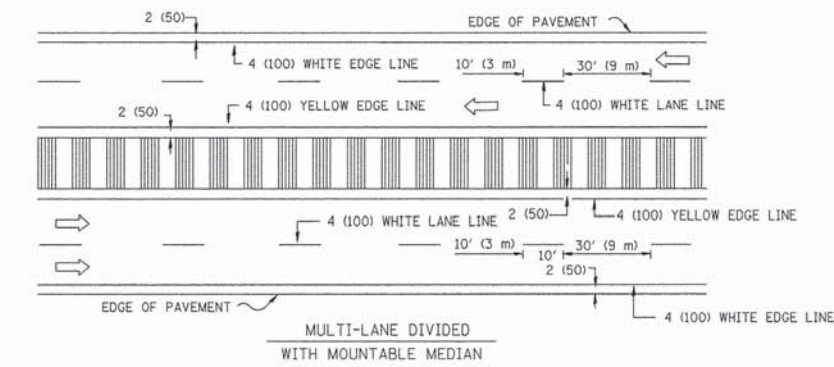
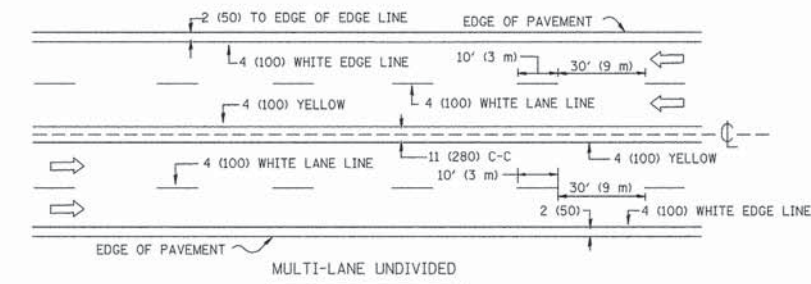
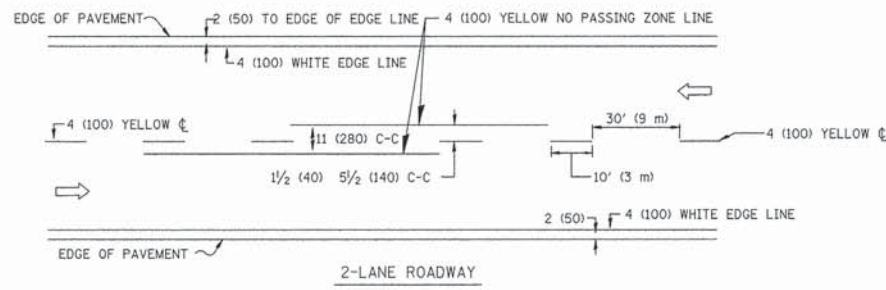

NOTE: MEDIANS WITH BARRIER CURB DO NOT REQUIRE AN EDGE LINE

TYPICAL LANE AND EDGE LINE MARKING

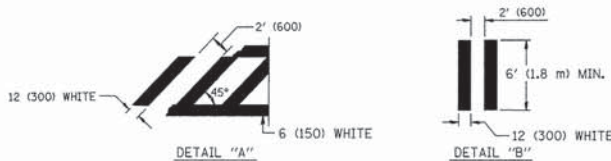
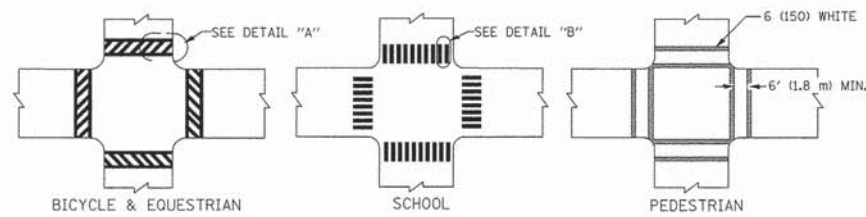

TYPICAL CROSSWALK MARKING

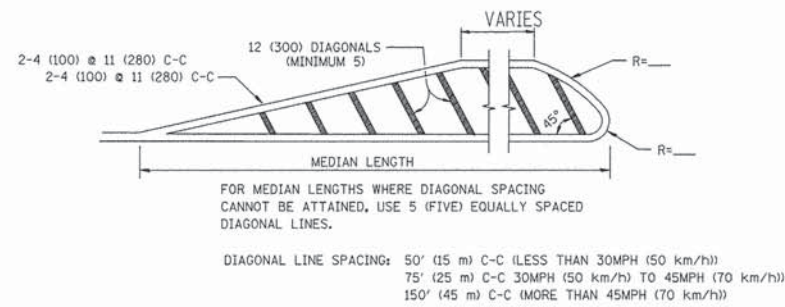
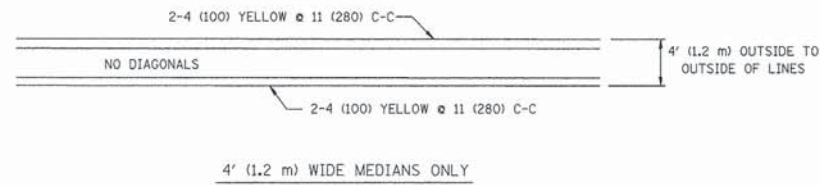

MEDIANS OVER 4' (1.2 m) WIDE

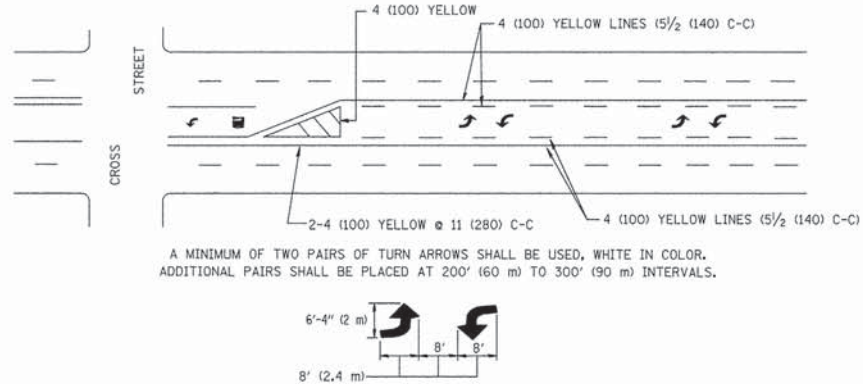

MEDIAN WITH TWO-WAY LEFT TURN LANE

TYPICAL PAINTED MEDIAN MARKING

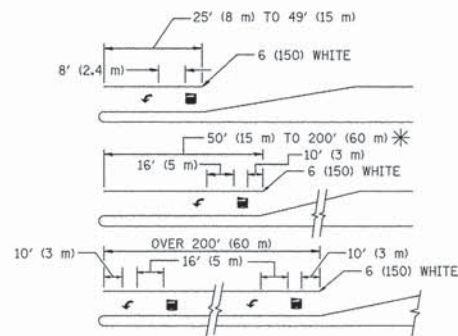

FULL SIZE LETTERS 8' (2.4 m) AND ARROWS SHALL BE USED.  
AREA = 15.6 SQ. FT. (1.5 m<sup>2</sup>) ONLY AREA = 20.8 SQ. FT. (1.9 m<sup>2</sup>)

\* TURN LANES IN EXCESS OF 400' (120 m) IN LENGTH MAY HAVE AN ADDITIONAL SET OF ARROW - "ONLY" INSTALLED MIDWAY BETWEEN THE OTHER TWO SETS OF ARROW - "ONLY".

TYPICAL LEFT (OR RIGHT) TURN LANE

TYPICAL TURN LANE MARKING

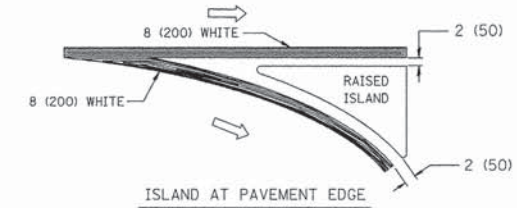
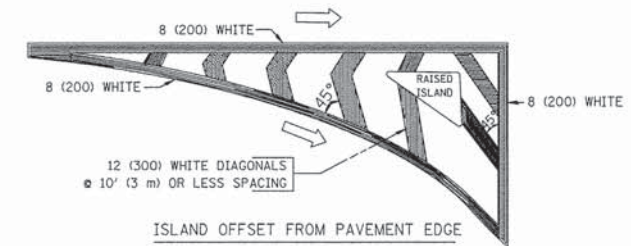

TYPICAL ISLAND MARKING

TYPE OF MARKING	WIDTH OF LINE	PATTERN	COLOR	SPACING / REMARKS
CENTERLINE ON 2 LANE PAVEMENT	4 (100)	SKIP-DASH	YELLOW	10' (3 m) LINE WITH 30' (9 m) SPACE
CENTERLINE ON MULTI-LANE UNDIVIDED PAVEMENT	2 @ 4 (100)	SOLID	YELLOW	11 (280) C-C
NO PASSING ZONE LINES: FOR ONE DIRECTION FOR BOTH DIRECTIONS	4 (100) 2 @ 4 (100)	SOLID SOLID	YELLOW YELLOW	5/2 (140) C-C FROM SKIP-DASH CENTERLINE 11 (280) C-C OMIT SKIP-DASH CENTERLINE BETWEEN
LANE LINES	4 (100) 5 (125) ON FREEWAYS	SKIP-DASH SKIP-DASH	WHITE WHITE	10' (3 m) LINE WITH 30' (9 m) SPACE
DOTTED LINES (EXTENSIONS OF CENTER, LANE OR TURN LANE MARKINGS)	SAME AS LINE BEING EXTENDED	SKIP-DASH	SAME AS LINE BEING EXTENDED	2' (600) LINE WITH 6' (1.8 m) SPACE
EDGE LINES	4 (100)	SOLID	YELLOW-LEFT WHITE-RIGHT	OUTLINE MOUNTABLE MEDIANS IN YELLOW; EDGE LINES ARE NOT USED NEXT TO BARRIER CURB
TURN LANE MARKINGS	6 (150) LINE; FULL SIZE LETTERS & SYMBOLS (8' (2.4m))	SOLID	WHITE	SEE TYPICAL TURN LANE MARKING DETAIL
TWO WAY LEFT TURN MARKING	2 @ 4 (100) EACH DIRECTION 8' (2.4m) LEFT ARROW	SKIP-DASH AND SOLID IN PAIRS	YELLOW WHITE	10' (3 m) LINE WITH 30' (9 m) SPACE FOR SKIP-DASH; 5/2 (140) C-C BETWEEN SOLID LINE AND SKIP-DASH LINE SEE TYPICAL TWO-WAY LEFT TURN MARKING DETAIL
CROSSWALK LINES (PEDESTRIAN) A. DIAGONALS (BIKE & EQUESTRIAN) B. LONGITUDINAL BARS (SCHOOL)	2 @ 6 (150) 12 (300) @ 45° 12 (300) @ 90°	SOLID SOLID SOLID	WHITE WHITE WHITE	NOT LESS THAN 6' (1.8 m) APART 2' (600) APART 2' (600) APART SEE TYPICAL CROSSWALK MARKING DETAILS.
STOP LINES	24 (600)	SOLID	WHITE	PLACE 4' (1.2 m) IN ADVANCE OF AND PARALLEL TO CROSSWALK, IF PRESENT. OTHERWISE, PLACE AT DESIRED STOPPING POINT. PARALLEL TO CROSSROAD CENTERLINE, WHERE POSSIBLE
PAINTED MEDIANS	2 @ 4 (100) WITH 12 (300) DIAGONALS @ 45° NO DIAGONALS USED FOR 4' (1.2 m) WIDE MEDIANS	SOLID	YELLOW: TWO WAY TRAFFIC WHITE: ONE WAY TRAFFIC	11 (280) C-C FOR THE DOUBLE LINE SEE TYPICAL PAINTED MEDIAN MARKING.
GORE MARKING AND CHANNELIZING LINES	8 (200) WITH 12 (300) DIAGONALS @ 45°	SOLID	WHITE	DIAGONALS: 15' (4.5 m) C-C (LESS THAN 30MPH (50 km/h)) 20' (6 m) C-C 30MPH (50 km/h) TO 45MPH (70 km/h) 30' (9 m) C-C (OVER 45MPH (70 km/h))
RAILROAD CROSSING	24 (600) TRANSVERSE LINES; "RR" IS 6' (1.8 m) LETTERS; 16 (400) LINE FOR "X"	SOLID	WHITE	SEE STATE STANDARD 780001 AREA OF: "R"=3.6 SQ. FT. (0.33 m <sup>2</sup> ) EACH "X"=54.0 SQ. FT. (5.0 m <sup>2</sup> )
SHOULDER DIAGONALS	12 (300) @ 45°	SOLID	WHITE - RIGHT YELLOW - LEFT	50' (15 m) C-C (LESS THAN 30MPH (50 km/h)) 75' (25 m) C-C (30 MPH (50 km/h) TO 45MPH (70 km/h)) 150' (45 m) C-C (OVER 45MPH (70 km/h))

FOR FURTHER DETAILS ON PAVEMENT MARKING REFER TO STANDARD SPECIFICATIONS FOR ROAD AND BRIDGE CONSTRUCTION AND STATE STANDARD 780001.

All dimensions are in inches (millimeters) unless otherwise shown.

FILE NAME = c:\pwwork\pwwork\drivakosgn\0108315\ta3.dgn

USER NAME = drivakosgn  
PLOT SCALE = 50,000 / IN.  
PLOT DATE = 9/9/2009

DESIGNED - EVERS  
DRAWN -  
CHECKED -  
DATE - 03-19-90

REVISED - T. RAMMACHER 10-27-94  
REVISED - C. JUCCIUS 09-09-09  
REVISED -  
REVISED -

STATE OF ILLINOIS  
DEPARTMENT OF TRANSPORTATION

DISTRICT ONE  
TYPICAL PAVEMENT MARKINGS

SCALE: NONE SHEET NO. 11 OF 12 SHEETS STA. TO STA.

F.A.U. RTE.	SECTION	COUNTY	TOTAL SHEETS	SHEET NO.
2829	14-00085-00-RS	COOK	12	11
TC-13		CONTRACT NO. 61A60		
FED. ROAD DIST. NO. 1 ILLINOIS FED. AID PROJECT M-4003 (279)				



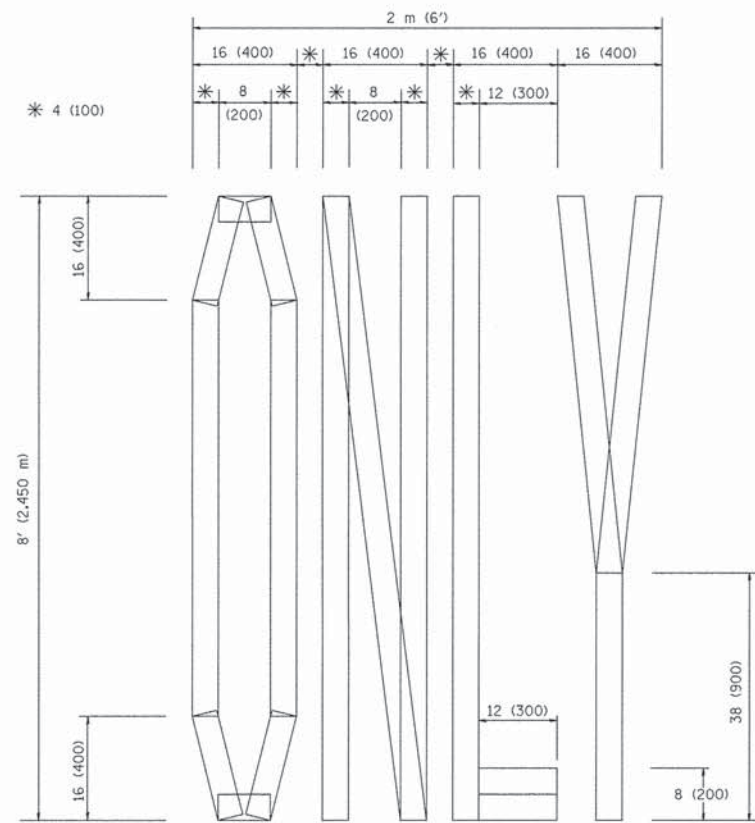

QUANTITY  
 4 (100) LINE = 64.1 ft. (19.7 m)  
 21.1 sq. ft. (1.97 sq. m)

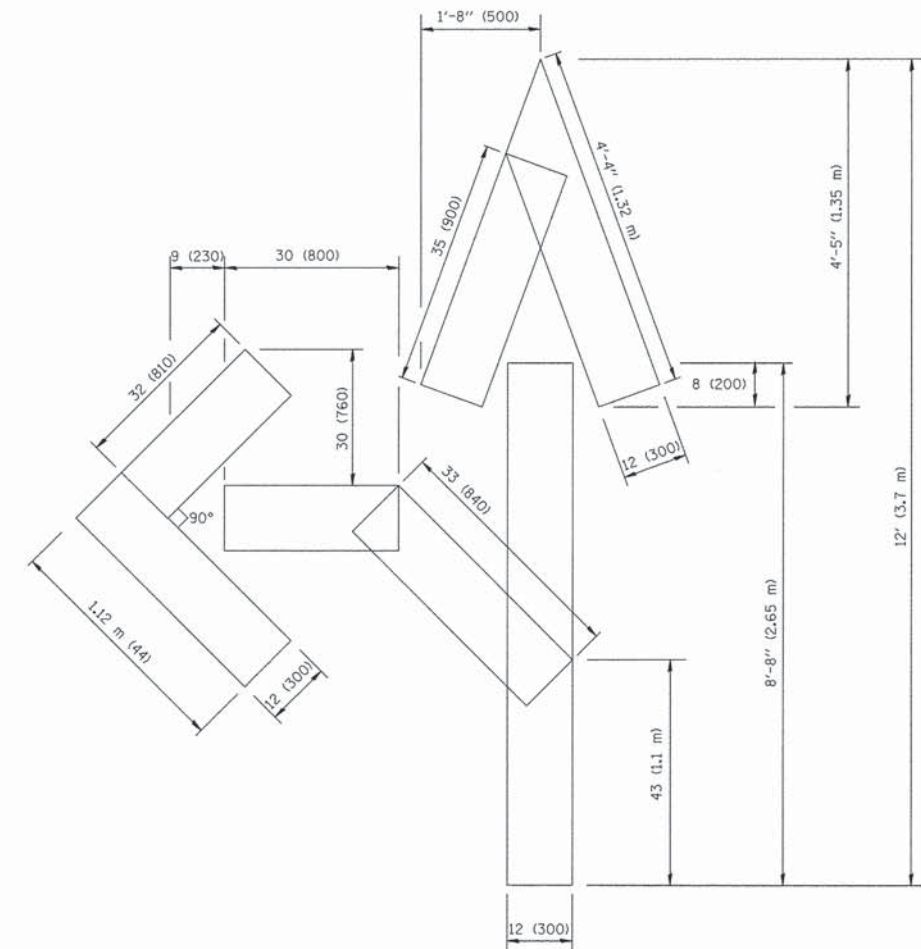

QUANTITY  
 4 (100) LINE = 82.5 ft. (25.3 m)  
 27.5 sq. ft. (2.53 sq. m)

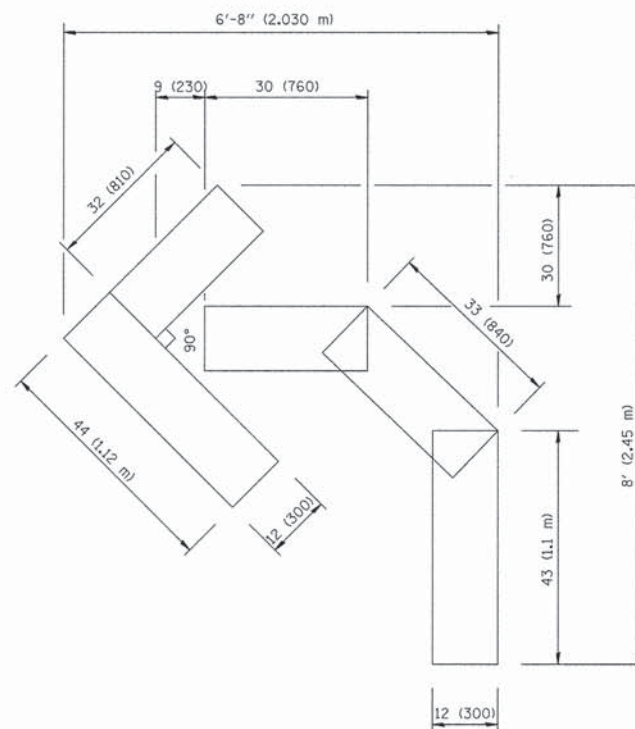

QUANTITY  
 4 (100) LINE = 45.5 ft. (13.9 m)  
 15.2 sq. ft. (1.39 sq. m)

All dimensions are in Inches (millimeters) unless otherwise shown.

FILE NAME = W:\diststd\22x34\tcl6.dgn	USER NAME = gaglienobt	DESIGNED - DRAWN -	REVISED -T. RAMMACHER 06-05-96 REVISED -T. RAMMACHER 11-04-97
PLOT SCALE = 58,0000 "/ IN.	CHECKED -	REVISED -T. RAMMACHER 03-02-98	
PLOT DATE = 1/4/2008	DATE - 09-18-94	REVISED -E. GOMEZ 08-28-00	

STATE OF ILLINOIS  
 DEPARTMENT OF TRANSPORTATION

DISTRICT ONE - PAVEMENT MARKING LETTERS AND SYMBOLS FOR TRAFFIC STAGING		F.A.U. RTE. 2829	SECTION 14-00085-00-RS	COUNTY COOK	TOTAL SHEETS 12	SHEET NO. 12
SCALE: NONE		SHEET NO. 12 OF 12 SHEETS		STA.	TO STA.	
		FED. ROAD DIST. NO. 1		ILLINOIS	FED. AID PROJECT M-4003 (279)	