

MATCH LINE STA. 136+00 (EX)
SEE BELOW

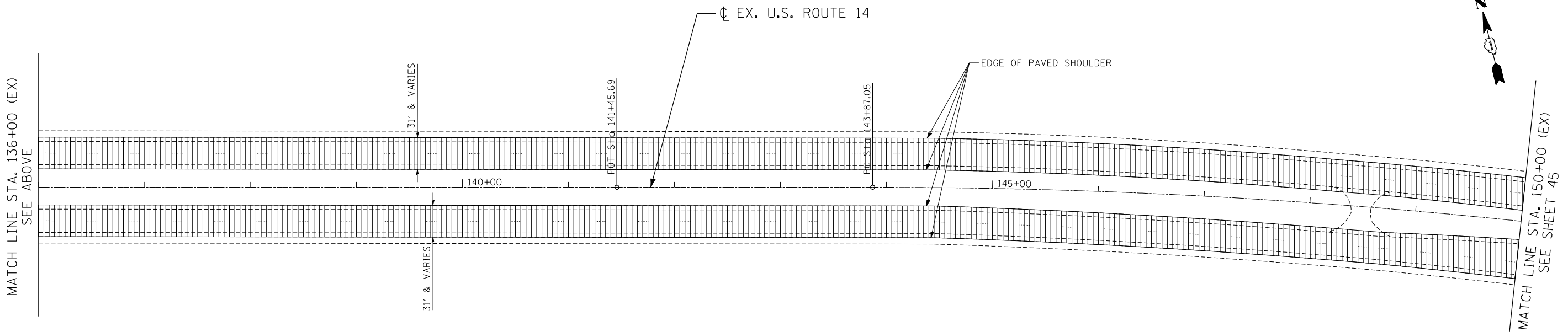

MATCH LINE STA. 136+00 (EX)
SEE ABOVE

MATCH LINE STA. 150+00 (EX)
SEE SHEET 45

REMOVAL LEGEND

	PAVEMENT REMOVAL		HMA SURFACE REMOVAL (VAR. DEPTH)		LINEAR REMOVALS
	PAVED SHOULDER REMOVAL		HMA SURFACE REMOVAL (2 1/4")		STORM SEWER TO BE REMOVED
	ISLAND PAVEMENT REMOVAL		MEDIAN REMOVAL		PIPE CULVERT REMOVAL (INCLUDING FLARED END SECTION)
	CONCRETE MEDIAN SURFACE REMOVAL		TREE REMOVAL (WITH DIA. INCHES)		DRAINAGE STRUCTURE TO BE REMOVED
	DRIVEWAY PAVEMENT REMOVAL		BUSH / SHRUB REMOVAL (REMOVAL INCLUDED IN COST OF EARTHWORK)		DRAINAGE STRUCTURE TO BE ADJUSTED

NOTES:
1. SEE GENERAL NOTE 35 FROM SHEET 3.

FILE NAME = ...
 USER NAME = HECHTBR
 DESIGNED -
 DRAWN - JP
 CHECKED - KA
 DATE - 11/01/13
 REVISED -
 REVISED -
 REVISED -
 REVISED -
 STATE OF ILLINOIS
 DEPARTMENT OF TRANSPORTATION
 U.S. ROUTE 14
 EXISTING ROADWAY & REMOVAL PLANS
 STA. 121+00 (EX) TO STA. 150+00 (EX)
 SCALE: 1"=50'
 SHEET NO. OF SHEETS STA. TO STA.
 F.A.P. RTE. SECTION COUNTY TOTAL SHEETS SHEET NO.
 305 27R-2 MCHENRY 673 44
 CONTRACT NO. 62268
 FED. ROAD DIST. NO. 1 ILLINOIS FED. AID PROJECT

FILE NAME =	USER NAME = HECHTBR	DESIGNED -	REVISED -	STATE OF ILLINOIS DEPARTMENT OF TRANSPORTATION U.S. ROUTE 14	EXISTING ROADWAY & REMOVAL PLANS STA. 121+00 (EX) TO STA. 150+00 (EX)	F.A.P. RTE.	SECTION	COUNTY	TOTAL SHEETS	SHEET NO.	
FILEL		DRAWN - JP	REVISED -			305	27R-2	MCHENRY	673	44	
exp U.S. Services Inc. Chicago, IL	PLOT SCALE = *SCALE*	CHECKED - KA	REVISED -			CONTRACT NO. 62268					
11-11-2013 14:18:10	PLOT DATE = *DATE*	DATE - 11/01/13	REVISED -			FED. ROAD DIST. NO. 1 ILLINOIS FED. AID PROJECT					