

**REMOVAL LEGEND**

	PAVEMENT REMOVAL		HMA SURFACE REMOVAL (VAR. DEPTH)		LINEAR REMOVALS
	PAVED SHOULDER REMOVAL		HMA SURFACE REMOVAL (2 1/4")		STORM SEWER TO BE REMOVED
	ISLAND PAVEMENT REMOVAL		MEDIAN REMOVAL		PIPE CULVERT REMOVAL (INCLUDING FLARED END SECTION)
	CONCRETE MEDIAN SURFACE REMOVAL		TREE REMOVAL (WITH DIA. INCHES)		DRAINAGE STRUCTURE TO BE REMOVED
	DRIVEWAY PAVEMENT REMOVAL		BUSH / SHRUB REMOVAL (REMOVAL INCLUDED IN COST OF EARTHWORK)		DRAINAGE STRUCTURE TO BE ADJUSTED

**NOTES:**

- PARTIAL STATIONING AND OFFSETS BASED OFF THE PROPOSED U.S. ROUTE 14 CENTERLINE.
- ADDITIONAL PAVEMENT REMOVAL REQUIRED FOR CONSTRUCTION OF THE PROPOSED ISLAND MEDIANS WILL BE INCLUDED IN THE CONTRACT UNIT PRICE FOR COMBINATION CURB AND GUTTER REMOVAL.
- SEE TRAFFIC SIGNAL PLANS FOR TRAFFIC SIGNAL REMOVALS.
- SEE CITY OF WOODSTOCK EXISTING UTILITY AND REMOVAL PLAN SHEETS FOR EXISTING CITY OF WOODSTOCK UTILITY REMOVALS.

**NOTES (CONT):**

- DURA-BAR PROPERTY (A DIVISION OF WELLS MANUFACTURING) LOCATED ON THE LEFT SIDE FROM STA. 331+12 TO 342+78 HAS AN EXISTING SPRINKLER SYSTEM LOCATED WITHIN THE PROPOSED RIGHT-OF-WAY. THE CONTRACTOR SHALL COORDINATE WITH THE DURA-BAR MANAGERS TO SHUT DOWN THE SPRINKLER SYSTEM PRIOR TO ITS REMOVAL BY THE CONTRACTOR. THE WORK TO REMOVE, CAP AT RIGHT-OF-WAY AND DISPOSE OF THE SPRINKLER SYSTEM WILL NOT BE PAID FOR SEPARATELY BUT SHALL BE INCLUDED IN THE CONTRACT UNIT PRICE FOR EARTH EXCAVATION.
- SEE SHEET 75 FOR REMOVAL LIMITS.
- SEE GENERAL NOTE 35 FROM SHEET 3.

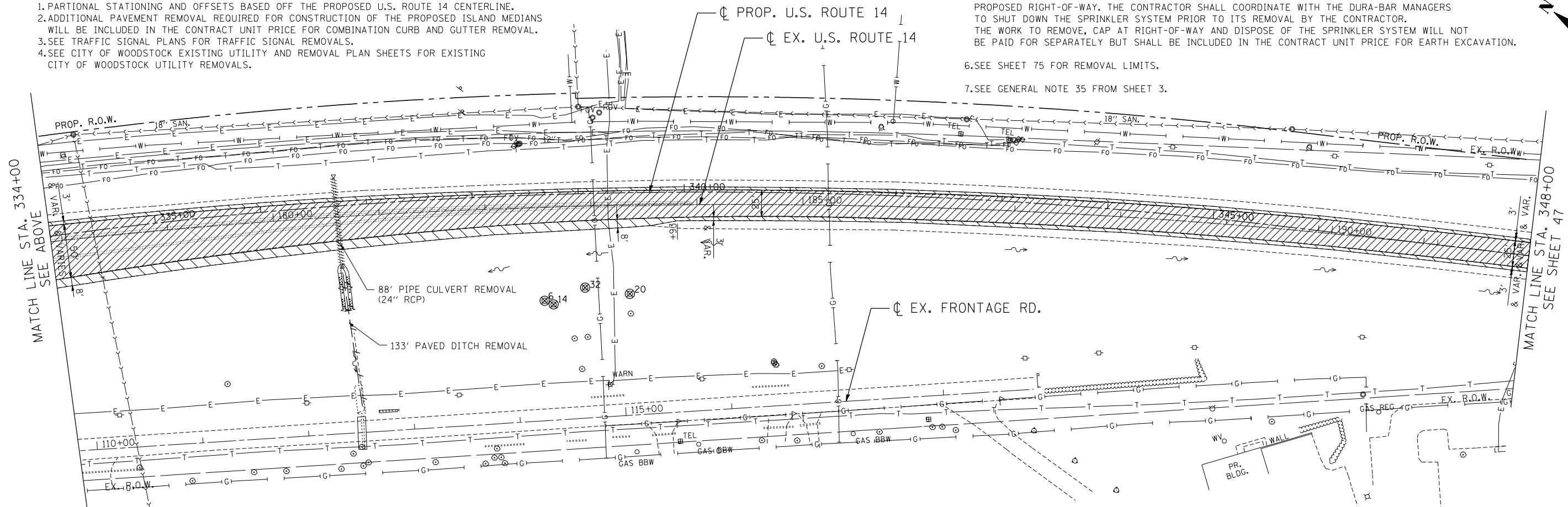

FILE NAME = ...  
 USER NAME = HECHTBR  
 DESIGNED -  
 DRAWN - RJS  
 CHECKED - BRH  
 DATE - 11/01/13  
 PLOT SCALE = \*SCALE\*  
 PLOT DATE = \*DATE\*  
 exp U.S. Services Inc.  
 BUILDINGS-EARTH & ENVIRONMENT-ENERGY  
 INDUSTRIAL-INFRASTRUCTURE-SUSTAINABILITY

**STATE OF ILLINOIS  
DEPARTMENT OF TRANSPORTATION  
U.S. ROUTE 14**

**EXISTING ROADWAY &  
REMOVAL PLANS  
STA. 164+00 (EX) TO STA. 348+00**

F.A.P. RTE.	SECTION	COUNTY	TOTAL SHEETS	SHEET NO.
305	27R-2	MCHENRY	673	46

CONTRACT NO. 62268

SCALE: 1"=50' SHEET NO. OF SHEETS STA. TO STA.

FED. ROAD DIST. NO. 1 ILLINOIS FED. AID PROJECT