

REMOVAL LEGEND

	PAVEMENT REMOVAL		HMA SURFACE REMOVAL (VAR. DEPTH)		LINEAR REMOVALS
	PAVED SHOULDER REMOVAL		HMA SURFACE REMOVAL (2 1/4")		STORM SEWER TO BE REMOVED
	ISLAND PAVEMENT REMOVAL		MEDIAN REMOVAL		PIPE CULVERT REMOVAL (INCLUDING FLARED END SECTION)
	CONCRETE MEDIAN SURFACE REMOVAL		TREE REMOVAL (WITH DIA. INCHES)		DRAINAGE STRUCTURE TO BE REMOVED
	DRIVEWAY PAVEMENT REMOVAL		BUSH / SHRUB REMOVAL (REMOVAL INCLUDED IN COST OF EARTHWORK)		DRAINAGE STRUCTURE TO BE ADJUSTED

NOTES:

- PARTIAL STATIONING AND OFFSETS BASED OFF THE PROPOSED U.S. ROUTE 14 CENTERLINE.
- SEE TRAFFIC SIGNAL PLANS FOR TRAFFIC SIGNAL REMOVALS.
- SEE CITY OF WOODSTOCK EXISTING UTILITY AND REMOVAL PLAN SHEETS FOR EXISTING CITY OF WOODSTOCK UTILITY REMOVALS.

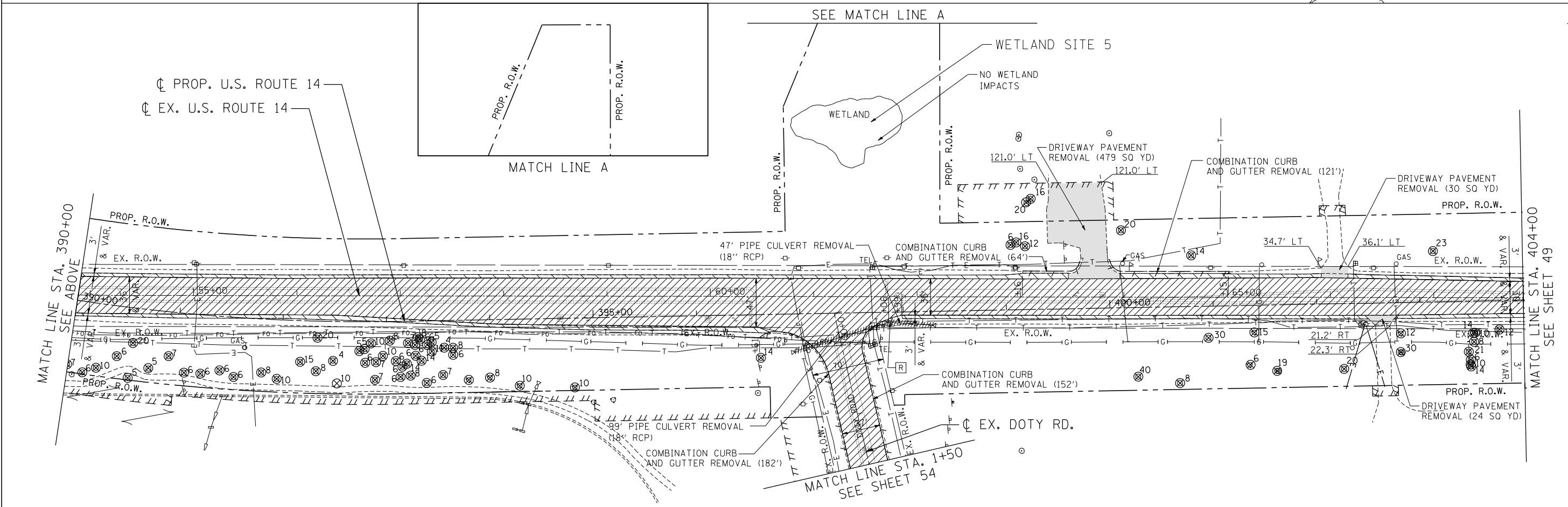
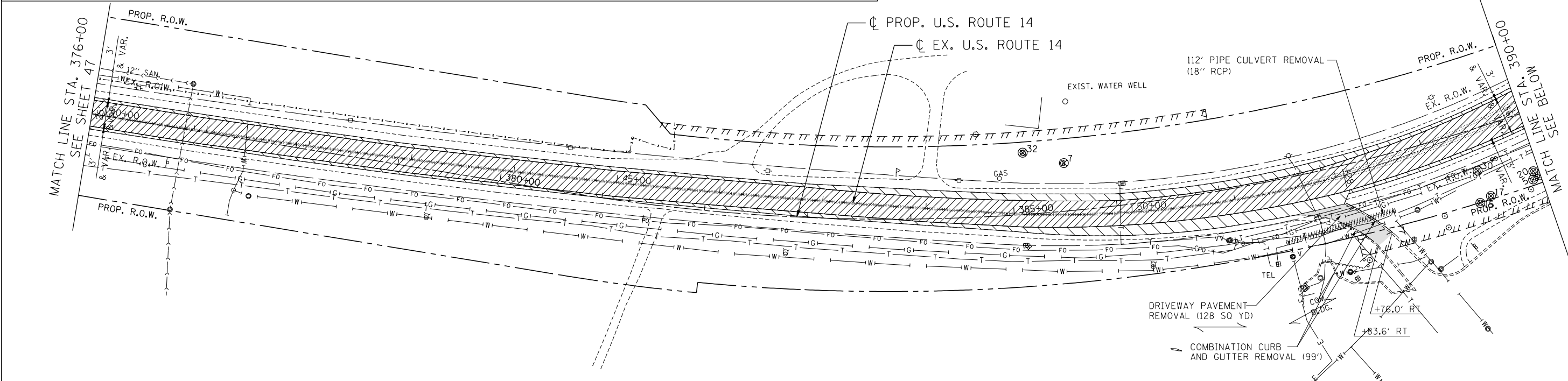
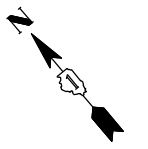

FILE NAME = ... USER NAME = HECHTBR ... DESIGNED - ... REVISED - ... DRAWN - RJS ... REVISED - ... CHECKED - BRH ... REVISED - ... DATE - 11/01/13 ... REVISED - ...

FILE NAME =	USER NAME = HECHTBR	DESIGNED -	REVISED -
#FILE#		DRAWN - RJS	REVISED -
exp U.S. Services Inc.	PLOT SCALE = *SCALE*	CHECKED - BRH	REVISED -
INDUSTRIAL-INFRASTRUCTURE-SUSTAINABILITY	PLOT DATE = *DATE*	DATE - 11/01/13	REVISED -

STATE OF ILLINOIS
DEPARTMENT OF TRANSPORTATION
 U.S. ROUTE 14

EXISTING ROADWAY & REMOVAL PLANS			
STA. 376+00 TO STA. 404+00			
SCALE: 1"=50'	SHEET NO.	OF SHEETS	STA. TO STA.

F.A.P. RTE.	SECTION	COUNTY	TOTAL SHEETS	SHEET NO.
305	27R-2	MCHENRY	673	48
CONTRACT NO. 62268				
FED. ROAD DIST. NO. 1 ILLINOIS FED. AID PROJECT				