

MOT STAGE 1.1 TYPICAL SECTION H-H

U.S. ROUTE 14
STA. 420+00

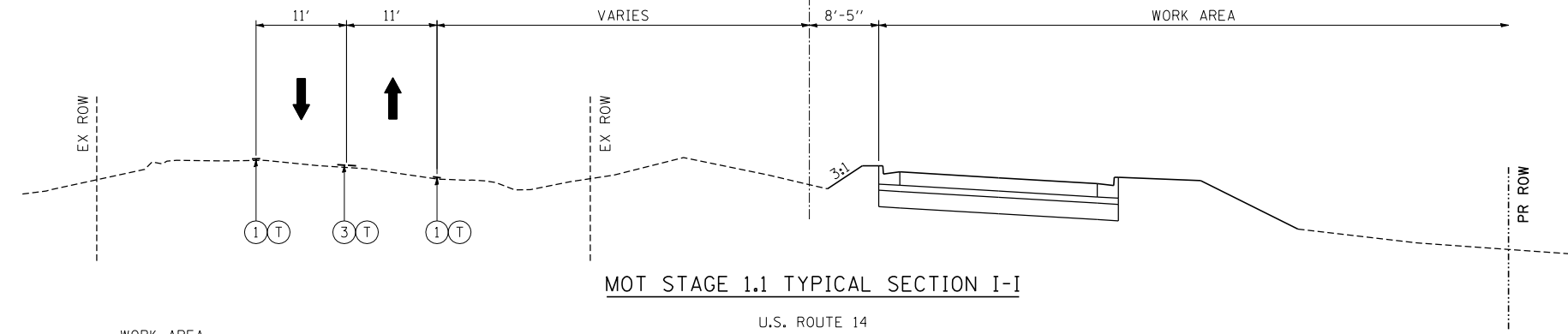

MOT STAGE 1.1 TYPICAL SECTION I-I

U.S. ROUTE 14
STA. 435+00

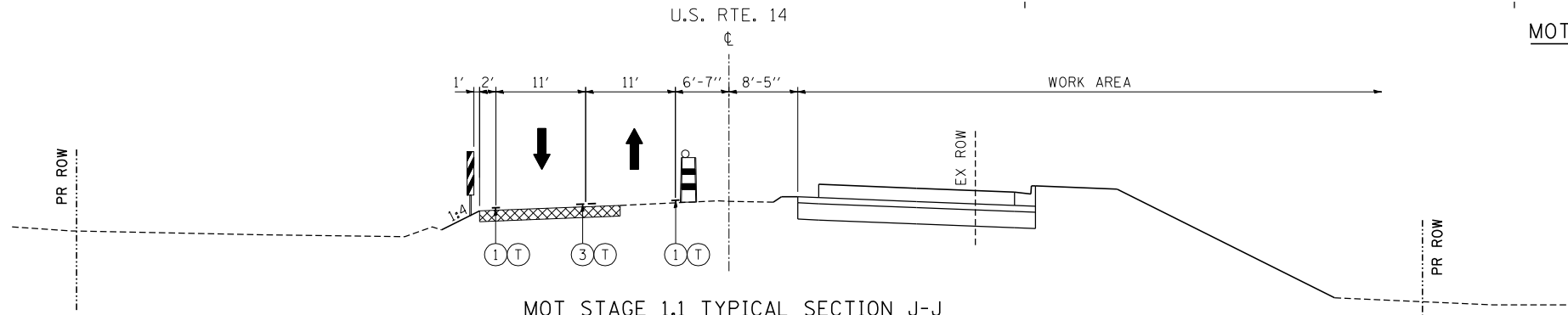

MOT STAGE 1.1 TYPICAL SECTION J-J

U.S. ROUTE 14
STA. 480+00

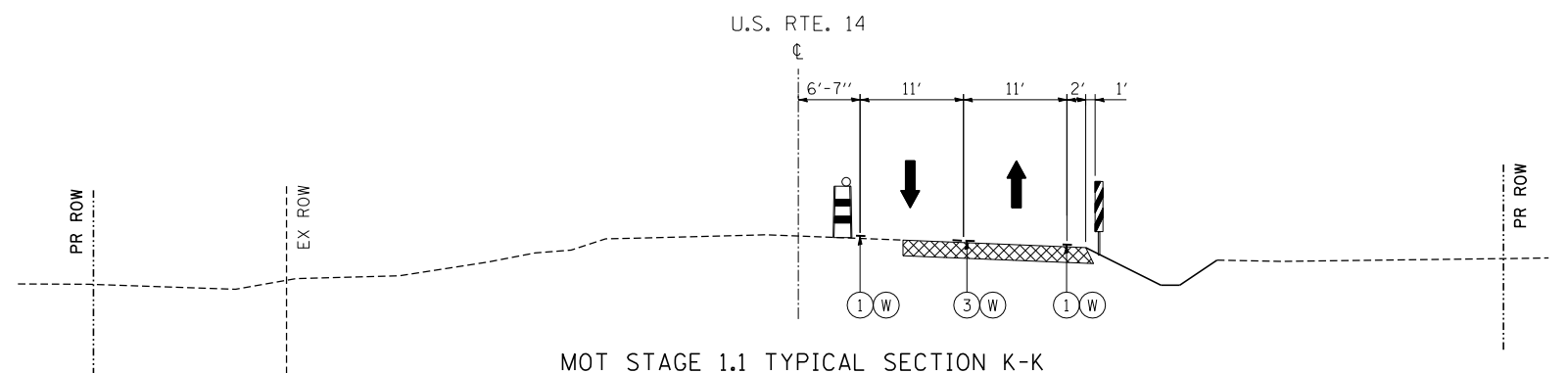

MOT STAGE 1.1 TYPICAL SECTION K-K

U.S. ROUTE 14
STA. 492+50

MAINTENANCE OF TRAFFIC LEGEND

- | | | | | | | | |
|--|--|--|--|---|---------------------------|---|---------------------|
| | TEMPORARY PAVEMENT
(SEE SHT 83 FOR SECTION) | | DOUBLE VERTICAL PANEL
WITH TYPE C STEADY
BURN BI-DIRECTIONAL LIGHT | ① | PVT MK - LINE 4" WHITE | Ⓣ | TEMP PVT MK |
| | TEMPORARY CONCRETE BARRIER | | EXISTING TRAFFIC DIRECTION | ② | PVT MK - LINE 4" YELLOW | Ⓜ | WET REF TEM TAPE T3 |
| | TYPE II BARRICADE OR DRUM
W/ TYPE C STEADY BURN
BI-DIRECTIONAL LIGHT | | PROPOSED TRAFFIC DIRECTION | ③ | PVT MK - DBL 4" YELLOW | | |
| | | | | ④ | PVT MK - LINE 6" WHITE | | |
| | | | | ⑤ | PVT MK - LINE 8" WHITE | | |
| | | | | ⑥ | EXISTING PAVEMENT MARKING | | |

STATE OF ILLINOIS
DEPARTMENT OF TRANSPORTATION
U.S. ROUTE 14

MOT TYPICAL SECTIONS
U.S. ROUTE 14
STAGE 1.1 - SHEET II

F.A.P. RTE.	SECTION	COUNTY	TOTAL SHEETS	SHEET NO.
305	27R-2	MCHENRY	673	85
CONTRACT NO. 62268				

SCALE: N.T.S. SHEET NO. OF SHEETS STA. TO STA.

FED. ROAD DIST. NO. 1 ILLINOIS FED. AID PROJECT

\NTSC00_31.DGN, \NTTB006.LJ.DGN, \GEN00477.DGN, \HECHTBR T:\DOCUMENT\934990\CIVIL\DOGTSC00_39.DGN
 11-07-2013, 16:25:31