

POINT	US RTE 14 STA	OFFSET
A	466+09.65	11.00
B	466+76.19	5.00
C	467+29.40	-11.00
D	468+14.40	-11.00
E	468+34.33	5.00
F	468+63.11	11.00

SEE SHEETS 140 AND 141 FOR RIDGEFIELD FOR ROAD STAGING (SUBSTAGE B-1 SHOWN)

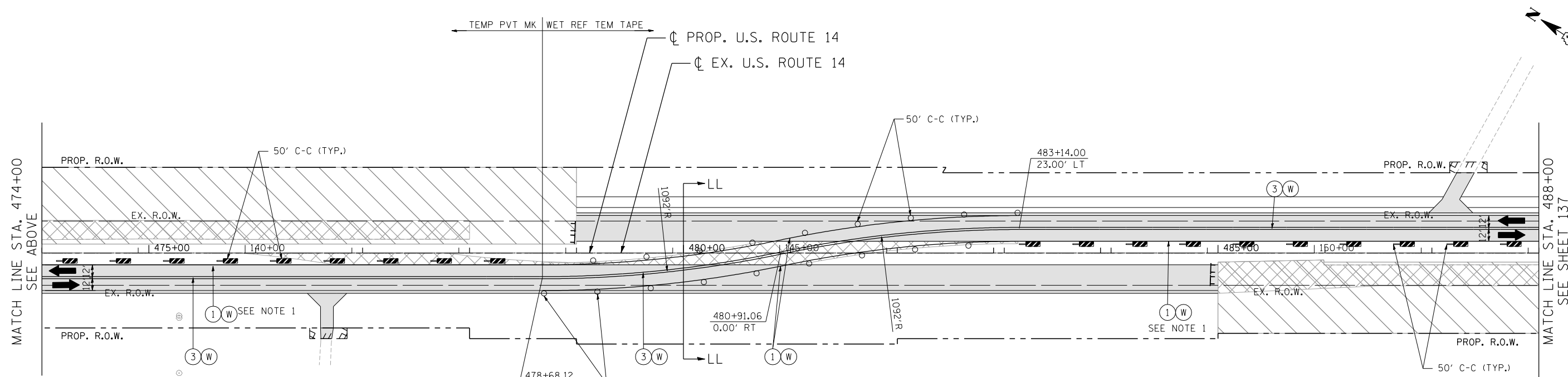

NOTES

- TEMPORARY PAVEMENT MARKING SHALL BE PLACED BETWEEN GAPS IN CURB AND GUTTER AND AT CURB AND GUTTER BUMPOUT LOCATIONS. TEMPORARY PAVEMENT MARKING IS NOT PLACED AT THE EDGE OF PAVEMENT ADJACENT TO CURB AND GUTTER EXCEPT AT LOCATIONS SHOWN ON THE PLANS.
- TYPE II BARRICADES OR DRUMS WITH TYPE C STEADY BURN LIGHT SHALL BE SPACED AT 25' C-C ALONG INTERSECTION RADIUS RETURNS.

MAINTENANCE OF TRAFFIC LEGEND

WORK AREA	EXISTING TRAFFIC DIRECTION	ARROW BOARD	PVT MK - LINE 4" WHITE	PVT MK - LINE 24" WHITE
TEMPORARY PAVEMENT (CURRENT STAGE)	BARRICADE, TYPE III, W/ TYPE A FLASHING LIGHTS	DOUBLE VERTICAL PANEL WITH TYPE C STEADY BURN LIGHT	PVT MK - LINE 4" YELLOW	PVT MK - LINE 8" WHITE
TEMPORARY PAVEMENT (PREVIOUS STAGES)	TYPE II BARRICADE OR DRUM W/ TYPE C STEADY BURN BI-DIRECTIONAL LIGHT	PROPOSED SIGN	PVT MK - DBL 4" YELLOW	TEMP PVT MK
CONSTRUCTED PAVEMENT	TYPE B MONO-DIRECTIONAL FLASHING LIGHT	TYPE II BARRICADE OR DRUM W/ TYPE A FLASHING LIGHT	PVT MK - LINE 6" WHITE	WET REF TEM TAPE T3
			PVT MK - LINE 12"	
			PVT MK - LTRS & SYMB	

STATE OF ILLINOIS
DEPARTMENT OF TRANSPORTATION
U.S. ROUTE 14

MAINTENANCE OF TRAFFIC
STAGE 2.1
STA. 460+00 TO STA. 488+00

FILE NAME =	USER NAME = HECHTBR	DESIGNED -	REVISED -
#FILEL#		DRAWN - JP	REVISED -
		CHECKED - KA	REVISED -
		DATE - 11/01/13	REVISED -

SCALE: 1"=50'	SHEET NO. OF SHEETS	STA. TO STA.
---------------	---------------------	--------------

F.A.P. RTE.	SECTION	COUNTY	TOTAL SHEETS	SHEET NO.
305	27R-2	MCHENRY	673	136
FED. ROAD DIST. NO. 1 ILLINOIS FED. AID PROJECT			CONTRACT NO. 62268	

11-06-2013, 15:55:46
 HECHTBR
 T:\DOCUMENT\19343981\CIVIL\DCN\M01004.LK.DGN
 T:\DOCUMENT\19343981\CIVIL\DCN\M01004.LK.DGN
 T:\DOCUMENT\19343981\CIVIL\DCN\M01004.LK.DGN