

MAINTENANCE OF TRAFFIC LEGEND

	WORK AREA		EXISTING TRAFFIC DIRECTION		ARROW BOARD		1 PVT MK - LINE 4" WHITE		7 PVT MK - LINE 24" WHITE
	TEMPORARY PAVEMENT (CURRENT STAGE)		PROPOSED TRAFFIC DIRECTION		DOUBLE VERTICAL PANEL WITH TYPE C STEADY BURN LIGHT		2 PVT MK - LINE 4" YELLOW		8 PVT MK - LINE 8" WHITE
	TEMPORARY PAVEMENT (PREVIOUS STAGES)		BARRICADE, TYPE III, W/ TYPE A FLASHING LIGHTS		PROPOSED SIGN		3 PVT MK - DBL 4" YELLOW		T TEMP PVT MK
	CONSTRUCTED PAVEMENT		TYPE II BARRICADE OR DRUM W/ TYPE C STEADY BURN BI-DIRECTIONAL LIGHT		TYPE II BARRICADE OR DRUM W/ TYPE A FLASHING LIGHT		4 PVT MK - LINE 6" WHITE		W WET REF TEM TAPE T3
			TYPE B MONO-DIRECTIONAL FLASHING LIGHT				5 PVT MK - LINE 12"		
							6 PVT MK - LTRS & SYMB		

CL PROP. U.S. ROUTE 14
CL EX. U.S. ROUTE 14

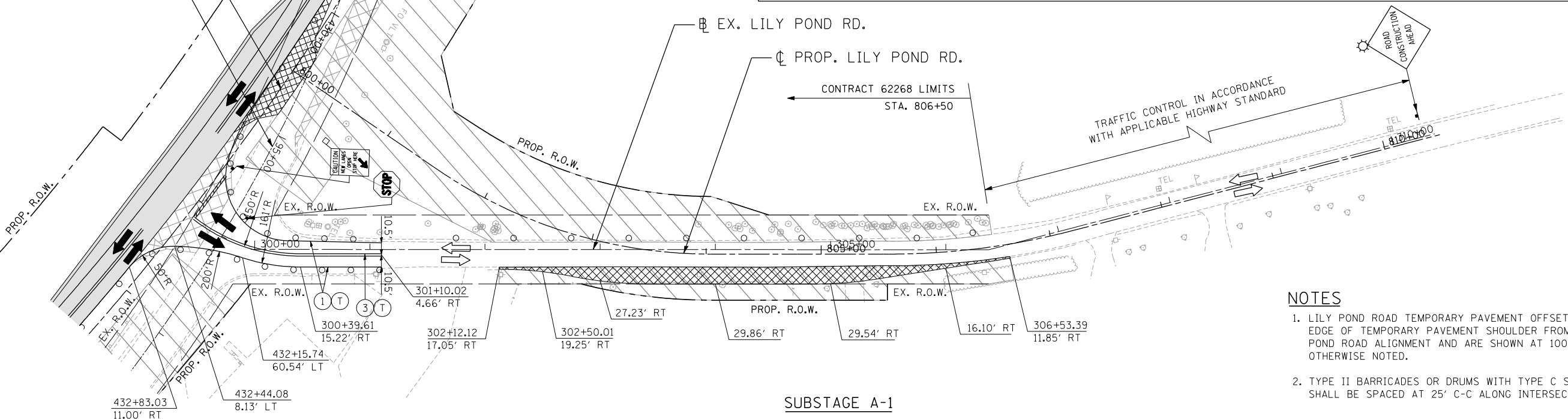

SUBSTAGE A-1

NOTES

- LILY POND ROAD TEMPORARY PAVEMENT OFFSETS ARE GIVEN TO THE EDGE OF TEMPORARY PAVEMENT SHOULDER FROM THE EXISTING LILY POND ROAD ALIGNMENT AND ARE SHOWN AT 100' INTERVALS UNLESS OTHERWISE NOTED.
- TYPE II BARRICADES OR DRUMS WITH TYPE C STEADY BURN LIGHT SHALL BE SPACED AT 25' C-C ALONG INTERSECTION RADIUS RETURNS.

CL PROP. U.S. ROUTE 14
CL EX. U.S. ROUTE 14

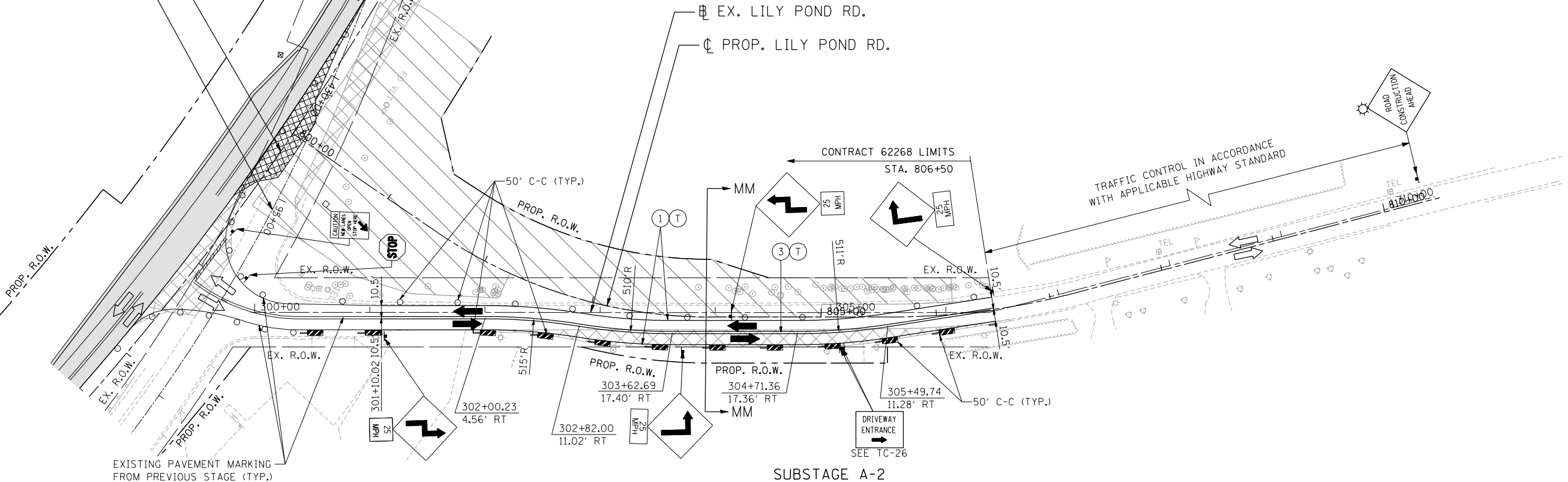

SUBSTAGE A-2

STATE OF ILLINOIS
DEPARTMENT OF TRANSPORTATION
U.S. ROUTE 14

MAINTENANCE OF TRAFFIC
STAGE 2.1 SUBSTAGE A-1 & A-2
LILY POND ROAD

F.A.P. RTE.	SECTION	COUNTY	TOTAL SHEETS	SHEET NO.
305	27R-2	MCHENRY	673	138
CONTRACT NO. 62268				

SCALE: 1"=50' SHEET NO. OF SHEETS STA. TO STA.

FED. ROAD DIST. NO. 1 ILLINOIS FED. AID PROJECT

FILE NAME = USER NAME = HECHTBR DESIGNED - DRAWN - JP CHECKED - KA DATE - 11/01/13

exp U.S. Services Inc. BUILDINGS-EARTH & ENVIRONMENT-ENERGY INDUSTRIAL-INFRASTRUCTURE-SUSTAINABILITY