

**PAVEMENT MARKING & SIGNING LEGEND**

① PAVEMENT MARKING - LINE 4" WHITE	⑦ PAVEMENT MARKING - LINE 6" YELLOW	EX. SIGN TO BE REMOVED ONLY	PROP. LOCATION OF RELOCATED EX. SIGN
② PAVEMENT MARKING - LINE 6" WHITE	⑧ PAVEMENT MARKING - LINE 8" YELLOW	EX. SIGN TO BE REMOVED AND RELOCATED	PROP. GROUND SIGN
③ PAVEMENT MARKING - LINE 8" WHITE	⑨ PAVEMENT MARKING - LINE 12" YELLOW		⊣ EXISTING GROUND SIGN
④ PAVEMENT MARKING - LINE 12" WHITE	⑩ PAVEMENT MARKING - DOUBLE LINE 4" YELLOW		⊣ PROPOSED GROUND SIGN
⑤ PAVEMENT MARKING - LINE 24" WHITE	⑪ PAVEMENT MARKING - LETTERS AND SYMBOLS		
⑥ PAVEMENT MARKING - LINE 4" YELLOW	◁ ONE-WAY CRYSTAL MARKER		

NOTE:  
 1. SEE SHEET 396 FOR NOTES.  
 2. PROPOSED LOCATION SHALL BE CORDINATED WITH THE CITY OF CRYSTAL LAKE AND THE ENGINEER.

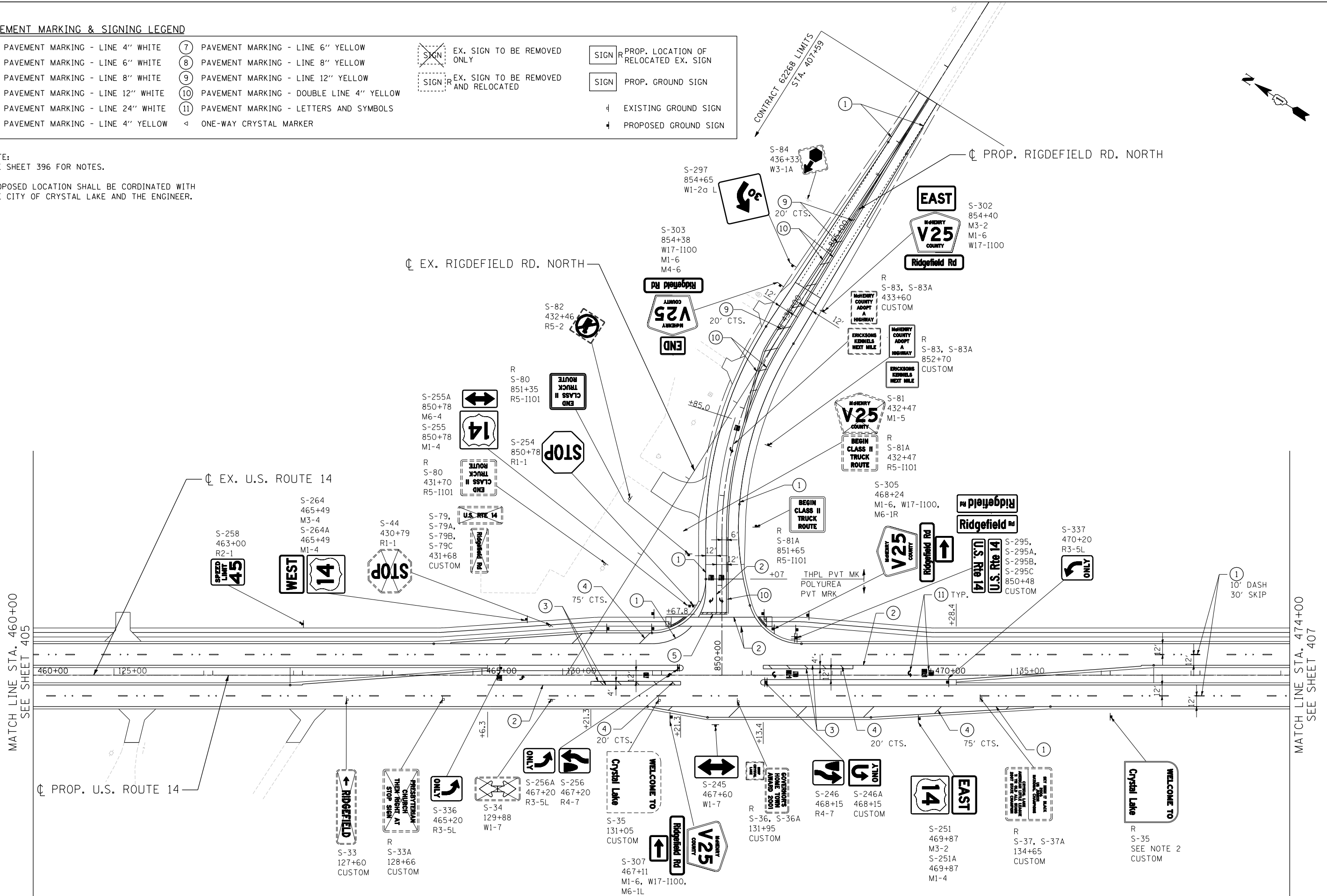

FILE NAME = ... USER NAME = HECHTBR ... DESIGNED - ... REVISED - ... DRAWN - AMB ... REVISED - ... CHECKED - TMH ... REVISED - ... DATE - 11/01/13 ... REVISED - ...

**STATE OF ILLINOIS**  
**DEPARTMENT OF TRANSPORTATION**  
 U.S. ROUTE 14

**PAVEMENT MARKING & SIGNING PLANS**  
**STA. 460+00 TO STA. 474+00**

F.A.P. RTE.	SECTION	COUNTY	TOTAL SHEETS	SHEET NO.
305	27R-2	MCHENRY	673	406
CONTRACT NO. 62268				
FED. ROAD DIST. NO. 1 ILLINOIS FED. AID PROJECT				

SCALE: 1"=50' SHEET NO. OF SHEETS STA. TO STA.