

150 140 130 120 110 100 90 80 70 60 50 40 30 20 10 0 10 20 30 40 50 60 70 80 90 100 110 120 130 140 150

PR C US RTE 14

DATE	
BY	
SURVEYED	
PLOTTED	
TEMPLATE	
NOTE BOOK	
AREAS CHECKED	
NO.	

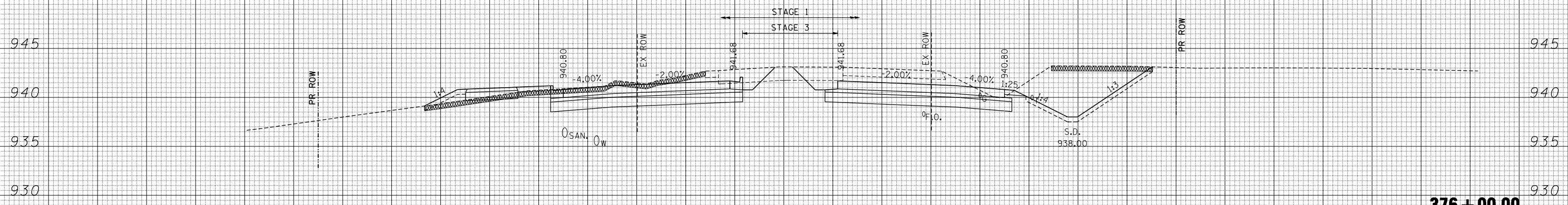

**STAGE 1**  
 EARTH EXCAVATION = 265.9 SQ FT  
 TOPSOIL EXCAVATION = 39.0 SQ FT  
 EMBANKMENT = 14.4 SQ FT

**376 + 00.00**

DATE	
BY	
SURVEYED	
PLOTTED	
TEMPLATE	
NOTE BOOK	
AREAS CHECKED	
NO.	

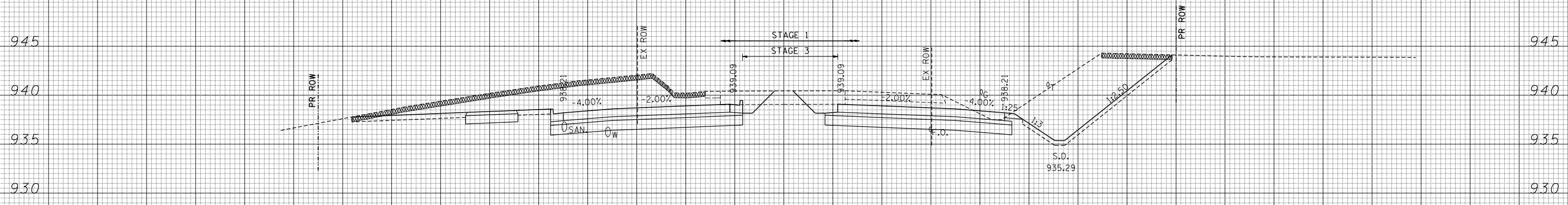

**STAGE 1**  
 EARTH EXCAVATION = 453.0 SQ FT  
 TOPSOIL EXCAVATION = 43.2 SQ FT  
 EMBANKMENT = 3.8 SQ FT

**375 + 00.00**

- LEGEND**
- TOPSOIL REMOVAL
  - UNSUIT. MATERIAL
  - AGGREGATE SUBGRADE IMPROVEMENT (CU YD)
  - EARTH EXCAVATION MULTI-USE PATH (80% IDOT 20% MCD)

PR C US RTE 14

150 140 130 120 110 100 90 80 70 60 50 40 30 20 10 0 10 20 30 40 50 60 70 80 90 100 110 120 130 140 150

FILE NAME =  
 \*FILEL\*  
 exp U.S. Services Inc.  
 Chicago, IL  
 BUILDING-EARTH & ENVIRONMENT-ENERGY  
 INDUSTRIAL-INFRASTRUCTURE-SUSTAINABILITY

USER NAME = \*USER\*  
 DESIGNED -  
 DRAWN - AC  
 CHECKED - BRH  
 DATE - 11/01/13

REVISED -  
 REVISED -  
 REVISED -  
 REVISED -

**STATE OF ILLINOIS  
 DEPARTMENT OF TRANSPORTATION**

**U.S. ROUTE 14 CROSS SECTIONS**

SCALE: HORIZ. 1" = 10' VERT. 1" = 5' STA. 375+00.00 TO STA. 376+00.00

F.A.P. RTE.	SECTION	COUNTY	TOTAL SHEETS	SHEET NO.
305	27R-2	MCHENRY	673	512
			CONTRACT NO. 62268	

ILLINOIS FED. AID PROJECT