

| | |
|---------------|--|
| DATE | |
| BY | |
| SURVEYED | |
| PLOTTED | |
| TEMPLATE | |
| NOTE BOOK | |
| AREAS CHECKED | |
| NO. | |

| | |
|---------------|--|
| DATE | |
| BY | |
| SURVEYED | |
| PLOTTED | |
| TEMPLATE | |
| NOTE BOOK | |
| AREAS CHECKED | |
| NO. | |

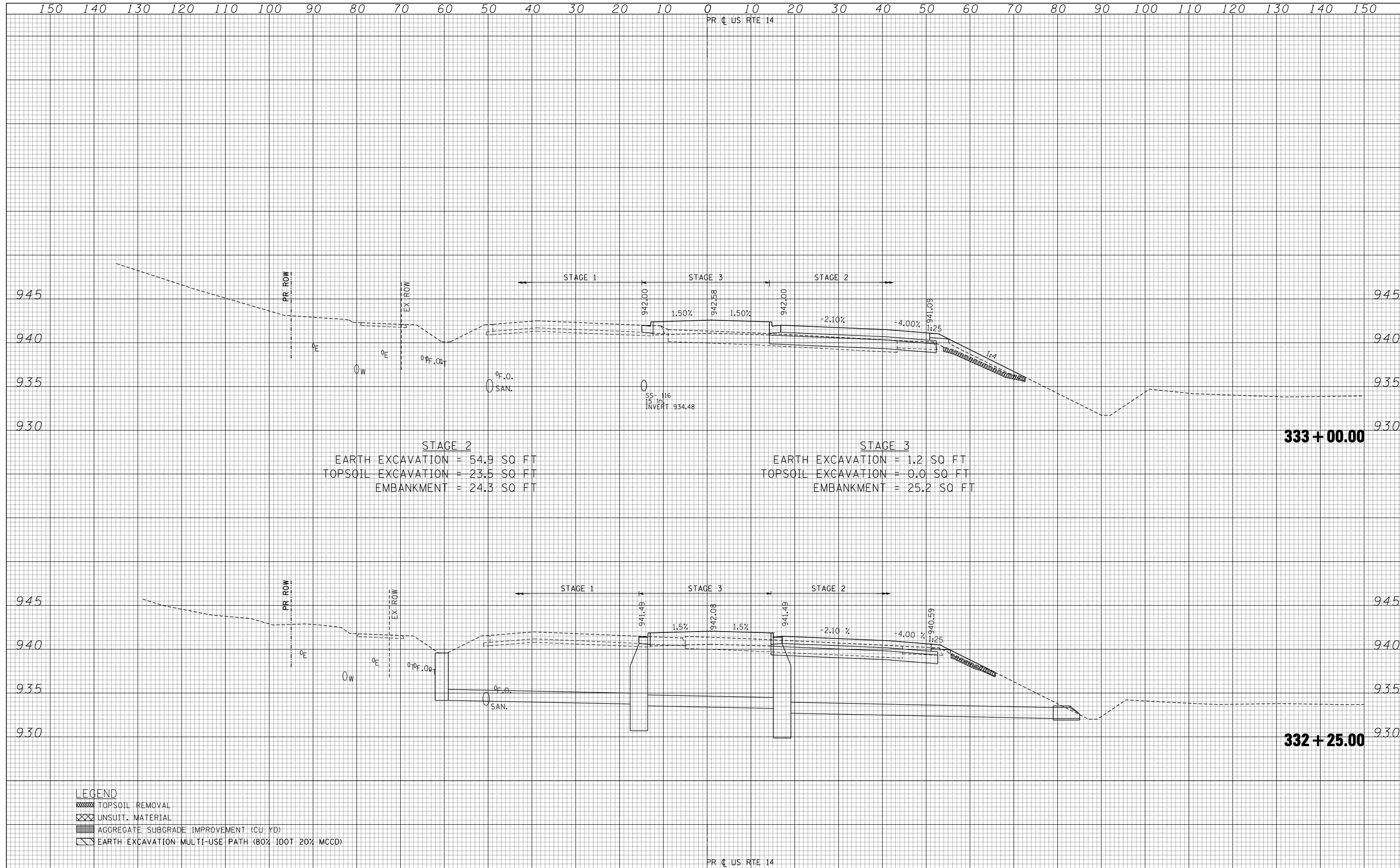

STAGE 2
 EARTH EXCAVATION = 54.9 SQ FT
 TOPSOIL EXCAVATION = 23.5 SQ FT
 EMBANKMENT = 24.3 SQ FT

STAGE 3
 EARTH EXCAVATION = 1.2 SQ FT
 TOPSOIL EXCAVATION = 0.0 SQ FT
 EMBANKMENT = 25.2 SQ FT

- LEGEND**
- TOPSOIL REMOVAL
 - UNSUIT. MATERIAL
 - AGGREGATE SUBGRADE IMPROVEMENT (CU YD)
 - EARTH EXCAVATION MULTI-USE PATH (80% IDOT 20% MCCD)

FILE NAME =
 #FILEL#
 exp U.S. Services Inc.
 Chicago, IL
 BUILDINGS-EARTH & ENVIRONMENT-ENERGY
 INDUSTRIAL-INFRASTRUCTURE-SUSTAINABILITY

USER NAME = #USER#
 DESIGNED -
 DRAWN - AG
 CHECKED - BRH
 DATE - 11/01/13

REVISED -
 REVISED -
 REVISED -
 REVISED -

**STATE OF ILLINOIS
 DEPARTMENT OF TRANSPORTATION**

U.S. ROUTE 14 CROSS SECTIONS
 SCALE: HORIZ. 1" = 10' VERT. 1" = 5'
 STA. 332+25.00 TO STA. 333+00.00

| F.A.P. RTE. | SECTION | COUNTY | TOTAL SHEETS | SHEET NO. |
|---------------------------|---------|---------|--------------------|-----------|
| 305 | 27R-2 | MCHENRY | 673 | 578 |
| | | | CONTRACT NO. 62268 | |
| ILLINOIS FED. AID PROJECT | | | | |