

150 140 130 120 110 100 90 80 70 60 50 40 30 20 10 0 10 20 30 40 50 60 70 80 90 100 110 120 130 140 150

PR C US RTE 14

DATE	
BY	
SURVEYED	
PLOTTED	
TEMPLATE	
NOTE BOOK	
AREAS CHECKED	
NO.	

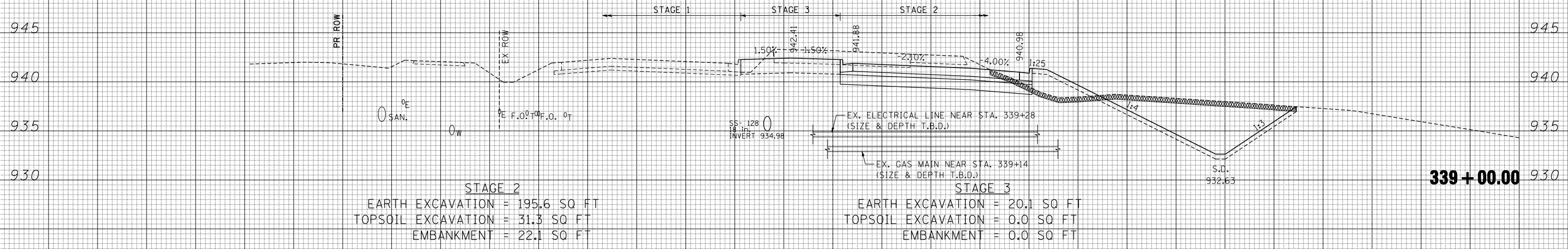

**STAGE 2**  
 EARTH EXCAVATION = 195.6 SQ FT  
 TOPSOIL EXCAVATION = 31.3 SQ FT  
 EMBANKMENT = 22.1 SQ FT

**STAGE 3**  
 EARTH EXCAVATION = 20.1 SQ FT  
 TOPSOIL EXCAVATION = 0.0 SQ FT  
 EMBANKMENT = 0.0 SQ FT

**339 + 00.00**

DATE	
BY	
SURVEYED	
PLOTTED	
TEMPLATE	
NOTE BOOK	
AREAS CHECKED	
NO.	

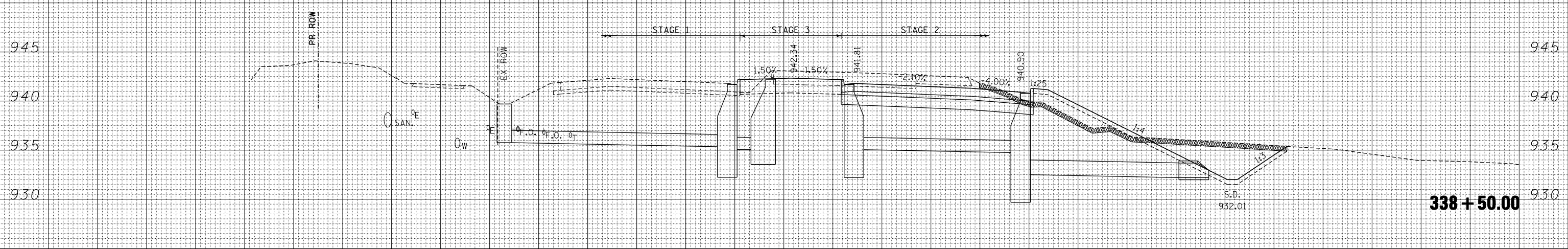

**338 + 50.00**

- LEGEND**
- TOPSOIL REMOVAL
  - UNSUIT. MATERIAL
  - AGGREGATE SUBGRADE IMPROVEMENT (CU YD)
  - EARTH EXCAVATION MULTI-USE PATH (80% IDOT 20% MCCD)

PR C US RTE 14

FILE NAME *	USER NAME * \$USER\$	DESIGNED -	REVISED -	<b>STATE OF ILLINOIS</b> <b>DEPARTMENT OF TRANSPORTATION</b>	<b>U.S. ROUTE 14 CROSS SECTIONS</b>	F.A.P. RTE.	SECTION	COUNTY	TOTAL SHEETS	SHEET NO.	
*FILEL\$		DRAWN - AG	REVISED -			305	27R-2	MCHENRY	673	582	
PLOT SCALE * \$SCALE\$		CHECKED - BRH	REVISED -			CONTRACT NO. 62268					
PLOT DATE * \$DATE\$		DATE - 11/01/13	REVISED -			ILLINOIS FED. AID PROJECT					
exp U.S. Services Inc. Chicago, IL BUILDINGS-EARTH & ENVIRONMENT-ENERGY INDUSTRIAL-INFRASTRUCTURE-SUSTAINABILITY					SCALE: HORIZ. 1" = 10' VERT. 1" = 5'		STA. 338+50.00 TO STA. 339+00.00				