

DATE	
BY	
SURVEYED	
PLOTTED	
TEMPLATE	
AREAS	
CHECKED	
FINAL SURVEY	
NOTE BOOK	
NO.	

DATE	
BY	
SURVEYED	
PLOTTED	
TEMPLATE	
AREAS	
CHECKED	
ORIGINAL SURVEY	
NOTE BOOK	
NO.	

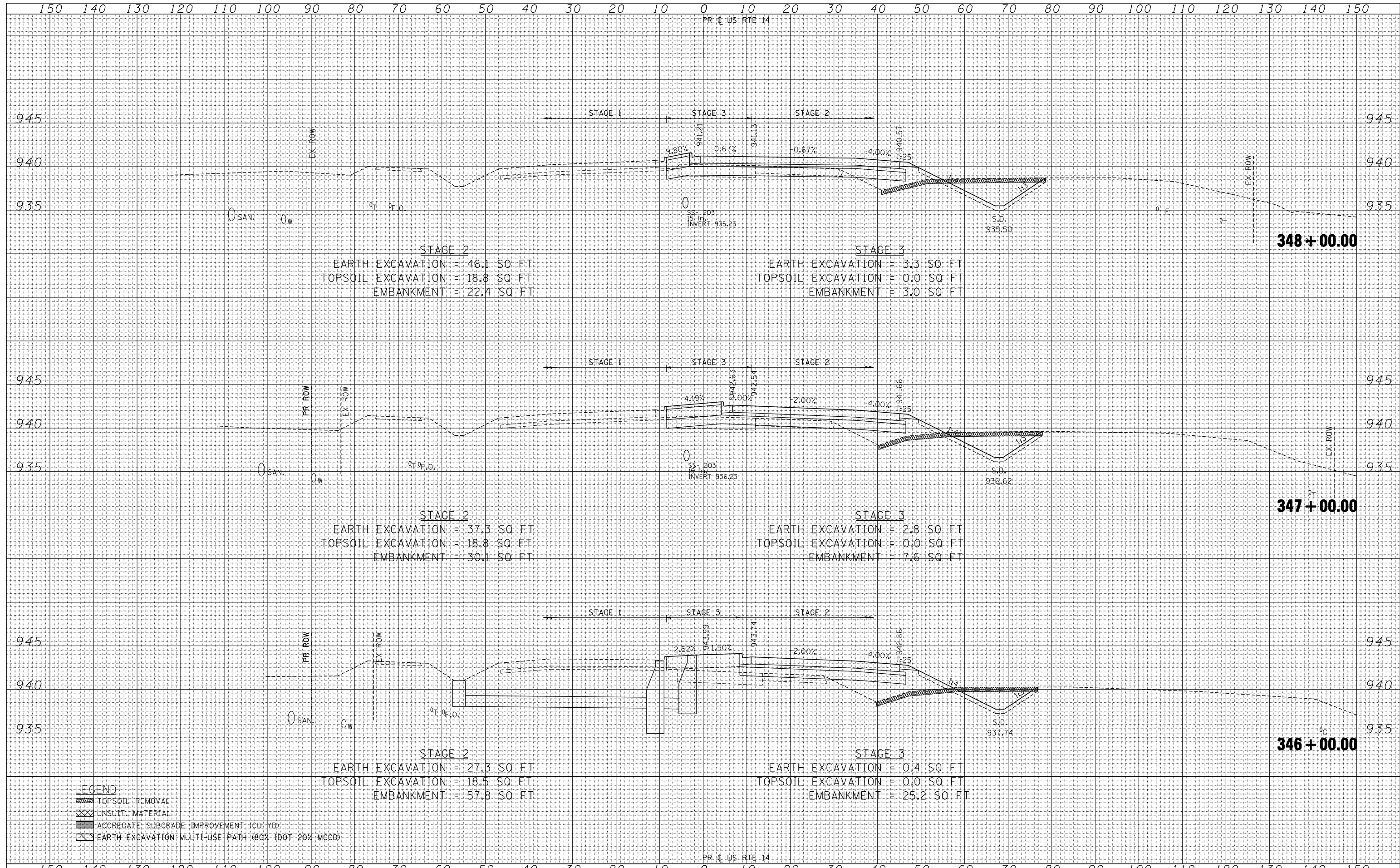

FILE NAME	USER NAME	DESIGNED	REVISED	<b>STATE OF ILLINOIS</b> <b>DEPARTMENT OF TRANSPORTATION</b>	<b>U.S. ROUTE 14 CROSS SECTIONS</b>	F.A.P. RTE.	SECTION	COUNTY	TOTAL SHEETS	SHEET NO.	
*FILEL*	*USERS*	DRAWN	REVISED			305	27R-2	MCHENRY	673	585	
		CHECKED	REVISED			CONTRACT NO. 62268					
		DATE	REVISED			ILLINOIS FED. AID PROJECT					

exp U.S. Services Inc.  
 Chicago, IL  
 BUILDING-EARTH & ENVIRONMENT-ENERGY  
 INDUSTRIAL-INFRASTRUCTURE-SUSTAINABILITY

SCALE: HORIZ. 1" = 10' VERT. 1" = 5'  
 STA. 346+00.00 TO STA. 348+00.00