

DATE	
BY	
SURVEYED	
PLOTTED	
TEMPLATE	
AREAS	
CHECKED	
FINAL SURVEY	
NOTE BOOK	
NO.	

DATE	
BY	
SURVEYED	
PLOTTED	
TEMPLATE	
AREAS	
CHECKED	
ORIGINAL SURVEY	
NOTE BOOK	
NO.	

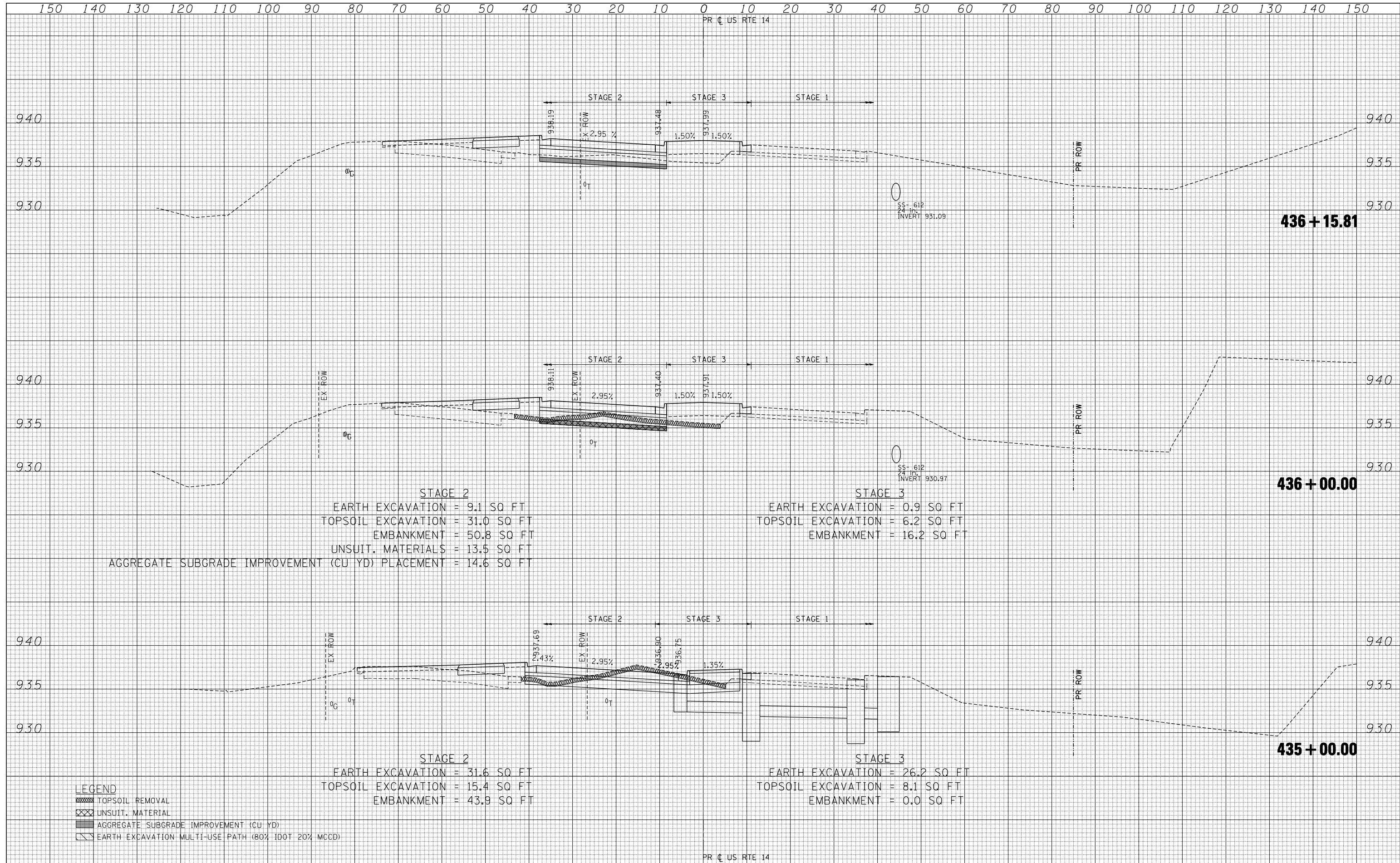

**STAGE 2**  
 EARTH EXCAVATION = 9.1 SQ FT  
 TOPSOIL EXCAVATION = 31.0 SQ FT  
 EMBANKMENT = 50.8 SQ FT  
 UNSUIT. MATERIALS = 13.5 SQ FT  
 AGGREGATE SUBGRADE IMPROVEMENT (CU YD) PLACEMENT = 14.6 SQ FT

**STAGE 3**  
 EARTH EXCAVATION = 0.9 SQ FT  
 TOPSOIL EXCAVATION = 6.2 SQ FT  
 EMBANKMENT = 16.2 SQ FT

**STAGE 2**  
 EARTH EXCAVATION = 31.6 SQ FT  
 TOPSOIL EXCAVATION = 15.4 SQ FT  
 EMBANKMENT = 43.9 SQ FT

**STAGE 3**  
 EARTH EXCAVATION = 26.2 SQ FT  
 TOPSOIL EXCAVATION = 8.1 SQ FT  
 EMBANKMENT = 0.0 SQ FT

- LEGEND**
- TOPSOIL REMOVAL
  - UNSUIT. MATERIAL
  - AGGREGATE SUBGRADE IMPROVEMENT (CU YD)
  - EARTH EXCAVATION MULTI-USE PATH (80% IDOT 20% MCD)

FILE NAME =  
 #FILEL#  
 exp U.S. Services Inc.  
 Chicago, IL  
 BUILDINGS-EARTH & ENVIRONMENT-ENERGY  
 INDUSTRIAL-INFRASTRUCTURE-SUSTAINABILITY

USER NAME = #USER#  
 DESIGNED -  
 DRAWN - AG  
 CHECKED - BRH  
 DATE - 11/01/13

REVISED -  
 REVISED -  
 REVISED -  
 REVISED -

**STATE OF ILLINOIS**  
**DEPARTMENT OF TRANSPORTATION**

**U.S. ROUTE 14 CROSS SECTIONS**  
 SCALE: HORIZ. 1" = 10' VERT. 1" = 5'  
 STA. 435+00.00 TO STA. 436+15.81

F.A.P. RTE.	SECTION	COUNTY	TOTAL SHEETS	SHEET NO.
305	27R-2	MCHENRY	673	631
			CONTRACT NO. 62268	
ILLINOIS FED. AID PROJECT				