

SCHEDULE OF QUANTITIES

ITEM	UNIT	QTY
LED INTERNALLY ILLUMINATED STREET NAME SIGN	EA	4
SIGN PANEL - TYPE 1	SF	30
UNDERGROUND CONDUIT, GALVANIZED STEEL, 2" DIA.	FT	1660
UNDERGROUND CONDUIT, GALVANIZED STEEL, 2 1/2" DIA.	FT	45
UNDERGROUND CONDUIT, GALVANIZED STEEL, 3" DIA.	FT	140
UNDERGROUND CONDUIT, GALVANIZED STEEL, 4" DIA.	FT	680
HANDHOLE	EA	7
HEAVY-DUTY HANDHOLE	EA	4
DOUBLE HANDHOLE	EA	2
FULL-ACTUATED CONTROLLER AND TYPE V CABINET, SPECIAL	EA	1
TRANSCEIVER - FIBER OPTIC	EA	1
ELECTRIC CABLE IN CONDUIT, SIGNAL NO. 14 3C	FT	752
ELECTRIC CABLE IN CONDUIT, SIGNAL NO. 14 5C	FT	2609
ELECTRIC CABLE IN CONDUIT, SIGNAL NO. 14 7C	FT	2318
ELECTRIC CABLE IN CONDUIT, LEAD-IN NO. 14 1 PAIR	FT	4963
ELECTRIC CABLE IN CONDUIT, SERVICE, NO. 6 2/C	FT	39
TRAFFIC SIGNAL POST, GALVANIZED STEEL 14 FT.	EA	2
TRAFFIC SIGNAL POST, GALVANIZED STEEL 16 FT.	EA	2
STEEL COMBINATION MAST ARM ASSEMBLY AND POLE, 42 FT.	EA	1
STEEL COMBINATION MAST ARM ASSEMBLY AND POLE, 46 FT.	EA	1
STEEL COMBINATION MAST ARM ASSEMBLY AND POLE, 48 FT.	EA	1
STEEL COMBINATION MAST ARM ASSEMBLY AND POLE, 52 FT.	EA	1
CONCRETE FOUNDATION, TYPE A	FT	26
CONCRETE FOUNDATION, TYPE C	FT	4
CONCRETE FOUNDATION, TYPE E 36 INCH DIAMETER	FT	54
SIGNAL HEAD, LED, 1-FACE, 3-SECTION, MAST-ARM MOUNTED	EA	8
SIGNAL HEAD, LED, 1-FACE, 5-SECTION, MAST-ARM MOUNTED	EA	2
SIGNAL HEAD, LED, 2-FACE, 3-SECTION, BRACKET MOUNTED	EA	2
SIGNAL HEAD, LED, 2-FACE, 1-3 SECTION, 3-5 SECTION, BRACKET MOUNTED	EA	2
TRAFFIC SIGNAL BACKPLATE, LOUVERED, ALUMINIUM	EA	10
INDUCTIVE LOOP DETECTOR	EA	16
LIGHT DETECTOR	EA	3
LIGHT DETECTOR AMPLIFIER	EA	1
TEMPORARY TRAFFIC SIGNAL INSTALLATION	EA	1
REMOVE EXISTING TRAFFIC SIGNAL EQUIPMENT	EA	1
REMOVE EXISTING HANDHOLE	EA	10
REMOVE EXISTING CONCRETE FOUNDATION	EA	6
PREFORMED DETECTOR LOOP	FT	769
TEMPORARY TRAFFIC SIGNAL TIMING	EA	1
SERVICE INSTALLATION - POLE MOUNTED	EA	1
MASTER CONTROLLER (SPECIAL)	EA	1
UNINTERRUPTIBLE POWER SUPPLY SPECIAL	EA	1
ELECTRIC CABLE IN CONDUIT, EQUIPMENT GROUNDING CONDUCTOR, NO. 6 1C	FT	924
ELECTRIC CABLE IN CONDUIT, SIGNAL NO. 20 3/C, TWISTED, SHIELDED	FT	752
100% LOCAL AGENCY COST		

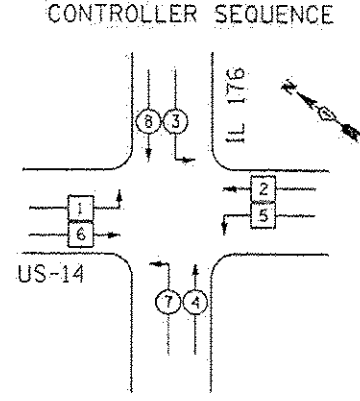

EMERGENCY VEHICLE PREEMPTION SEQUENCE

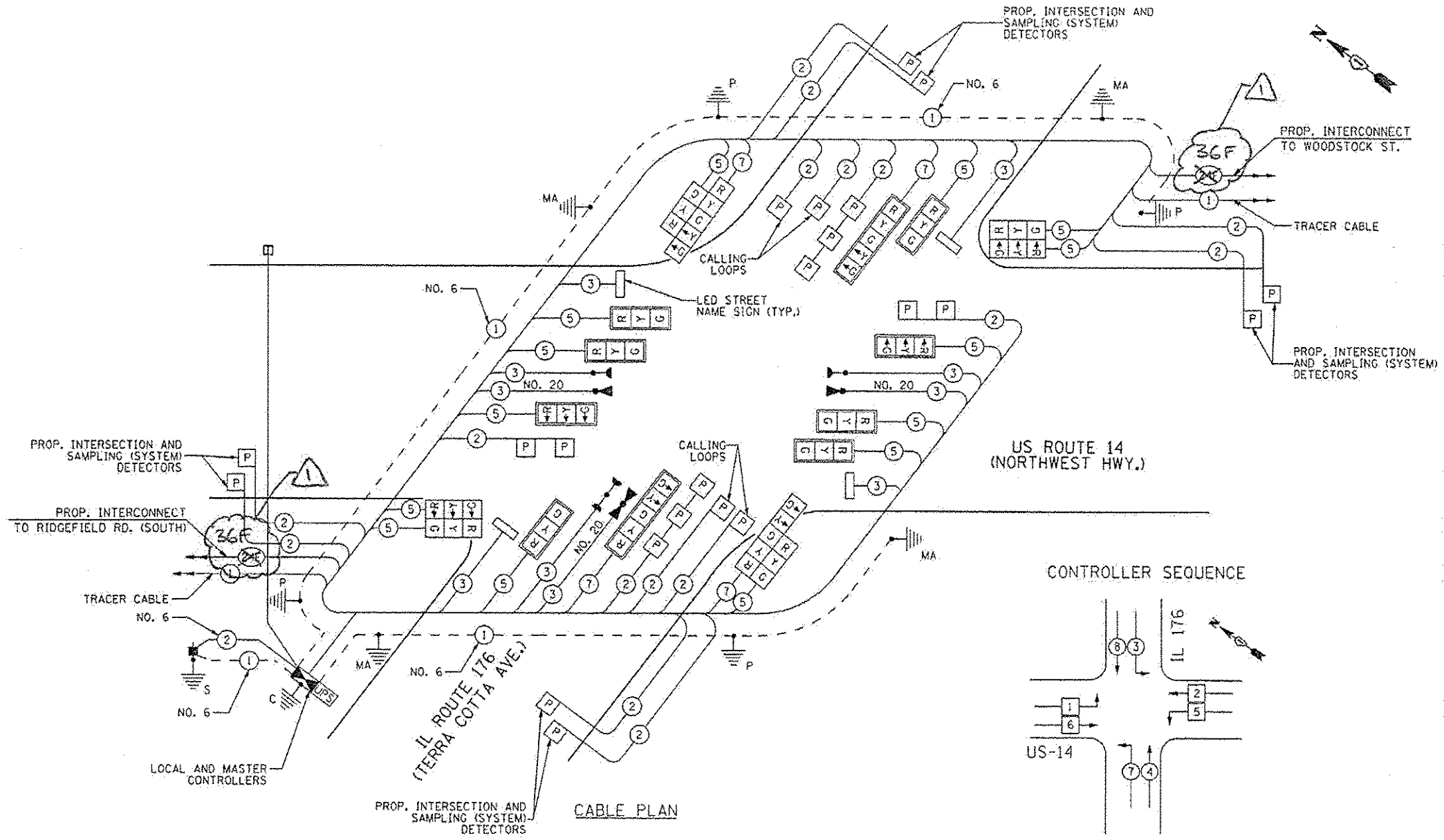
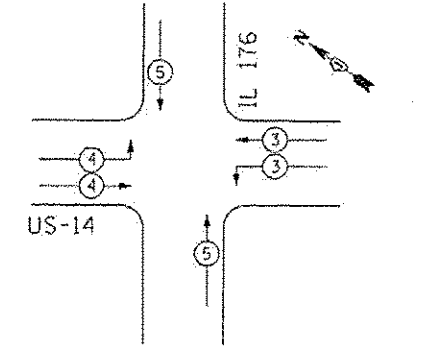

PROPOSED EMERGENCY VEHICLE PREEMPTORS			
EMERGENCY VEHICLE PREEMPTOR	3	4	5
MOVEMENT	←	→	↑↓

LEGEND

- (with 2) DUAL ENTRY PHASE
- (with 1) SINGLE ENTRY PHASE
- ⊕ (with 1) OVERLAP
- ⊕ (with 1) PEDESTRIAN PHASE
- NUMBER REFERS TO ASSOCIATED PHASE

NOTE: THE TRAFFIC SIGNAL CONTROLLER EQUIPMENT FOR THIS PROJECT SHALL BE "ECONOLITE" TO MATCH THE EXISTING ADJACENT SYSTEM.

NOTE: THE EMERGENCY PREEMPTION EQUIPMENT FOR THIS PROJECT SHALL BE "OPTICOM" BRAND TO MATCH THE EXISTING CITY SYSTEM.

THE END OF THE TRACER CABLE SHALL BE CONTINUOUS AND EXTEND INTO THE CONTROLLER CABINET.

RESTORATION OF WORK AREA: RESTORATION OF THE TRAFFIC WORK AREA SHALL BE INCLUDED IN THE COST OF THE RELATED PAY ITEM SUCH AS FOUNDATION, CONDUIT, HANDHOLE, TRENCH, AND BACKFILL ETC. AND NO EXTRA COMPENSATION SHALL BE ALLOWED. ALL ROADWAY SURFACES SUCH AS SHOULDERS, MEDIANS, SIDEWALKS, PAVEMENT, ETC. SHALL BE REPLACED IN KIND. ALL DAMAGE TO MOWED LAWNS SHALL BE REPLACED WITH AN APPROVED SOG, AND ALL DAMAGE TO UNMOWED FIELDS SHALL BE SEEDDED IN ACCORDANCE WITH STANDARD SPECIFICATIONS 252 AND 250 RESPECTIVELY.

I.D.O.T. TRAFFIC SIGNAL INSTALLATION ELECTRICAL SERVICE REQUIREMENTS

TYPE	NO. OF LAMPS	WATTAGE		% OPERATIONS	TOTAL WATTAGE
		INCAND.	LED		
SIGNAL (RED)	18	135	17	0.50	153.00
(YELLOW)	18	135	25	0.25	112.50
(GREEN)	18	135	15	0.25	67.50
ARROW	8	135	12	0.10	9.6
PED. SIGNAL	--	90	25	1.00	---
CONTROLLER	1	100	100	1.00	100.00
FLASHER	--	25	0.50	---	---
LED SIGN (6'+)	4	120	0.50	---	240.00

ENERGY COSTS TO: TOTAL = 682.6

ILLINOIS DEPARTMENT OF TRANSPORTATION
DIVISION OF HIGHWAYS/DISTRICT 1
SCHAUMBURG, ILLINOIS 60196

ENERGY SUPPLY: CONTACT: MIKE WIDHALM
PHONE: (815) 263-5624
COMPANY: COMED

EJM ENGINEERING, INC.
411 South Wells Street Suite 1000
Chicago, Illinois 60607

FILE NAME: ...10162517-SHT-TS038.dgn	USER NAME: rjason	DESIGNED: GR	REVISED: LP / 10/14
		DRAWN: GR	REVISED:
		CHECKED: RS	REVISED:
		DATE: 10/15/2013	REVISED:

STATE OF ILLINOIS DEPARTMENT OF TRANSPORTATION		SCHEDULE OF QUANTITIES, CABLE PLAN, PHASE DESIGNATION DIAGRAM, AND EMERGENCY VEHICLE PREEMPTION SEQUENCE US RTE. 14 AND IL RTE. 176		F.A.P. RTE. 305	SECTION 27R-3	COUNTY MCHENRY	TOTAL SHEETS 431	SHEET NO. 303
SCALE: NONE		SHEET NO. 1 OF 1 SHEETS		STA. TO STA.		CONTRACT NO. 62517		
FED. ROAD DIST. NO. 1 ILLINOIS FED. AID PROJECT								