

COLLEGE ENTR #3 STA. 12+10

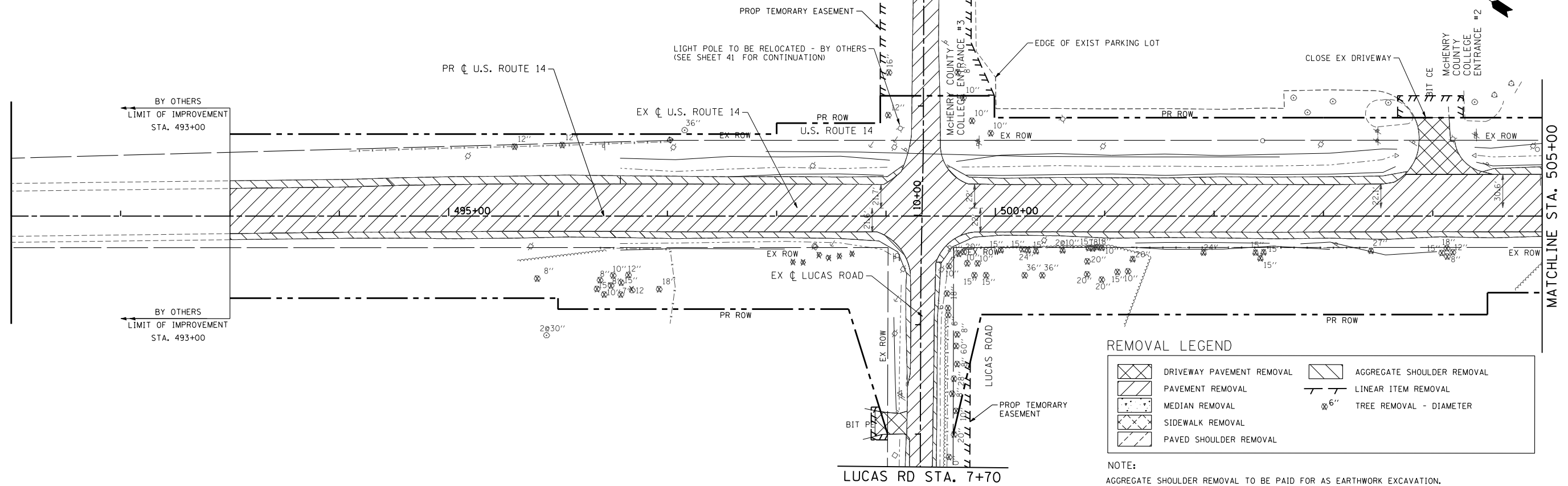

COLLEGE ENTR #3 STA. 12+10

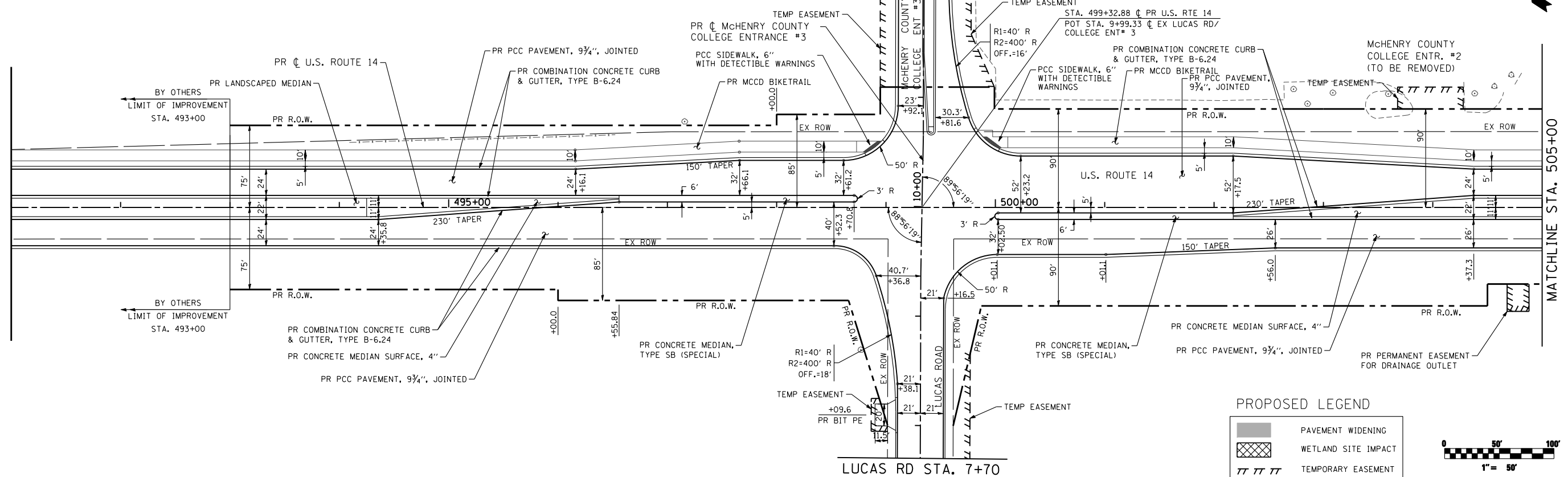

FILE NAME = S:\1606\CADD Sheets\0162517-sht-plan.dgn
 USER NAME = _USERNAME_
 PLOT SCALE = 100.0000' / IN.
 PLOT DATE = 10/14/2013

DESIGNED - JPW
 DRAWN - JPW
 CHECKED - MGZ
 DATE - 10/15/2013

REVISED -
 REVISED -
 REVISED -
 REVISED -

STATE OF ILLINOIS
 DEPARTMENT OF TRANSPORTATION

PLAN
 US ROUTE 14
 SCALE: 1"=50'
 SHEET NO. 32 OF 431 SHEETS
 STA. 490+00.00 TO STA. 505+00.00

F.A.P. RTE.	SECTION	COUNTY	TOTAL SHEETS	SHEET NO.
305	27R-3	MCHENRY	431	32
CONTRACT NO. 62517			ILLINOIS FED. AID PROJECT	