

NOTES:

1. AGGREGATE SHOULDER REMOVAL TO BE PAID FOR AS EARTHWORK EXCAVATION.
2. SAWCUT AND REMOVE 1' WIDTH OF PAVEMENT ADJACENT TO CURB AND GUTTER REMOVAL.

REMOVAL LEGEND

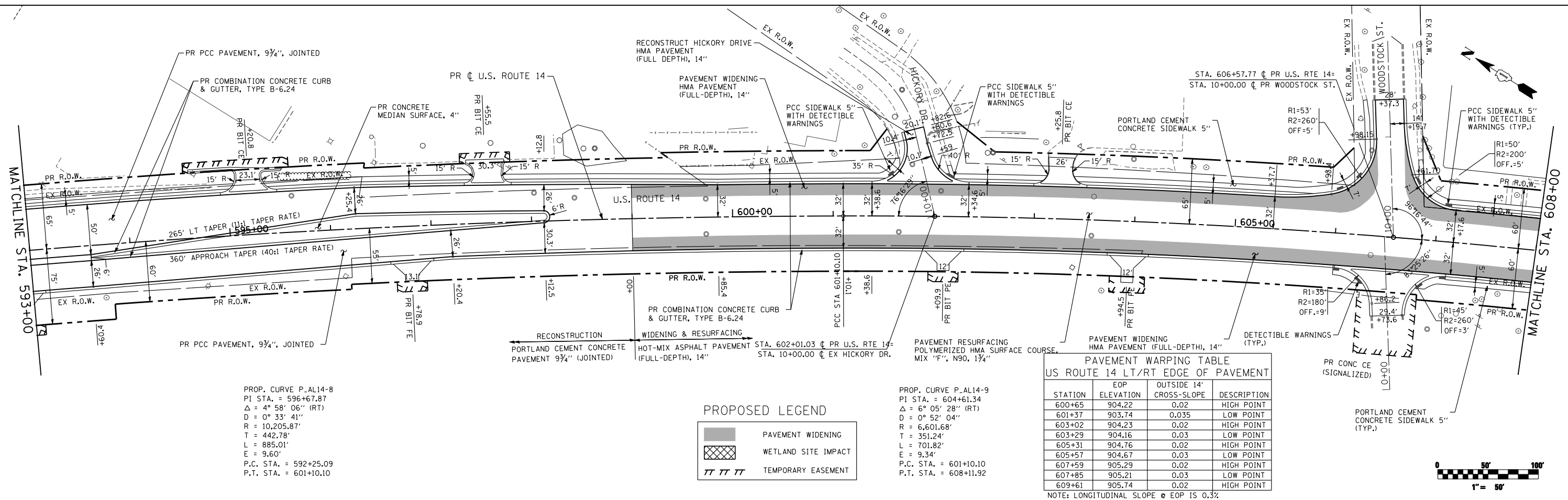
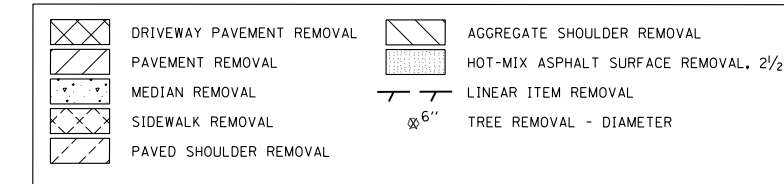

PROP. CURVE P-AL14-8
 PI STA. = 596+67.87
 $\Delta = 4^\circ 58' 06''$ (RT)
 $D = 0^\circ 33' 41''$
 $R = 10,205.87'$
 $T = 442.78'$
 $L = 885.01'$
 $E = 9.60'$
 P.C. STA. = 592+25.09
 P.T. STA. = 601+10.10



PROP. CURVE P-AL14-9
 PI STA. = 604+61.34
 $\Delta = 6^\circ 05' 28''$ (RT)
 $D = 0^\circ 52' 04''$
 $R = 6,601.68'$
 $T = 351.24'$
 $L = 701.82'$
 $E = 9.34'$
 P.C. STA. = 601+10.10
 P.T. STA. = 608+11.92

**PAVEMENT WARPING TABLE
 US ROUTE 14 LT/RT EDGE OF PAVEMENT**

STATION	EOP ELEVATION	OUTSIDE 14' CROSS-SLOPE	DESCRIPTION
600+65	904.22	0.02	HIGH POINT
601+37	903.74	0.035	LOW POINT
603+02	904.23	0.02	HIGH POINT
603+29	904.16	0.03	LOW POINT
605+31	904.76	0.02	HIGH POINT
605+57	904.67	0.03	LOW POINT
607+59	905.29	0.02	HIGH POINT
607+85	905.21	0.03	LOW POINT
609+61	905.74	0.02	HIGH POINT

NOTE: LONGITUDINAL SLOPE @ EOP IS 0.3%



FILE NAME = S:\1606\CADD Sheets\0162517-sht-plan.dgn	USER NAME = _USERNAME_	DESIGNED - JPW	REVISED -
		DRAWN - JPW	REVISED -
		CHECKED - MGZ	REVISED -
		DATE - 10/15/2013	REVISED -

**STATE OF ILLINOIS
 DEPARTMENT OF TRANSPORTATION**

**PLAN
 US ROUTE 14**

SCALE: 1"=50' SHEET NO. 39 OF 431 SHEETS STA. 593+00.00 TO STA. 608+00.00

F.A.P. RTE.	SECTION	COUNTY	TOTAL SHEETS	SHEET NO.
305	27R-3	MCHENRY	431	39
CONTRACT NO. 62517			ILLINOIS FED. AID PROJECT	