

STAGE 1A

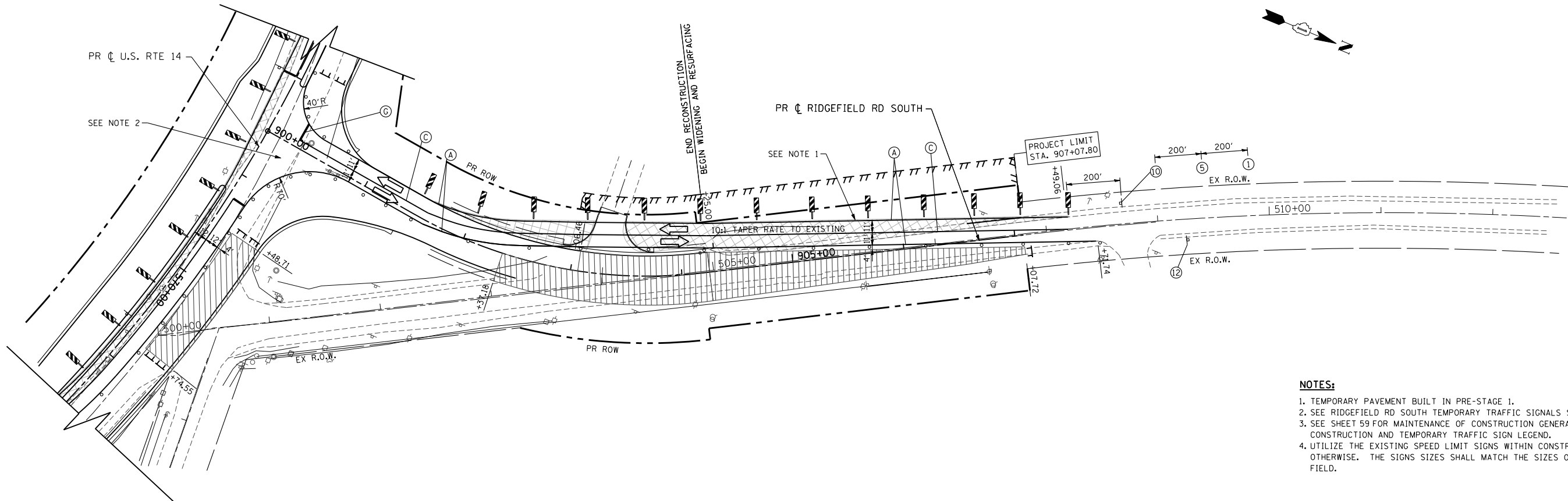

NOTES:

1. TEMPORARY PAVEMENT BUILT IN PRE-STAGE 1.
2. SEE RIDGEFIELD RD SOUTH TEMPORARY TRAFFIC SIGNALS SHEET.
3. SEE SHEET 59 FOR MAINTENANCE OF CONSTRUCTION GENERAL NOTES, SEQUENCE OF CONSTRUCTION AND TEMPORARY TRAFFIC SIGN LEGEND.
4. UTILIZE THE EXISTING SPEED LIMIT SIGNS WITHIN CONSTRUCTION LIMITS UNLESS NOTED OTHERWISE. THE SIGNS SIZES SHALL MATCH THE SIZES OF THE EXISTING SIGNS IN FIELD.

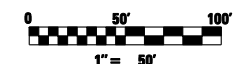

FILE NAME =	USER NAME = .USERNAME.	DESIGNED - JPW	REVISED -
si:\1606\cadd sheets\162517-sht-staging\1.dgn		DRAWN - JPW	REVISED -
PLOT SCALE = 100.0000' / IN.		CHECKED - MGZ	REVISED -
PLOT DATE = 10/9/2013		DATE - 10/15/2013	REVISED -

**STATE OF ILLINOIS
DEPARTMENT OF TRANSPORTATION**

**MAINTENANCE OF TRAFFIC PLAN
RIDGEFIELD RD SOUTH STAGE 1A**

F.A. RTE.	SECTION	COUNTY	TOTAL SHEETS	SHEET NO.
305	27R-3	MCHENRY	431	77
			CONTRACT NO. 62517	
ILLINOIS FED. AID PROJECT				

SCALE: 1"=50' SHEET NO. 77 OF 431 SHEETS STA. 900+00.00 TO STA. 907+71.74